



TEL 020 7253 4191
7th Floor, 125 Finsbury Pavement, London, EC2A 1NQ

NOTES:
This drawing may not be copied, reproduced or given to any third parties for any reason whatsoever without the written permission of Artemis Interiors.
Please note this drawing is protected under Copyright and remains the property of Artemis Interiors at all times.
All dimensions must be checked on site and not scaled from the drawing.
Proposals are subject to approvals by statutory authorities.

This drawing may not be copied, reproduced or given to any third parties for any reason whatsoever without the written permission of Artemis Interiors.
Please note this drawing is protected under Copyright and remains the property of Artemis Interiors at all times.
All dimensions must be checked on site and not scaled from the drawing.
Proposals are subject to approvals by statutory authorities.

Proposals are subject to approvals by statutory authorities.

Notes

- 1) Refer to accommodation and finishes schedule for details.
- 2) Design Intent drawing only - all elements are to be developed and integrated by the contractor for approval by the designer.
- 3) This drawing is to be read in conjunction with Artemis Interiors schedule of works which will override any discrepancy with the drawing.
- 4) This drawing is to be read in conjunction with all associated schedules: door schedule, furniture schedule, graphics schedule, CDM risk assessments and all specifications.
- 5) Goods lift doors to be confirmed.
- 6) All joinery to be manufactured in sections to fit site access via the goods lift.
- 7) Refer to referenced drawings for all client equipment.

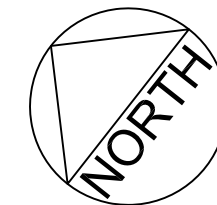

CHARLES II STREET

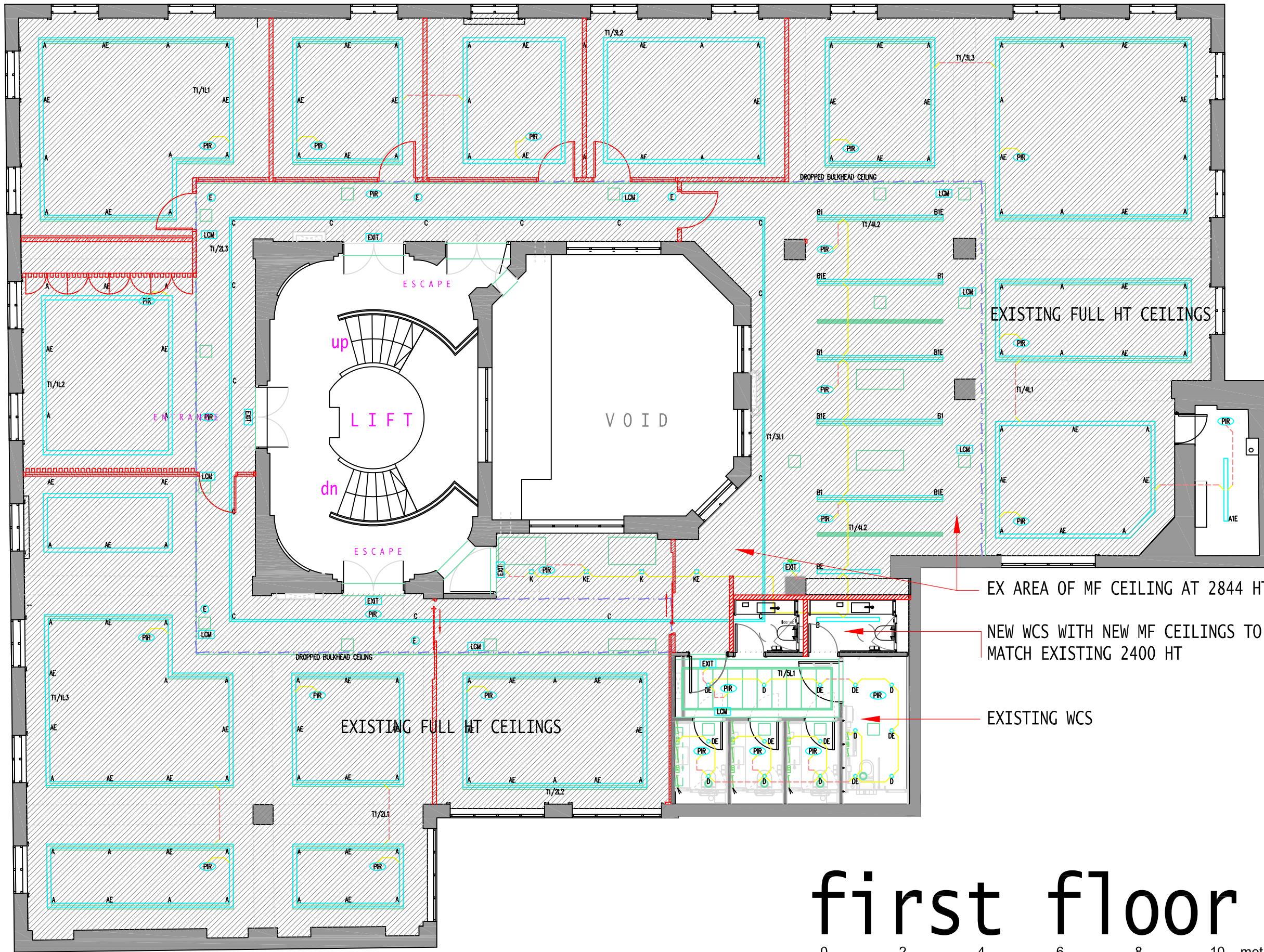

EX AREA OF MF CEILING AT 2844 HT

NEW WCS WITH NEW MF CEILINGS TO MATCH EXISTING 2400 HT

EXISTING WCS

first floor

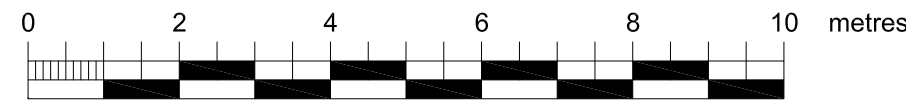

- 231023 LISTED BUILDING APPLICATION H
- 231022 WC VERSION G
- 231019 REVISED TO SUIT CLIENT CHANGES FROM DRG R06 WITH NEW WCS F
- 231019 REVISED TO SUIT CLIENT CHANGES FROM DRG R06 E
- 231009 LISTED BUILDING APPLICATION D
- 231006 TEA POINT UPDATED, LEGEND & NORTH SIGN ADDED C
- 230923 LISTED BUILDING APPLICATION B
- 230907- REVISED TO SUIT CLIENT CHANGES FROM DRG R03 A

REVISION	DATE	BY

LISTED BUILDING APPLICATION

DRAWING TITLE
EXISTING REFLECTED CEILING PLAN
NEW WALLS IN RED OVERLAID
FIRST FLOOR

DRAWING NUMBER
672/04

REVISION
H

SCALE
1:100@A3
1:50@A1

DATE
AUG 2023

JOB TITLE
11 WATERLOO PLACE, ST JAMES'S
LONDON, SW1Y 4AU

CLIENT
ALGBRIS (UK) LTD