

EXISTING SITE PLAN
0 2 4 6 8 10 1:200

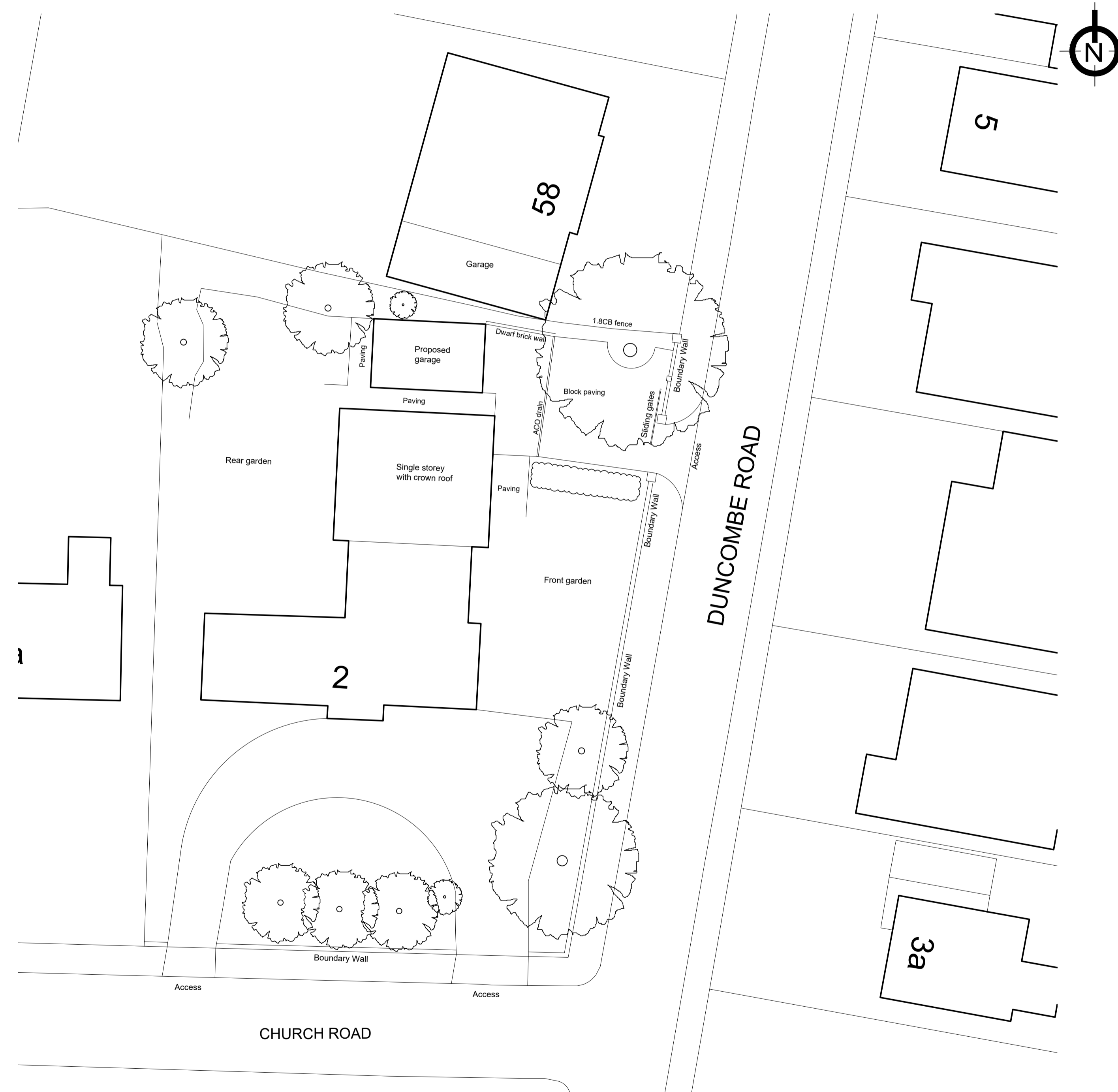

PROPOSED SITE PLAN
0 2 4 6 8 10 1:200

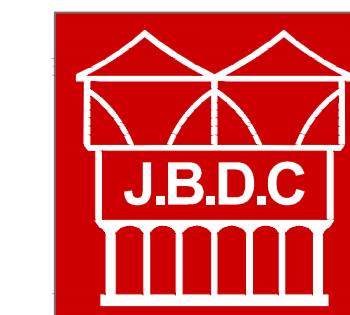

jbell design and conservation ltd
 Suite G2, Holly House Business Centre
 220-224 New London Road, Chelmsford, CM2 9AE
 T: 07484 791794
 E: jbell@designandconservation.co.uk
 www.designandconservation.co.uk

Client :	-	Scale :	1:200/1:1250 @ A1
Project :	2 Church Road, Hertford Bengeo, Hertford, SG14 3DP	Status :	Planning
Drawing :	Existing and Proposed Site Plan	Dwg No. :	2023-799-002
<small>© THIS DRAWING IS THE COPYRIGHT OF J BELL DESIGN AND CONSERVATION LTD. It shall not be in any way used or reproduced without their prior written consent. All dimensions are to be checked on site or in the workshop prior to commencing any work. Work only to figured dimensions. Any discrepancies are to be reported to the Architect.</small>			