

Glazing Calculation
 Total room area = 26.2m²
 25% allowance = 6.55m² + compensable existing = 5.59m²
 total allowance = 13.49m²
 total window area = 20.6x1.0 + 1.8x1.2 + 0.85x2.05 = 5.1m²
 therefore glazing complies.

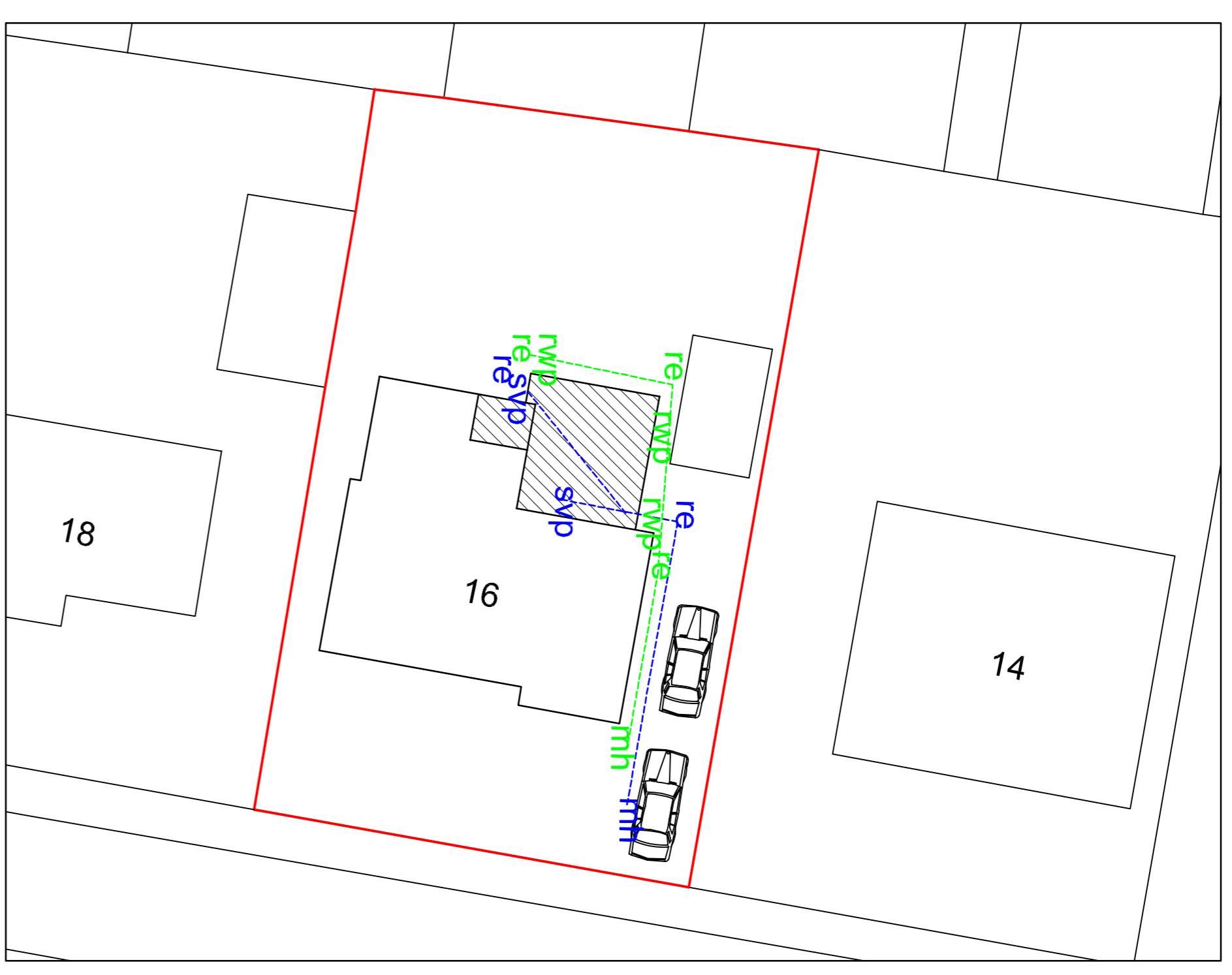

SPECIFICATION AND DESIGN CONSIDERATIONS

- Ensure sill height is at least equal to top of the sashes
- Width of linting pieces will vary depending on window type. See manufacturer's Reference Update 1
- Gutter linting minimum code 4 in lengths not exceeding 1500mm
- Header or Lintel Building's minimum of 150mm and 150mm may be present on sashes or not exceeding 1500mm
- Sashes feet should terminate over the top of the linting pieces at the sill height
- Partitions of Consider use to exterior finish of floor. Sashes may be supported by masonry.

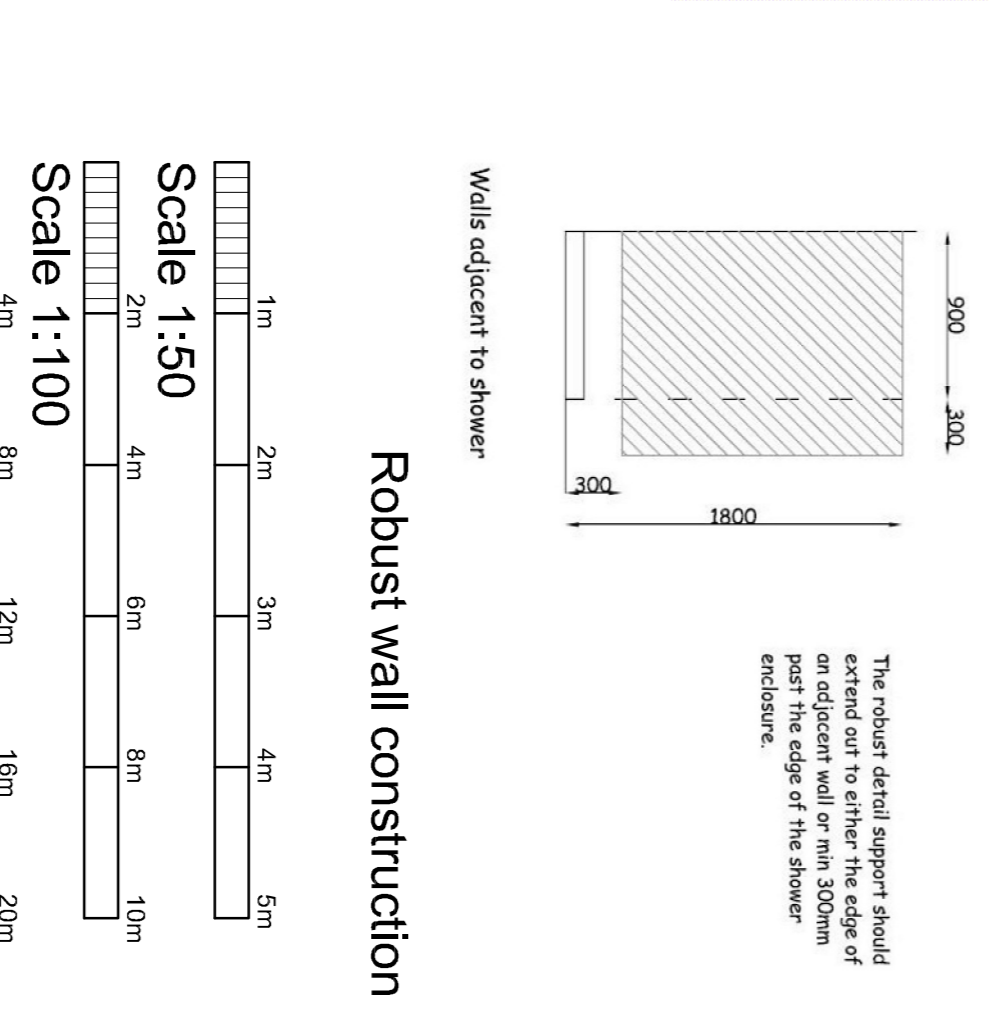
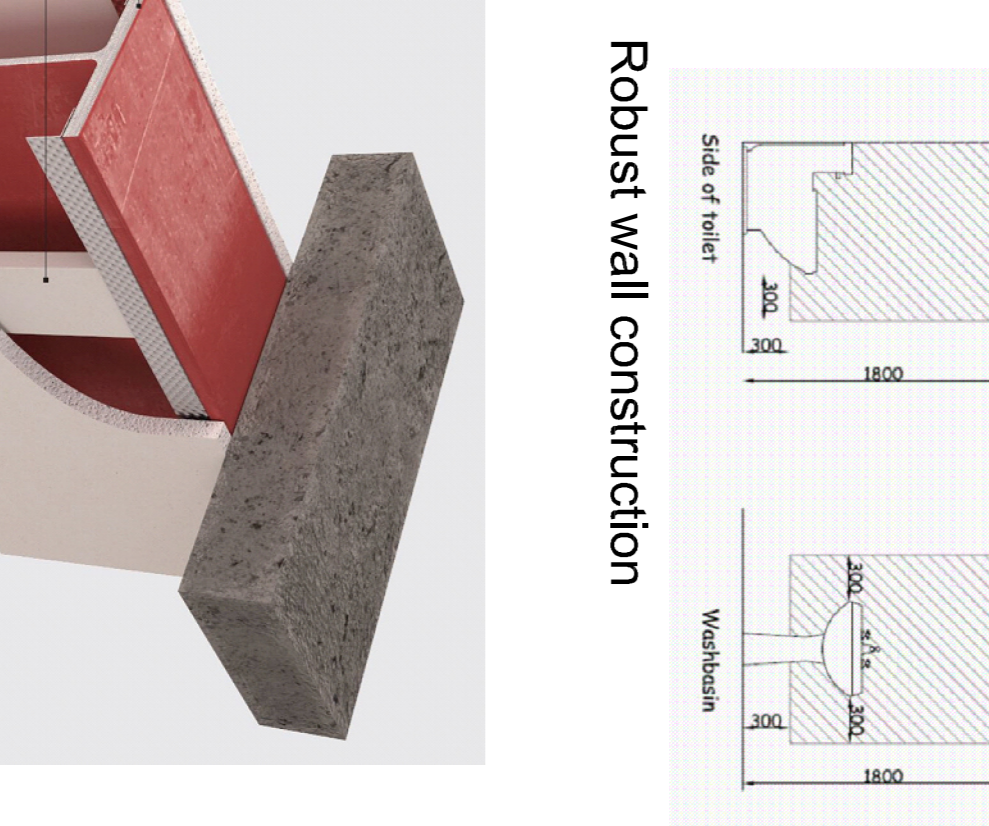
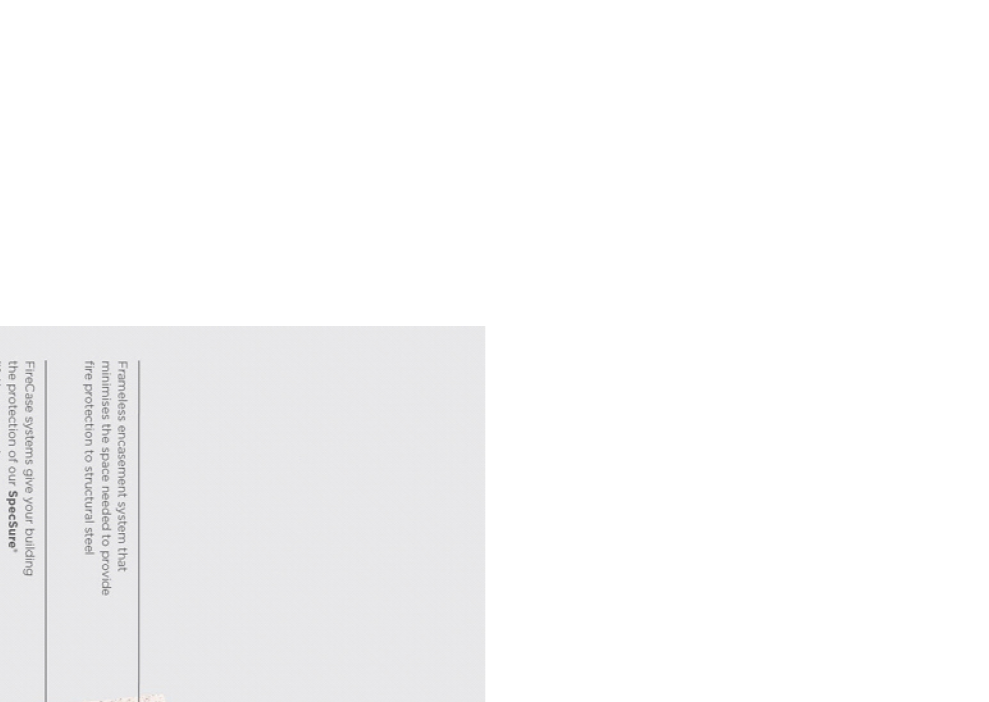
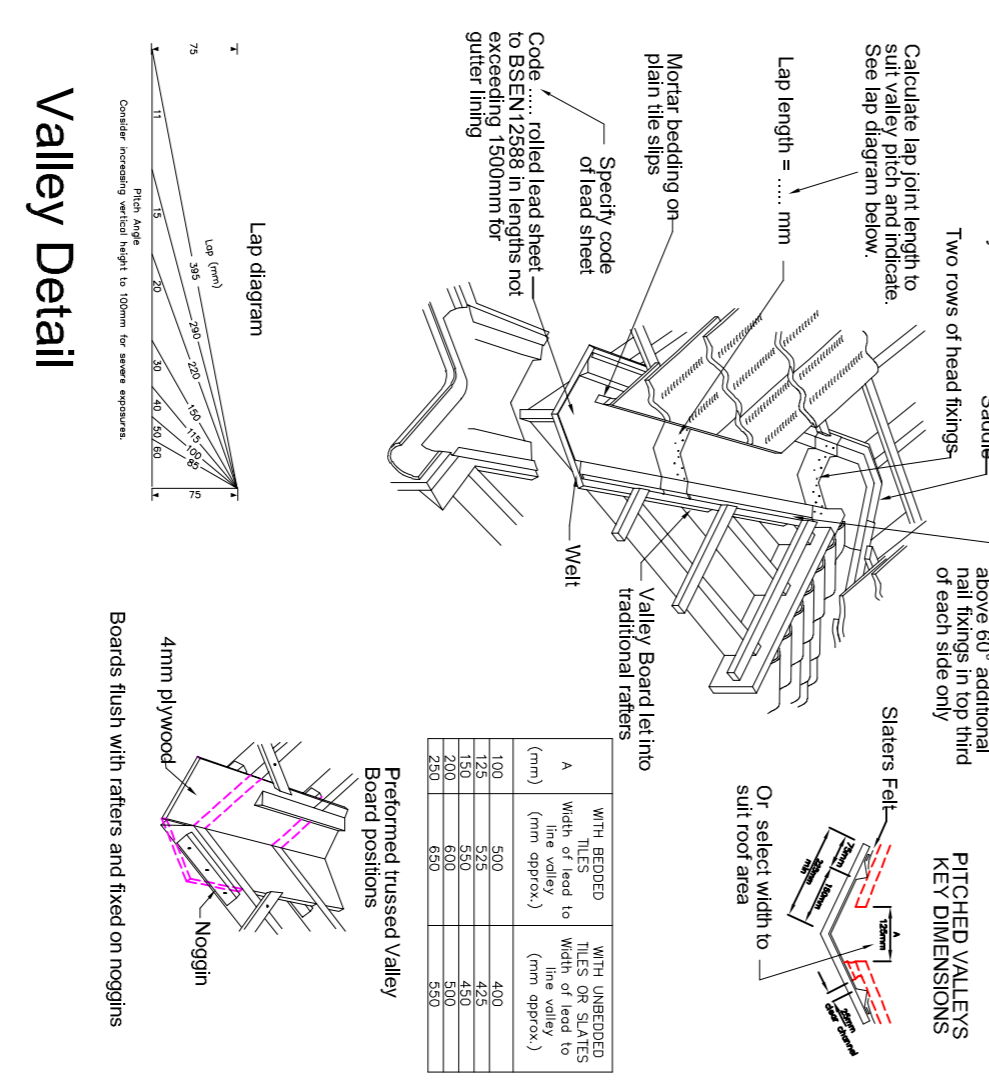
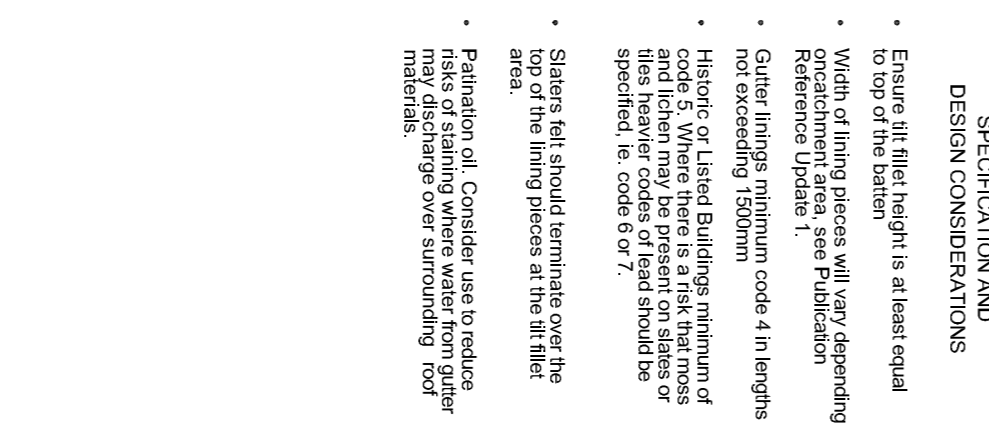
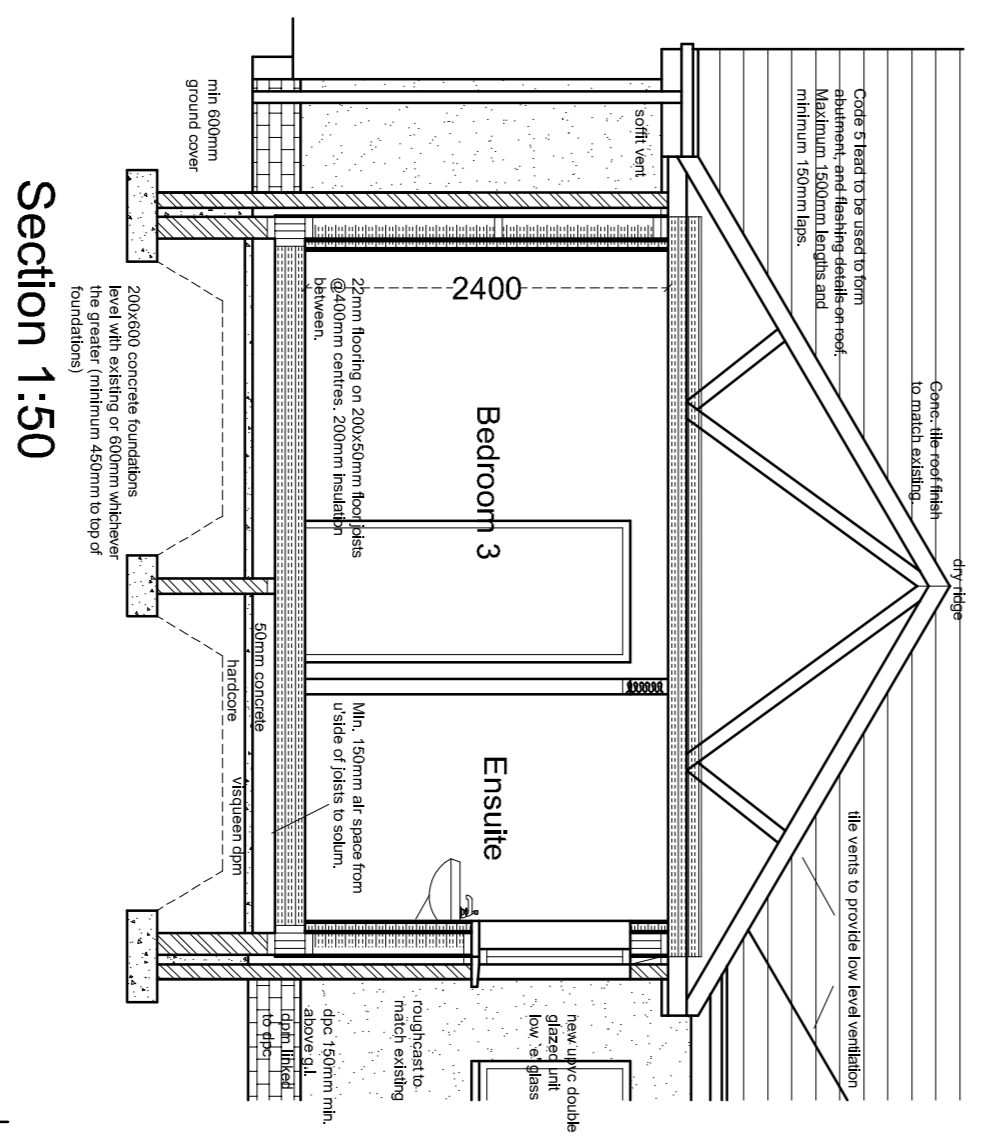

Project:
 Mr & Mrs Graham
 16 Woodlands Road
 Metherell, ML1 2PX
 Scale 1:50/1:100/1:200
 Date: 25/10/23 Rev

Proposed
 W00/02

