

NB Responsibility is not accepted for errors made by others scaling from this drawing. All construction information should be taken from figured dimensions only

A3

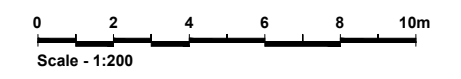

Rev	Description	By	Date

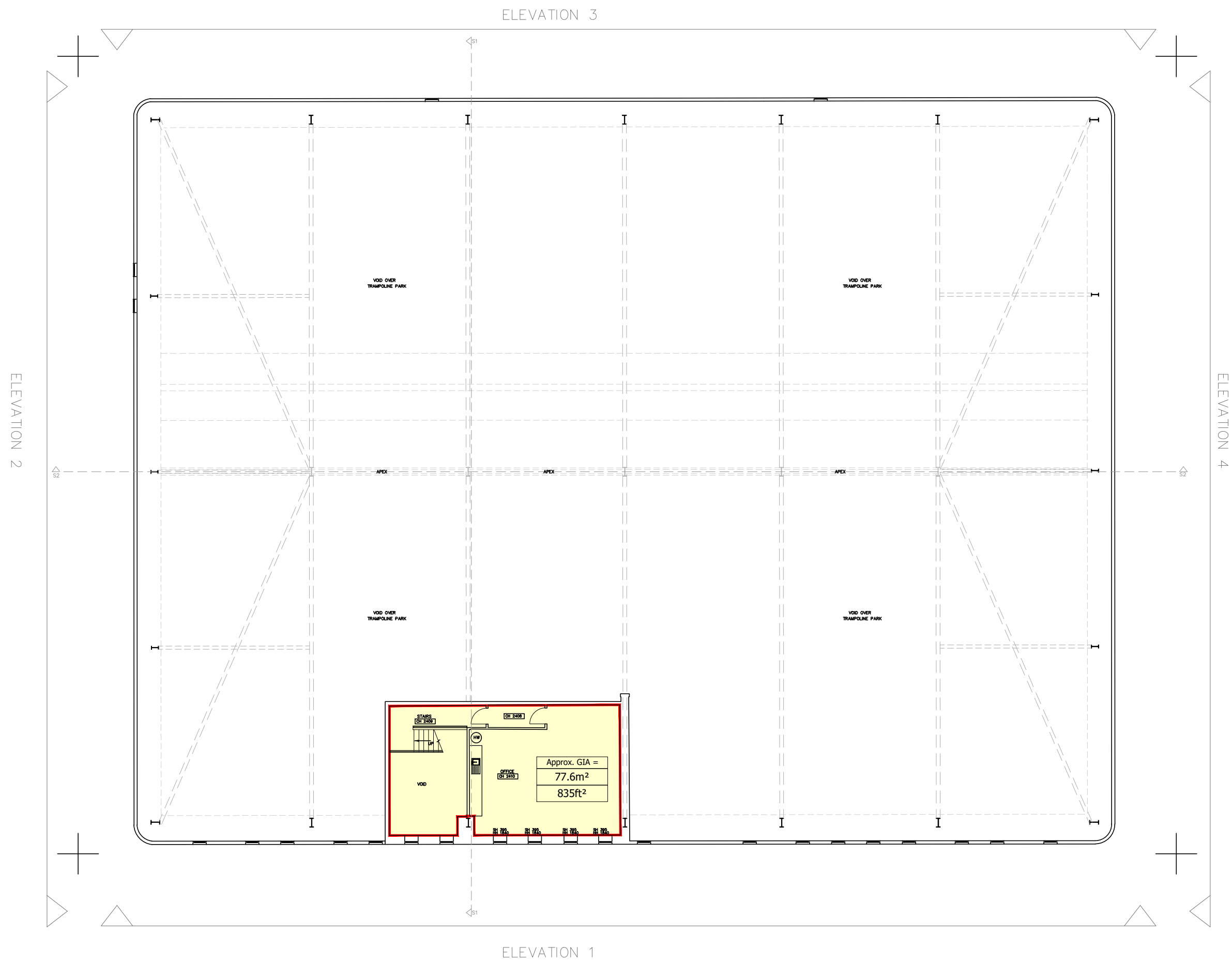

Project
SALTIRE RETAIL PARK
 GLENROTHES, KY6 2AL

Client
SACKVILLE UK PROPERTY
 SELECT III (GP) No2 LTD

Title
UNIT 2 - FIRST FLOOR
 AS EXISTING

Drawn by GJS	Surveyor BSM	Date JANUARY 2023
------------------------	------------------------	-----------------------------

Scale
1:200 @ A3

Drawing Number G222158-A01-02	Revision
-----------------------------------------	----------

Layouts shown are transcribed from UKBS, ref UKBS-9246, dated 26/9/22 and are intended as initial indicative drawings only, subject to feasibility including detailed measured survey, Structural Engineers report, M&E Engineers report, Building Control approval, Fire Officer approval and all statutory applications.