

**COPYRIGHT**  
 THIS DRAWING IS THE PROPERTY OF DONALD HUNTER ARCHITECTS. COPYRIGHT IS RESERVED BY THEM AND THIS DRAWING MUST NOT BE COPIED, REPRODUCED, RETAINED OR DISCLOSED TO ANY UNAUTHORISED PERSON, EITHER WHOLLY OR IN PART WITHOUT CONSENT IN WRITING OF DONALD HUNTER ARCHITECTS.

THIS DRAWING HAS BEEN PRODUCED AND IS SUBMITTED AS PART OF A PLANNING APPLICATION AND IS NOT INTENDED FOR USE BY ANY OTHER PERSON OR FOR ANY OTHER PURPOSE.

DO NOT SCALE FROM THIS DRAWING, USE FIGURED DIMENSIONS ONLY. ALL DIMENSIONS ARE TO BE CHECKED ON SITE PRIOR TO WORKS COMMENCING AND ANY DISCREPANCIES ARE TO BE REPORTED.

**DRAWING STATUS:**  
**PLANNING APPLICATION**

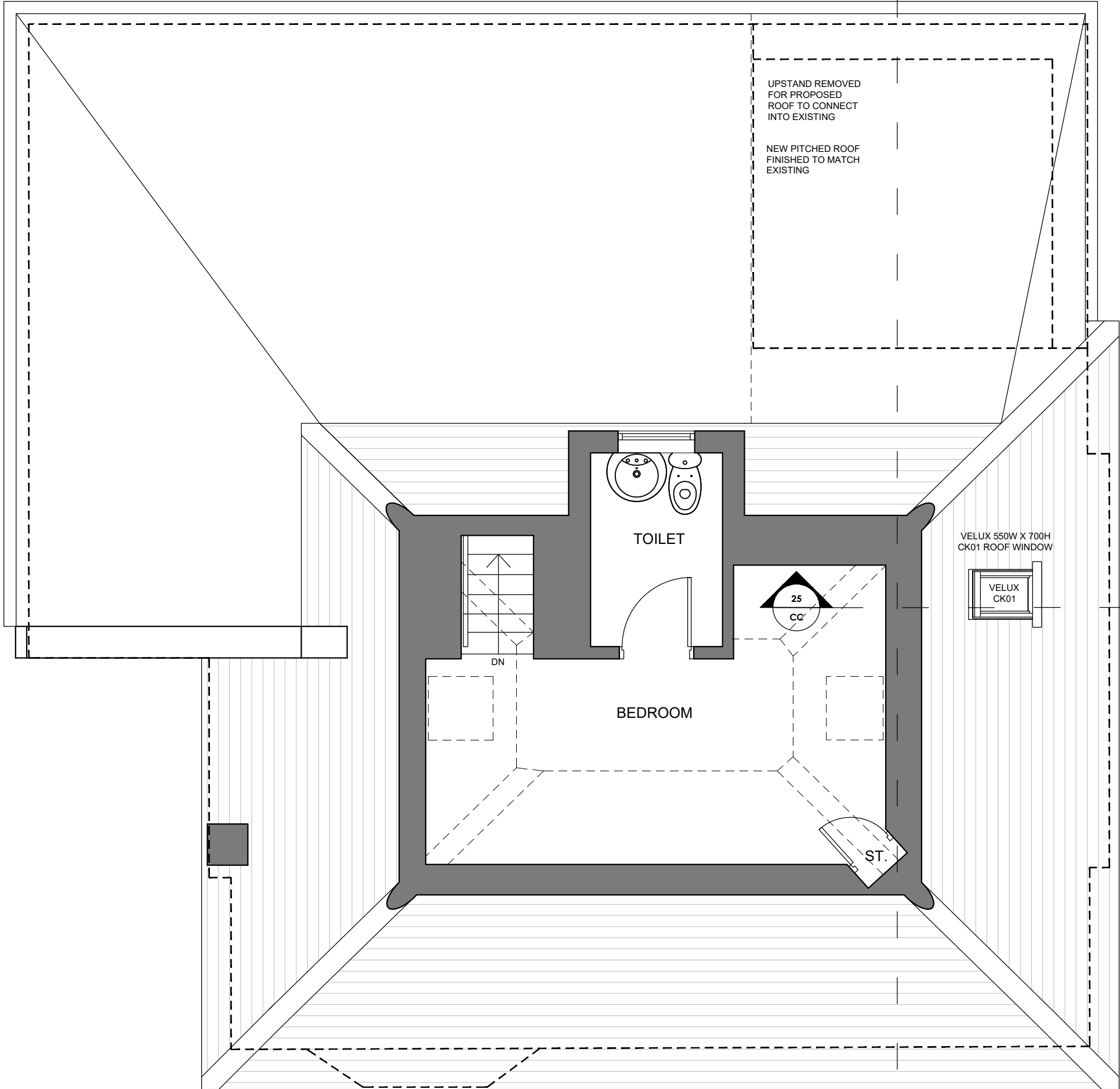
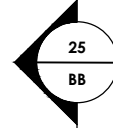

VELUX 550W X 700H  
 CK01 ROOF WINDOW

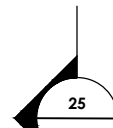
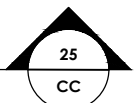
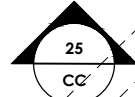
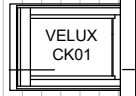

**DONALD HUNTER ARCHITECTS**

w. [www.donaldhunterarchitects.co.uk](http://www.donaldhunterarchitects.co.uk)  
 e. [info@donaldhunterarchitects.co.uk](mailto:info@donaldhunterarchitects.co.uk)  
 a. 41a Beresford Terrace, Ayr, KA7 2HD  
 t. 01292 502223

CLIENT: Mrs Winthrop

PROJECT TITLE:  
 Proposed Alterations and Extension  
 4 Hillside Crescent,  
 Prestwick,  
 KA9 2JN

DRAWING TITLE:  
 Proposed First Floor Plan

DRAWING NUMBER: 23012/21.B SCALE: 1:50 at A3  
 DATE: August 2023

Rev B - 26/10/23 - Velux window code / size updated  
 Rev A - 12/10/23 - Velux window added to the existing ground floor Bedroom.  
 Building footprint indicated in broken lines



WHEN PRINTING FROM PDF THIS LINE SHOULD MEASURE 50mm

