



Asbestos Refurbishment/Demolition Survey
For Roy Allum
at
House
Sycamore Lodge
Green Lane
Melton Mowbray
LE14-3QF



THIS REPORT MUST BE READ IN FULL AND NOT ONLY SPECIFIC SECTIONS



Project Number: 005170RS

Printed: 17/10/2022 By: M & G Services Ltd. Using Multibase software.



M & G Services Ltd

Names and Addresses

Client Name:

Roy Allum

Sycamore Lodge
Green Lane
Melton Mowbray
LE14-3QF

Contact:

Phone: 07710193916

Fax:

Instructing Party:

Roy Allum

Sycamore Lodge
Green Lane
Melton Mowbray
LE14-3QF

Contact: Roy Allum

Phone: 07710193916

Fax:

Site Full Name:

House

Sycamore Lodge
Green Lane
Melton Mowbray
LE14-3QF

Contact:

Phone:

Fax:

Report Author:

M & G Services Ltd

Unit 2 Pintail Close
Victoria Business Park, Netherfield
Nottingham
Notts
NG4 2SG

Contact: Chris Brailsford

Managing Director

M & G Services Ltd	Project Number:	005170RS
	Survey Date:	08 October 2022
	Printed On:	17 October 2022
	Page:	Page 1 of 1



TABLE OF CONTENTS

SECTION 1	Executive Summary
SECTION 2	Survey Objectives
SECTION 3	Survey Techniques
SECTION 4	Survey Notes
SECTION 5	Survey Summary
SECTION 6	Excluded Areas
SECTION 7	Survey Recommendations
SECTION 8	Material Assessment: Summary by Area
SECTION 9	Material Assessment (Photo)
SECTION 10	Survey Drawings
SECTION 11	Bulk Certificate
SECTION 12	Survey Caveat

SECTION ONE

EXECUTIVE SUMMARY

M & G Services Ltd

Executive Summary

General Information:

M & G Services Ltd were instructed by Roy Allum to carry out an Asbestos Refurbishment/Demolition Survey to inspect for the presence of asbestos containing materials (ACMs) at the following site:

House

(See below for full list of areas inspected)

The survey was carried out on 8th October 2022 by Chris Brailsford & Joseph Brailsford.

Area	Comments	Accessed
House, Sycamore Lodge, Green Lane, Melton Mowbray, LE14-3QF	THIS REPORT MUST BE READ IN FULL AND NOT ONLY SPECIFIC SECTIONS	Yes
Area 1 – Bedrooms x4	Sample taken, no asbestos materials present.	Yes
Area 2 – Landing & Stairs	Sample taken, no asbestos materials present.	Yes
Area 3 – Lounge	Sample taken & presumed asbestos materials present, asbestos materials present in sample.(Millboard to the fireplace S12 + cast pipe to fireplace - P)	Yes
Area 4 – Entrance Hallway	No samples taken, no asbestos materials present.	Yes
Area 5 – Study	No samples taken, no asbestos materials present.	Yes
Area 6 – Conservatory	No samples taken, no asbestos materials present.	Yes
Area 7 – Lounge No2	Sample taken & presumed asbestos materials present, no asbestos materials present in sample. (cast pipe to fireplace - P)	Yes
Area A – Bathrooms x2 (1st floor)	Sample taken, no asbestos materials present.	Yes
Area B – Bathroom (ground floor)	Sample taken, no asbestos materials present.	Yes
Area C – Kitchen (ground floor)	Sample taken, no asbestos materials present.	Yes
Roof Space x2	No samples taken, no asbestos materials present. (Mice traps in both roof spaces with mice in - access was limited).	Yes
External - House	Sample taken, asbestos materials present. (eternite roof tiles & infills S15)	Yes

Client Name:	Roy Allum	Project Number:	005170RS
		Survey Date:	08 October 2022
Site Address:	House, Sycamore Lodge, Green Lane, Melton Mowbray, LE14-3QF	Printed On:	17 October 2022
		Site Description:	Page 1 of 1

SECTION TWO

SURVEY OBJECTIVES

Survey Objectives

- 1 To carry out a survey to ascertain the presence of asbestos based materials. As per the C.A.R 2012 regulation 4 and HSE Guidance HSG/264 "Asbestos the Survey Guide" - HSG/248 "The Sampling Guide".
- 2 To locate as far as reasonably practicable, any suspect containing materials within the defined area of investigation.
- 3 To collect and analyse where possible, representative material samples to confirm the types of asbestos present and the material product in which they are used.
- 4 To leave the site on completion of survey in a clean and safe condition (fit for purpose)

Client Name:	Roy Allum	Project Number:	005170RS
		Survey Date:	08 October 2022
Site Address:	House, Sycamore Lodge, Green Lane, Melton Mowbray, LE14-3QF	Printed On:	17 October 2022
		Survey Objectives:	Page 1 of 1

SECTION THREE

SURVEY TECHNIQUES

Survey Techniques

- 1 Materials of a similar type were only occasionally sampled and it was assumed that other surfaces identical to where the sample was taken, was of a similar composition.
- 2 Photographs were taken at all of the sample locations (unless otherwise stated). Security risk, Sensitive areas etc...
- 3 Samples taken will be returned to a UKAS Accredited Laboratory only for analysis.
- 4 All Asbestos Bulk Sample Analysis is conducted by using Polarised Light and Dispersion Staining Techniques. Dispersion Staining is used to describe the colour effects produced when a transparent colourless particle or fibre is immersed in a liquid having a refractive index near to that of the particle or fibre, and is viewed under a microscope using transmitted white light (based on HSE Publication HSG 248).
- 5 **Material Sampling**
Appropriate respirators and protection are to be worn in all areas requiring the sampling of any type or suspected type of asbestos contained material.
- 6 Care must be taken to ensure against the contamination of surrounding surfaces with dust caused by the taking of any samples, by using hand held fibre suppressant to dampen the sampling point before and during the sampling process.
- 7 Samples are collected in a polythene bags, with an outer bag used to ensure against leakage.
- 8 Whilst samples are being taken the area will be vacated by others and warning signs and barrier tape erected where appropriate.
- 9 Any debris resulting from sampling will be carefully collected using the wet wipes or a H type vacuum.
- 10 Sampling points will be repaired to cover any fibrous surfaces using adhesive tape, filler or paint.
- 11 Both sample point and sample will be labelled with a trace-able unique reference number.
- 12 All sample points will have a unique reference number fixed on with a sample label, this will include the date and surveyors initials.
- 13 All bulk sampling equipment will be adequately cleaned after each sample is taken, to prevent any cross contamination of samples, and possible exposure to self or others to asbestos fibres.
- 14 All sampling and surveying areas will be left clean on completion and fit for purpose.

Client Name:	Roy Allum	Project Number:	005170RS
		Survey Date:	08 October 2022
Site Address:	House, Sycamore Lodge, Green Lane, Melton Mowbray, LE14-3QF	Printed On:	17 October 2022
		Survey Technique:	Page 1 of 1

SECTION FOUR

SURVEY NOTES

Survey Notes

- 1 Whilst every effort was made to locate the ceiling panels, wall partitions and other panels, which may have been constructed from asbestos boarding, none other than those detailed were found. Some may have been missed due to repairs, alterations etc, where false and other finishes have been applied or where different specifications (including a possible mixture of asbestos and non-asbestos) panels have been used in the same area. Only by sampling each panel would the composition of all the materials be known. This was clearly not practical in terms of cost or time.
- 2 No air monitoring was carried out whilst the survey was undertaken and therefore care was taken not to cause disturbance of fibre or contamination of clean surfaces.
- 3 This report has been written with reference to the various Guidance Notes etc, issued and current at the date of this report and describes circumstances at the site on the date the investigation took place.
- 4 Where similar items exist in the building, only one or two samples have been taken to ascertain the material content. It was assumed that similar products were of the same material. Only random sampling was carried out.
- 5 Any person undertaking work within the buildings should be told of the presence of asbestos. This briefing also applies to any other person associated with the site, including staff, sub-contractors and others.
- 6 The diagrams/drawings in the report are not to scale and are illustrative only to indicate approximate locations of asbestos contained materials.
- 7 All the recommendations described in this report are based upon assumptions made after consideration of the type of material, condition of the material, its location, analysis result and type of use the area is thought to be subjected to. However, statutory authorities or others, could require amendments based on local knowledge, change in legislation, change in use or indeed, other conditions or criteria.
- 8 The Survey area / area's will be left clean and safe on completion. (fit for purpose)
- 9 THIS REPORT MUST BE READ IN FULL AND NOT ONLY SPECIFIC SECTIONS
- 10 (Mice traps in both roof spaces with mice in - access was limited).

Client Name:	Roy Allum	Project Number:	005170RS
		Survey Date:	08 October 2022
Site Address:	House, Sycamore Lodge, Green Lane, Melton Mowbray, LE14-3QF	Printed On:	17 October 2022
		Survey Objectives:	Page 1 of 1

SECTION FIVE

SURVEY SUMMARY

Survey Summary

1 House, Sycamore Lodge, Green Lane, Melton Mowbray, LE14-3QF

Area 1 – Bedrooms x4

Floor – Concrete. Timber. Carpet. Bitumen S11.

Walls – Timber. Plasterboard. Solid.

Ceiling – Plaster & lathe.

Doors – Timber.

Boxings – Timber.

Pipes – Copper.

Boards – Timber.

Other - Modern electric. Log burners x2.

Area 2 – Landing & Stairs

Floor – Concrete. Timber. Carpet. Bitumen S11.

Walls – Plasterboard. Solid.

Ceiling – Plaster & lathe.

Doors – Timber. Timber – glazed.

Boxings – Timber.

Boards – Timber.

Other – Timber stairs.

Area 3 – Lounge

Floor – Concrete. Carpet.

Walls – Solid.

Ceiling – Plasterboard.

Doors – Timber. Glazed UPVC.

Pipes – Copper. Cast pipe to fireplace (presumed)

Boards – Timber. Millboard S12.

Area 4 – Entrance Hallway

Floor – Concrete. Ceramic.

Walls – Plasterboard. Solid.

Ceiling – Plasterboard.

Doors – Timber. Timber – glazed.

Boxings – Timber.

Pipes – Copper.

Boards – Timber.

Area 5 – Study

Floor – Concrete. Carpet.

Walls – Timber. Solid.

Ceiling – Plasterboard. Timber.

Doors – Timber. Timber – glazed.

Boxings – Timber.

Pipes – Copper.

Boards – Timber.

Area 6 – Conservatory

Floor – Concrete. Carpet.

Walls – Solid. Timber-glazed.

Ceiling – Timber.

Client Name:	Roy Allum	Project Number:	005170RS
		Survey Date:	08 October 2022
Site Address:	House, Sycamore Lodge, Green Lane, Melton Mowbray, LE14-3QF	Printed On:	17 October 2022
		Survey Summary:	Page 1 of 3

Survey Summary

Doors – Timber. Timber – glazed.
 Boxings – Timber.
 Pipes – Copper.
 Boards – Timber.

Area 7 – Lounge No2
 Floor – Concrete. Timber.
 Walls – Plasterboard. Solid.
 Ceiling – Plasterboard.
 Lagging – Foam.
 Doors – Timber. Glazed UPVC.
 Boxings – Timber.
 Pipes – Copper.
 Boards – Timber.
 Other – Metal fireplace - cast pipe (presumed). Windows S14.

Area A – Bathrooms x2 (1st floor)
 Floor – Concrete. Carpet. Bitumen S11.
 Walls – Ceramic. Plasterboard. Solid.
 Ceiling – Plasterboard.
 W/C system – Pot.
 Soil and vent – Plastic.
 Boxings – Timber.
 Windows – Timber.
 Extract – Yes.
 Shower – Yes.
 Pipes – Copper. Plastic.
 Doors – Timber. Glazed timber.
 Bath panel – Yes, plastic.

Area B – Bathroom (ground floor)
 Floor – Ceramic. Floor tile S13. Concrete.
 Walls – Ceramic. Timber. Solid.
 Ceiling – Plasterboard.
 W/C system – Pot.
 Soil and vent – Plastic.
 Boxings – Timber. Ceramic.
 Windows – Timber.
 Extract – No.
 Shower – No.
 Pipes – Copper. Plastic.
 Doors – Timber.
 Other – Copper cylinder. Foam insulation. Modern boiler.

Area C – Kitchen (ground floor)
 Floor covering – Floor tile S13. Ceramic. Below floor – Concrete. Timber.
 Walls – Ceramic. Plasterboard. Solid.
 Ceiling – Plasterboard.
 Pipes – Copper. Plastic.
 Boiler – No.
 Electrics – No.

Client Name:	Roy Allum	Project Number:	005170RS
		Survey Date:	08 October 2022
Site Address:	House, Sycamore Lodge, Green Lane, Melton Mowbray, LE14-3QF	Printed On:	17 October 2022
		Survey Summary:	Page 2 of 3

Survey Summary

Sink- Yes. Pads – Modern.
Doors – Timber.
Windows – UPVC.
Boards – Timber.
Boxing – Timber.
Other – Modern aga cooker.

Roof Space x2
MMMF quilt.
Modern felt.
Pipes – Copper. Plastic.
Tanks – Plastic x2.
Insulation – Polystyrene. Foam. MMMF.
Loft hatch – Timber.
(Mice traps in both roof spaces with mice in - access was limited).

External - House
Roof – Eternite S15.
Walls – Brick. Blue brick damp course membrane.
Rainwater goods – Plastic.
Fascia's – Timber.
Soffits – Timber.
Infill's – Eternite S15.
Windows – Timber. UPVC. Modern Putty.
Doors – Timber. UPVC. Modern Putty. Timber – glazed.
Pipes – Copper. Plastic.
Flues – Pot. Plastic.

Client Name:	Roy Allum	Project Number:	005170RS
		Survey Date:	08 October 2022
Site Address:	House, Sycamore Lodge, Green Lane, Melton Mowbray, LE14-3QF	Printed On:	17 October 2022
		Survey Summary:	Page 3 of 3

SECTION SIX

EXCLUDED AREAS

Excluded Areas

The Following rooms / areas could not be accessed during the survey. Asbestos Containing Materials (ACMs) should be deemed as being present in these areas until proven otherwise.

- 1 Live services
Below solid/fixed floors
Behind solid/fixed walls
Above solid/fixed ceilings
(Mice traps in both roof spaces with mice in - access was limited).
Areas 3 & 7 - cast pipe in fireplace (presumed)

Client Name:	Roy Allum	Project Number:	005170RS
		Survey Date:	08 October 2022
Site Address:	House, Sycamore Lodge, Green Lane, Melton Mowbray, LE14-3QF	Printed On:	17 October 2022
		Excluded Areas:	Page 1 of 1

SECTION SEVEN

SURVEY RECOMMENDATIONS

Survey Recommendations

1 House, Sycamore Lodge, Green Lane, Melton Mowbray, LE14-3QF

Areas 1, 2 & A

A sample was taken of the bitumen to the floor (S11) this was proven to be asbestos free; there was no visible sign of any asbestos containing materials evident within the above areas.

Area 3 – Lounge

A sample was taken of the millboard to fireplace (S12) this was proven to be asbestos (chrysotile).

LICENSABLE MATERIALS – Millboard S12

The material must be removed under full conditions by a contractor who holds a license issued by the H.S.E. after 14 days' notice has been served.

Presumed

cast pipe to the fireplace which was presumed to contain asbestos rope in joints, no sample was taken as it is a live service. (Further inspection required).

Areas 4, 5 & 6

No sample was taken; there was no visible sign of any asbestos containing materials evident within the above areas.

Area 7 – Lounge No2

A sample was taken of the rope sash to windows (S14) this was proven to be asbestos free; there was no visible sign of any asbestos containing materials evident within area 7 except cast pipe to fireplace which was presumed to contain asbestos rope in joints, no sample was taken as it is a live service. (Further inspection required).

Areas B & C

A sample was taken of the floor tile (S13) this was proven to be asbestos free; there was no visible sign of any asbestos containing materials evident within the above area.

Roof Space x2

No sample was taken; there was no visible sign of any asbestos containing materials evident within both roof spaces. (Mice traps in both roof spaces with mice in - access was limited).

External - House

A sample was taken of the eternite cement to roof tiles and infills (S15) this was proven to be asbestos (chrysotile).

NON-LICENSABLE MATERIALS – Asbestos cement S15

It require removals prior to demolition, this can only be carried out by a competent contractor with, 1) Non licensable removals training. 2) Fit testing for respirator to be used. 3) Adequate insurance coverage and 4) Medical surveillance for operatives, disposing as special waste regulation 2005.

Client Name:	Roy Allum	Project Number:	005170RS
		Survey Date:	08 October 2022
Site Address:	House, Sycamore Lodge, Green Lane, Melton Mowbray, LE14-3QF	Printed On:	17 October 2022
		Recommendation:	Page 1 of 2

Survey Recommendations

Material Assessment Algorithm

Sample variable	Score	Examples of scores
Product type (or debris from product)	1	Asbestos-reinforced composites (plastics, resins, mastics, roofing felts, vinyl floor tiles, semi-rigid paints or decorative finishes, asbestos cement etc).
	2	AIB, millboards, other low-density insulation boards, asbestos textiles, gaskets, ropes and woven textiles, asbestos paper and felt.
	3	Thermal insulation (eg pipe and boiler lagging), sprayed asbestos, loose asbestos, asbestos mattresses and packing.
Extent of damage/deterioration	0	Good condition: no visible damage.
	1	Low damage: a few scratches or surface marks, broken edges on boards, tiles etc.
	2	Medium damage: significant breakage of materials or several small areas where material has been damaged revealing loose asbestos fibres.
	3	High damage or delamination of materials, sprays and thermal insulation. Visible asbestos debris.
Surface treatment	0	Composite materials containing asbestos: reinforced plastics, resins, vinyl tiles.
	1	Enclosed sprays and lagging, AIB (with exposed face painted or encapsulated) asbestos cement sheets etc.
	2	Unsealed AIB, or encapsulated lagging and sprays.
	3	Unsealed lagging and sprays.
Asbestos type	1	Chrysotile.
	2	Amphibole asbestos excluding crocidolite.
	3	Crocidolite.

Client Name:	Roy Allum	Project Number:	005170RS
		Survey Date:	08 October 2022
Site Address:	House, Sycamore Lodge, Green Lane, Melton Mowbray, LE14-3QF	Printed On:	17 October 2022
		Recommendation:	Page 2 of 2

SECTION EIGHT

MATERIAL ASSESSMENT: SUMMARY BY AREA

Material Assessment: Summary by Area

Site Name: House

Area: House

Project Number: 005170RS

Sample Date	Location Ref	Location ID	Drawing Reference	Floor	Room	Asbestos Type	Product Name	Material Risk Score	Material Risk Band	Priority Risk Score	Comments	Action	Survey Type
08/10/22	08	37457			Roof space	Not Applicable	Overview	0	Not Applicable	N/A	This photo was taken of the overview in the roof space. (Please note only so much can be assessed).	No Action Required	RDS
08/10/22	07	37456		1st floor	Area 1	Not Applicable	Modern Electrics	0	Not Applicable	N/A	This photo was taken of the modern electrics in area 1.	No Action Required	RDS
08/10/22	01/s11	37450		1st floor	Areas 1, 2 & A	NADIS	Bitumen	0	NADIS	N/A	This photo shows sample 11 was taken of the bitumen to the floors in areas 1, 2 & A this sample was proven to be asbestos free.	No Action Required	RDS
08/10/22	05/s15	37454		External	External	Chrysotile	Eternite roof tiles	3	Very Low Risk	N/A	These photos shows sample 15 was taken of the external eternite to the roof tiles & infills this sample was proven to be asbestos (chrysotile).	Remove if disturbed	RDS
08/10/22	15	37464		External	External		Overview	0	Very Low Risk	N/A	This photo was taken of the external overview.	Overview	RDS
08/10/22	02/s12	37451		Ground floor	Area 3	Chrysotile	Board	4	Very Low Risk	N/A	This photo shows sample 12 was taken of the millboard to the fireplace in area 3 this sample was proven to be asbestos (chrysotile).	Remove - 14 days to the HSE	RDS
08/10/22	04/s14	37453		Ground floor	Area 7	NADIS	Rope	0	NADIS	N/A	This photo shows sample 14 was taken of the rope sash to windows in area 7 this sample was proven to be asbestos free.	No Action Required	RDS
08/10/22	13	37462		Ground floor	Area 7	Not Applicable	Panel	0	Not Applicable	N/A	This photo was taken of the metal panel in area 7.	No Action Required	RDS
08/10/22	14	37463		Ground floor	Area 7	Not Applicable	Overview	0	Not Applicable	N/A	This photo was taken of the overview to the floor in area 7.	Overview	RDS
08/10/22	09	37458		Ground floor	Area B	Not Applicable	Cylinder	0	Not Applicable	N/A	This photo was taken of the copper cylinder in area B.	No Action Required	RDS



Material Assessment: Summary by Area

Site Name:

Area: House

Project Number:

Sample Date	Location Ref	Location ID	Drawing Reference	Floor	Room	Asbestos Type	Product Name	Material Risk Score	Material Risk Band	Priority Risk Score	Comments	Action	Survey Type
08/10/22	10	37459		Ground floor	Area B	Not Applicable	Boiler	0	Not Applicable	N/A	This photo was taken of the modern boiler in area B.	No Action Required	RDS
08/10/22	11	37460		Ground floor	Area C	Not Applicable	AGA Cooker	0	Not Applicable	N/A	This photo was taken of the modern AGA cooker in area C.	No Action Required	RDS
08/10/22	12	37461		Ground floor	Area C	Not Applicable	Overview	0	Not Applicable	N/A	This photo was taken of the overview in area C.	Overview	RDS
08/10/22	06/p	37455		Ground floor	Areas 3 & 7		Cast pipes	4	Very Low Risk	N/A	Theses photos were taken due to no access to the live cast pipes to fireplaces in areas 3 & 7 these were both presumed to contain asbestos until further inspections.	Further Inspections	RDS
08/10/22	03/s13	37452		Ground floor	Areas B & C	NADIS	Floor tile	0	NADIS	N/A	This photo shows sample 13 was taken of the floor tiles in areas B & C this sample was proven to be asbestos free.	No Action Required	RDS



SECTION NINE

MATERIAL ASSESSMENT (PHOTO)

M & G Services Ltd

Material Assessment (Photo) Sorted by: Location ID

Site Address:

Client Name:

Project Number:

Location ID:	<input type="text" value="37450"/>	Survey Type:	<input type="text" value="RDS"/>
Location Ref:	<input type="text" value="01/s11"/>	Product Type:	<input type="text" value="NADIS"/>
Product:	<input type="text" value="Bitumen"/>	Damage:	<input type="text" value="NADIS"/>
Area:	<input type="text" value="House"/>	Treatment:	<input type="text" value="NADIS"/>
Floor:	<input type="text" value="1st floor"/>	Asbestos Type:	<input type="text" value="NADIS"/>
Room:	<input type="text" value="Areas 1, 2 & A"/>	Identification:	<input type="text" value="Identified"/>
Surveyor Name:	<input type="text" value="Chris Brailsford"/>	Quantity:	<input type="text"/>
Drawing Ref:	<input type="text"/>		
Asbestos ?	<input type="text" value="No"/>		
Date:	<input type="text" value="08 October 2022"/>		
Next Inspection:	<input type="text" value="Not Applicable"/>		

Material Risk Score:	<input type="text" value="0"/>
Material Risk Band:	<input type="text" value="NADIS"/>
Priority Risk Score:	<input type="text" value="N/A"/>

Action:



Material Comments:

M & G Services Ltd

Material Assessment (Photo) Sorted by: Location ID

Site Address:

Client Name:

Project Number:

Location ID:	<input type="text" value="37451"/>	Survey Type:	<input type="text" value="RDS"/>
Location Ref:	<input type="text" value="02/s12"/>	Product Type:	<input type="text" value="Asbestos Insulating Board"/>
Product:	<input type="text" value="Board"/>	Damage:	<input type="text" value="Good condition"/>
Area:	<input type="text" value="House"/>	Treatment:	<input type="text" value="AIB painted or encapsulated"/>
Floor:	<input type="text" value="Ground floor"/>	Asbestos Type:	<input type="text" value="Chrysotile"/>
Room:	<input type="text" value="Area 3"/>	Identification:	<input type="text" value="Identified"/>
Surveyor Name:	<input type="text" value="Chris Brailsford"/>	Quantity:	<input type="text"/>
Drawing Ref:	<input type="text"/>		
Asbestos ?	<input type="text" value="Yes"/>		
Date:	<input type="text" value="08 October 2022"/>		
Next Inspection:	<input type="text" value="08 October 2023"/>		

Material Risk Score:	<input type="text" value="4"/>
Material Risk Band:	<input type="text" value="Very Low Risk"/>
Priority Risk Score:	<input type="text" value="N/A"/>

Action:



Material Comments:

M & G Services Ltd

Material Assessment (Photo) Sorted by: Location ID

Site Address:

Client Name:

Project Number:

Location ID:	<input type="text" value="37452"/>	Survey Type:	<input type="text" value="RDS"/>
Location Ref:	<input type="text" value="03/s13"/>	Product Type:	<input type="text" value="NADIS"/>
Product:	<input type="text" value="Floor tile"/>	Damage:	<input type="text" value="NADIS"/>
Area:	<input type="text" value="House"/>	Treatment:	<input type="text" value="NADIS"/>
Floor:	<input type="text" value="Ground floor"/>	Asbestos Type:	<input type="text" value="NADIS"/>
Room:	<input type="text" value="Areas B & C"/>	Identification:	<input type="text" value="Identified"/>
Surveyor Name:	<input type="text" value="Chris Brailsford"/>	Quantity:	<input type="text"/>
Drawing Ref:	<input type="text"/>		
Asbestos ?	<input type="text" value="No"/>		
Date:	<input type="text" value="08 October 2022"/>		
Next Inspection:	<input type="text" value="Not Applicable"/>		

Material Risk Score:

Material Risk Band:

Priority Risk Score:

Action:



Material Comments:

M & G Services Ltd

Material Assessment (Photo) Sorted by: Location ID

Site Address:

Client Name:

Project Number:

Location ID:	<input type="text" value="37453"/>	Survey Type:	<input type="text" value="RDS"/>
Location Ref:	<input type="text" value="04/s14"/>	Product Type:	<input type="text" value="NADIS"/>
Product:	<input type="text" value="Rope"/>	Damage:	<input type="text" value="NADIS"/>
Area:	<input type="text" value="House"/>	Treatment:	<input type="text" value="NADIS"/>
Floor:	<input type="text" value="Ground floor"/>	Asbestos Type:	<input type="text" value="NADIS"/>
Room:	<input type="text" value="Area 7"/>	Identification:	<input type="text" value="Identified"/>
Surveyor Name:	<input type="text" value="Chris Brailsford"/>	Quantity:	<input type="text"/>
Drawing Ref:	<input type="text"/>		
Asbestos ?	<input type="text" value="No"/>		
Date:	<input type="text" value="08 October 2022"/>		
Next Inspection:	<input type="text" value="Not Applicable"/>		

Material Risk Score:	<input type="text" value="0"/>
Material Risk Band:	<input type="text" value="NADIS"/>
Priority Risk Score:	<input type="text" value="N/A"/>

Action:



Material Comments:

M & G Services Ltd

Material Assessment (Photo) Sorted by: Location ID

Site Address:

Client Name:

Project Number:

Location ID:	<input type="text" value="37454"/>	Survey Type:	<input type="text" value="RDS"/>
Location Ref:	<input type="text" value="05/s15"/>	Product Type:	<input type="text" value="Asbestos cement"/>
Product:	<input type="text" value="Eternite roof tiles"/>	Damage:	<input type="text" value="Good condition"/>
Area:	<input type="text" value="House"/>	Treatment:	<input type="text" value="Asbestos cement sheets etc"/>
Floor:	<input type="text" value="External"/>	Asbestos Type:	<input type="text" value="Chrysotile"/>
Room:	<input type="text" value="External"/>	Identification:	<input type="text" value="Identified"/>
Surveyor Name:	<input type="text" value="Chris Brailsford"/>	Quantity:	<input type="text"/>
Drawing Ref:	<input type="text"/>		
Asbestos ?	<input type="text" value="Yes"/>		
Date:	<input type="text" value="08 October 2022"/>		
Next Inspection:	<input type="text" value="08 October 2023"/>		

Material Risk Score:

Material Risk Band:

Priority Risk Score:

Action:



Material Comments:

M & G Services Ltd

Material Assessment (Photo) Sorted by: Location ID

Site Address:

Client Name:

Project Number:

Location ID:	<input type="text" value="37455"/>	Survey Type:	<input type="text" value="RDS"/>
Location Ref:	<input type="text" value="06/p"/>	Product Type:	<input type="text" value="Ropes and woven textiles"/>
Product:	<input type="text" value="Cast pipes"/>	Damage:	<input type="text" value="Good condition"/>
Area:	<input type="text" value="House"/>	Treatment:	<input type="text" value="Encapsulated lagging and spray"/>
Floor:	<input type="text" value="Ground floor"/>	Asbestos Type:	<input type="text"/>
Room:	<input type="text" value="Areas 3 & 7"/>	Identification:	<input type="text" value="Presumed"/>
Surveyor Name:	<input type="text" value="Chris Brailsford"/>	Quantity:	<input type="text"/>
Drawing Ref:	<input type="text"/>		
Asbestos ?	<input type="text" value="Yes"/>		
Date:	<input type="text" value="08 October 2022"/>		
Next Inspection:	<input type="text" value="08 October 2023"/>		

Material Risk Score:

Material Risk Band:

Priority Risk Score:

Action:



Material Comments:

M & G Services Ltd

Material Assessment (Photo) Sorted by: Location ID

Site Address:

Client Name:

Project Number:

Location ID:	<input type="text" value="37456"/>	Survey Type:	<input type="text" value="RDS"/>
Location Ref:	<input type="text" value="07"/>	Product Type:	<input type="text" value="Not Applicable"/>
Product:	<input type="text" value="Modern Electrics"/>	Damage:	<input type="text" value="Not Applicable"/>
Area:	<input type="text" value="House"/>	Treatment:	<input type="text" value="Not Applicable"/>
Floor:	<input type="text" value="1st floor"/>	Asbestos Type:	<input type="text" value="Not Applicable"/>
Room:	<input type="text" value="Area 1"/>	Identification:	<input type="text"/>
Surveyor Name:	<input type="text" value="Chris Brailsford"/>	Quantity:	<input type="text"/>
Drawing Ref:	<input type="text"/>		
Asbestos ?	<input type="text" value="No"/>		
Date:	<input type="text" value="08 October 2022"/>		
Next Inspection:	<input type="text" value="Not Applicable"/>		

Material Risk Score:	<input type="text" value="0"/>
Material Risk Band:	<input type="text" value="Not Applicable"/>
Priority Risk Score:	<input type="text" value="N/A"/>

Action:



Material Comments:

M & G Services Ltd

Material Assessment (Photo) Sorted by: Location ID

Site Address:

Client Name:

Project Number:

Location ID:	<input type="text" value="37457"/>	Survey Type:	<input type="text" value="RDS"/>
Location Ref:	<input type="text" value="08"/>	Product Type:	<input type="text" value="Not Applicable"/>
Product:	<input type="text" value="Overview"/>	Damage:	<input type="text" value="Not Applicable"/>
Area:	<input type="text" value="House"/>	Treatment:	<input type="text" value="Not Applicable"/>
Floor:	<input type="text"/>	Asbestos Type:	<input type="text" value="Not Applicable"/>
Room:	<input type="text" value="Roof space"/>	Identification:	<input type="text"/>
Surveyor Name:	<input type="text" value="Chris Brailsford"/>	Quantity:	<input type="text"/>
Drawing Ref:	<input type="text"/>		
Asbestos ?	<input type="text" value="No"/>		
Date:	<input type="text" value="08 October 2022"/>		
Next Inspection:	<input type="text" value="Not Applicable"/>		

Material Risk Score:

Material Risk Band:

Priority Risk Score:

Action:



Material Comments:

M & G Services Ltd

Material Assessment (Photo) Sorted by: Location ID

Site Address:

Client Name:

Project Number:

Location ID:	<input type="text" value="37458"/>	Survey Type:	<input type="text" value="RDS"/>
Location Ref:	<input type="text" value="09"/>	Product Type:	<input type="text" value="Not Applicable"/>
Product:	<input type="text" value="Cylinder"/>	Damage:	<input type="text" value="Not Applicable"/>
Area:	<input type="text" value="House"/>	Treatment:	<input type="text" value="Not Applicable"/>
Floor:	<input type="text" value="Ground floor"/>	Asbestos Type:	<input type="text" value="Not Applicable"/>
Room:	<input type="text" value="Area B"/>	Identification:	<input type="text"/>
Surveyor Name:	<input type="text" value="Chris Brailsford"/>	Quantity:	<input type="text"/>
Drawing Ref:	<input type="text"/>		
Asbestos ?	<input type="text" value="No"/>		
Date:	<input type="text" value="08 October 2022"/>		
Next Inspection:	<input type="text" value="Not Applicable"/>		

Material Risk Score:	<input type="text" value="0"/>
Material Risk Band:	<input type="text" value="Not Applicable"/>
Priority Risk Score:	<input type="text" value="N/A"/>

Action:



Material Comments:



M & G Services Ltd

Material Assessment (Photo) Sorted by: Location ID

Site Address:

Client Name:

Project Number:

Location ID:	<input type="text" value="37459"/>	Survey Type:	<input type="text" value="RDS"/>
Location Ref:	<input type="text" value="10"/>	Product Type:	<input type="text" value="Not Applicable"/>
Product:	<input type="text" value="Boiler"/>	Damage:	<input type="text" value="Not Applicable"/>
Area:	<input type="text" value="House"/>	Treatment:	<input type="text" value="Not Applicable"/>
Floor:	<input type="text" value="Ground floor"/>	Asbestos Type:	<input type="text" value="Not Applicable"/>
Room:	<input type="text" value="Area B"/>	Identification:	<input type="text"/>
Surveyor Name:	<input type="text" value="Chris Brailsford"/>	Quantity:	<input type="text"/>
Drawing Ref:	<input type="text"/>		
Asbestos ?	<input type="text" value="No"/>		
Date:	<input type="text" value="08 October 2022"/>		
Next Inspection:	<input type="text" value="Not Applicable"/>		

Material Risk Score:	<input type="text" value="0"/>
Material Risk Band:	<input type="text" value="Not Applicable"/>
Priority Risk Score:	<input type="text" value="N/A"/>

Action:



Material Comments:

M & G Services Ltd

Material Assessment (Photo) Sorted by: Location ID

Site Address:

Client Name:

Project Number:

Location ID:	<input type="text" value="37460"/>	Survey Type:	<input type="text" value="RDS"/>
Location Ref:	<input type="text" value="11"/>	Product Type:	<input type="text" value="Not Applicable"/>
Product:	<input type="text" value="AGA Cooker"/>	Damage:	<input type="text" value="Not Applicable"/>
Area:	<input type="text" value="House"/>	Treatment:	<input type="text" value="Not Applicable"/>
Floor:	<input type="text" value="Ground floor"/>	Asbestos Type:	<input type="text" value="Not Applicable"/>
Room:	<input type="text" value="Area C"/>	Identification:	<input type="text"/>
Surveyor Name:	<input type="text" value="Chris Brailsford"/>	Quantity:	<input type="text"/>
Drawing Ref:	<input type="text"/>		
Asbestos ?	<input type="text" value="No"/>		
Date:	<input type="text" value="08 October 2022"/>		
Next Inspection:	<input type="text" value="Not Applicable"/>		

Material Risk Score:	<input type="text" value="0"/>
Material Risk Band:	<input type="text" value="Not Applicable"/>
Priority Risk Score:	<input type="text" value="N/A"/>

Action:



Material Comments:

M & G Services Ltd

Material Assessment (Photo) Sorted by: Location ID

Site Address:

Client Name:

Project Number:

Location ID:	<input type="text" value="37461"/>	Survey Type:	<input type="text" value="RDS"/>
Location Ref:	<input type="text" value="12"/>	Product Type:	<input type="text" value="Not Applicable"/>
Product:	<input type="text" value="Overview"/>	Damage:	<input type="text" value="Not Applicable"/>
Area:	<input type="text" value="House"/>	Treatment:	<input type="text" value="Not Applicable"/>
Floor:	<input type="text" value="Ground floor"/>	Asbestos Type:	<input type="text" value="Not Applicable"/>
Room:	<input type="text" value="Area C"/>	Identification:	<input type="text"/>
Surveyor Name:	<input type="text" value="Chris Brailsford"/>	Quantity:	<input type="text"/>
Drawing Ref:	<input type="text"/>		
Asbestos ?	<input type="text" value="No"/>		
Date:	<input type="text" value="08 October 2022"/>		
Next Inspection:	<input type="text" value="Not Applicable"/>		

Material Risk Score:

Material Risk Band:

Priority Risk Score:

Action:



Material Comments:

M & G Services Ltd

Material Assessment (Photo) Sorted by: Location ID

Site Address:

Client Name:

Project Number:

Location ID:	<input type="text" value="37462"/>	Survey Type:	<input type="text" value="RDS"/>
Location Ref:	<input type="text" value="13"/>	Product Type:	<input type="text" value="Not Applicable"/>
Product:	<input type="text" value="Panel"/>	Damage:	<input type="text" value="Not Applicable"/>
Area:	<input type="text" value="House"/>	Treatment:	<input type="text" value="Not Applicable"/>
Floor:	<input type="text" value="Ground floor"/>	Asbestos Type:	<input type="text" value="Not Applicable"/>
Room:	<input type="text" value="Area 7"/>	Identification:	<input type="text"/>
Surveyor Name:	<input type="text" value="Chris Brailsford"/>	Quantity:	<input type="text"/>
Drawing Ref:	<input type="text"/>		
Asbestos ?	<input type="text" value="No"/>		
Date:	<input type="text" value="08 October 2022"/>		
Next Inspection:	<input type="text" value="Not Applicable"/>		

Material Risk Score:	<input type="text" value="0"/>
Material Risk Band:	<input type="text" value="Not Applicable"/>
Priority Risk Score:	<input type="text" value="N/A"/>

Action:



Material Comments:



M & G Services Ltd

Material Assessment (Photo) Sorted by: Location ID

Site Address:

Client Name:

Project Number:

Location ID:	<input type="text" value="37463"/>	Survey Type:	<input type="text" value="RDS"/>
Location Ref:	<input type="text" value="14"/>	Product Type:	<input type="text" value="Not Applicable"/>
Product:	<input type="text" value="Overview"/>	Damage:	<input type="text" value="Not Applicable"/>
Area:	<input type="text" value="House"/>	Treatment:	<input type="text" value="Not Applicable"/>
Floor:	<input type="text" value="Ground floor"/>	Asbestos Type:	<input type="text" value="Not Applicable"/>
Room:	<input type="text" value="Area 7"/>	Identification:	<input type="text"/>
Surveyor Name:	<input type="text" value="Chris Brailsford"/>	Quantity:	<input type="text"/>
Drawing Ref:	<input type="text"/>		
Asbestos ?	<input type="text" value="No"/>		
Date:	<input type="text" value="08 October 2022"/>		
Next Inspection:	<input type="text" value="Not Applicable"/>		

Material Risk Score:

Material Risk Band:

Priority Risk Score:

Action:



Material Comments:

M & G Services Ltd

Material Assessment (Photo) Sorted by: Location ID

Site Address:

Client Name:

Project Number:

Location ID:	<input type="text" value="37464"/>	Survey Type:	<input type="text" value="RDS"/>
Location Ref:	<input type="text" value="15"/>	Product Type:	<input type="text"/>
Product:	<input type="text" value="Overview"/>	Damage:	<input type="text"/>
Area:	<input type="text" value="House"/>	Treatment:	<input type="text"/>
Floor:	<input type="text" value="External"/>	Asbestos Type:	<input type="text"/>
Room:	<input type="text" value="External"/>	Identification:	<input type="text"/>
Surveyor Name:	<input type="text" value="Chris Brailsford"/>	Quantity:	<input type="text"/>
Drawing Ref:	<input type="text"/>		
Asbestos ?	<input type="text" value="Yes"/>		
Date:	<input type="text" value="08 October 2022"/>		
Next Inspection:	<input type="text" value="08 October 2023"/>		

Material Risk Score:

Material Risk Band:

Priority Risk Score:

Action:



Material Comments:

SECTION TEN

SURVEY DRAWINGS

1st Floor

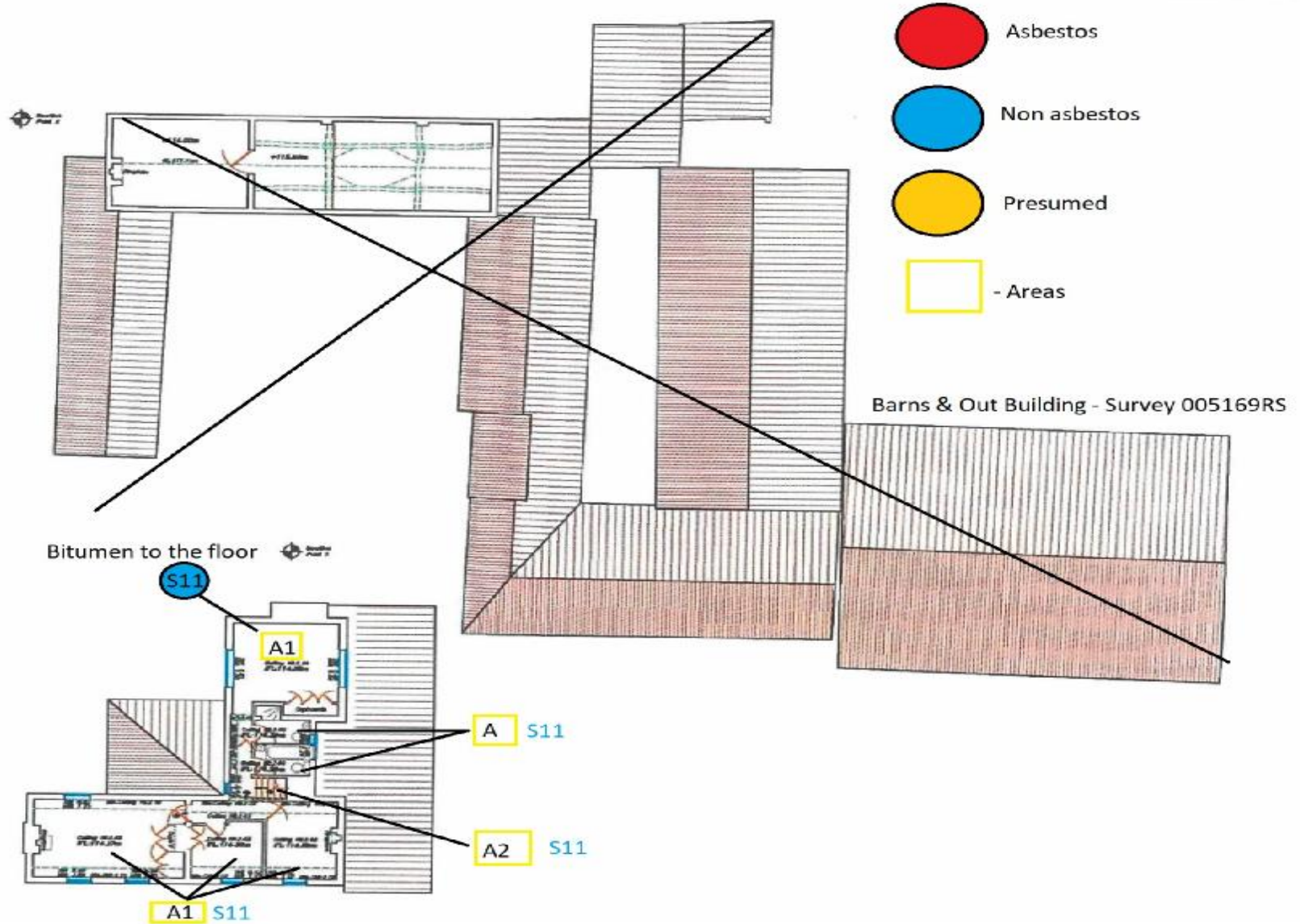

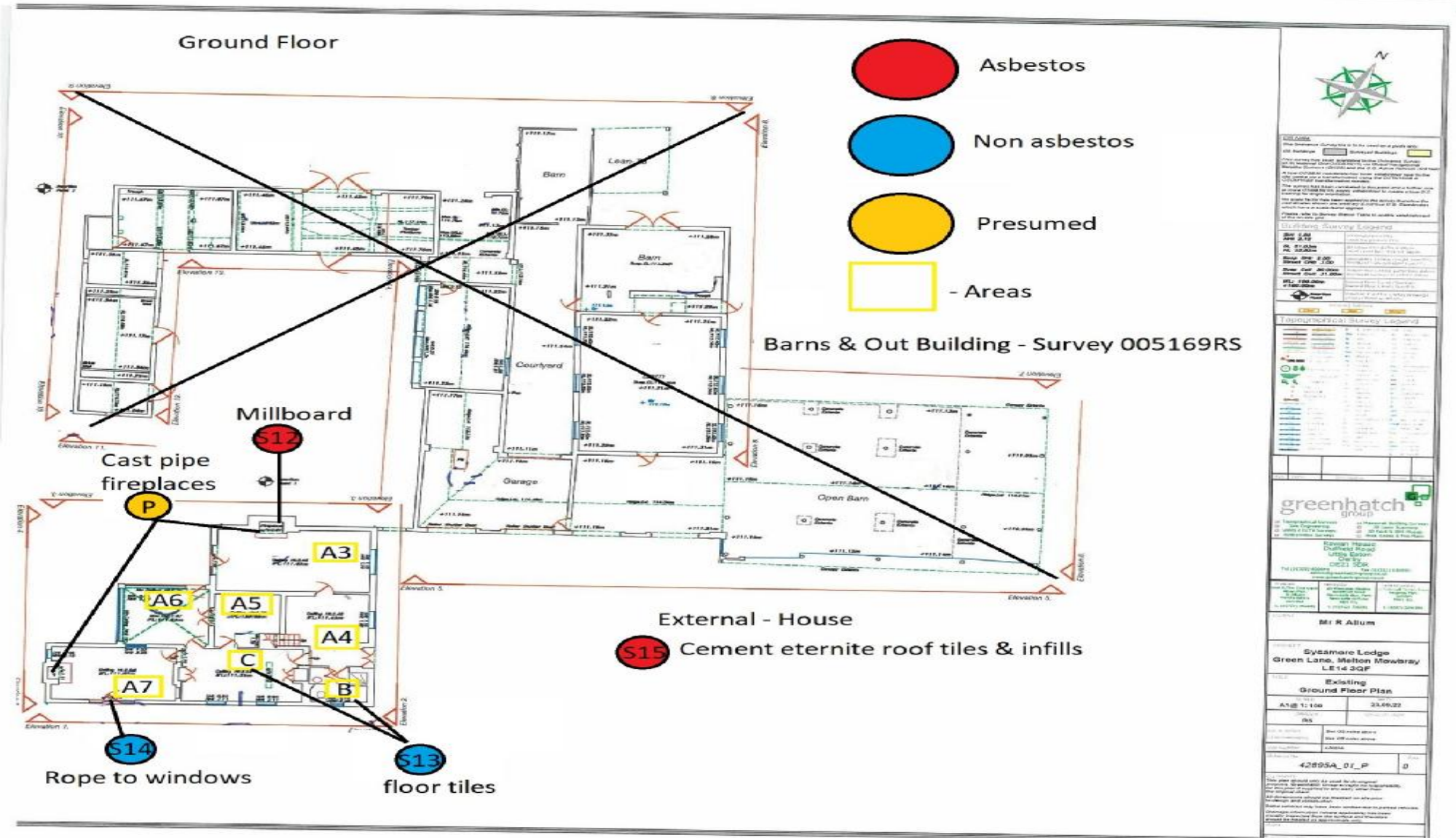

Survey Drawings and Documentation

Project Number: 005170RS

- Non Asbestos
- Asbestos
- Presumed
- Areas

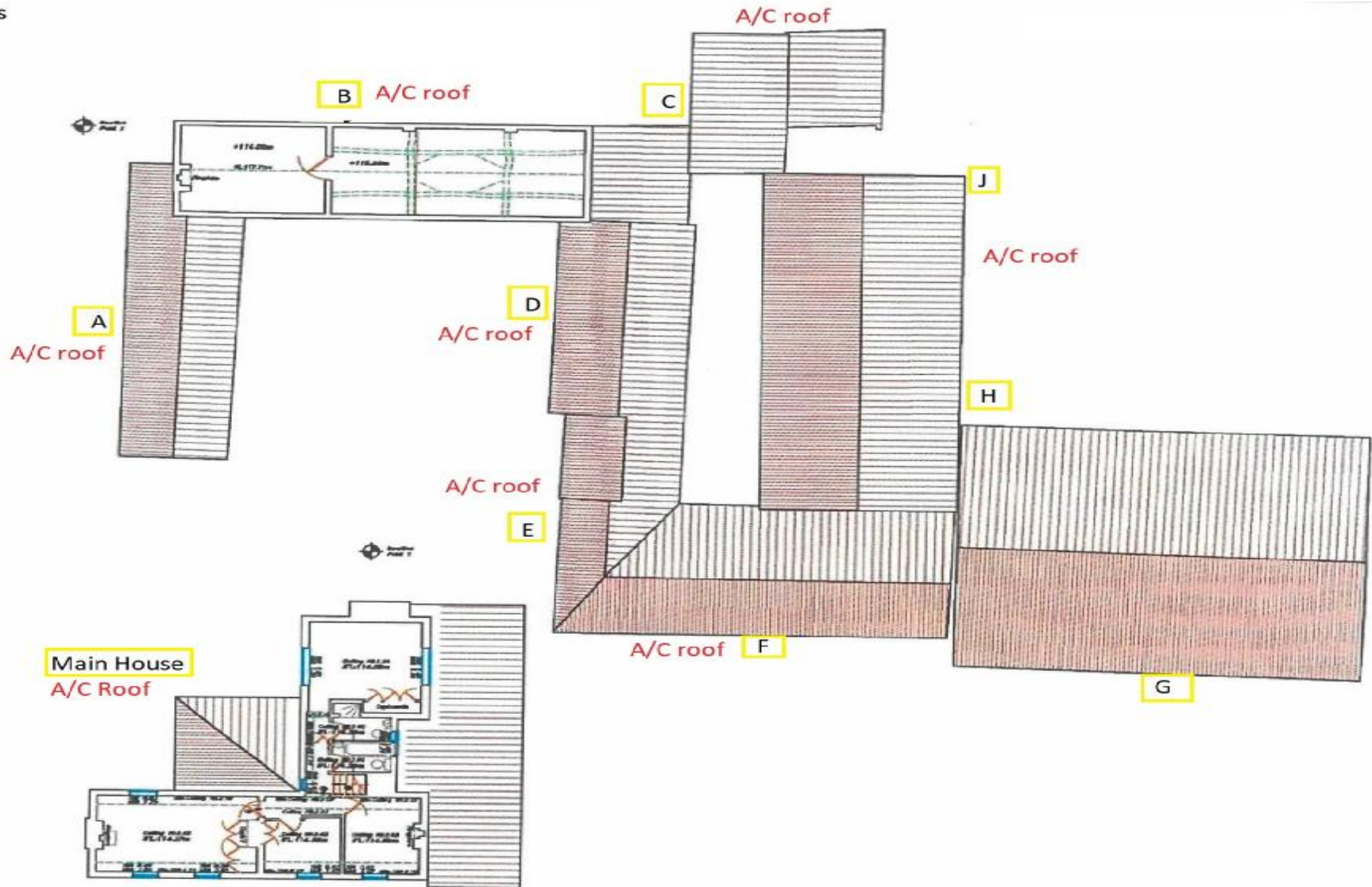

SECTION ELEVEN

BULK CERTIFICATE

M & G Services Ltd

Bulk Certificate

Project Number:

005170RS



FOURSTAGE ENVIRONMENTAL LTD.

5A CLAPGUN STREET, CASTLE DONINGTON, DERBY, DE74 2LE
Telephone: 01332 812549 Email: bulks@fourstage.co.uk



2671

CERTIFICATE FOR IDENTIFICATION OF ASBESTOS FIBRES

Client:	M&G Services Ltd	Report Number:	4S-38881-B
Address:	2 Pintail Close Victoria Business Park Netherfield Nottingham NG4 2SG	Report Date:	13/10/2022
Attention:	CP Brailsford	Number of Samples:	5
Site Address:	Sycamore Lodge Green Lane Melton Mowbray	Site Reference/Order No.	TBC
		Sampled By:	Client
		Date Sample Taken:	08/10/2022
		Date Sample Received:	10/10/2022
		Date of Analysis:	13/10/2022

Samples of material, referenced below, have been examined to determine the presence of asbestos fibres, using Fourstage Environmental Limited "in house" method of transmitted/polarized light microscopy and centre stop dispersion staining, based on HSG 248. If the samples have been DELIVERED then the site address and actual sample location and sample type is as given by the client at the time of the delivery. However after analysis the type of material may be changed if the analysis indicates the wrong information was given. Fourstage Environmental Limited is not responsible for the accuracy or competence of the sampling by third parties. Under these circumstances Fourstage Environmental Limited cannot be held responsible for the interpretation of the results shown. Fourstage Environmental Limited does however take responsibility for information reported when a staff member of Fourstage Environmental Limited takes the samples. This report must not be reproduced except in full without the approval of Fourstage Environmental Ltd. Any comments made on this certificate are outside the scope of UKAS accreditation. The results contained within this report relate to the sample as received only. The Asbestos Fibre distribution within the sample analysed will be indicated as Homogeneous (H) Layered (L) or Sporadic (S) ALL samples with No Asbestos Detected will be indicated as Not Applicable (NA)

FOURSTAGE SAMPLE No.	CLIENT SAMPLE NO.	SAMPLE LOCATION	SAMPLE TYPE	(H) (L) (S) (NA)	FIBRE TYPE DETECTED
162888	S11	House. 1 st Floor	Bitumen	NA	No Asbestos Detected
162889	S12	House. A3 Lounge. Fireplace	Millboard	H	Chrysotile Asbestos
162890	S13	House. Ground Floor. W/C	Floor Tile	NA	No Asbestos Detected
162891	S14	House. A7 Sash Window	Rope	NA	No Asbestos Detected
162892	S15	House. Main Roof	Cement	H	Chrysotile Asbestos

Note: All samples will be retained for a minimum of 6 months with the Reports retained for five years.

Analysed By:	M. O'Brien	Authorised Signatory:	
		Print Name:	Marie O'Brien

SECTION TWELVE

SURVEY CAVEAT

Survey Caveat

1 Whilst every effort has been made to identify all asbestos materials, so far as reasonably practical to do so within the scope of the survey and the attached report. Methods used to carry out the survey were agreed with the client prior to any works being commenced.

Survey techniques used involves trained and experienced surveyors using the combined approach with regard to visual examination and necessary bulk sampling. It is always possible after a survey that asbestos based materials of one sort or another may remain in the property or area covered by that survey, this could be due to various reasons:

- Asbestos materials existing within areas not specifically covered by this report are therefore out side the scope of the survey.
- Materials may be hidden or obscured by other items or cover finishes i.e. Paint, over boarding disguising etc. where this is the case then its detection will be impaired.
- Asbestos may well be hidden as part of the structure to a building and not visible until the structure is dismantled at a later date.
- Debris from previous asbestos removal projects may well be present in some areas ;general asbestos debris does not form part of this survey however all good intentions are made for its discovery.
- When an area has been previously stripped for asbestos i.e. plant rooms, duct etc .and new coverings added, it must be pointed out that asbestos removal techniques have improved steadily over the years since its introduction. Most notably would be the Control of Asbestos Regulations (1987) revised in 2012, laying down certain enforceable guidelines. Asbestos removal prior to this regulation would not be of today's standard and therefore debris may be present below new coverings.
- This survey will detail all areas accessed and all samples taken, where an area is not covered by this survey it will be due to No access, it may have been necessary for the limits of the surveyor's authority to be confirmed prior to the survey.
- Access for the survey may be restricted for any reasons beyond our control such as height, inconvenience to others immovable obstacles or confined space. where electrical equipment is present and presumed in the way of the survey no access will be attempted until proof of its safe state is given. Our operatives have duty of care under the health and safety at work act (1974) for both themselves and others.
- In the building where asbestos has been located and it is clear that not all areas have been investigated, any material that is found to be suspicious and not detailed as part of the survey should be treated with caution and sampled accordingly.
- Certain materials contain asbestos to varying degrees and some may be less densely contaminated at certain locations (artex for example), where this is the case sample taken may not be representative of the whole product through out.
- Where a survey is carried out under the guidance of the owner of the property, or his representative, then the survey will be as per his instructions and guidance at that time.
- M & G Services Ltd cannot be held responsible for any damage caused as part of this survey carried out on your behalf. Due to the nature and necessity of sampling for asbestos some danger is unavoidable and will be limited to just that necessary for the taking of the sample.

Client Name:	Roy Allum	Project Number:	005170RS
		Survey Date:	08 October 2022
Site Address:	House, Sycamore Lodge, Green Lane, Melton Mowbray, LE14-3QF	Printed On:	17 October 2022
		Survey Caveat:	Page 1 of 1