

HISTORIC BUILDING ASSESSMENT With Phasing Plans

For

ROSEMARY COTTAGE, SIDLESHAM, WEST SUSSEX



Plate I: Sidlesham Quay
(c.1960)



Affiliates: Richard Meynell Dip Arch (Portsmouth) Conservation Architect
Tom Hayes BSC Hons. RICS
Kirsty Huxtable MA Cantab
www.meynellhayes.com

Meynell Hayes Ltd is a limited company registered as the Companies Registry of England & Wales. Reg No: 14090880



PHASING OF HISTORIC DEVELOPMENT

Ground Floor Plan

Fronting onto Mill Lane, the tidal main road through the settlement, Rosemary cottage sits amongst a pretty mixture of houses old and new leading to Sidlesham Quay, the site of a Medieval New Town. Several buildings along the street including The Crab and Lobster date from the second half of the 18th century, a time when the hamlet was still an active commercial port.



The principal Elevation of Rosemary Cottage comprises Flemish bond brickwork and both gauged segmental and flat arches. Six panel door and sliding sashes with pointed panes and simple mouldings. The façade is believed to be largely original and is typical of modest late Georgian construction.

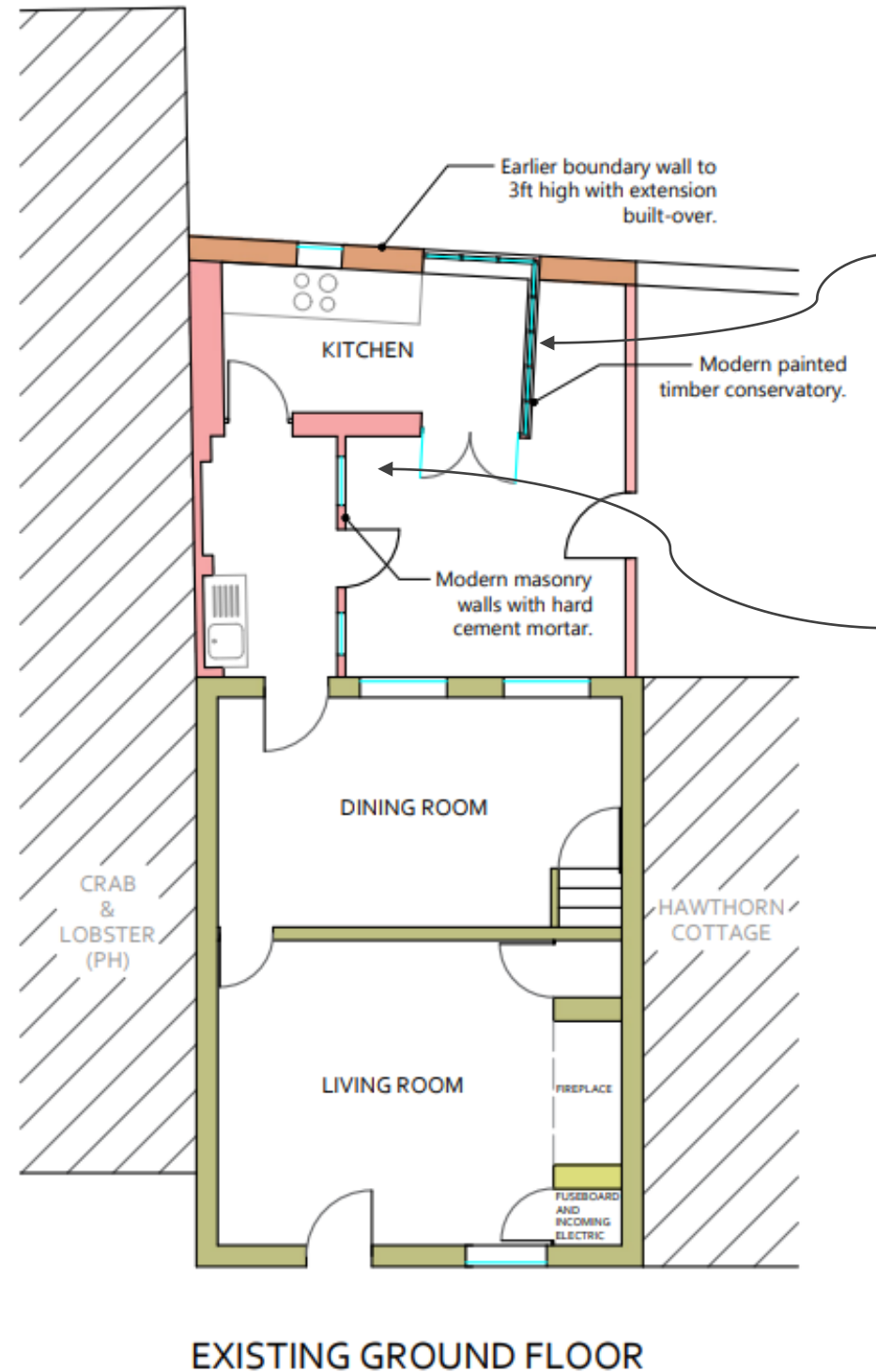

Poorly constructed modern conservatory



Modern brickwork and flintwork with cement mortar and external joinery. Modern concrete courtyard.

- Late C18th - Early C19th Phase
- C19th Phase
- C20th Phase



Date stone to front elevation '1795' in worn condition and in need of stabilisation.



Affiliates: Richard Meynell Dip Arch (Portsmouth) Conservation Architect
 Tom Hayes BSC Hons. RICS
 Kirsty Huxtable MA Cantab
www.meynellhayes.com

Richard Meynell Ltd is a limited company registered as the Companies Registry of England & Wales. Reg No: 06178887



PHASING OF HISTORIC DEVELOPMENT

First Floor Plan



Attic space with coursed flintwork to gable and primarily modern rafters.



Vertical raised and fielded panelling at the head of the stairs is typical of late C18 or early C19 work.

Ceilings and partition walls at First Floor level are of modern construction including asbestos cement boarding, fibreboard and plywood. The external walls were noted to be damp in many areas.

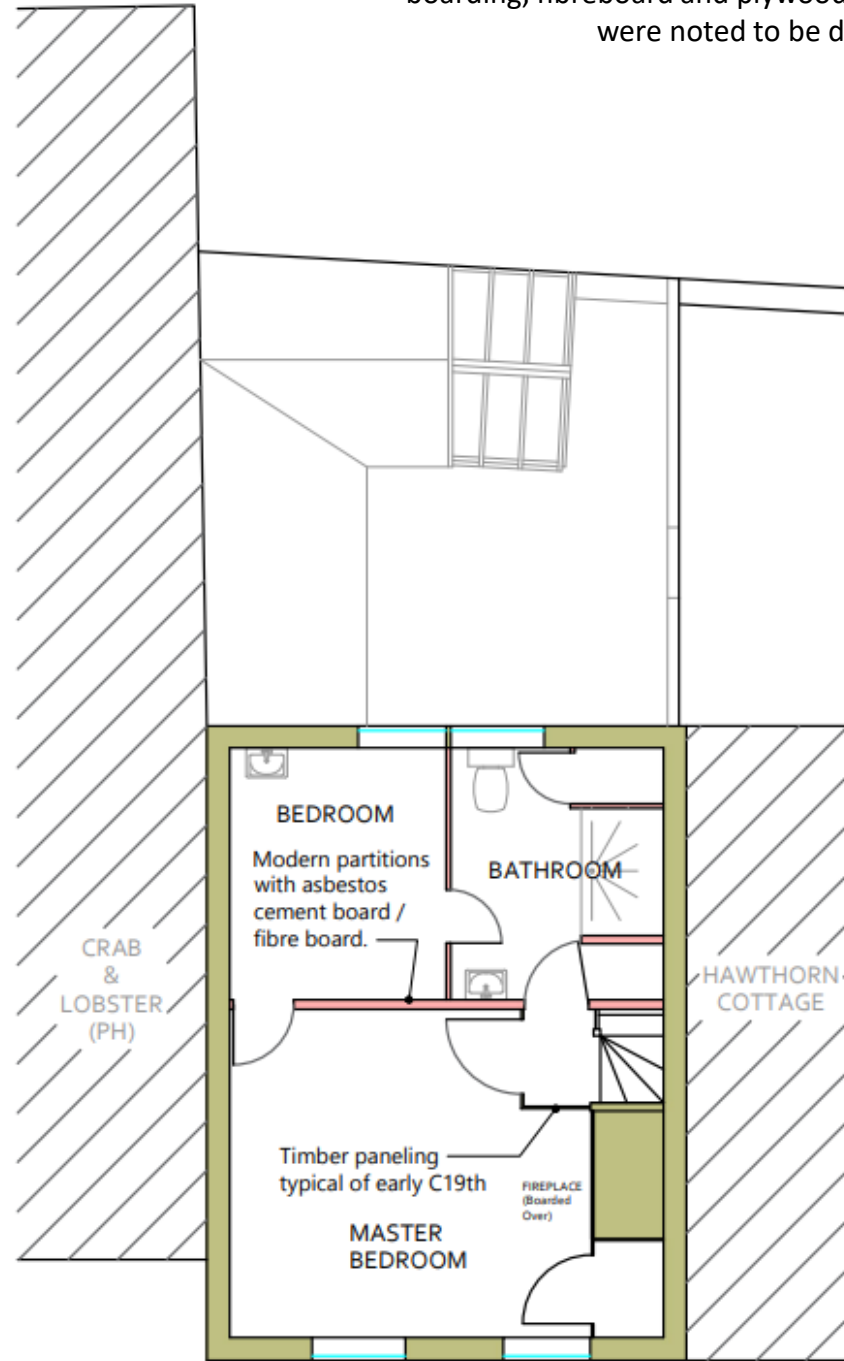

EXISTING FIRST FLOOR



- Late C18th - Early C19th Phase
- C19th Phase
- C20th Phase