

PROPOSED GROUND FLOOR

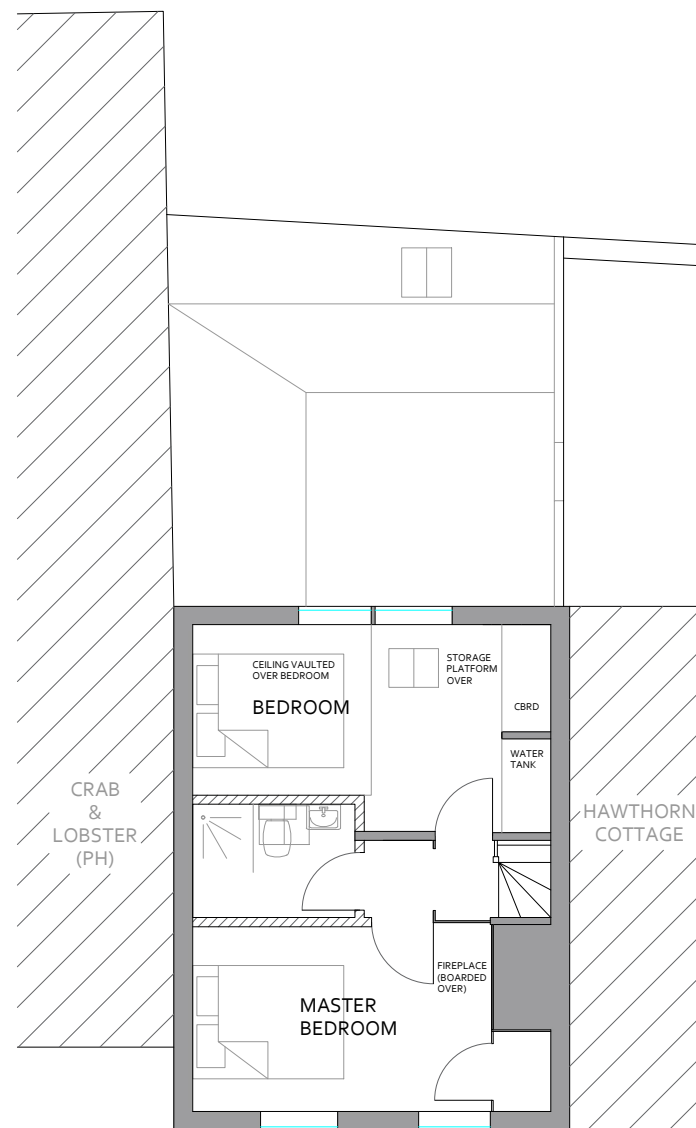

PROPOSED FIRST FLOOR

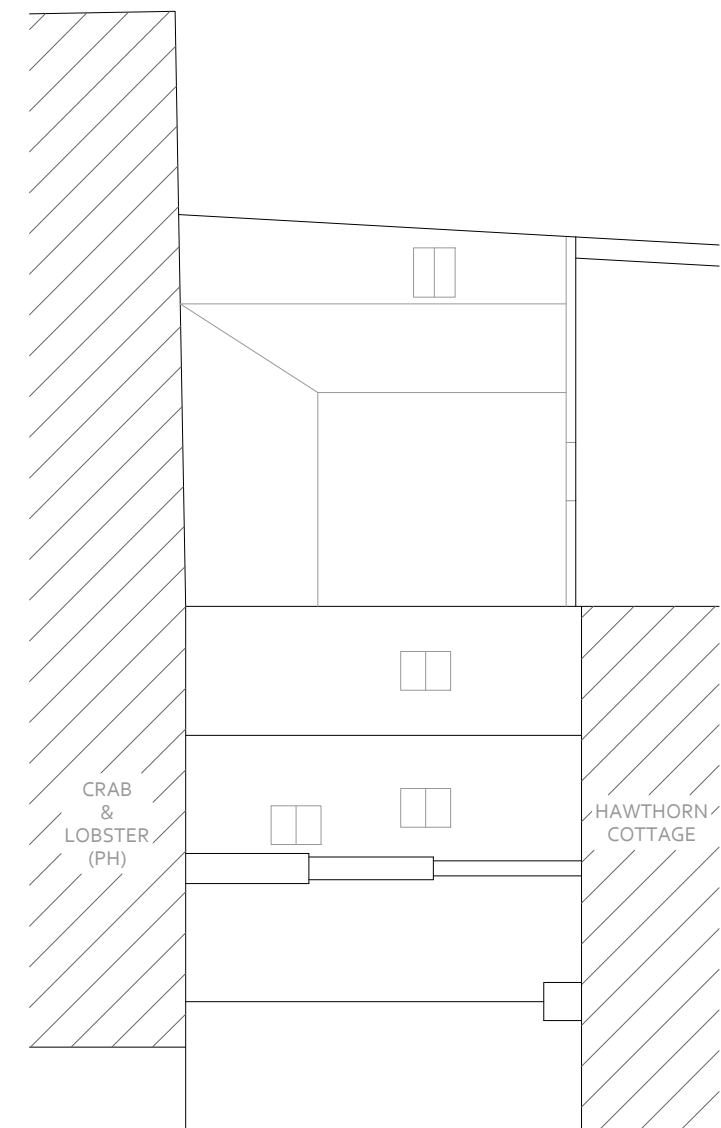

PROPOSED ROOF PLAN

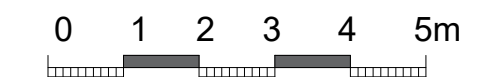

PROPOSED FLOOR PLANS  
1:100 scale @ A3



Meynell Hayes Ltd  
The Woodyard  
Mouthays Lane  
East Ashling, Chichester  
West Sussex  
PO18 8AA  
[www.meynellhayes.com](http://www.meynellhayes.com)

REPLACEMENT SINGLE STOREY REAR EXTENSION, INTERNAL ALTERATIONS,  
SUSTAINABILITY IMPROVEMENTS & CONSERVATION REPAIRS  
to  
ROSEMARY COTTAGE, MILL LANE, SIDLESHAM, W.SUSSEX, PO20 7NB.

|                       |                     |                |                   |
|-----------------------|---------------------|----------------|-------------------|
| Drawing:<br>1205 - 04 | Date:<br>26/06/2023 | Revision:<br>C | Date:<br>23-10-23 |
|-----------------------|---------------------|----------------|-------------------|