

**Proposed Site Section**  
Scale @A1 1:100  
@A3 1:200

**NOTES**

- Default drawing size is A1
- To print at A3 please 'scale by 50%
- Check printed scale against scale bar above

DRAWING DATE: 30/08/2023  
*Sawkings Architects Ltd copyright 2023*  
This drawing must not be reproduced in part or whole without prior written consent. Scale to be checked against scale bar as this drawing has been provided electronically. Check and confirm all dimensions on site prior to commencing work. IF IN DOUBT ASK.

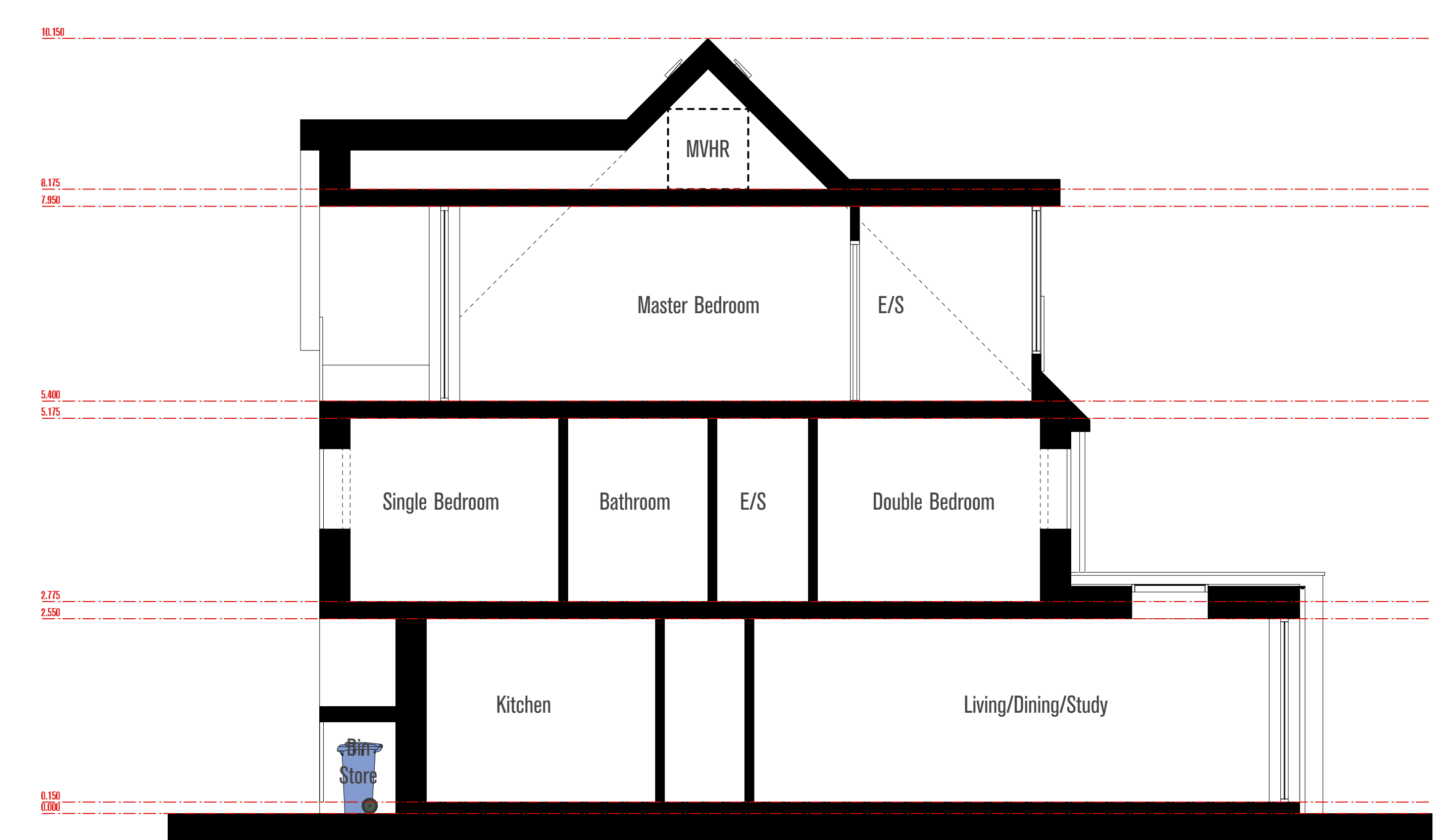
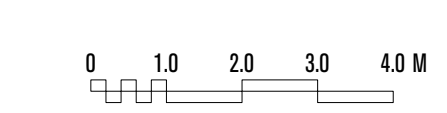

**Proposed Section**  
Scale @A1 1:50  
@A3 1:100

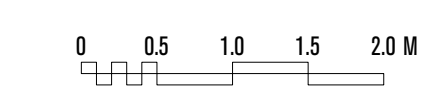

**HAZARDS LEADING TO UNUSUAL OR SIGNIFICANT RISK DURING THE CONSTRUCTION PROCESS ARE IDENTIFIED ON THIS DRAWING AS:**  
SAWKINGS ARCHITECTS SPECIFIC RISKS & HAZARDS:

NOTE: THE LIST ABOVE IDENTIFIES CERTAIN RISKS WHICH ARE DEEMED TO BE UNUSUAL, ABNORMAL OR UNEXPECTED TO A COMPETENT CONTRACTOR CARRYING OUT WORK OF THIS NATURE BUT DOES NOT COVER ALL POSSIBLE SITUATIONS WHICH MAY BE ENCOUNTERED DURING THE CONSTRUCTION PROCESS. IT IS THEREFORE THE MAIN CONTRACTOR'S RESPONSIBILITY TO IDENTIFY ANY FURTHER RISKS/HAZARDS AND TAKE APPROPRIATE ACTION.

REV.	DATE	NOTES
D1	02/06/2023	Draft issue for comment
D4	21/08/2023	Draft issue for comment
P1	30/08/2023	Planning Issue

**PROJECT**  
**Whitehall Works**

**CLIENT**  
Glenn Mullet

Sawkings Architects  
The Box Hill Studio  
1 The Quarry,  
Batchworth,  
Surrey RH3 7BY

**sawkings architects**

T 01737 845580  
E hello@sawkingsarchitects.com  
W www.sawkingsarchitects.com

RIBA Chartered Practice

STATUS	DRAWN BY	CHECKED BY
<b>PLANNING</b>	IL	GMF
JOB NO.	DRAWING NO.	REV
A4560	2300	<b>P1</b>
DRAWING TITLE		
<b>Proposed GA Sections</b>		