

EXISTING GROUND FLOOR PLAN

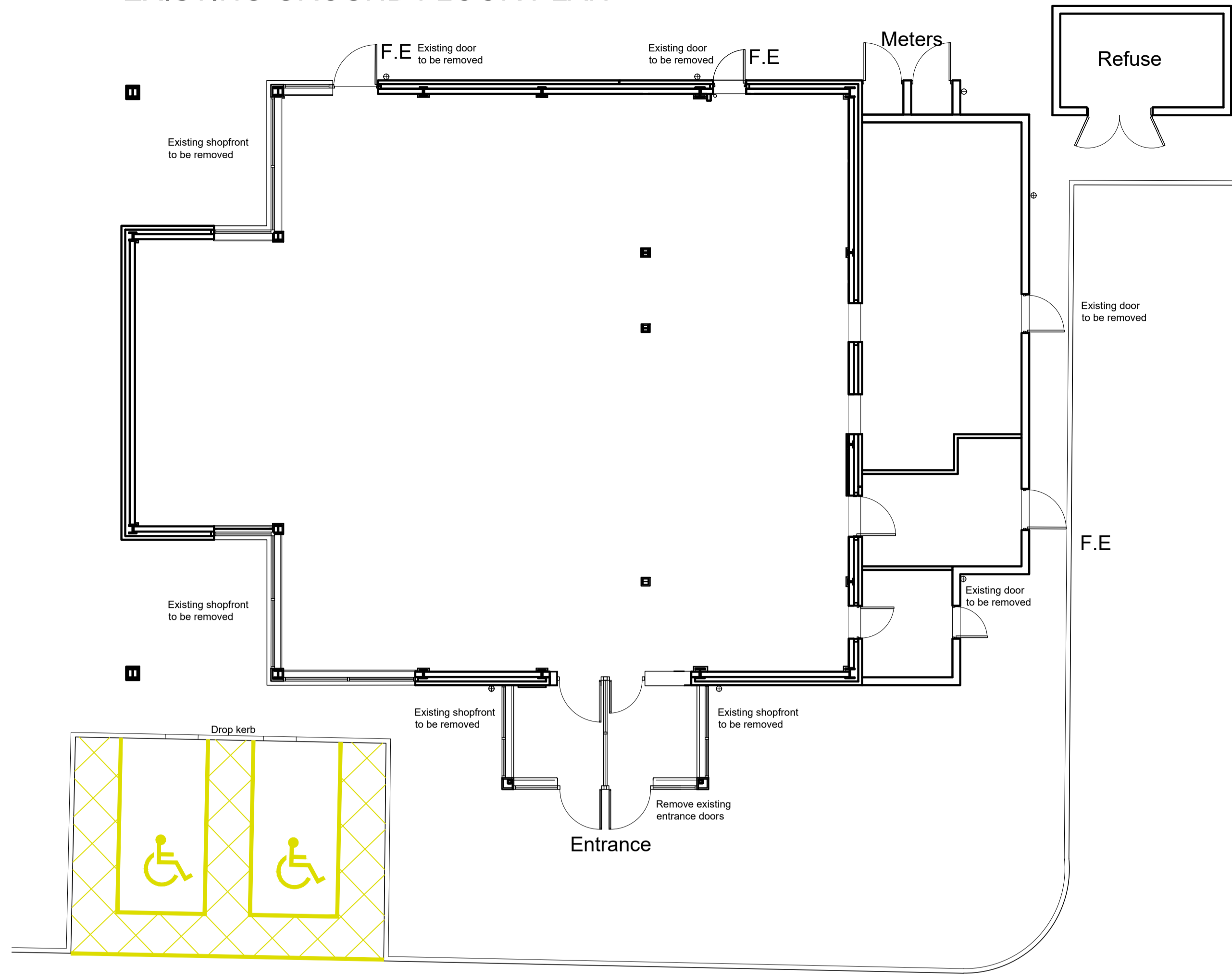

PROPOSED GROUND FLOOR PLAN

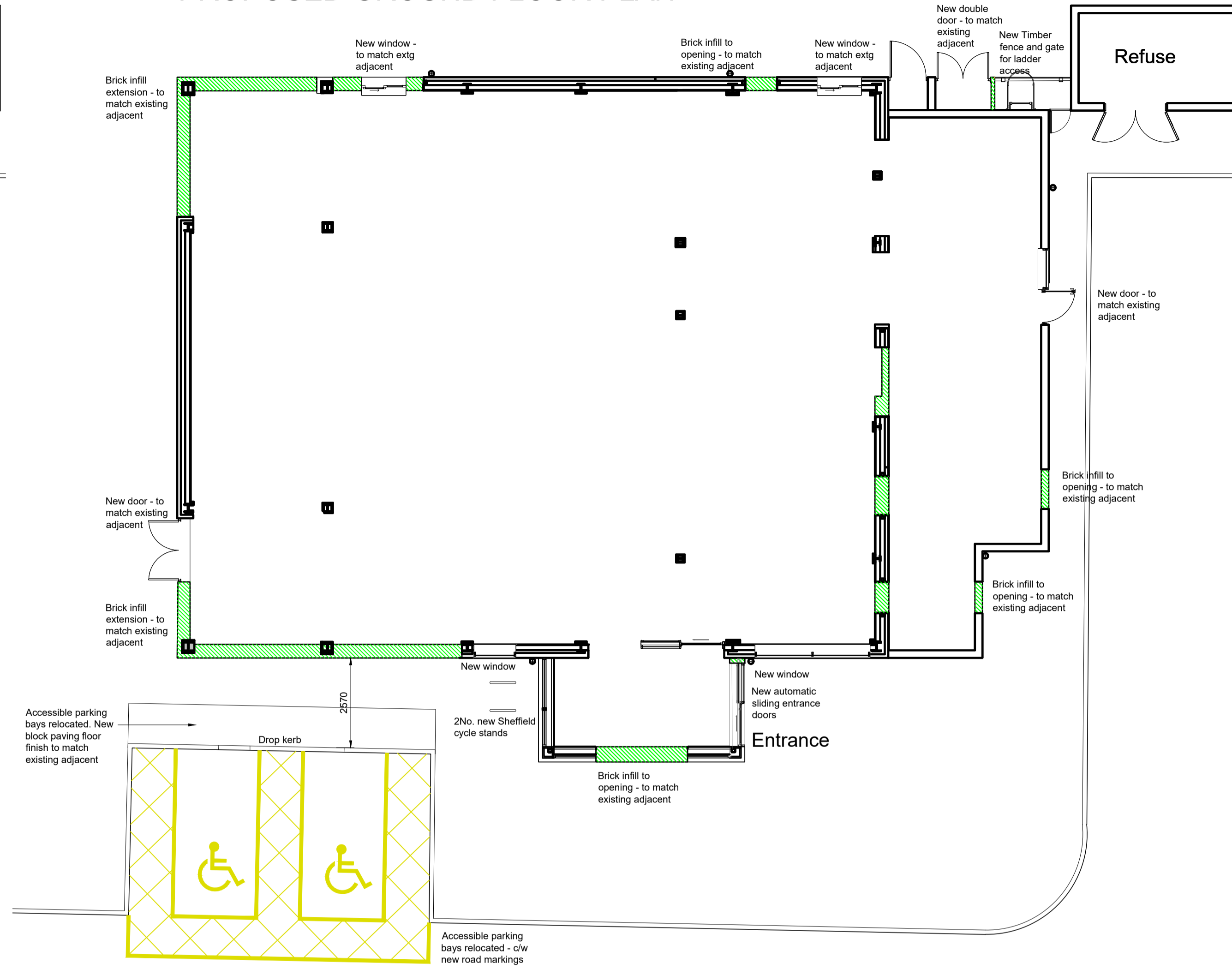

general notes:
 All works are to be undertaken in accordance with the Building Regulations and the latest British Standards.
 All proprietary materials and products are to be used strictly in accordance with the manufacturer's recommendations.
 All dimensions to be checked on site prior to construction.
 All risks assessed to comply with the designers responsibility under the Construction (Design Management) regulations 2015.

Notes:
 All drawings to be read in conjunction with all other drawings as noted on issue sheet

Areas Schedule	Existing	Proposed
GIA (Approximate m ²)	359	388
GEA (Approximate m ²)	394	426

EXISTING ROOF PLAN

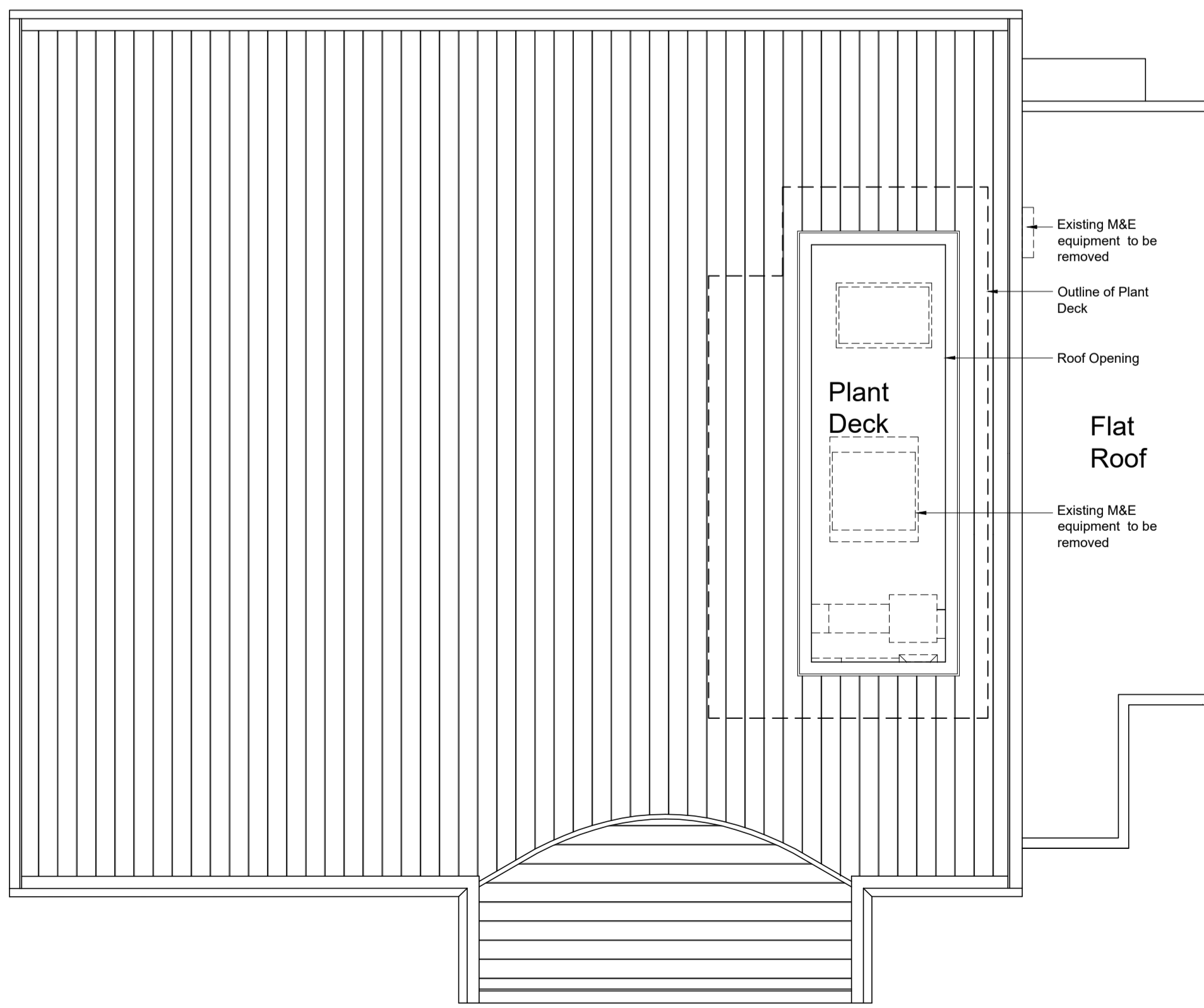

PROPOSED ROOF PLAN

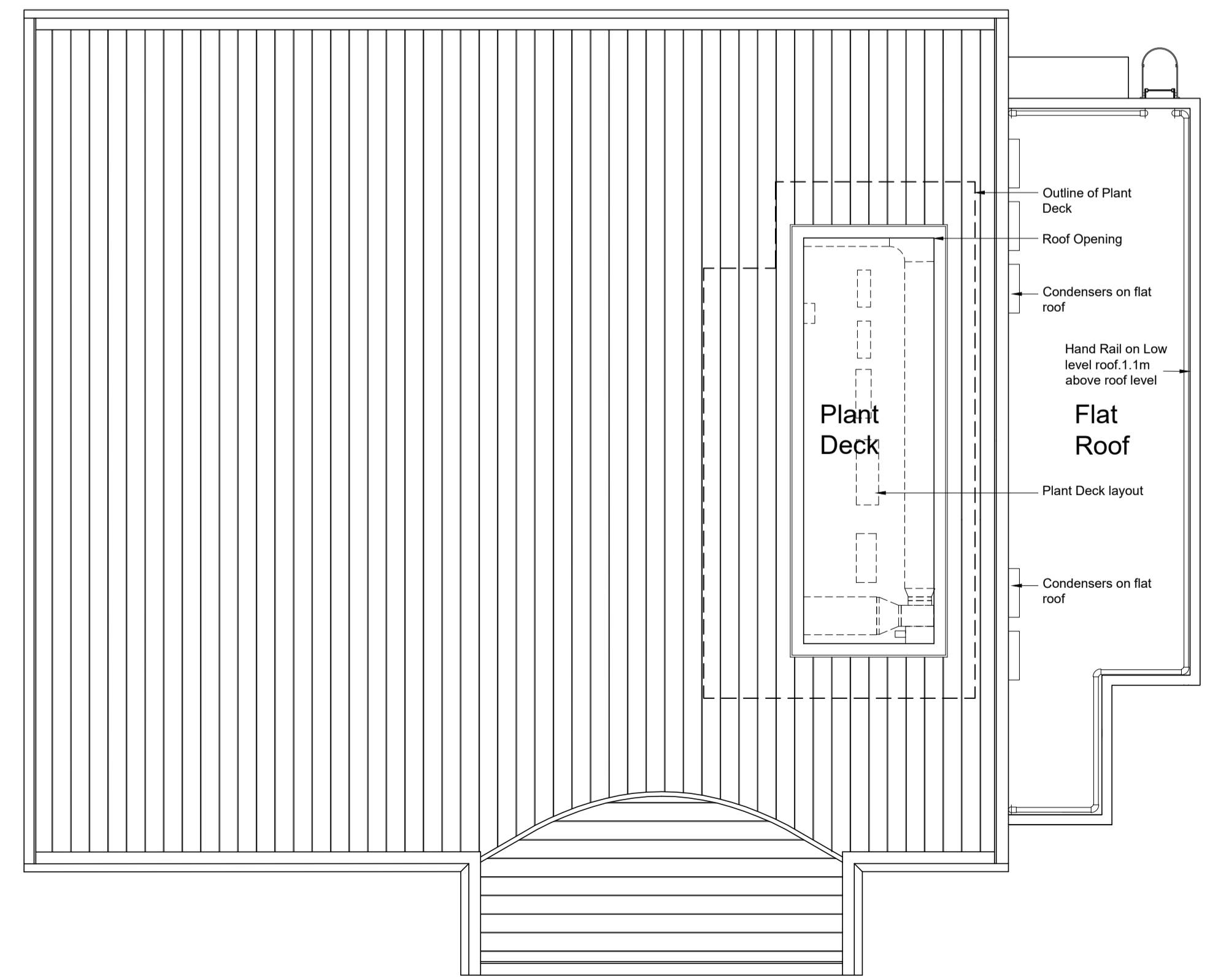

rev:	revision notes:	by:	date:
E	Existing Roof Plan added. Cycle stands indicated.	JK	01.11.2023
D	Plant area guarding and access added.	EP	01.07.2023
C	Areas Schedule added. Internal partitions omitted. Roof Plan added and Plant Area & M&E plant / equipment indicated.	JK	08.08.2023
B	Windows added.	MR	17.05.2023
A	Minor amendments.	CM	23.03.2023

Scurr Architects
 85 Southdown Road
 Harpenden
 Hertfordshire
 AL5 1PR
 T: 01582 793999
 email: scurrs@scurr.co.uk
 www.scurr.co.uk

architects designers project managers

drawn by:	drawn date:	checked/approved:	scale:
JK	Feb 23		1:100@A1

project title:
Skegness Retail Park
 Heath Road
 SKEGNESS PE25 3ST

dwg title:
Ground Floor Plan
 Existing & Proposed

dwg no:	rev:
8511-SA-1911-P006	E

© Copyright Scurr Architects

