

Ground Floor Plan as Existing
1 : 50

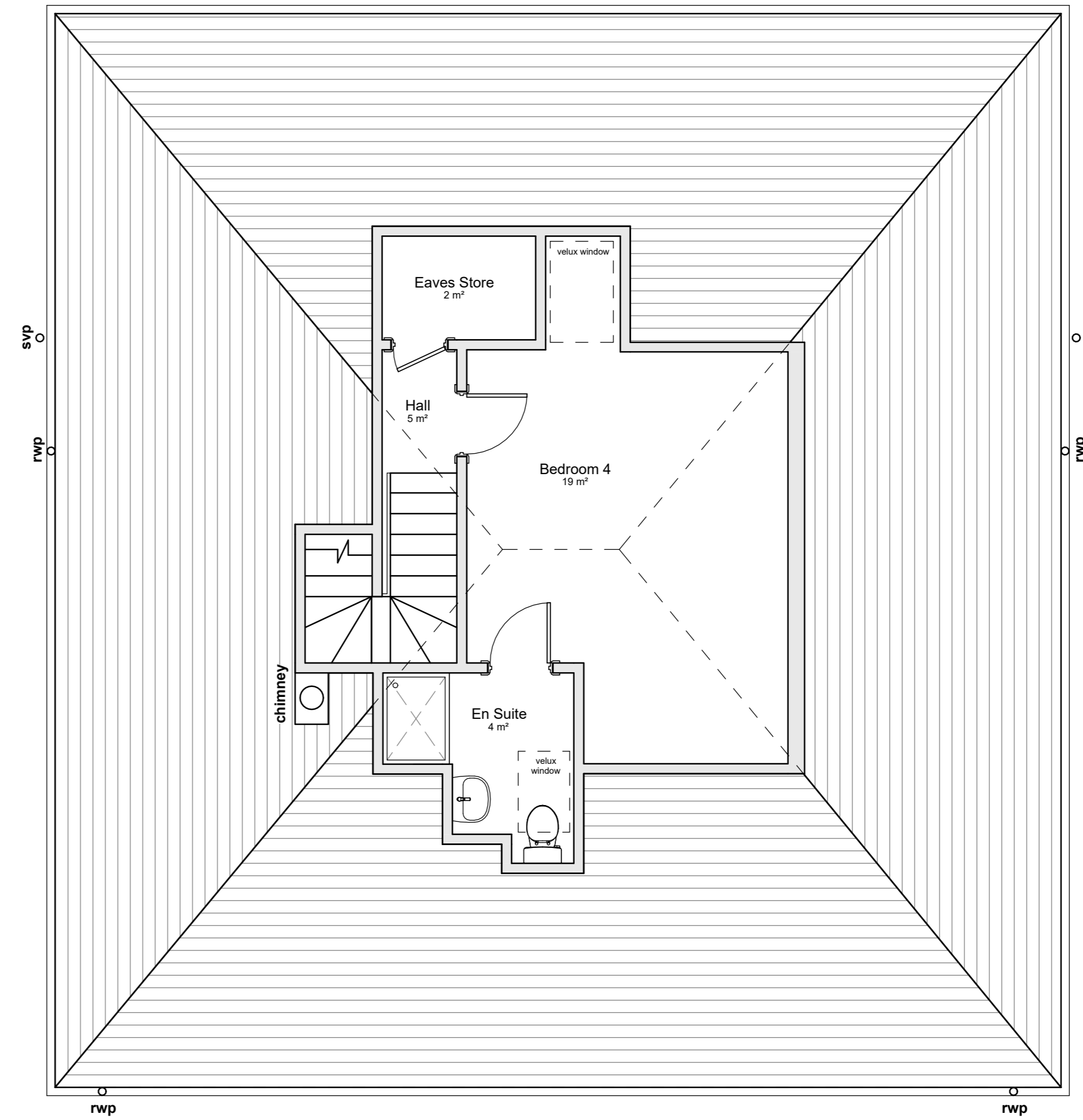

First Floor Plan as Existing
1 : 50

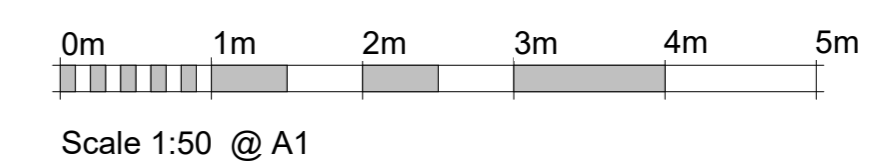

CLIENT
King Enterprises

PROJECT
Dwelling House Conversion to 6 Bedroom HMO
173 Dunnicker Road, Kirkcaldy, Fife, KY2 2AD

DRAWING
Floor Plans as Existing

STATUS
PLANNING

DATE
OCTOBER 2023

DWG NO.
(A23-505)201

SCALE
1 : 50

REV

ALL DRAWINGS HAVE BEEN PREPARED FOR PLANNING AND OR BUILDING WARRANT PURPOSES ONLY.

DRAWINGS ARE **NOT TO BE USED** FOR CONSTRUCTION OR MANUFACTURING PURPOSES AS NO INTRUSIVE INVESTIGATIONS HAS BEEN CARRIED OUT BY D7 ARCHITECTURE LTD. ALL DRAWINGS MUST BE READ IN CONJUNCTION WITH THOSE OF THE STRUCTURAL ENGINEERS WHICH TAKE PRECEDENCE ON ANY STRUCTURAL ITEMS INCLUDING (BUT NOT LIMITED TO) STEEL AND TIMBER MEMBERS AND ALL ASSOCIATED FIXINGS. IF ANY DIMENSIONS OR DETAILS CONFLICT, PLEASE NOTIFY THE D7 ARCHITECTURE LTD IMMEDIATELY.

ALL SIZES TO BE SITE VERIFIED ANY DEVIATIONS TO THE PLANS MUST BE BROUGHT TO THE ATTENTION OF THE CLIENT AND OR D7 ARCHITECTURE LTD IMMEDIATELY.

THIS DRAWING IS PROTECTED BY COPYRIGHT. IT MAY NOT BE REPRODUCED IN ANY FORM OR BY ANY MEANS FOR ANY PURPOSE, WITHOUT GAINING PRIOR WRITTEN PERMISSION FROM D7 ARCHITECTURE LTD

A PRINCIPAL DESIGNER MUST BE APPOINTED SEPARATELY BY THE CLIENT TO ENSURE COMPLIANCE WITH THE CURRENT CONSTRUCTION DESIGN MANAGEMENT REGULATIONS.

