

NOTES  
 CONTRACTORS MUST VERIFY ALL DIMENSIONS ON SITE BEFORE COMMENCING ANY WORK ON SHOP DRAWINGS  
 DO NOT SCALE FROM THIS DRAWING  
 RS AT&A COPYRIGHT

- Notes:
1. Do not scale this drawing
  2. All dimensions to be verified on site and any discrepancy reported to the client
  3. This drawing to be read in conjunction with all relevant drawings

owners to serve party wall act notice on owners of adjacent property and obtain written agreement, prior to commencement of any works

client/builder to obtain all planning permission approvals from the relevant authority, commencement of building works prior to the planning & building control approvals is to client/builders own risk

roof lights:  
 final size and position of roof lights to clients requirements

all rainwater gutturing, down pipes locations to be confirmed by architect & not to encroach neighbors property

client/builder to liaise with local water board for any new works on or within the public sewer or drain runs and obtain approval from the local authority prior to commencement of any works

### Proposed Single Storey Rear Extension

REV	AMENDMENT	DATE	CHKD
A	Planning Issue	05.11.23	RS

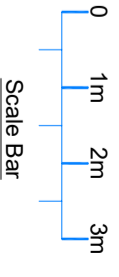

CLIENT  
 Sherine Vasantharaj

PROJECT  
 131 Castle Road  
 Northolt - Middlesex  
 UB5 4SG

DRAWING TITLE  
 Proposed Single Storey Rear Extension  
 Existing & Proposed Floor Layouts  
 Sheet 1

SCALE 1:50 @ A1  
 1:100 @ A3  
 DRAWN BY RS  
 CHECKED RS  
 DATE 05.11.23

DRAWING STATUS  
 Planning Issue

DRAWING NUMBER  
 2023 - 144 - 01  
 REVISION  
 A

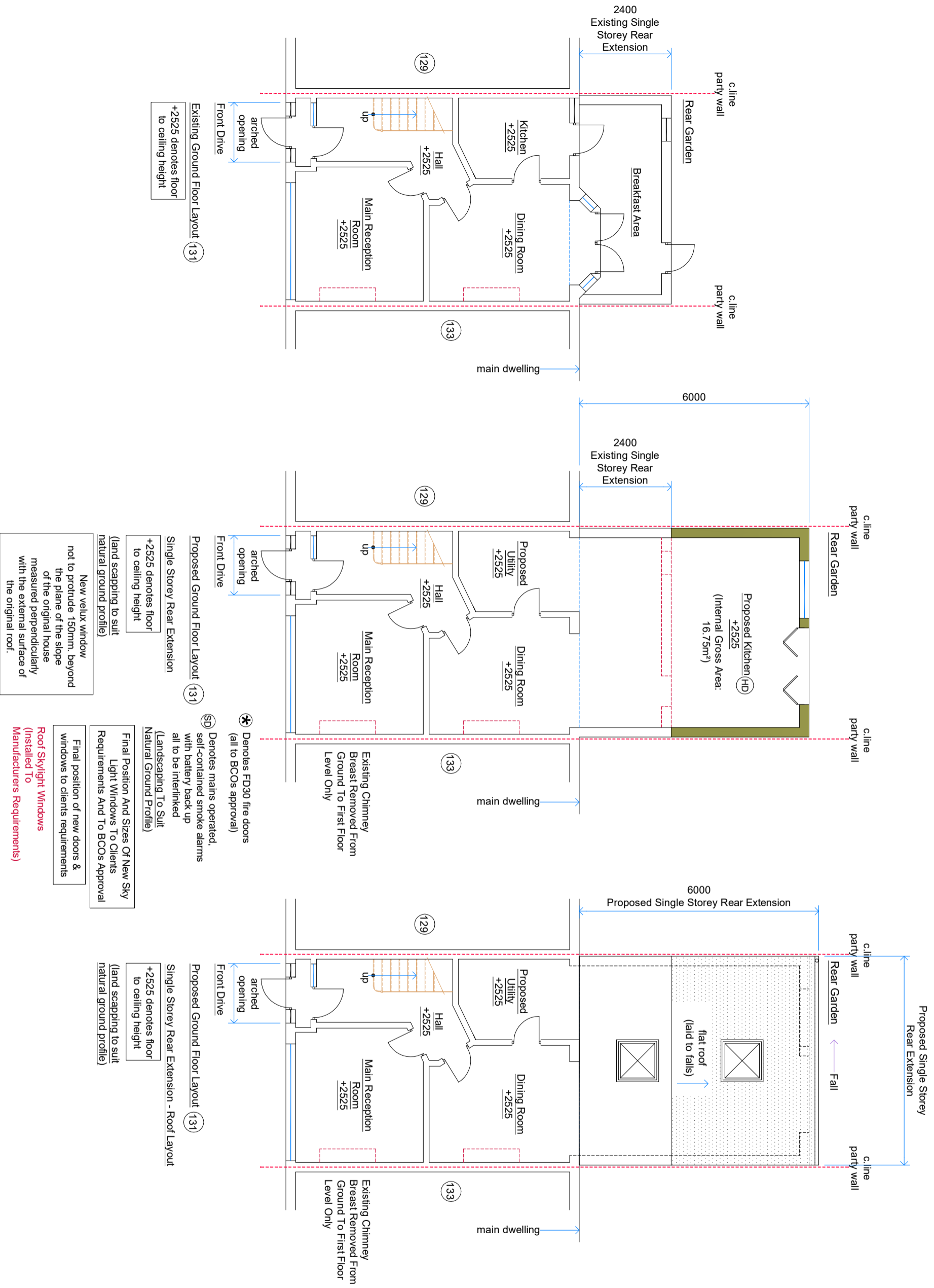

- ⊛ Denotes FD30 fire doors (all to BCOs approval)
- ⊙ Denotes mains operated, self-contained smoke alarms with battery back up all to be interlinked (Landscaping To Suit Natural Ground Profile)
- Final Position And Sizes Of New Sky Light Windows To Clients Requirements And To BCOs Approval
- Final position of new doors & windows to clients requirements
- Roof Skylight Windows (Installed To Manufacturers Requirements)**
- New velux window not to protrude 150mm, beyond the plane of the slope of the original house measured perpendicularly with the external surface of the original roof.