

Construction (Design and Management) Regulations
 Design risk assessments are carried out throughout the design stage of this project in accordance with company procedures and manuals. Where reasonably possible all areas of risk applicable to design and end use of the construction have been identified and then eliminated, mitigated or recorded as a residual risk. Note the general risk of which a competent designer or contractor should be aware are not included. This drawing is to be used in conjunction with the Pre-construction Information and all related documents prepared in accordance with the current Construction (Design and Management) Regulations 2015 and all applicable Health and Safety legislation as currently amended.

GENERAL NOTES

All dimensions to be checked on site and any discrepancies to be reported to the site manager/ architect. Ensure works are completed in a safe and timely manner. Area of works to be thoroughly cleaned, tidied and made good on completion, prior to handover.
 Lawray Architects are not responsible for discrepancies in the measurements shown for existing structure.

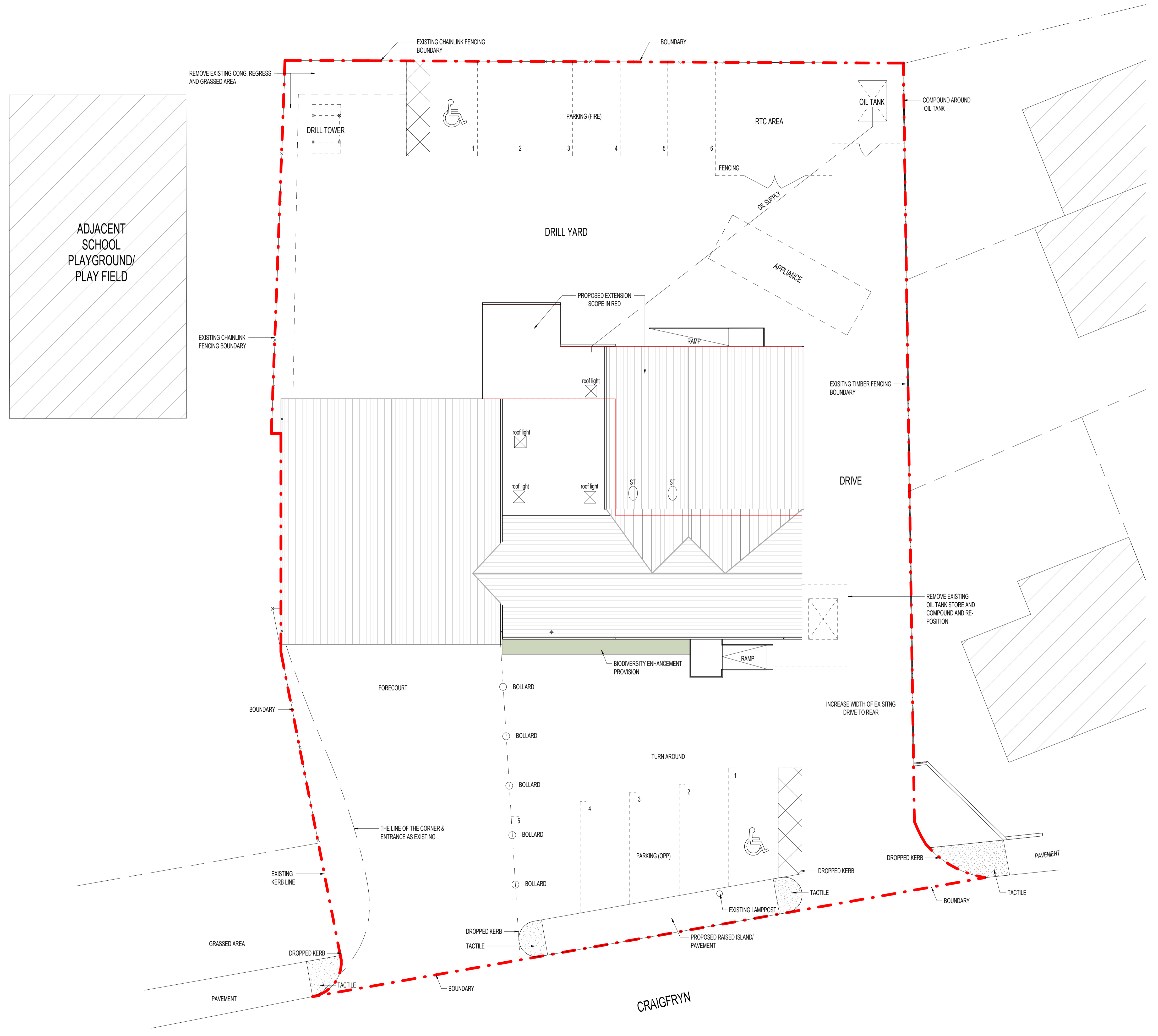

Proposed Site Plan
 1: 100

P2 - Revised Issue A A J RE	24/10/2023
P1 - Initial Input and Issue A A J RE	07/09/2023
REV. DESCRIPTION DRAWN BY CHECKED BY APPROVED BY DATE	
RIBA PLAN OF WORK WORKSTAGE	LEVEL OF MODEL DEFINITION (LOD)
Stage 4 - Technical Design	LOD 4b - Coordinated Model
PURPOSE OF ISSUE - SUITABLE FOR...	BIM STATUS or SUITABILITY
Information	Status D1 - Costing



CARDIFF 029 2052 8140
 LONDON 0207 138 3560
 WREXHAM 01978 357 887
 www.lawray.co.uk
 CLIENT
 MAWWFIRE

PROJECT TITLE
 Machynlleth Fire Station

DRAWING TITLE
 PROPOSED SITE PLAN

PROJECT No 19658	SCALE @ A1 1: 100
DRAWING No 19658-01	REVISION
19658-01	1
19658-02	2
19658-03	3
19658-04	4
19658-05	5
19658-06	6
19658-07	7
19658-08	8
19658-09	9
19658-10	10
19658-11	11
19658-12	12
19658-13	13
19658-14	14
19658-15	15
19658-16	16
19658-17	17
19658-18	18
19658-19	19
19658-20	20
19658-21	21
19658-22	22
19658-23	23
19658-24	24
19658-25	25
19658-26	26
19658-27	27
19658-28	28
19658-29	29
19658-30	30
19658-31	31
19658-32	32
19658-33	33
19658-34	34
19658-35	35
19658-36	36
19658-37	37
19658-38	38
19658-39	39
19658-40	40
19658-41	41
19658-42	42
19658-43	43
19658-44	44
19658-45	45
19658-46	46
19658-47	47
19658-48	48
19658-49	49
19658-50	50
19658-51	51
19658-52	52
19658-53	53
19658-54	54
19658-55	55
19658-56	56
19658-57	57
19658-58	58
19658-59	59
19658-60	60
19658-61	61
19658-62	62
19658-63	63
19658-64	64
19658-65	65
19658-66	66
19658-67	67
19658-68	68
19658-69	69
19658-70	70
19658-71	71
19658-72	72
19658-73	73
19658-74	74
19658-75	75
19658-76	76
19658-77	77
19658-78	78
19658-79	79
19658-80	80
19658-81	81
19658-82	82
19658-83	83
19658-84	84
19658-85	85
19658-86	86
19658-87	87
19658-88	88
19658-89	89
19658-90	90
19658-91	91
19658-92	92
19658-93	93
19658-94	94
19658-95	95
19658-96	96
19658-97	97
19658-98	98
19658-99	99
19658-100	100

DO NOT SCALE
 Any discrepancy or query concerning this drawing should be referred to the Architect
 Copyright © LAWRAY LIMITED
 Registered Office: Greenmeadow Springs, 1 Cae Gwynedd, Trefyniwl, Cardiff CF15 7AB
 Reg. Co. No. 2724178. VAT Reg. No. 134 2148 06.