

NOTES

1. This drawing is to be read in conjunction with all relevant Architects and Engineers details and the Specification.
2. Concrete for padstones to be grade 30.
3. Steelwork to be grade S355.
4. All steelwork to be shot blasted to Swedish Standard SA21/2 and primed with zinc phosphate primer to a d.f.t of 75 microns.

Rev	Date	Amendments	By	Chkd
A	Aug. 2023	Drawing updated.	A O	

Client:-

Project:-
386 WHITEFOOT LANE BR1 SSF

Drawing Title:-

VIEW A

Scale:- 1:30

Drawn	A.O.	Job No.	Drg No.
Date	MAR. 2023	202308	6-A
Checked			

ADE OGUNRINDE & ASSOCIATES
Consulting Structural Engineers

185 HAZELBANK ROAD CATFORD, SE6 1LU
TEL.: 0203 802 1324
Mobile: 07530 005 622
E-mail: aogunrinde@aol.com

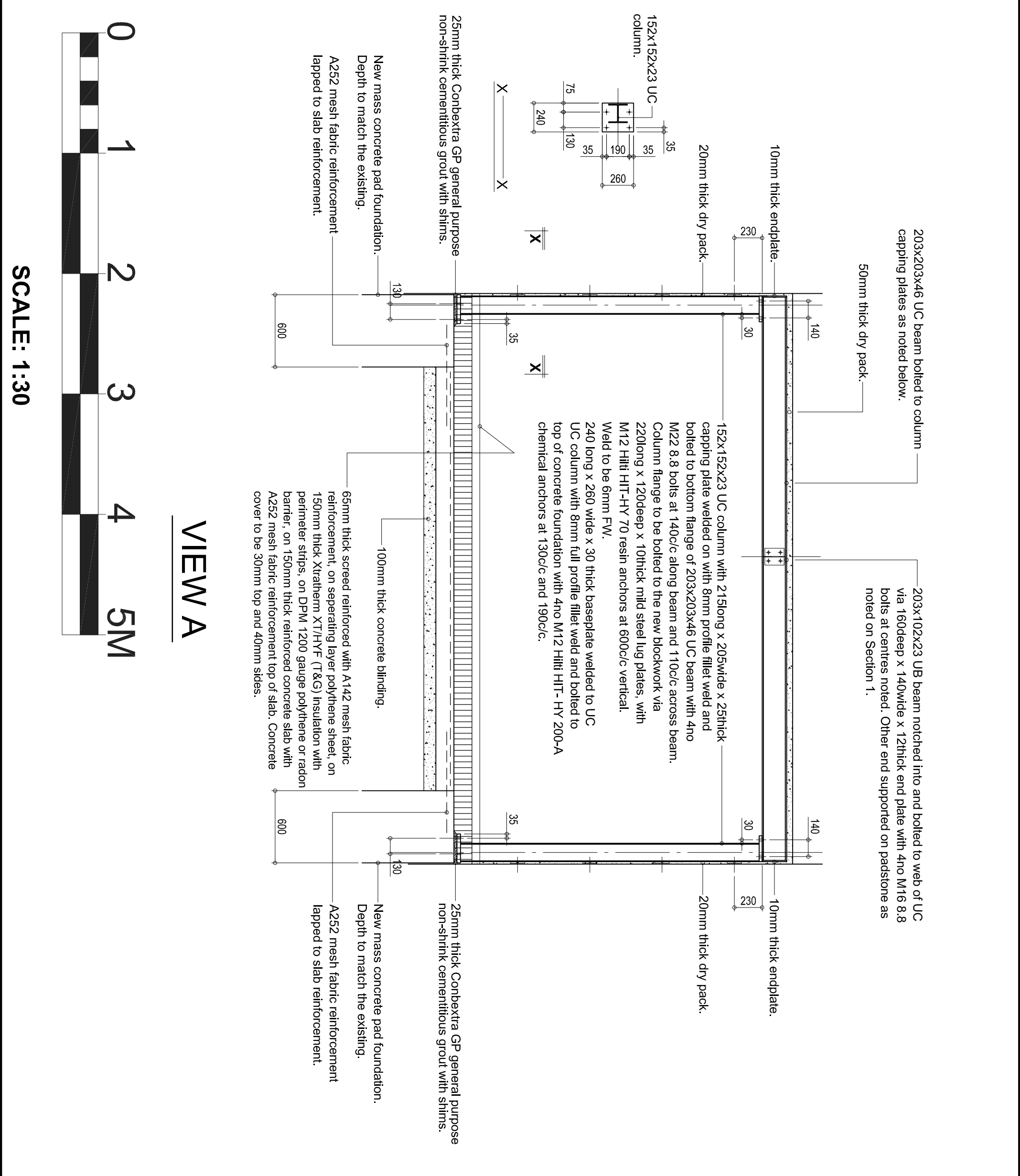

VIEW A

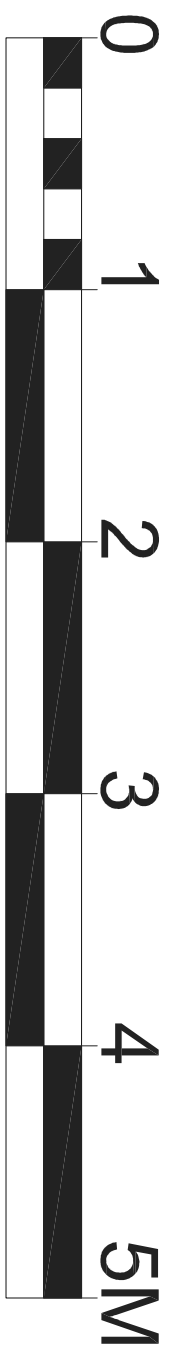

SCALE: 1:30