

# MERSTONE VALLEY

## LANDSCAPE TREE PLANTING PROPOSALS:

### Hedgerows:

#### H1.

New hedgerows to the north and east of the site with the following species.

Mixed native species `countryside` hedgerow:

- Hawthorn *Crataegus monogyna*
- Blackthorn *Prunus spinosa*
- Spindleberry Bush *Euronymus europeaus*
- Common Dogwood *Cornus sanguinea*
- Dog Rose *Rosa canina*

Size: `Whips` 60- 90cm.

Spacing: Double staggered row 50cm centers - 5 plants per metre.

Bare rooted or root plugs.

#### H2

- Beech - *Fagus Sylvatica*.

Size: `Whips` 60- 90cm.

Spacing: Double staggered row 50cm centers - 5 plants per metre.

Bare rooted or root plugs.

### Small Trees:

Plan Identification	Species	Amount
<b>FM</b>	Field Maple <i>Acer campestre</i>	3
<b>HAZ</b>	Hazel <i>Corylus Avellana</i>	4
<b>HB</b>	Hornbeam <i>Carpinus betulus</i>	2
<b>EO</b>	English Oak <i>Quercus robur</i>	3
<b>CA</b>	Crab Apple <i>Malus sylvestris</i>	2
<b>DA</b>	Damson <i>Prunus domestica subsp insititia</i>	2

Size – Feathered tree 1.5 - 1.8 m high

Bare rooted or container grown.

## Specimen Trees:

Plan Identification	Species	Amount
A	Red Horse Chestnut <i>Aesculus x Carnea</i>	2
B	English Oak <i>Quercus robur</i>	2
C	Silver Birch <i>Betula pendula</i>	3
D	Swedish Whitebeam <i>Sorbus intermedia</i>	2
E	Mountain Ash <i>Sorbus aucuparia</i>	2
F	Wild Service Tree <i>Sorbus torminalis</i>	2
G	Strawberry Tree <i>Arbutus unado</i>	3
H	Crab Apple (ornamental) <i>Malus 'Evereste'</i>	2
I	Tree Cotoneaster <i>Cotoneaster cornubia</i>	2

Size – Light Standard. 6-8cm diameter  
Root balled or container grown.

Planting - Throughout the site in plots in the indicative positions as indicated on the Landscape Plan.

## Planting Schedule:

### GENERAL:

1. All plants are to be true to type, pest and disease free and of good shape and form.
2. Trees are to be of sizes already stated and should be well maintained and watered.
3. Any changes to plant species for whatever reason e.g. availability will be first approved by the IoW Council Planning department.

### TIMING:

1. The planting timing shall be carried out in the first planting seasons prior to the occupation of the buildings or the completion of the development.

### SETTING OUT:

1. Trees and hedgerows are to be planted in indicative positions shown in the landscape plan drawing.
2. Shrub positioning will be the landscapers/ contractors responsibility, but in agreement with the owner or site manager.

### PLANTING:

1. Planting areas should be un-compacted and have a good quality top soil.
2. Planting for the hedgerows will be 'notch' or 'T' planting.
3. For the trees a 1m diameter (or more if the container size is greater) planting hole will be excavated and the bottom broken up for better irrigation.
4. Planting should not take place if ground conditions are frozen or periods of hard frost or snow.
5. If planting in a very dry period plants should be well watered in and regular watering carried out until weather conditions improve.

6. A layer of composted bark chippings is to be used as a mulch covering to an average depth of 75mm for the planting areas.
7. A layer of composted bark / wood chippings is to be used as a mulch covering to an average depth of 75mm and of 50cm radius mulched area around each of the trees planted. The hedgerows will have a 1m wide strip of the mulched area.
8. After planting any damaged or broken parts of plants will be pruned out to suitable growing points.

**STAKEING:**

1. Trees are to be held in place by a twin stake with a cross brace or a prop stake angled towards the prevailing wind direction set at a point just below the first crown branches or at a height no more than 2/5ths the height of the tree planted.
2. The tree to be tied to this using a rubber strap and buffer nailed to the stake or crosspiece
3. For larger specimen trees an underground cable guying system may be used, with an integral underground irrigation system.

**MAINTENANCE:**

1. After planting, a maintenance period of 5 years will be put in place. This may be less if suitable establishment occurs before that time.
2. Planting will be generally weeded if necessary and watered during periods of dry weather or if plants appear to be wilting.
3. After stormy or strong winds plants will be checked for ground firmness and re-firmed in if required. Any damaged or broken parts pruned out.
4. If a tree becomes diseased or dies within their establishment period they shall be replaced with a plant of similar size and species in the first planting season after its demise.
5. Mulch layer will be maintained at the set depth and `topped up` as required.

**Landscaping Plan Showing Proposed Layout**

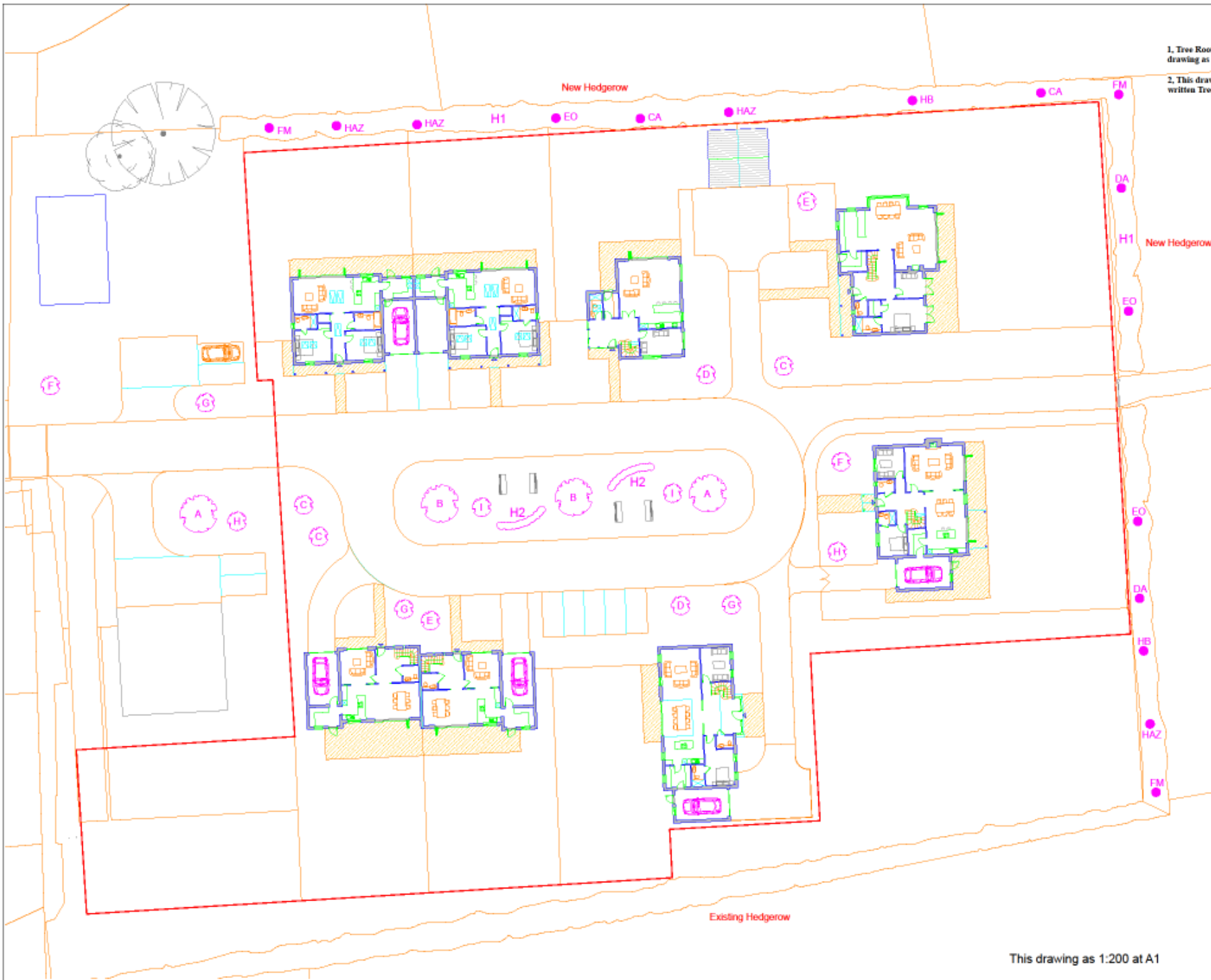

NOTES.

1. Tree Root Protection Areas have been added to survey drawing as supplied.
2. This drawing should be read in conjunction with the written Tree Report and associated Schedules

This drawing as 1:200 at A1

Issue	Amendment	Date
Contractors must verify all Dimensions on site before commencing any works or making any shop drawings.		
 <b>M Jones Arborist IW LTD.</b> <small>The Professional Tree Service for the Isle of Wight</small> <small>Telephone (01983) 520971 Email: <a href="mailto:admin@mjonesarborist.com">admin@mjonesarborist.com</a></small>		
Contract		
Merstone Valley Merstone Isle of Wight		
Title		
LANDSCAPE TREE PLANTING SHOWING EXISTING LAYOUT		
Scale	Draw No	
1:200	TCP/S/01.	
Date	Oct	2023