

Project Title:

Lower Woodhouse Farm

Client:

Mr Mark Roper

Address:

Lower Woodhouse Farm
Fernhill, Almondsbury,
Bristol, BS32 4LU

Revisions:

Ref. Date. Revision.

Drawing status:

PLANNING

NOTES:

This drawing is copyright of David James Ltd and must not be reproduced in whole or in part without written permission.

The contractor is to check and verify all building and site dimensions, levels, services and invert levels at connection points before work commences.

Use only figured dimensions and any discrepancies to be reported immediately to author.

This drawing is to be read with and checked against any structural or other specialist drawings.

The contractor is to comply in all respects with current Building Regulations and relevant British Standards / codes of practice whether specifically stated on this drawing or not.

Use of this drawing does not absolve the client from their responsibility under Health and Safety: Construction (Design and management) regulations 2013.

Scale Bars:

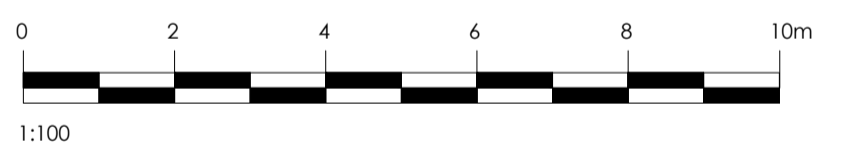

Table with 4 columns: Abbreviations, B, B, dh, dh. Contains various building symbols and their meanings.

Gross Internal Floor Area
Building A: 118.3m²
Building B: 108.8m²

Scales @ A1:
1:100

Drawn By:
IM

Date:
August 2023

Rev:

Drawing No.

71632/01/002

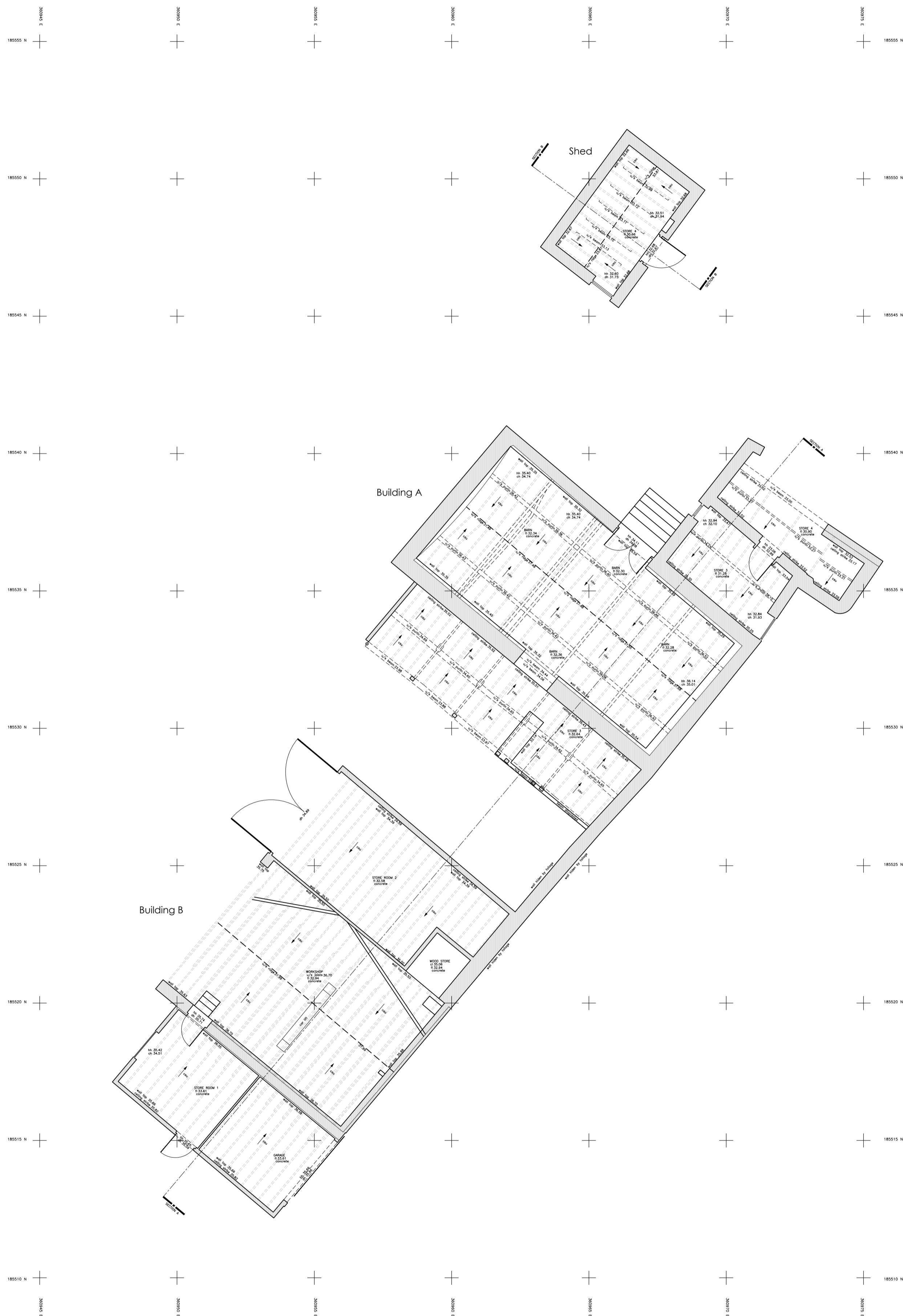

Existing Floor Plan
Scale 1:100