

Existing heating system to be extended into loft.  
Radiators to be fitted with thermostatic release valves.

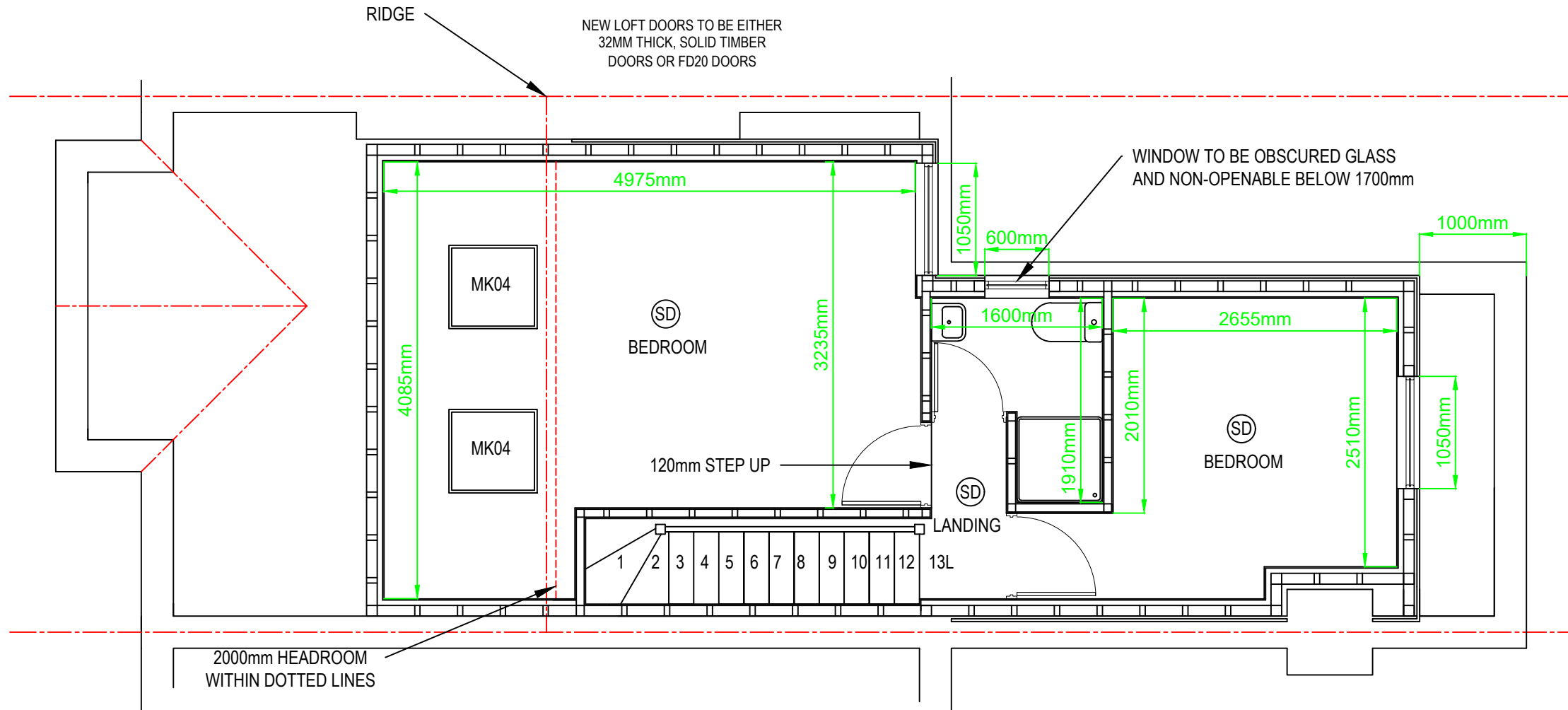

PROPOSED LOFT PLAN



12 Swift Avenue, Finberry,  
Ashford, Kent, TN25 7GD.  
07872 995076.  
theloftdesignstudio@outlook.com

Name:

Address:  
6 PELHAM RD BECKENHAM BR3 4SG

Project:  
LOFT CONVERSION

Date:  
16/10/23

Drawn By:  
RJ

Plan No:  
1606/7

