

Tree and shrub planting plan for 18 Thorn Rd SK71HQ
 Ref number DC/090246
 Planning application number DC/086142
 Planting of new trees and shrubs to take place between 01.04.2024 and 31.05.2024.
 This is to avoid winter frost and should ensure the trees and shrubs can become established.
 Planting plan and schedule below.

PLANTING SCHEDULE

AZ:	AZALEA EVERGREEN	1m x 1m
C:	CAMELLIA EVERGREEN	1m x 50cm
D:	DAPHNE EVERGREEN	50 x 50cm
EXO:	EXOCORDIA NIAGRA EVERGREEN	1.5m x 1.5m
HS:	HALIMIOCISTOS SAHUGI EVERGREEN	1.2 x 80cm
HY:	HYDRANGIA	
L:	LAVENDER EVERGREEN	60 x 60cm
P:	PITTOSPORUM EVERGREEN	60 x 60cm
ROWAN:	SORBUS AUTUMN SPIRE	4m x 1m

- (A) BLACK TARMAC
- (B) GREY STONE SETT EDGING
- (C) ACO DRAIN

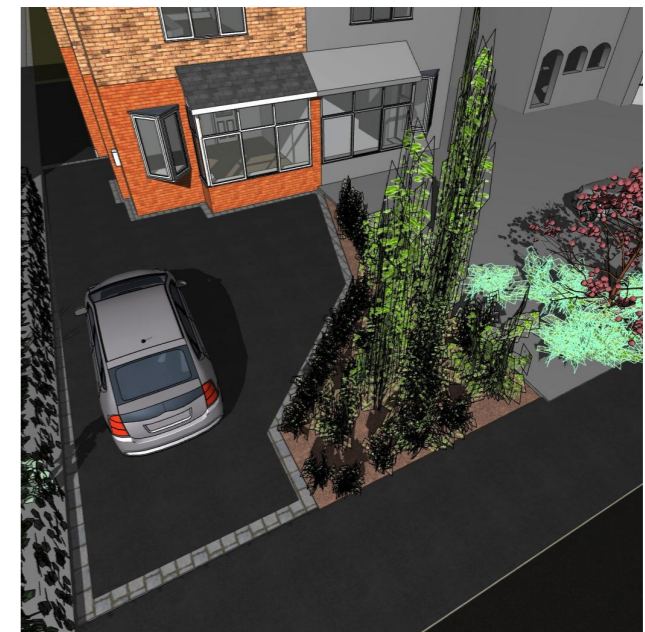

Reference number DC/090246

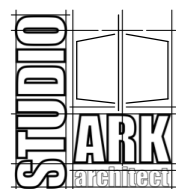

STUDIO ARK (Architect)
 15 MAYWOOD
 113 GRAVEL LANE
 WILMSLOW
 CHESHIRE
 SK9 6LZ
 07846029109
 studio.ark@yahoo.com

© STUDIO ARK (Architect)

Project
**Extension and refurbishment of
 18 Thorn Road, Bramhall, SK7 1HQ**
 Site Plan (Proposed)

Client
R and S Webster
 18 Thorn Road, Bramhall
 SK7 1HQ

Drawing Number
22-DR-RSW18TRB-CD-03-A
 Scale @ A3
 1:50, 1:443.31
 Date
 21/06/2023

Revision

Drawing Status
Planning Application