

All the information reflected in this document is the property of Ellis Healey Architects and is confidential. It is not to be used, copied, reproduced, disseminated, or otherwise made available to any third party without the prior written consent of Ellis Healey Architects.

**Cycle parking**

Proprietary galvanised steel cycle hoops are to be installed, where indicated. Broxap 'Sheffield Extra' or similar. Bike shelters shall be Droxap 'New Sheffield'. Hoops and shelters are to be installed in accordance with the manufacturer's instructions cast into appropriate concrete footings.

**Fencing**

The site shall be fenced to the extent indicated on the plans. The fence shall be 2000mm high paladin type proprietary weld mesh panels with posts at approximately 3m centres - to suit the panel length - cast into concrete bases. All metal components shall be galvanneal and powder coated black.

An electrically operated sliding gate shall be installed to the entrance of the site. The track and operation of the gate shall suit the entrance width and installed in full accordance with the manufacturer's instructions.

Slab GRN	Technical Specifications
Haunch	24 no. Slabwater stops
6.5m	1 no. Disabled spaces
	3 no. EVCP
	1 no. Cycle parking space
	1 no. Uncovered Cycle Parking Space

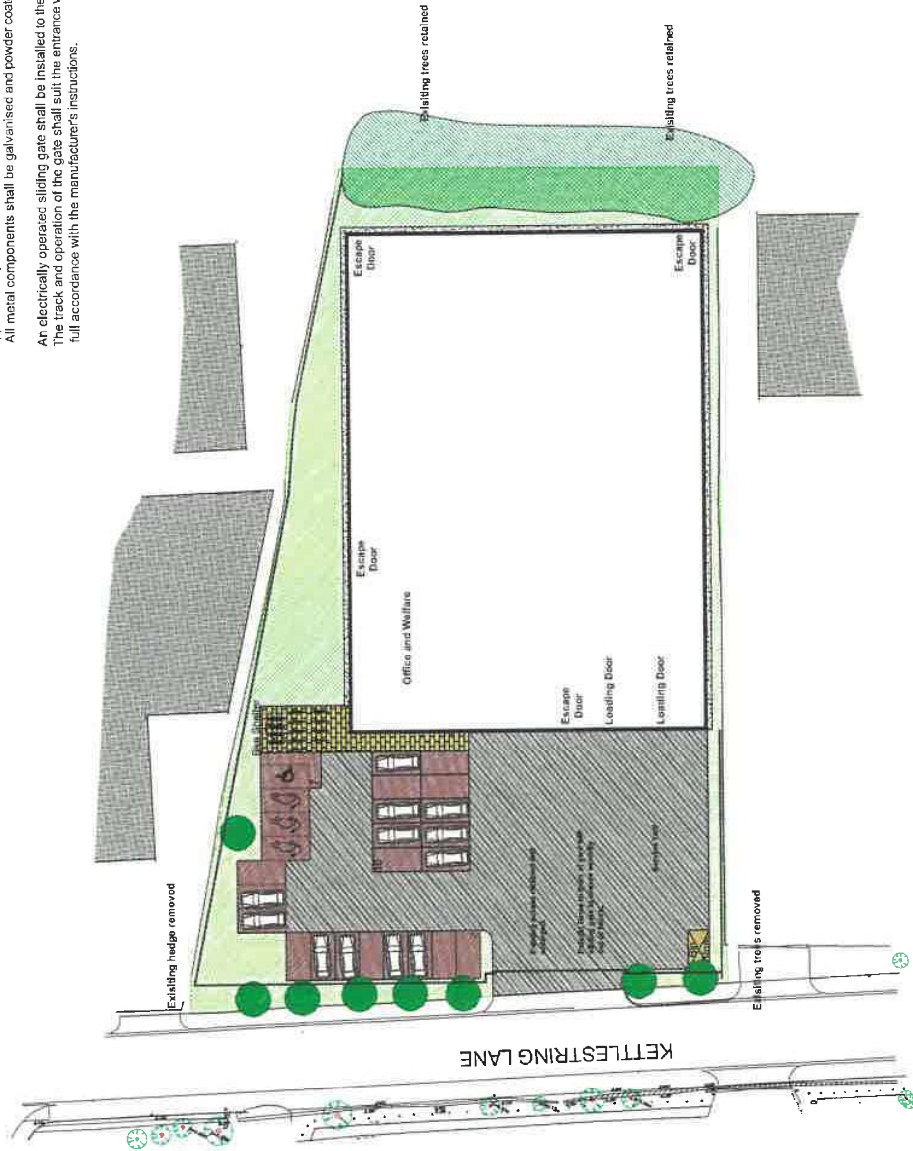

NO.	DATE	BY
001	21.11.2024	SH
002	21.11.2024	SH
003	21.11.2024	SH
004	21.11.2024	SH
005	21.11.2024	SH
006	21.11.2024	SH
007	21.11.2024	SH
008	21.11.2024	SH
009	21.11.2024	SH
010	21.11.2024	SH
011	21.11.2024	SH
012	21.11.2024	SH
013	21.11.2024	SH
014	21.11.2024	SH
015	21.11.2024	SH
016	21.11.2024	SH
017	21.11.2024	SH
018	21.11.2024	SH
019	21.11.2024	SH
020	21.11.2024	SH
021	21.11.2024	SH
022	21.11.2024	SH
023	21.11.2024	SH
024	21.11.2024	SH
025	21.11.2024	SH
026	21.11.2024	SH
027	21.11.2024	SH
028	21.11.2024	SH
029	21.11.2024	SH
030	21.11.2024	SH
031	21.11.2024	SH
032	21.11.2024	SH
033	21.11.2024	SH
034	21.11.2024	SH
035	21.11.2024	SH
036	21.11.2024	SH
037	21.11.2024	SH
038	21.11.2024	SH
039	21.11.2024	SH
040	21.11.2024	SH
041	21.11.2024	SH
042	21.11.2024	SH
043	21.11.2024	SH
044	21.11.2024	SH
045	21.11.2024	SH
046	21.11.2024	SH
047	21.11.2024	SH
048	21.11.2024	SH
049	21.11.2024	SH
050	21.11.2024	SH

**ellis healey**  
architecture

**PLANNING**

PROPOSED DEVELOPMENT  
FOR THE PROPOSED SITE  
FOR THE PROPOSED DEVELOPMENT

NO. 100  
PROPOSED SITE PLAN

DATE: 18.01.2024

PROJECT: 2024

NO. 100

100