

Drawing #1

Size G/A	Haunch	Technical Considerations
20,000 sq ft (1858 sq m)	6.5m	21 no. Standard spaces 3 no. EVCP 9 no. Covered Cycle parking spaces 10 no. Increased Cycle Parking Spaces

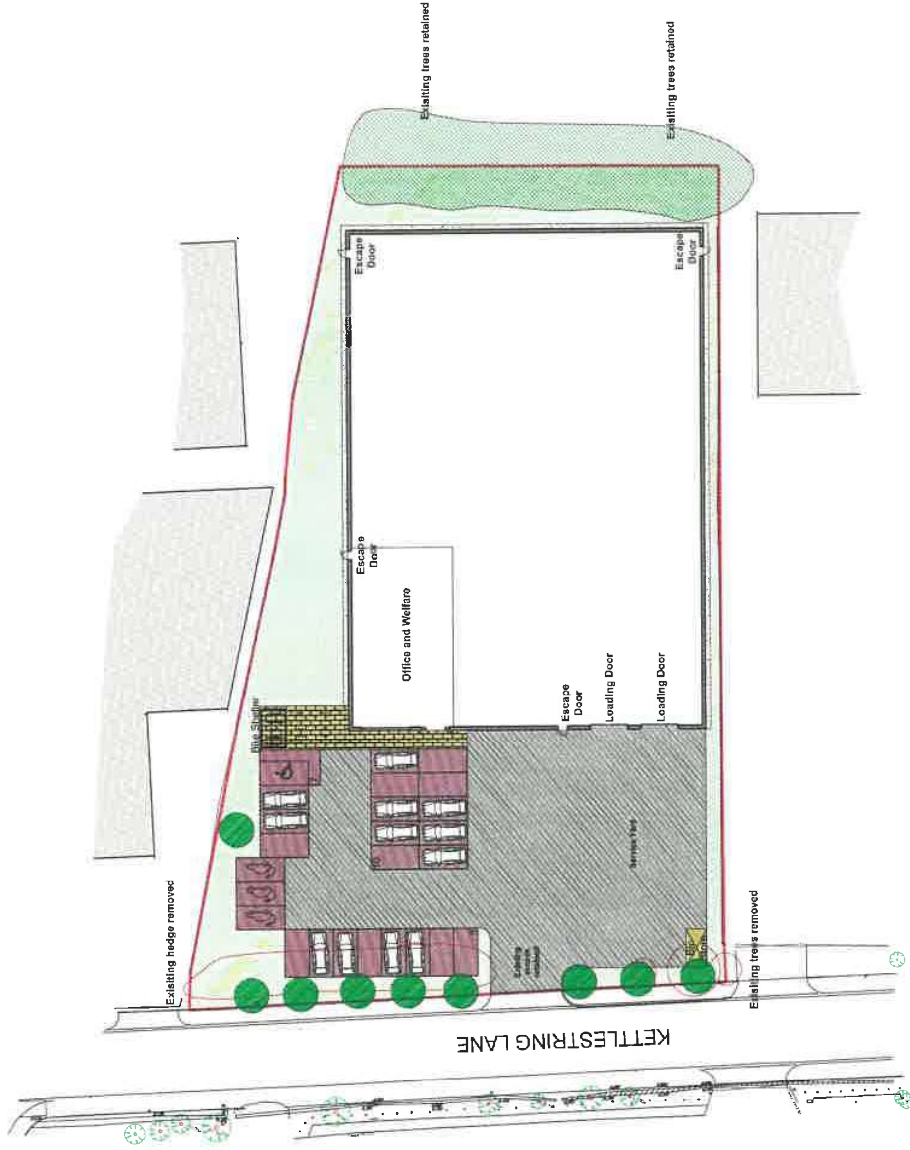

Do not scale from this drawing. Only work to written dimensions. The drawings are the property of Ellis Healey Architecture and are to be used only for the project and site for which they are prepared. No part of this drawing may be reproduced or transmitted in any form or by any means, electronic, mechanical, photocopying, recording, or by any information storage and retrieval system, without the prior written permission of Ellis Healey Architecture.



NO. 1	1:1000	15.12.2019	PLAN
NO. 2	1:1000	15.12.2019	PLAN
NO. 3	1:1000	15.12.2019	PLAN
NO. 4	1:1000	15.12.2019	PLAN
NO. 5	1:1000	15.12.2019	PLAN
NO. 6	1:1000	15.12.2019	PLAN
NO. 7	1:1000	15.12.2019	PLAN
NO. 8	1:1000	15.12.2019	PLAN
NO. 9	1:1000	15.12.2019	PLAN
NO. 10	1:1000	15.12.2019	PLAN
NO. 11	1:1000	15.12.2019	PLAN
NO. 12	1:1000	15.12.2019	PLAN
NO. 13	1:1000	15.12.2019	PLAN
NO. 14	1:1000	15.12.2019	PLAN
NO. 15	1:1000	15.12.2019	PLAN
NO. 16	1:1000	15.12.2019	PLAN
NO. 17	1:1000	15.12.2019	PLAN
NO. 18	1:1000	15.12.2019	PLAN
NO. 19	1:1000	15.12.2019	PLAN
NO. 20	1:1000	15.12.2019	PLAN

ellis healey
architecture

PLANNING

PROJECT: PROPOSED DEVELOPMENT OF A RESIDENTIAL AND COMMERCIAL DEVELOPMENT AT 15, KETTLESTRING LANE, ST. JOHN'S, LEAMINGTON SPA, CV32 5JN

NO. 1: PROPOSED SITE PLAN

DATE: 15th Dec 2019

SCALE: 1:500

DATE: NOV 2019

PROJECT: 1500

DATE: NOV 2019

PROJECT: 1500