

MA 3-4-7-9 REMOVED FEB/MAR 2016
 UNDER PP 15/01857/TPO
 MA 6 REMOVED MAY 2020
 EMERGENCY REQUEST BY EMAIL/PHONE
 RE SPLIT TRUNK.

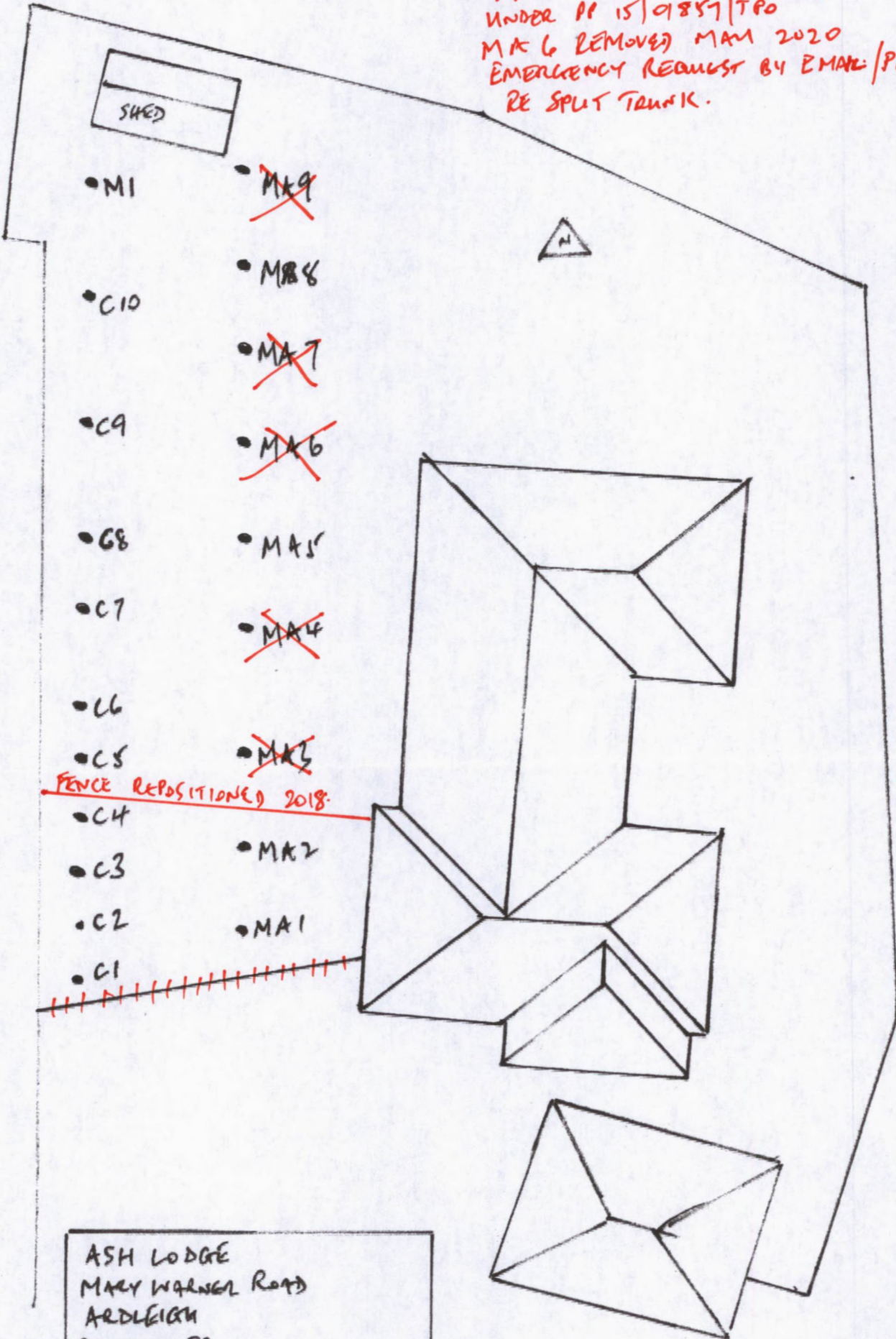

ASH LODGE
 MARY WARNER ROAD
 ARDLEIGH
 COLCHESTER
 CO7 7RP



C = COTONEASTER G1
 M = MAPLE T3
 MA = MOUNTAIN ASH. G2