

DRIVEWAY PLAN, 1:100 @ A3

- New electric sliding gate as image below.
- Steel posts with trellice to stabilise wall, hidden behind wall.
- Neighbours existing low wall

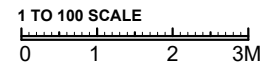
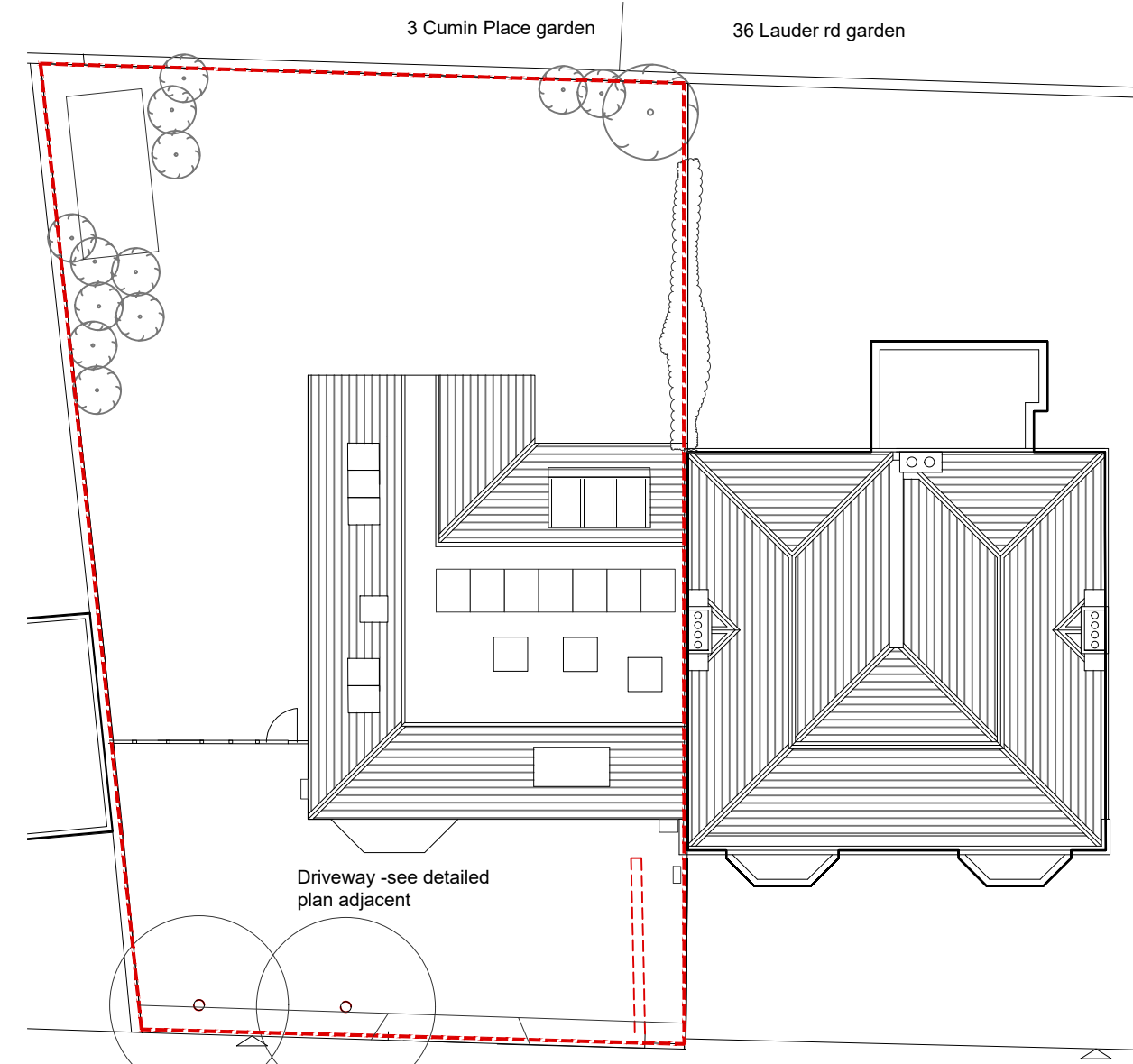

Image of similar pattern gate



PROPOSED SITE/ ROOF PLAN, 1:200 @ A3



PROPOSED STREET (NORTH) ELEVATION, 1:100 @ A3

- Retain existing wall.
- New electric sliding gate. Dark grey timber effect aluminium panels with solid bottom and slatted top as image above.
- Retain existing wall.
- Replace existing pedestrian gate with new to match adjacent electric gate.
- Neighbours existing low wall and hedge.



STREETVIEW
Prior to new house build start

The copyright of this drawing remains with SB-AD and may not be reproduced without prior written consent. Layouts of existing building are based on approximate survey dimensions - any dimensions that are critical to elements of design by others or for setting out of the works should be checked in advance. All dimensions are to be checked on site and the Architect notified of any discrepancies. DO NOT SCALE from this drawing for Constructional purposes.

STATUS	NMV
CLIENT	SURABHI AND MAHESH
PROJECT	42 GRANGE ROAD EDINBURGH
TITLE	AS PROPOSED SITE ALTERATIONS
DRAWN	JOB No. / Drwg No. / Rev
LB LB	0286 / P04 / N
SCALE DATE	@A3 FEB 21