

- Wall Type 1: Wall around Velux**
- Existing ventilated roof build up
 - 100mm Timber frame infilled with 100mm Kingspan Thermowall Insulation, or equal and approved.
 - 25mm Rigid Insulation
 - Vapour Barrier
 - 12.5mm Moisture Resistant Plasterboard

- Wall Type 2: Non load bearing Internal Wall**
- 12.5mm Moisture resistant Plasterboard (to bathroom side)
 - 75mm Timber frame infilled with 75mm Mineral Wool (10kg/m³)
 - 12.5mm Plasterboard (to bedroom / hall side)

New eaves door formed to other side of existing velux window. Door to be positioned between structural supports so no structural changes required. Door to be insulated to have u-value of 1.4W/m²K.

WALL TYPE 1

1180 x 940 Roof window installed, centred on bathroom and aligned with existing bedroom velux window. Roof window to be glazed in accordance with BS 6262: Part 4: 2018 and BS 6399: Part 1: 1996 and to have a U-value of 1.3 W/m²K and colour to be dark grey and approved by client. Rafter's doubled up around velux windows and bridled with double trimmers, as per Structural Engineer's Drawings and specification. Roof lights and flashing to be installed in strict accordance with manufacturer's instructions and specification. Shelf to be minimum 750mm high from FFL to allow for installation of WC and bath in front.

WALL TYPE 2

New internal walls formed to create enlarged bathroom. Dividing wall to be as close to existing velux window as possible.

Outward opening door to maintain adequate activity space within bathroom.

Existing loft hatch to be moved outwith new wall position. To be located between existing joists so no structural change required.

Internal wall formed behind bath to allow for position of shower at tallest headspace within room and to allow for location of basin.

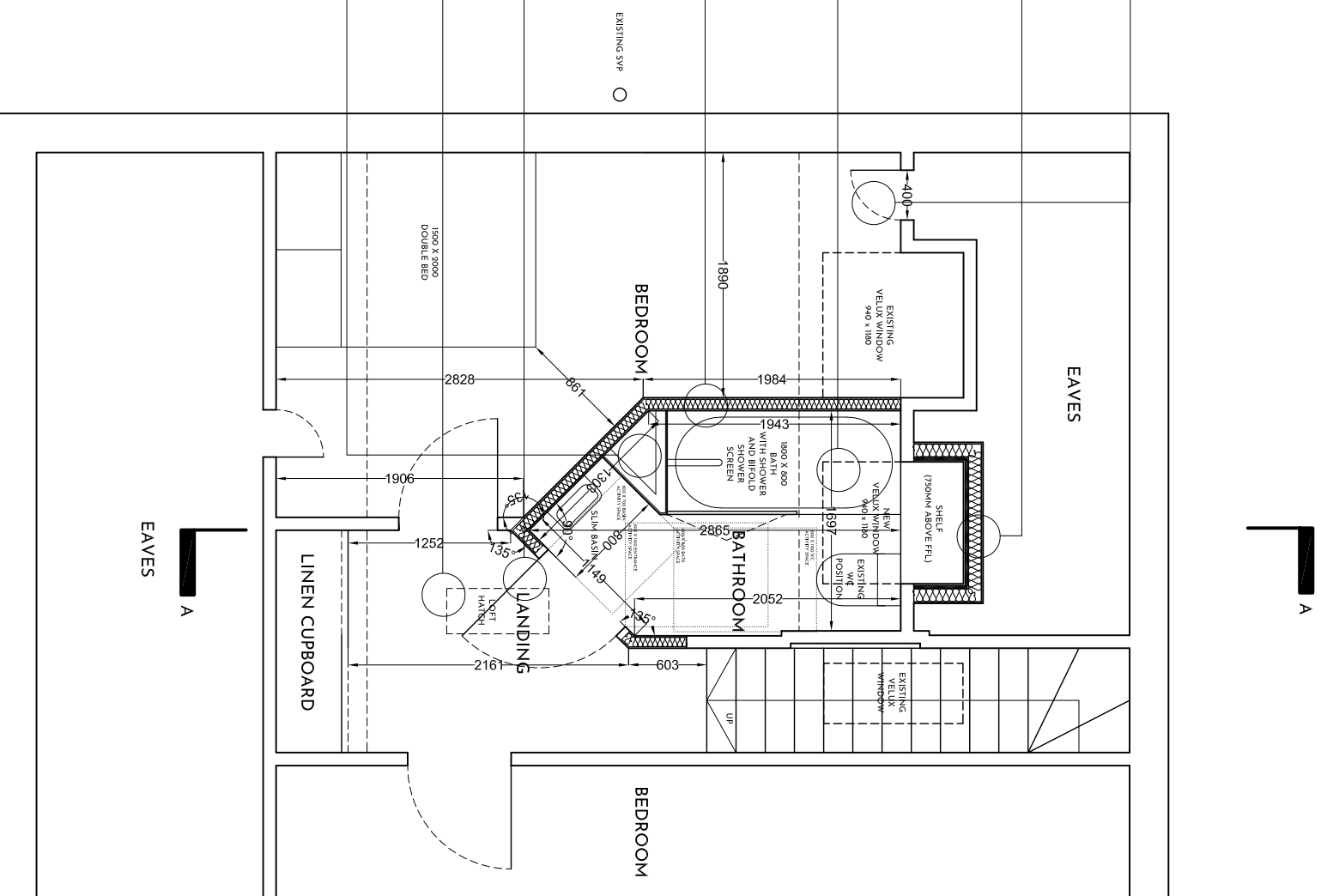

NOTES:
Drawings to be read in conjunction with Structural Engineer's Drawings and Specifications.

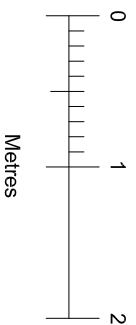

REV : DATE



29 Eglinton Walk
Eglesham
G76 0LB

01355 510 464
lorne@houletstudio.co.uk
www.houletstudio.co.uk

DO NOT SCALE FROM DRAWINGS
All dimensions to be checked on site by contractor and any discrepancies to be notified to the architect prior to works being commenced. Use figured dimensions only.
© All rights reserved. Copyright in all documents and drawings prepared by Houlet Studio and in any work executed from these documents and drawings shall remain the property of Houlet Studio.

CLIENT: Mr & Mrs Moore

SCALE: 1:50

SIZE: A3

JOB NUMBER: A2314

DATE: October 2023

PROJECT: 63 Holehouse Road,
Eglesham, Glasgow

DRAWING TITLE:
Proposed First Floor Plan

DRAWING NUMBER: A2314 03

REV: -