

Contractors **MUST** check all dimensions on site.
 Only figured dimensions are to be worked from.
 Any discrepancies **MUST** be reported to architect **BEFORE** proceeding.
 If in doubt ASK.
 This drawing is copyright, and is **NOT** to be copied, scanned or reproduced without the written consent.

Construction (Design & Management) Regulations 2015
 It has been presumed that the 'principal designer duties', as detailed in the above (CDM Regs) have either been taken on by the client or their chosen contractor.
 This means that the person who prepared these detailed drawings for the proposed works has **NOT** been deemed to have been appointed as a 'designer' (including principal designer) and therefore is **NOT** responsible for the various duties placed on designers as set out in Regulation 9 and 10 of the above regulations.

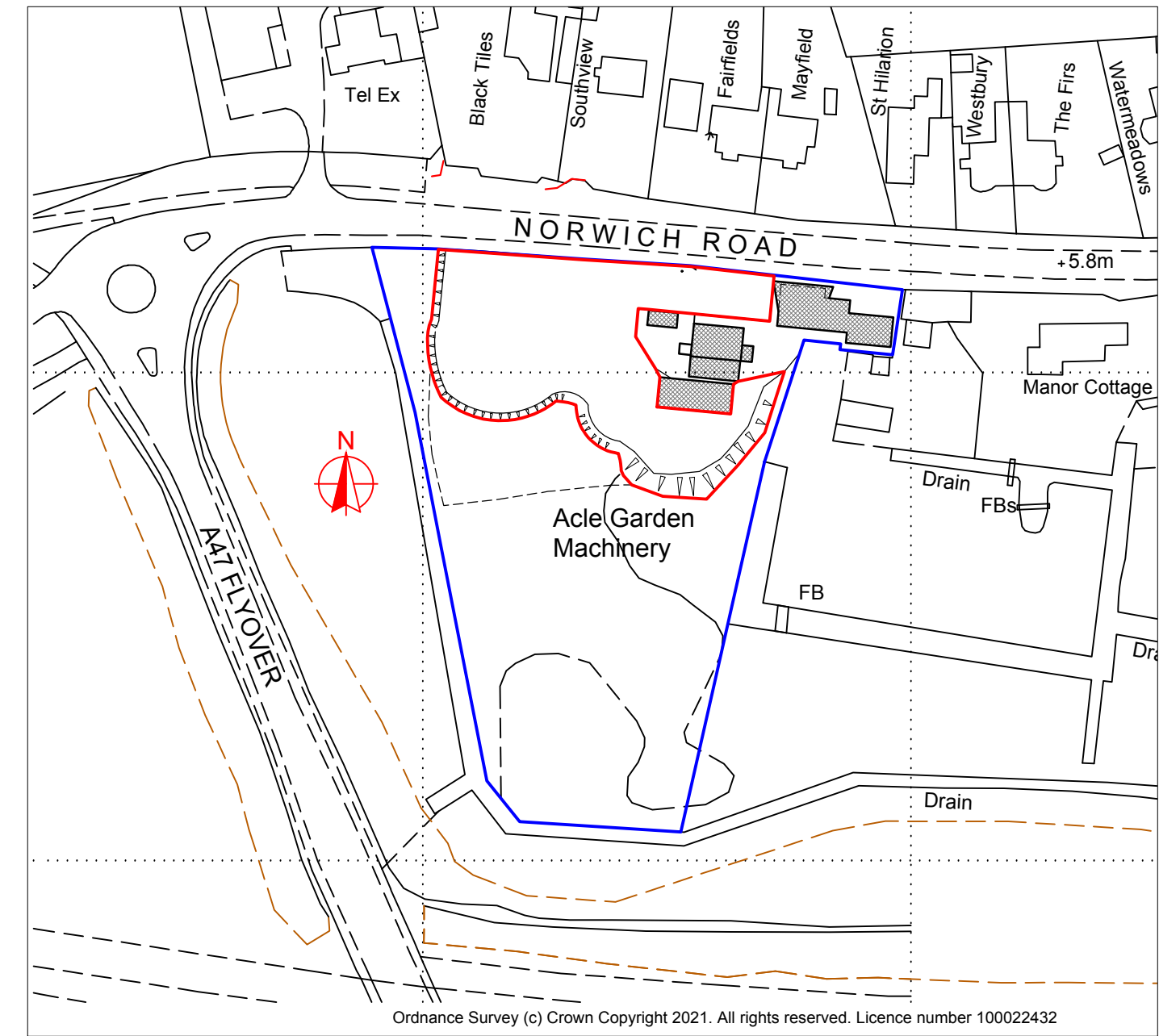

SITE LOCATION PLAN - 1:1250

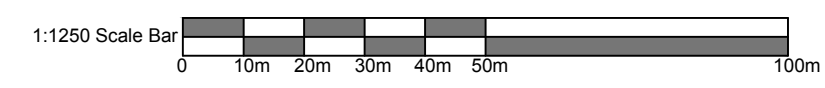

ANY WORK STARTED ON SITE IS AT YOUR OWN RISK
 UNTIL ALL APPROVALS AND CONSENTS ARE GRANTED

G	Larger shed building / repositioning	G	19.09.2023
F	Plan update	G	31.03.2022
	Soakaway added after infiltration test		
E	Plan update	G	09.03.2022
	7.2m turning space revised after SPA		
D	Planning update	G	10.01.2022
C	Revised turning / parking	G	26.10.2021
B	Red line - whole area	G	13.10.2021
A	Plan update	G	12.10.2021

Rev	Description	Initial	Date
GJ Building Surveying Services			
<ul style="list-style-type: none"> New Build, Conversion, Alteration and Extension Design Building Surveys Measured Surveys Planning & Building Regulation Submissions Project Management Party Wall Matters Residential, Commercial and Industrial 			
PO Box 1044, NORWICH, NR13 3XR T 01493 751137 W www.gjbs.co.uk E mail@gjbs.co.uk			

Issued For	Comment	<input checked="" type="checkbox"/>	<input type="checkbox"/>
	Approval	<input checked="" type="checkbox"/>	<input type="checkbox"/>
	Tender	<input type="checkbox"/>	<input type="checkbox"/>
	Construction	<input type="checkbox"/>	<input type="checkbox"/>
	Record	<input type="checkbox"/>	<input type="checkbox"/>

Client	ACLE GARDEN MACHINERY LTD		
Project	ACLE GARDEN MACHINERY CENTRE NORWICH ROAD ACLE NORFOLK NR13 3BY		
Title	PROPOSED ADDITIONAL STORAGE SHED EXISTING & PROPOSED PLAN / BLOCK & SITE LOCATION PLANS		
Info	Local Authority	BROADLAND DC	Date Apprvd
	Planning Ref	20211179	
	Building Ctrl Ref	-	
Date	SEPT 2023	Job No.	Dwg No.
Scale	AS SHOWN	GJ/21/2000	01
Drawn By	G		G

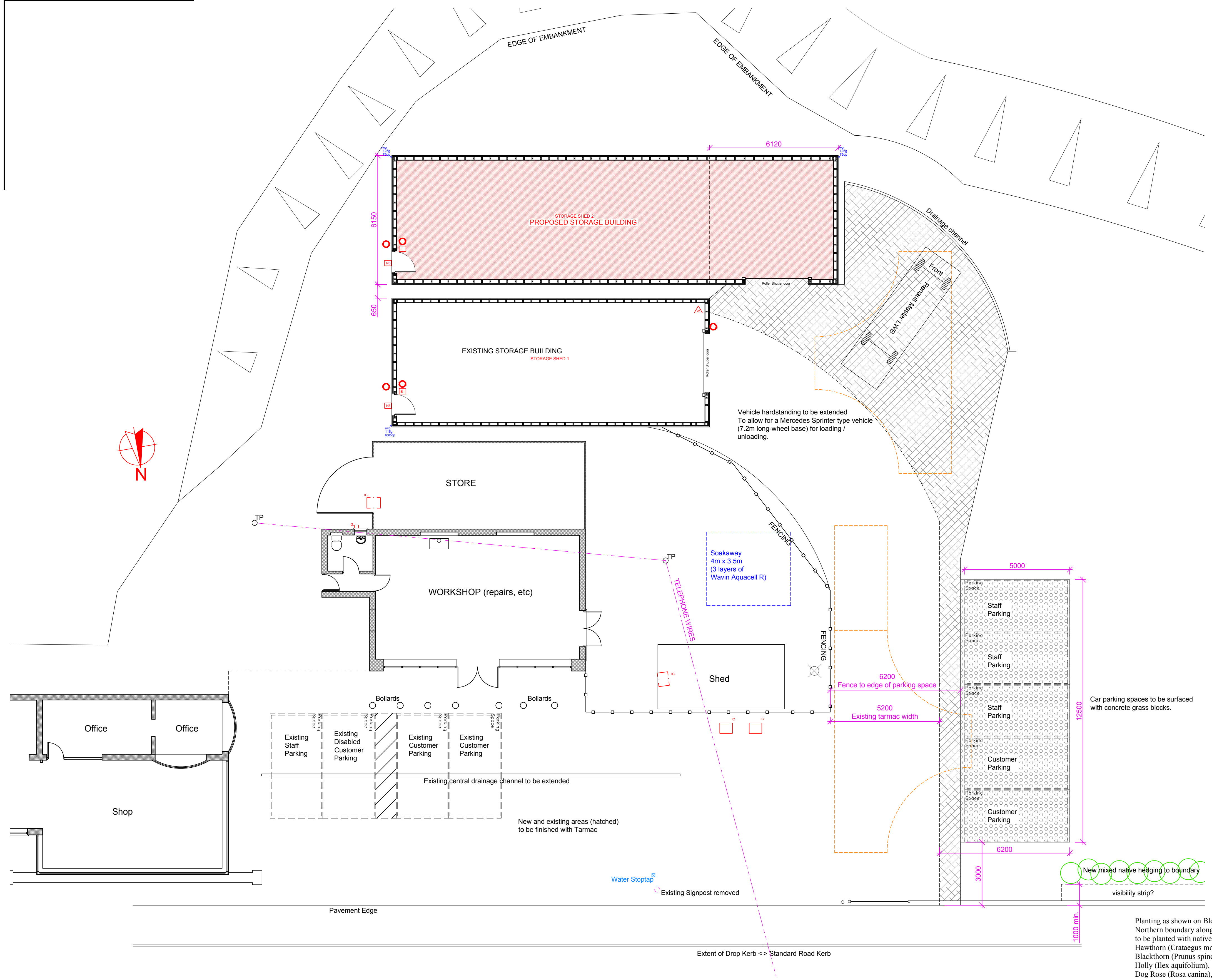

EXISTING / PROPOSED BLOCK PLAN - 1:100
 Proposed new building hatched in RED

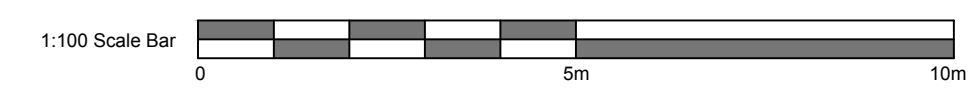

Traffic movements:
 In peak summer there is an articulated HGV lorry (with side curtain) delivery three times a week. This pulls up adjacent to the site on Norwich Road, and has a maximum unloading time of 20 minutes. The staff of the business are able to supervise and assist the lorry driver with banksman services and to make sure that the road remains free-flowing for what little time the lorry is parked up.

Daily in late afternoon, there is a visit from Royal Mail in a Renault Master (long wheel base) type van, to collect parcels, etc. This parks adjacent to the existing rear storage shed, and then turns around and exits the site in a forward gear.

Surface Water:
 All new roof areas and hardstandings to exit into new site soakaway in position as shown consisting of:
 Wavin Aquacell units - two layers of 3 long x 5 wide (3m x 2.5m)
 Using the calculations obtained from the permeability testing (see separate results) the above design has been confirmed to be suitable for a 1:30 year storm +30% for climate change.

Planting as shown on Block Plan on Sheet 02:
 Northern boundary alongside Norwich Road and part of Western edge of embankment to be planted with native mixed hedging:
 Hawthorn (Crataegus monogyna),
 Blackthorn (Prunus spinosa),
 Holly (Ilex aquifolium),
 Dog Rose (Rosa canina),
 Wild privet (Ligustrum vulgare)

Spacing to be double staggered rows of plants, 50cm between rows, 50cm between plants.
 Making sure that there is at least a one metre clear visibility strip between boundary fencing and eventual outer edge of hedging line.