

DO NOT SCALE : All dimensions are to be checked and confirmed on site. All discrepancies are to be reported to this Office.  
 This drawing and design is protected under copyright, and it shall not be reproduced in whole or part without our prior consent.

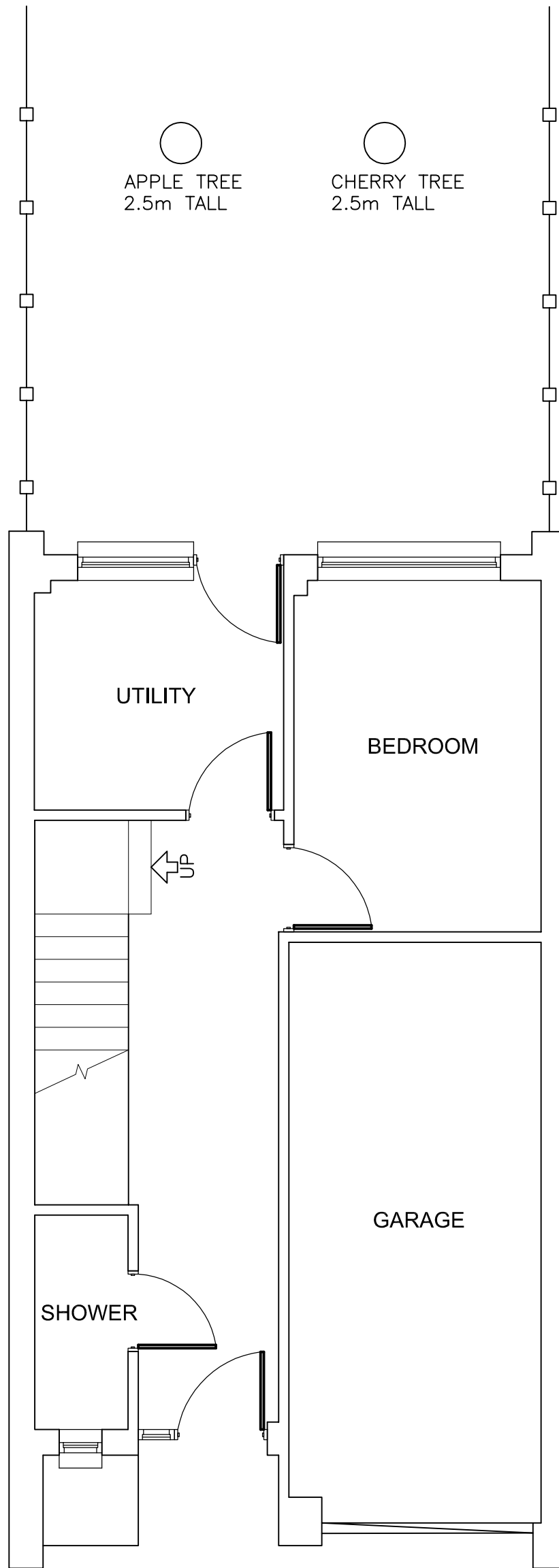

NOTE:-  
 No changes are proposed  
 to the ground floor plan.

**PROPOSED GROUND FLOOR PLAN**

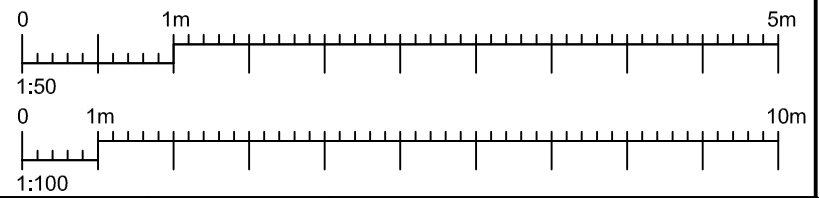

13 KINGSMEAD CLOSE,  
 SIDCUP,  
 KENT.  
PROPOSED INTERNAL ALTERATIONS -  
PROPOSED GROUND FLOOR PLAN.

**Kelsham Ltd**  
 CONSULTING STRUCTURAL ENGINEERS  
 WILSON HOUSE  
 JOHN WILSON BUSINESS PARK, WHITSTABLE  
 KENT. CT5 3QT  
 Tel : 01227 276503 E-mail : Mail@Kelsham.co.uk

SCALE	1:50 @ A3		
DATE	NOVEMBER 2023	DRAWN BY	N.R.J.
CLIENT			
DRAWING NO.	<b>KL4015/04</b>		REV.