

GROUND FLOOR LEVEL PLAN

Boundary Line

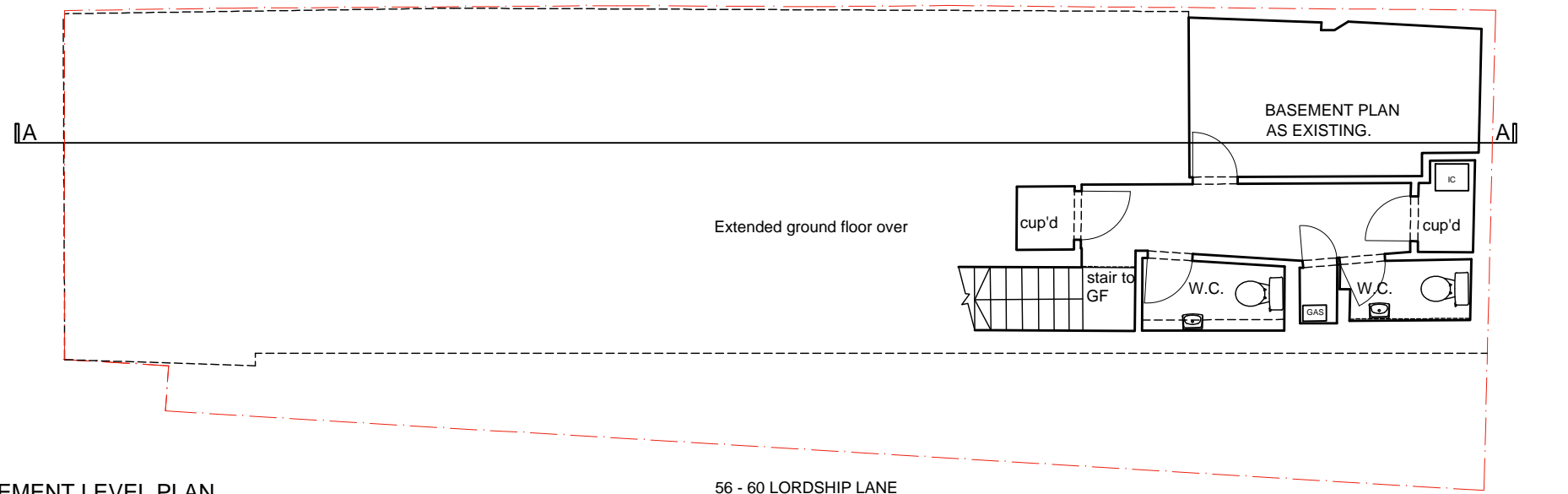

BASEMENT LEVEL PLAN

Boundary Line

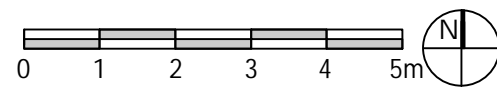

PLANNING DRAWING

- PROPOSED KEY
- ① New brickwork cavity wall to commercial extension
 - ② New double glazed rooflight above
 - ④ Wheelchair accessible W.C. to commercial extension
 - ⑤ New refuse store
 - ⑦ New escape door from commercial unit
 - ⑧ Existing access door to residential unit
 - ⑨ New bike store with canopy over
 - ⑩ Gate to Lordship Lane
 - ⑪ Existing shop front

Planning Consent
23/AP/1495
granted 20/07/2023

SALT WEST ARCHITECTS
71 Pendle Road, London, SW16 6RT
Tel/fax: 020 8677 1807 Email: mail@saltwestarchitects.com

job no: 184 project: 54 LORDSHIP LANE, LONDON SE22
date: Nov. 2023 title: PROP. BASEMENT & GROUND FLOOR PLAN
scale: 1:100 @ A3 drwg no: CLD20