



Do not scale from this drawing. All dimensions are approximate and should be checked on site prior to construction. All discrepancies must be reported to the Architect for verification prior to commencement of the affected works.

This drawing is Copyright protected and must not to be reproduced or used without prior written permission

Notes:

Keys

-  Existing wall to be retained
-  Existing floor to be removed and replaced with limecrete flooring
-  Existing floor to be retained

Revisions:

Rev	Date	Amendment
A	07/02/23	ASHP omitted from the proposal
B	13/10/23	Demolition of existing floor to be replaced with limecrete
C	02/11/23	Annotations added

RIACH

architects

Riach Architects Limited, Company Number: 8867519
 65 Banbury Rd, Oxford, OX2 6PE. Tel:01865 553772
 mail@riacharchitects.com www.riacharchitects.com

Client
Mr Stephen Pavlovich

Project
20 Northmoor Road

Drawing title
Proposed Ground Floor Plan

Date **Nov 2023** Scale **1:100@A3**

Stage **Planning** Drawn By **DB** Checked By **TB**

Drawing Number **1915-101** Revision **C**

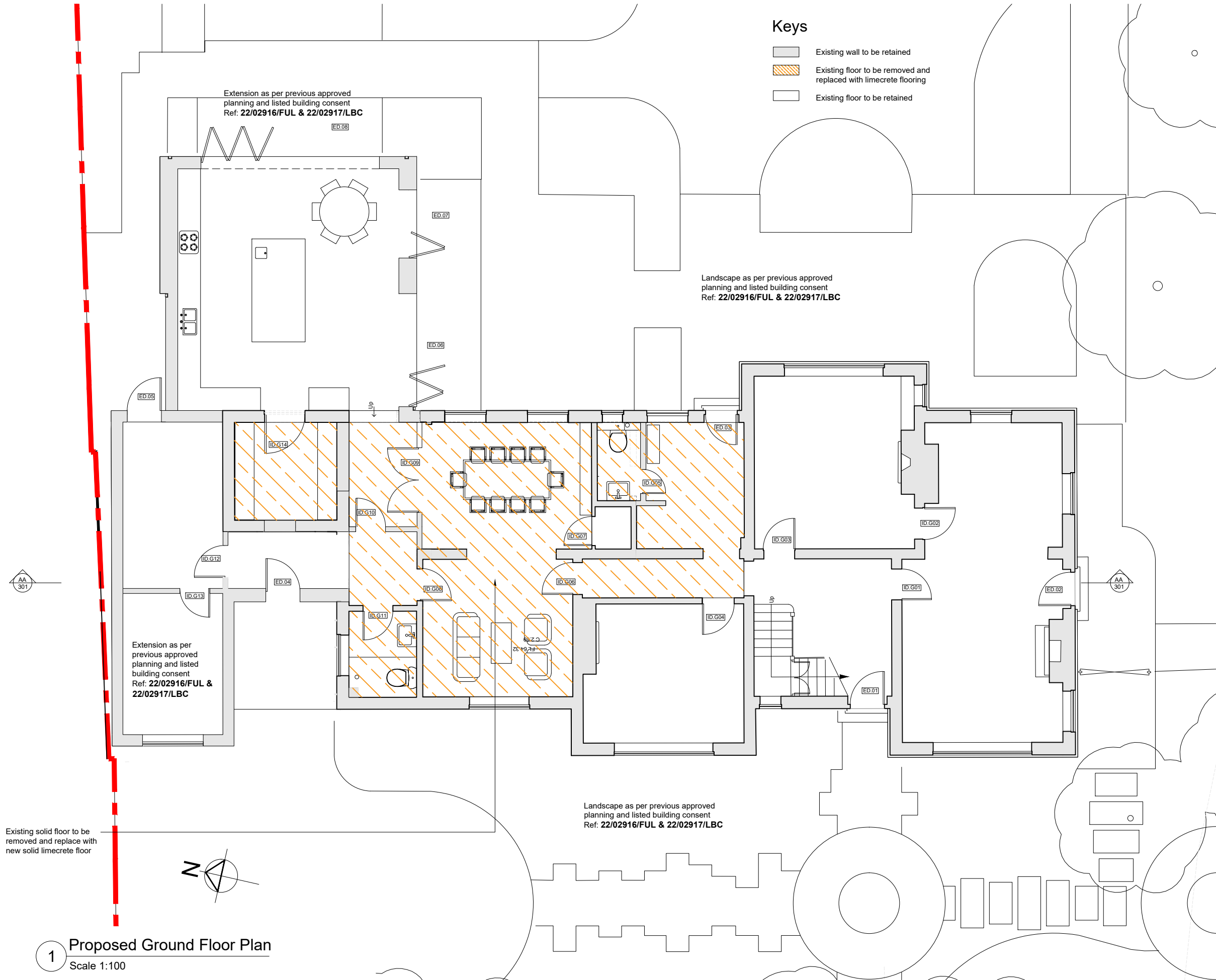

Existing solid floor to be removed and replace with new solid limecrete floor

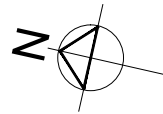

1 Proposed Ground Floor Plan
 Scale 1:100

