

PROPOSAL DESCRIPTION

Total of 6m rear extension with 2 skylights from the original house. New extension is only 2.5m and the house was already extended 3.5m via planning application number 16/14696/LDP

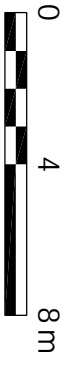
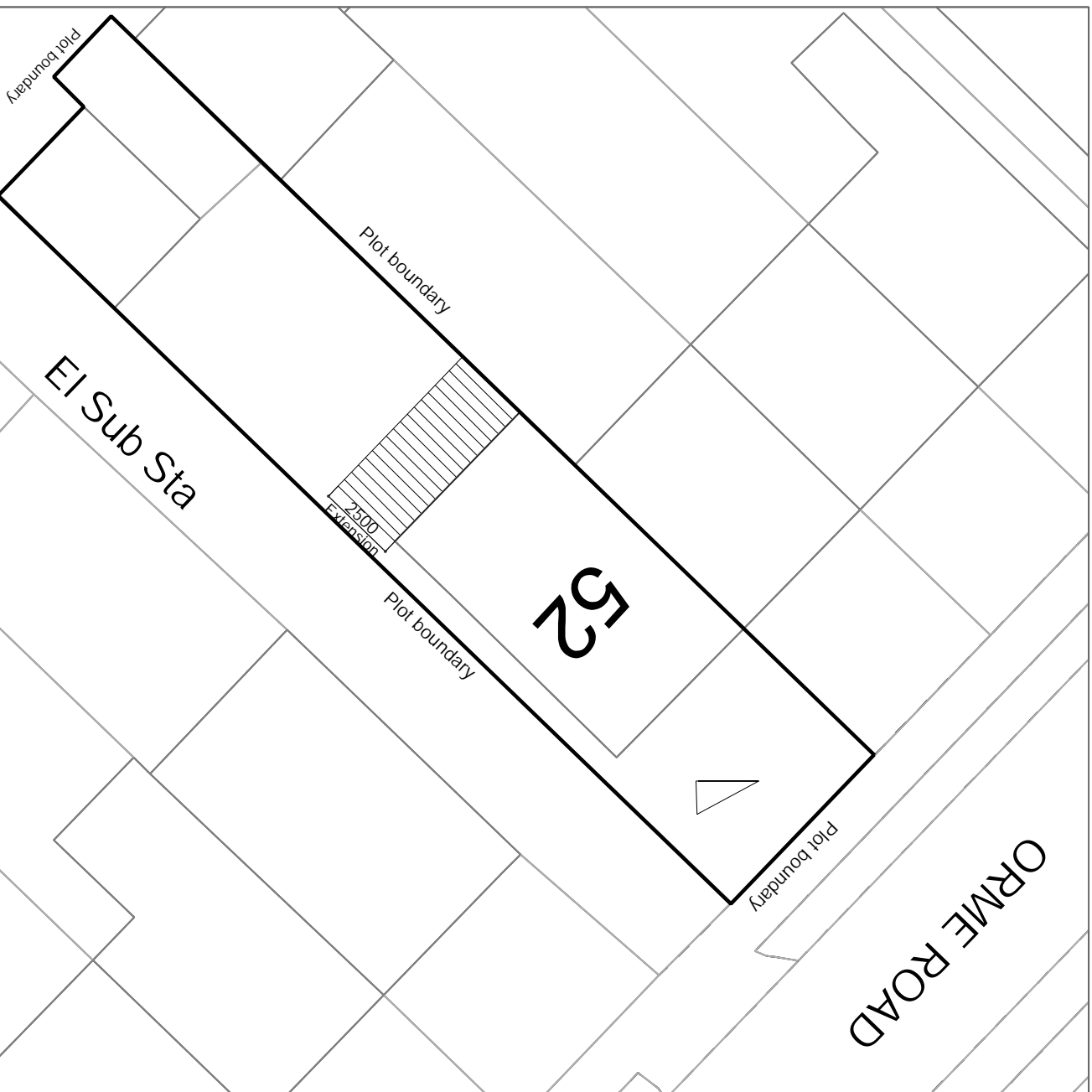

SCALE BAR - 1:200
NOTE: ALL DIMENSIONS ARE IN MM

TITLE
BLOCK PLAN

HOUSE AT 52, ORME ROAD
NORBITON, KT1 3SB

APPLICATION NUMBER
23/02947/PAEXT

KANSAL CONSULTANCY
PRIVATE LTD.
www.kclengineers.co.uk

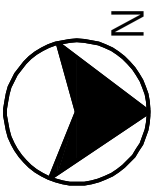

DATE 26/10/23 SCALE A3 @ 1:200