

Produced on 13 September 2023 from the Ordnance Survey National Geographic Database and incorporating surveyed revision available at this date.
 This map shows the area bounded by 485167 170135, 485267 170135, 485267 170235, 485167 170235, 485167 170135
 Crown copyright and database rights 2023 OS 100054135. Supplied by copla ltd trading as UKPlanningMaps.com a licensed Ordnance Survey partner (OS 100054135).
 Data licence expires 13 September 2024. Unique plan reference: v1e/1000743/1348509

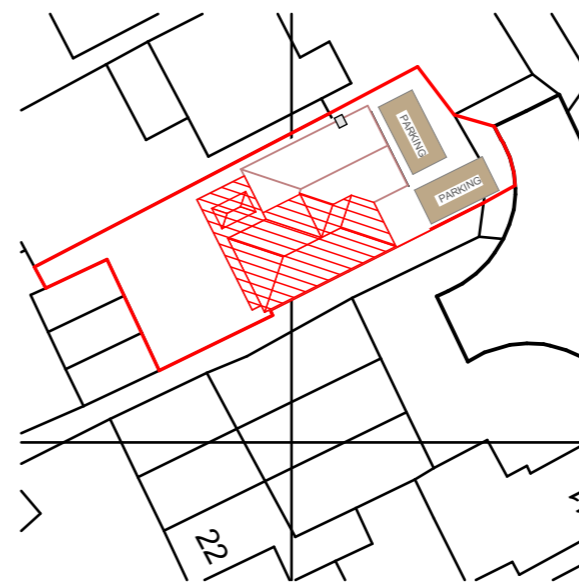

Location Plan 1:1250
1:1250

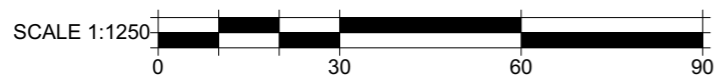

Block Plan 1:500
1:500

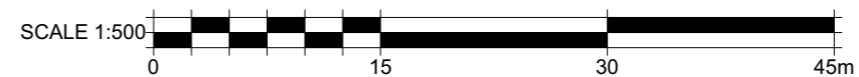

RevID	Revision	Date
01	Transmittal Set	14/09/2023

1. All materials to match existing unless otherwise stated
2. Do not scale from this drawing (other than for Planning purposes).
3. The Contractor is to verify all dimensions & levels before setting out, commencing work or placing orders.
4. Any discrepancies to be reported to M3 Architectural Design Ltd.
5. Drawings & design are the intellectual property of M3 Architectural Design Ltd, must not be used or reproduced without consent.
6. Issued drawings must be read in conjunction with entire contract set.
7. Ensure all work is undertaken using the most recent issue of documentation (refer to revision issue & date)
8. Comply with all applicable building code/regulations.

Client	Project	Project Ref	Layout Id	Rev.
		3080	A.02	01
		Drawing Title		
		Date	Scales @ A3	
14 Culver Croft Binfield RG42 4DF	Proposed two storey side and single storey rear extensions and alterations	Location And Block Plan	14/09/2023	1:1250, 1:500



M3 Architectural Design Ltd
 Basepoint Centres Limited
 377-399 London Road
 Camberley GU15 3HL

t: 01276 300024
 e: info@m3architecturaldesign.co.uk
 w: www.m3architecturaldesign.co.uk

©2023 M3 Architectural Design Ltd