

PLANNING APPLICATION FOR EXTENSION
 TO DWELLINGHOUSE (IN RETROSPECT)
 1 FALCONER'S WAY
 FALCONER'S LANE CLEGHORN
 FOR MR. W. CRUICKSHANK JNR
 ORIGINAL FIRST FLOOR PLAN
 DRWG. NO. FW1-PL5

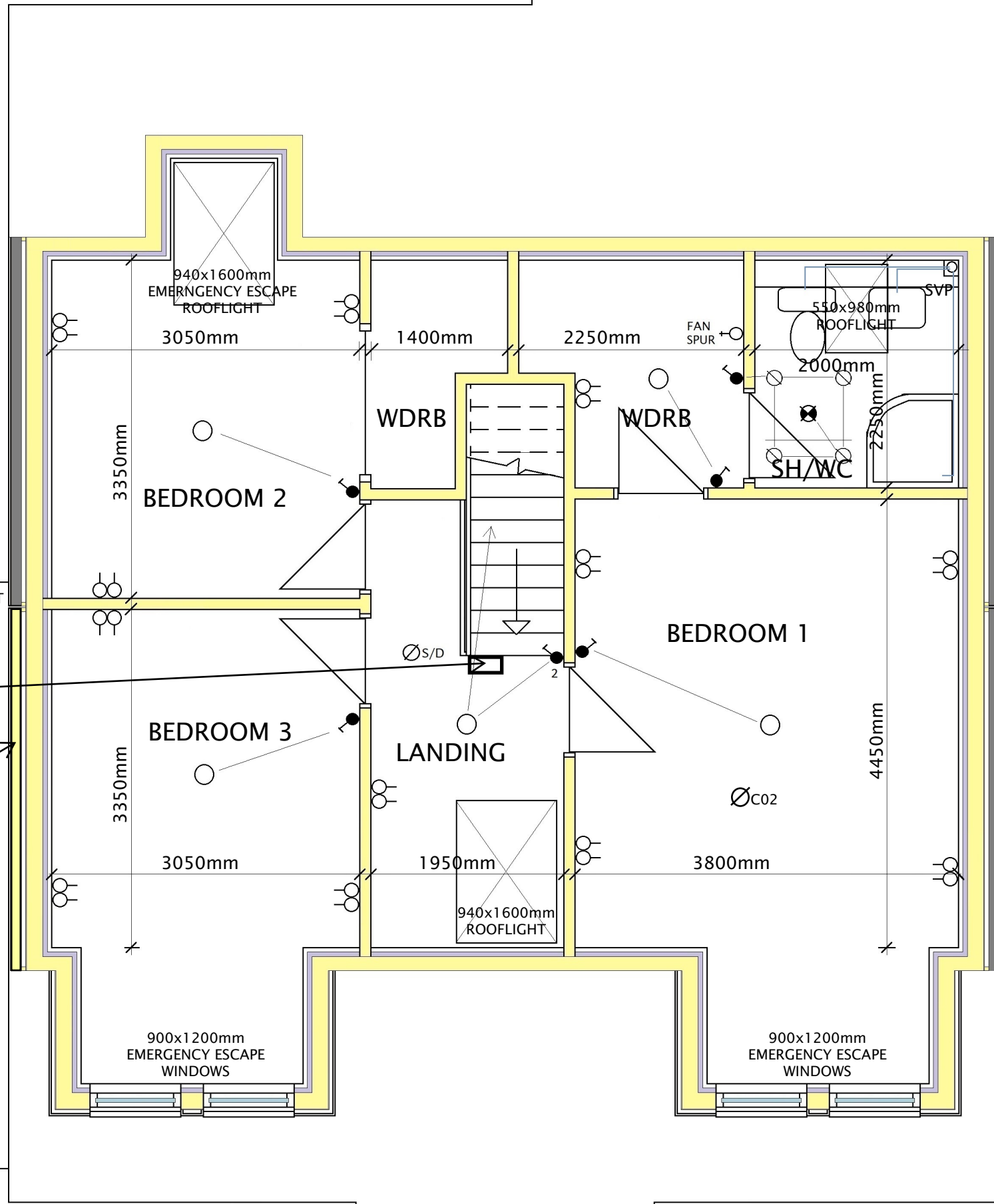

103 Main Street · Carnwath · Lanarkshire · ML11 8HP
 telephone – 01555 840807
 www.nevilledesignltd.co.uk



**GENERAL NOTES
 (GROUND FLOOR PLAN)**

Dimensions shown on plan are room size guidance only & are to be set out & confirmed on site.

Window & door sizes shown are nominal and are to be confirmed by the window/door manufacturer.

INTERNAL & EXTERNAL DOORS
 All doors to be sized to ensure a MINIMUM clear opening width through the door of not less than 800mm.

ACCESS TO DWELLINGS AND WITHIN DWELLINGS AND WIDTH OF INTERNAL DOORWAYS - Ensure every corridor within dwelling is a minimum of 900mm wide except at a radiator where it may reduce to a minimum of 750mm for a length of not more than 2000mm.

SPACE FOR FUTURE STAIRLIFT
 200x400mm space for future stairlift at foot of stairs, see main specification notes and details.

MOVEMENT JOINT

200x400mm SPACE FOR FUTURE STAIRLIFT

FRAME OUT FROM TIMBER FRAME INNER LEAF IN TREATED TIMBER BATTENS AND FINISH IN RENDER ON RENDABOARD, SEE MAIN SPEC. NOTES ON DRAWING NUMBER BW23.

MOVEMENT JOINT

ATTIC & EAVES ACCESS - Form attic access hatches and eaves access doors, to be formed between trusses, to be formed without cutting the ceiling tie or oxters of trusses of the roof trusses, to be insulated with minimum 300mm crown wool. All to allow access to all roof spaces, fit additional access panels as required to ensure all areas of roof voids are accessible. Draught stripping to loft hatchse and doors - All attic access hatches to be fully draught stripped on all sides.

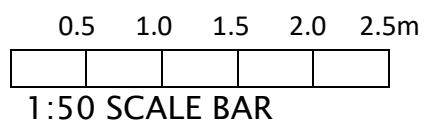

ORIGINAL FIRST FLOOR PLAN SCALE 1:50