

- This design / drawing and any related specification are the COPYRIGHT of 7hills Architectural Design Ltd and may not be reproduced in drawing or built form without the express permission of 7hills Architectural Design Ltd.
- Do not scale off this drawing, if a dimension is in doubt please contact 7hills Architectural Design Ltd.
- All dimensions are shown in millimetres unless stated otherwise.
- Contractor to check and clarify all levels, heights, dimensions, drainage, construction and specification prior to commencement or fabrication or fitting of any works on site and to bring to the clients attention any variations or deviations for written confirmation before being carried out on site.
- Client to confirm all legal boundaries at and before any works are commenced on site - all boundaries shown are indicative.
- Figured dimensions are taken to structure unless indicated otherwise.
- Report any discrepancies to 7hills Architectural Design Ltd immediately for verification.
- All elements of structure are indicative only, refer to Structural Engineers design / details and specification.
- All drawings are to be read in conjunction with the relevant Structural Engineers / Consultants details / drawings.
- These drawings are prepared for the purposes of obtaining Town & Country Planning permission and or Building Regulations only.
- All materials shall be fixed, applied or mixed in accordance with all of the manufacturers instructions, recommendations and specification. All materials shall be suitable for the purposes of use.
- The contractor shall take into account everything necessary for the proper execution of the works and to the satisfaction of the Building Inspector, whether or not indicated on the drawings or in the specification.

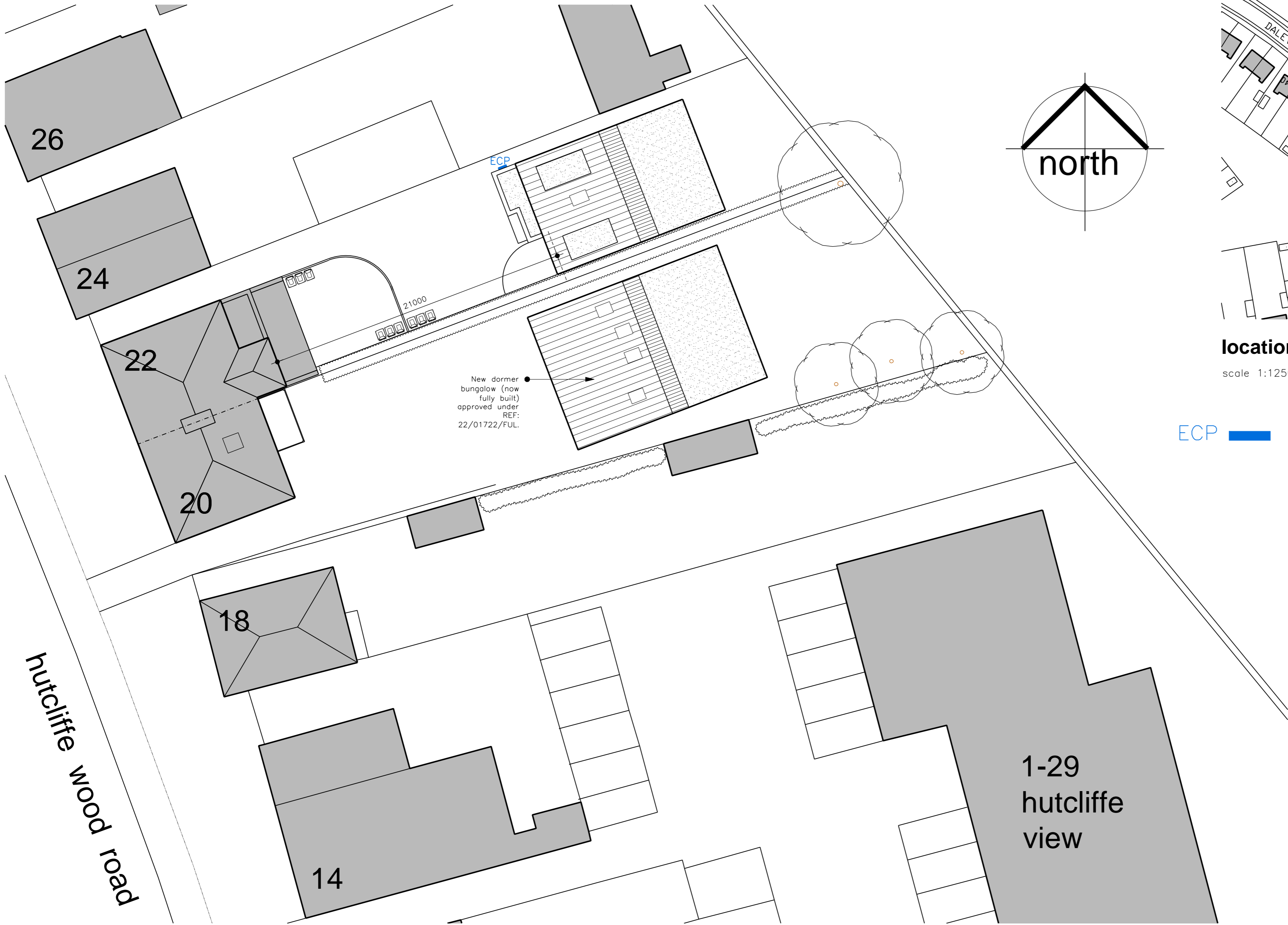

proposed site plan
scale 1:200



location plan
scale 1:1250

ECP  ELECTRIC CAR CHARGING POINT

DRAWING TITLE
PROPOSED SITE PLAN & LOCATION PLAN

PROJECT
NEW DWELLING
AT
LAND TO REAR
22 HUTCLIFFE WOOD ROAD
SHEFFIELD, S8 0EX
FOR
MR J. MEE

<small>PROJECT NO</small>	<small>DRAWING NO</small>	<small>REVISION</small>
338	02	-

<small>SCALE (A1)</small>	<small>DATE</small>	<small>STATUS</small>	<small>DRAWN</small>
VARIES	OCTOBER 2023	PRELIM	NT

7hills architectural design ltd
neil twigg
e: 7hillsarchitecture@gmail.com
 Queens Tower Lodge
 77-79 East Bank Road
 Sheffield
 S2 3PX