

- KEY**
- Existing Level $\oplus +00.00$
 - Application Boundary —
 - Existing tree position
 - Root Protection Zone

- External Finishes/Treatment**
- Existing
 - Soft Landscaping
 - Macadam

Refer to fpcr survey - 11047-T-01.

Note:
Drawing is based on Premier Surveys drawing 8034-Site-2D-RO (Nov 2021),

1 Traffic calming feature on Russell Gardens

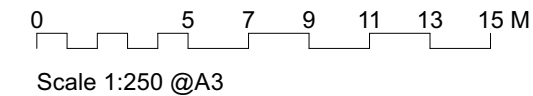
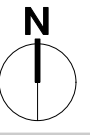
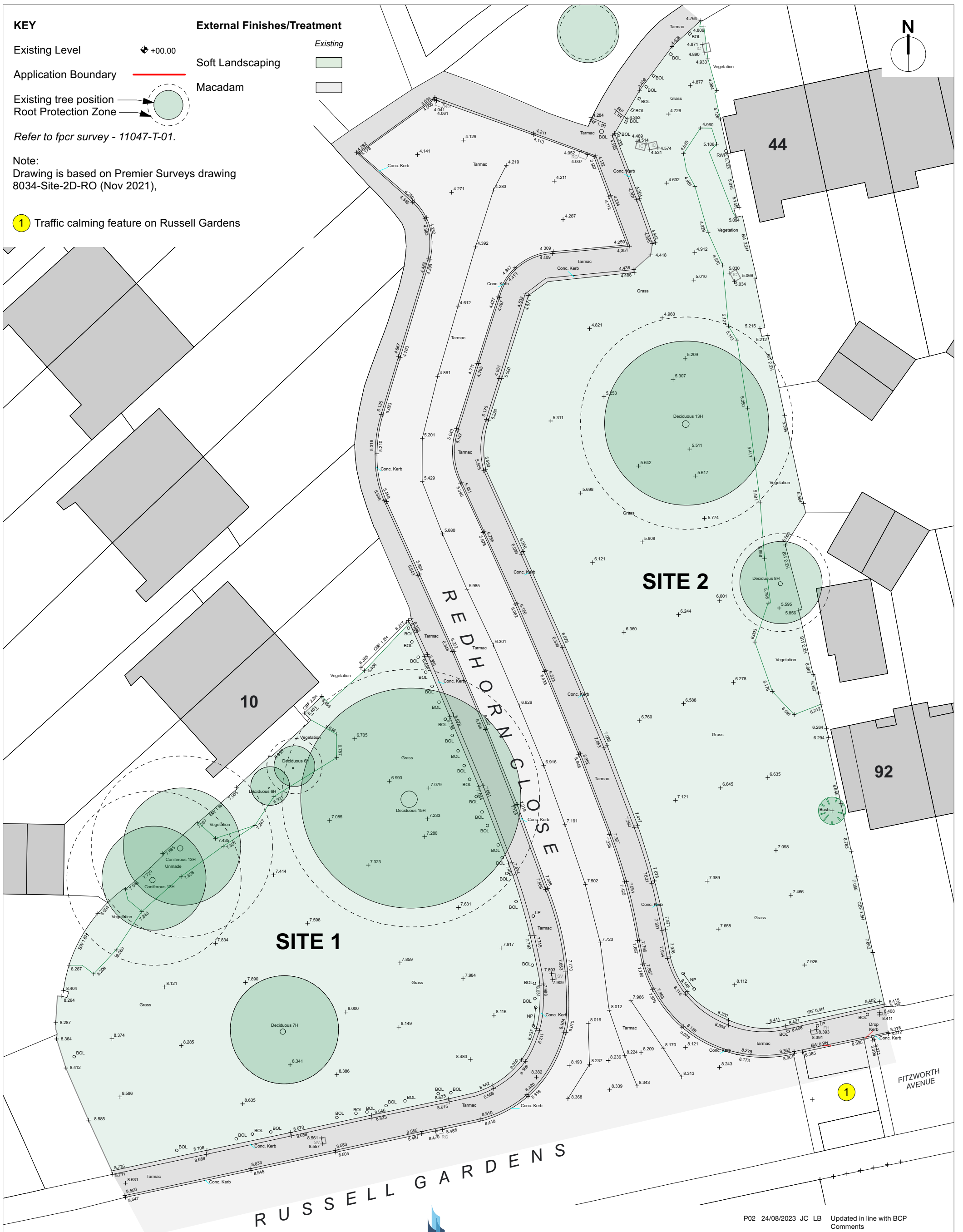

Kendall Kingscott
Chartered Architects
Chartered Building Surveyors
Interior Designers
CDM Services

Project
**Redhorn Close, Poole.
Infill Sites**

Client
BCP Council

Glentworth Court, Lime Kiln Close
Stoke Gifford, Bristol BS34 8SR
+44 (0)117 931 2062
www.kendallkingscott.co.uk

Scale Paper Size Filename
1:250 ISO A3 220449-Redhorn Close.vwx

© Copyright Do not scale this drawing

P02	24/08/2023	JC	LB	Updated in line with BCP Comments
P01	09/01/2023	JKCLB	LB	Drawing Issue
Rev	Date	By	Ap	Note
Drawing Title				Site Plan as Existing
Project Number	Drawing Number	Revision		
220449-1050		P02		
Date	Drawn	Checked	Purpose/Status	
09/01/2023	JKC	LB	PLANNING	
Check all dimensions and levels on site				

Only to be used on the site for which designed. The electronic transmission of designs/information contained in this drawing is carried out entirely at the User's risk and Kendall Kingscott Ltd. will have no liability for any errors or inaccuracies arising therefrom. The production of amended or updated information from the said designs/information by the User is entirely the responsibility of the User and Kendall Kingscott Ltd. shall have no responsibility in respect thereof whatsoever.