

Metres

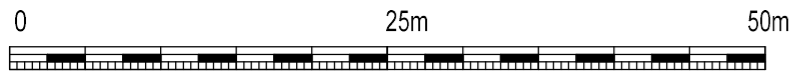

SCALE 1 : 500

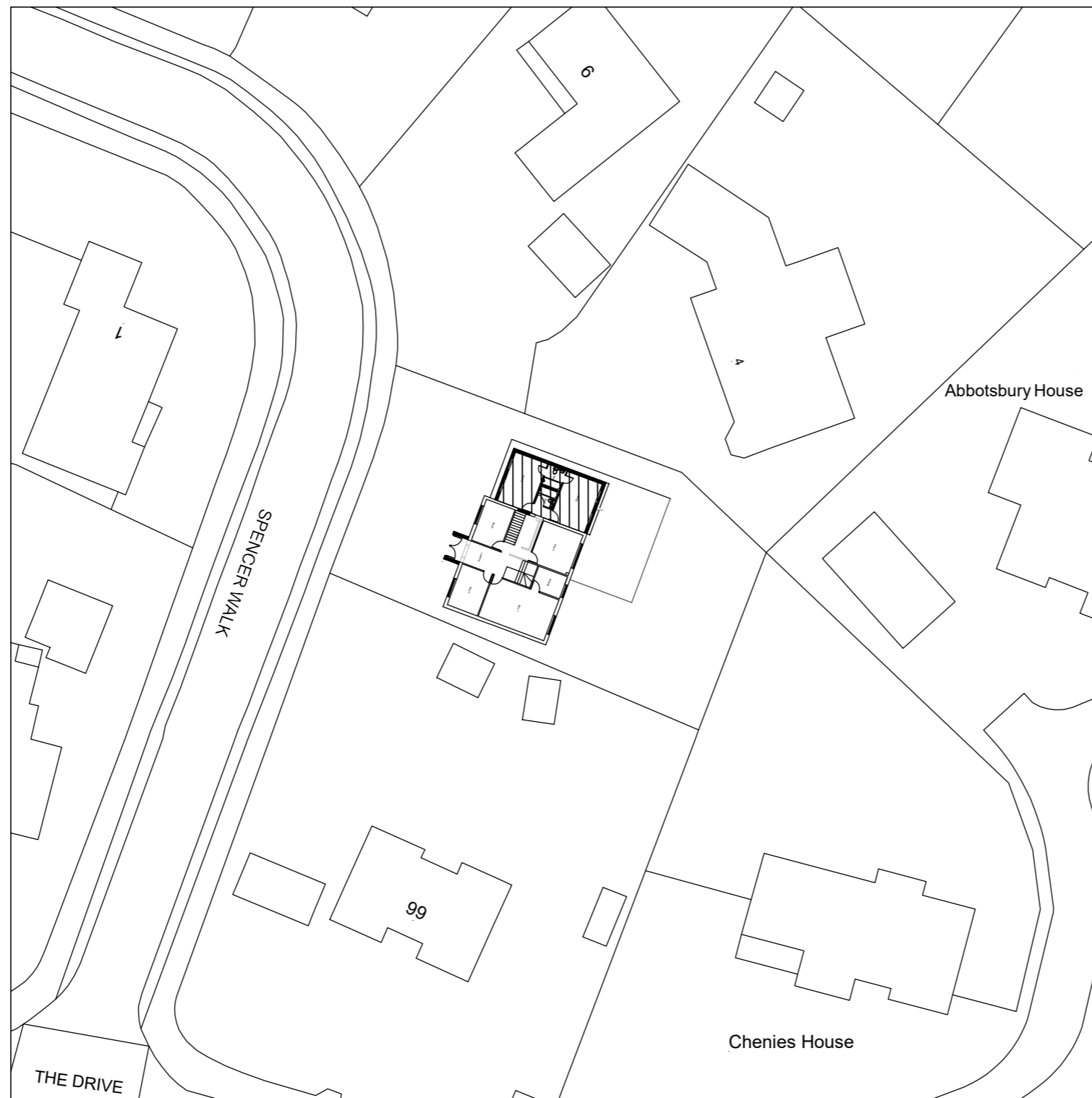

# BLOCK PLAN 2 (FF)

## SCALE 1:500

Application:		
<b>HPA – Ground floor rear, first floor side, 2 storey front extensions and loft conversion with rear dormer &amp; raised roof</b>		
Client:	Mr Ricky Kapoor	Date: 13 <sup>th</sup> July 2023
Site:	2 Spencer Walk Rickmansworth WD3 4EE	Drawn By: Gurps Benning
Scale:	Refer to Drawing @ A3	Dwg.No: GTD1091 – 08A

<b>G T DESIGNZ LTD</b> <i>Building Designs &amp; Technical services</i>	
GT Designz Ltd, 5th Floor, Hyde Park Hayes 3, 11 Millington Road, Hayes, UB3 4AZ.	Tel : 0208 212 7981 Mob : 07854 351 934 Email : enquiries@gtdesignzLtd.com

Copyright © 2023 GT Designz LTD  
(All rights reserved)