

Metres

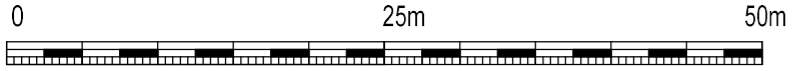

SCALE 1 : 500

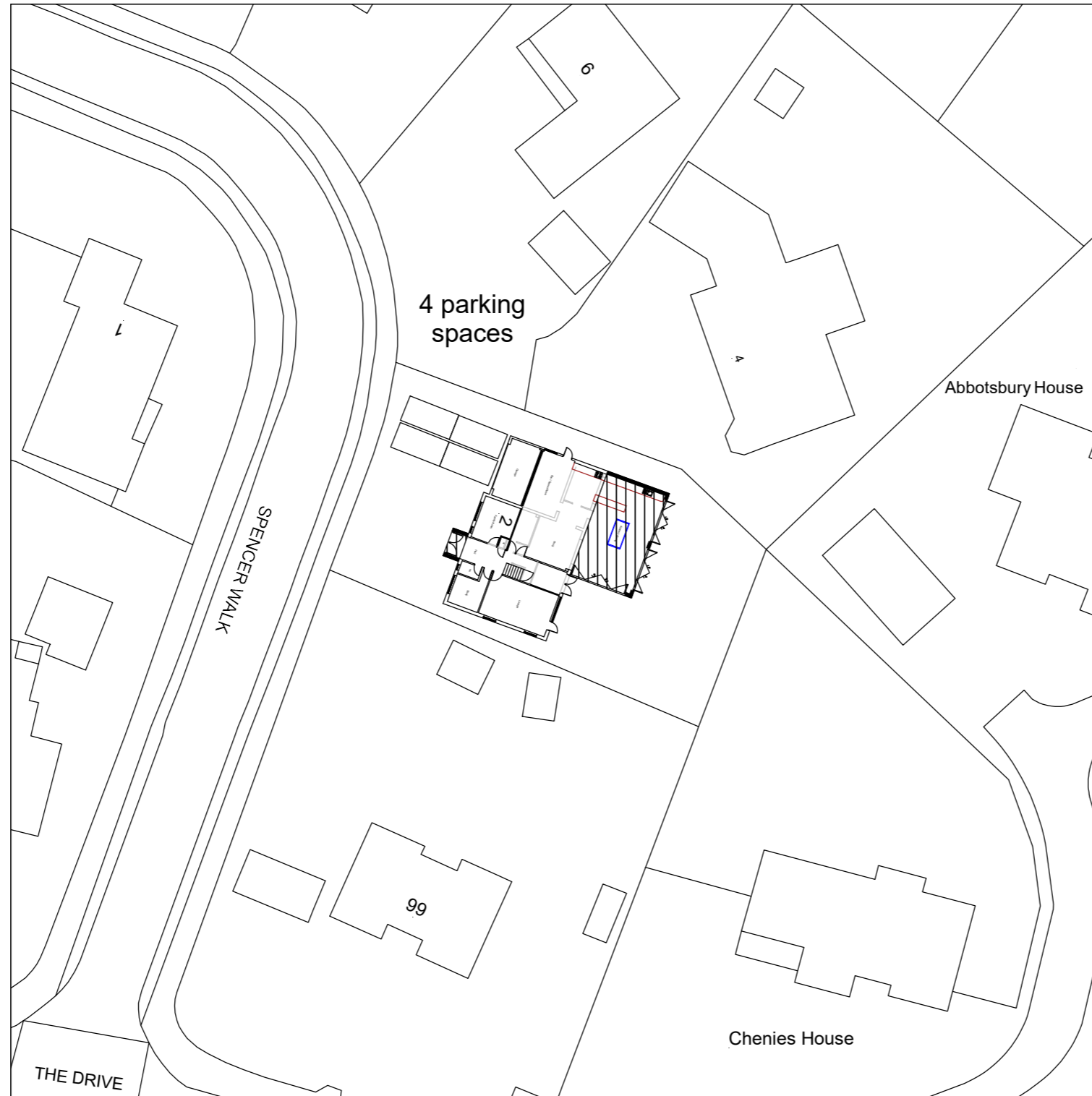

BLOCK PLAN 1 (GF)

SCALE 1:500

Application:		
HPA – Ground floor rear, first floor side, 2 storey front extensions and loft conversion with rear dormer & raised roof		
Client:	Mr Ricky Kapoor	Date: 13 th July 2023
Site:	2 Spencer Walk Rickmansworth WD3 4EE	Drawn By: Gurps Benning
Scale:	Refer to Drawing @ A3	Dwg.No: GTD1091 – 07A

G T DESIGNZ LTD <i>Building Designs & Technical services</i>	
GT Designz Ltd, 5th Floor, Hyde Park Hayes 3, 11 Millington Road, Hayes, UB3 4AZ.	Tel : 0208 212 7981 Mob : 07854 351 934 Email : enquiries@gtdesignzLtd.com

Copyright © 2023 GT Designz LTD
(All rights reserved)