

EXISTING COMMERCIAL GYM (SUI GENERIS USE)  
RED EDGE

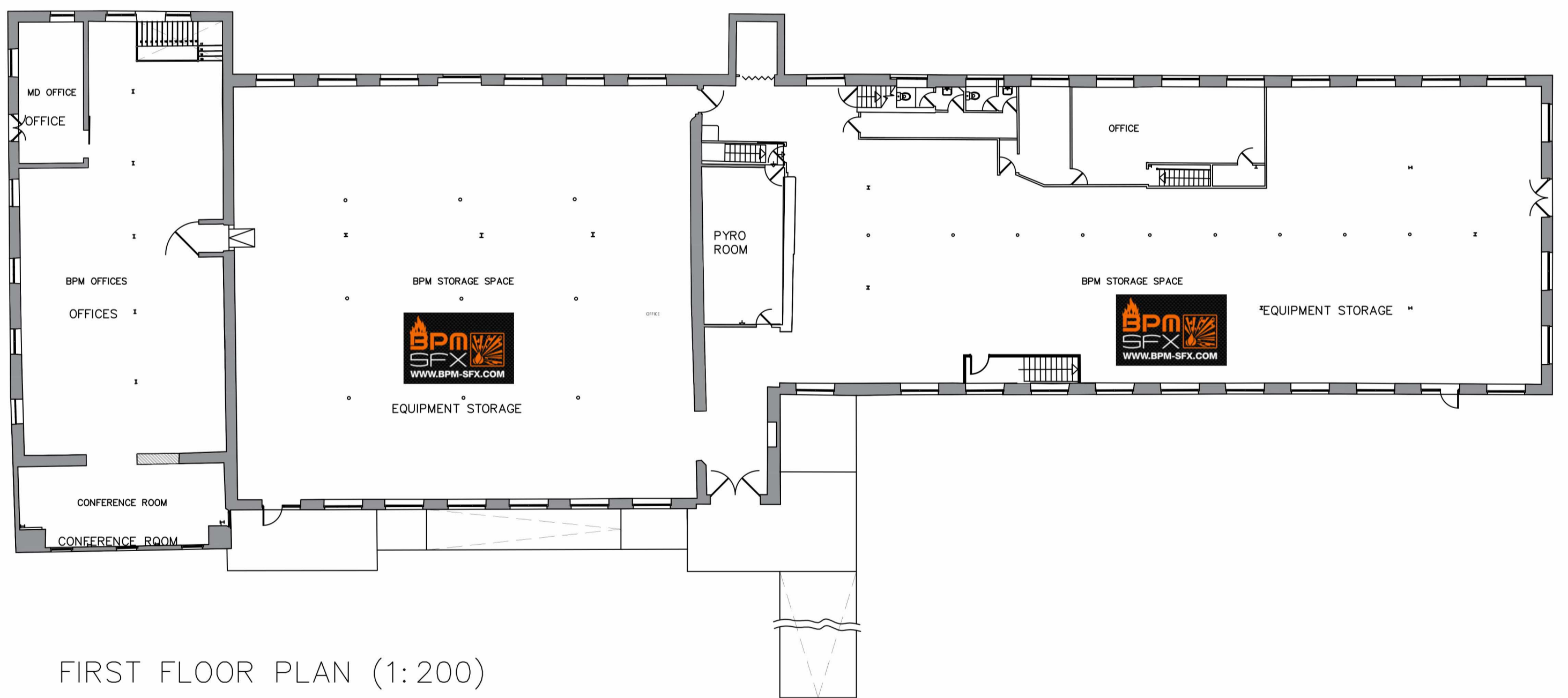
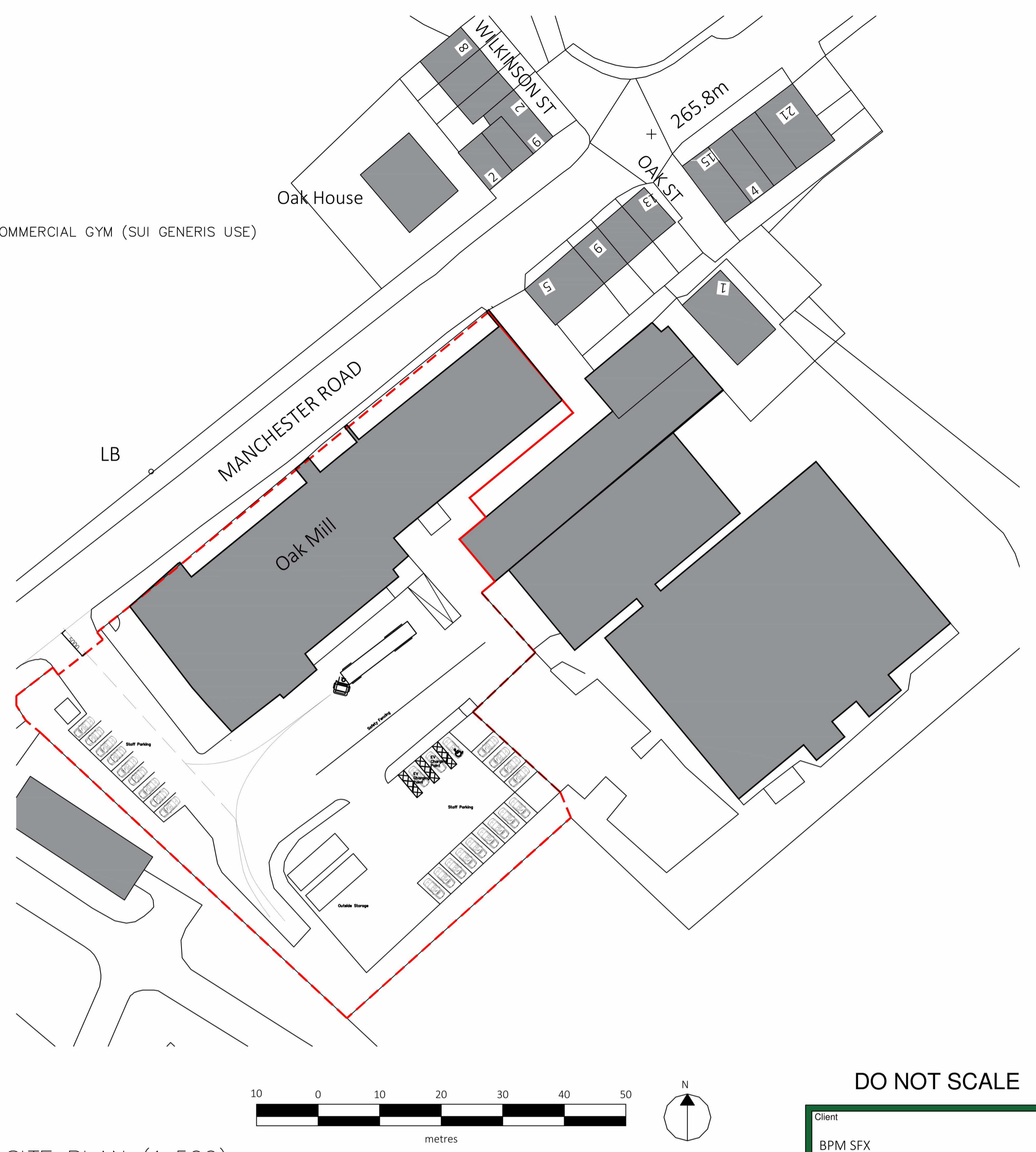

Client  
BPM SFX

Project  
Change of use of Gym (Sui Generis) to commercial use (Sui Generis) including staff facilities & temporary overnight accommodation Oak Mill, Dunnockshaw, Burnley

Job No.  
2023/21

Title  
EXISTING PLANS AND SITE PLAN

2023/21-01

Date  
14.03.23

Drn.  
B. E

Scale  
AS NOTED

Checked

rev.  
A

**eds**  
edmondson  
design services

Stacksteads, Bacup  
Lancashire  
OL13 8JS