

Notes:

General Notes

This drawing has been prepared based on survey and other information supplied by others.
 All dimensions and labels are to be checked on-site by contractors, and inconsistencies are reported immediately to Plots and Plans LTD prior to works being undertaken.
 This drawing is to be read in conjunction with all other relevant Plots and Plans LTD drawings, Specifications, schedules, and additional consultants information relating to the project or projects for which this drawing has been prepared.
 This drawing does not constitute compliance with the Party Wall Act 1996-responsibilities, including notification under the Act, are to be checked separately and clarified before works commence.
 Contractors are to ensure that all works under the responsibility or the responsibility of their sub-contractors are constructed and manufactured to comply with all relevant national and local authority statutory requirements and in accordance with local building control and codes of practice.
 All proprietary products/systems shown on this drawing are to be installed in strict accordance with the manufacturers/supplier's recommendations and details.
 These proposals must be inspected against all existing deeds to the property. Should this information not be provided to Plots and Plans Ltd, it is the client's responsibility to do so.

THIS DRAWING IS COPYRIGHTED AND MUST NOT BE REPRODUCED WITHOUT PLOTS AND PLANS LTD PERMISSION

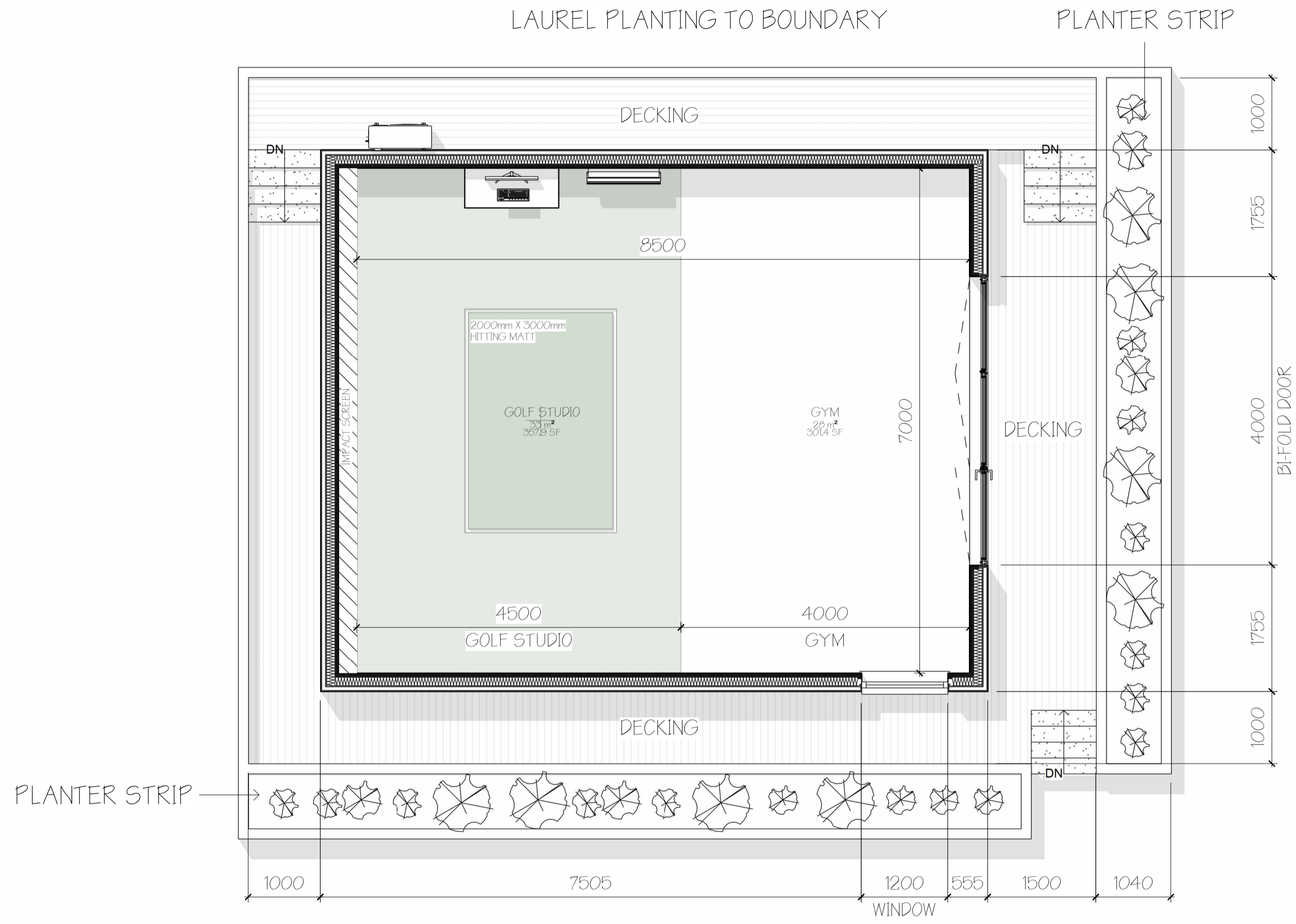

1 PROPOSED FLOOR PLAN
1:50

REV	DESCRIPTION	BY	DATE
LDC1	LDC ISSUE	JB	27/10/2023
			3

P&P Design Studio
 Plots and Plans LTD
 22 Beauchamp Avenue
 Midsomer Norton
 BA3 4FX
 Office: 01225 251991
 Mobile: 07817714353
 jack@plotsandplansdesign.co.uk

CLIENT: STEPHANIE NOVITT
 Project Stage Status: LDC ISSUE

SITE: 27 Shenley Hill, Hertfordshire, Radlett, WD7 7AU

TITLE: PROPOSED FLOOR PLAN

SCALE AT A2: 1:50	DATE: 27/10/2023	DRAWN: JB	CHECKED: PP
PROJECT NO: 23G034	DRAWING NO: LDC004	REVISION: LDC1	

