

ALEX IMLACH DESIGN 02088779955

PROJECT: 135B, Riverview Road, Epsom KT19 OJR CLIENT: Mr R O'Sullivan  
TITLE: Proposed ground floor plan of studio in relation to 135  
SCALE: 1:100 on A3 DWG NO: 682B/PL/110 REV: G

SCALE BAR IN MM COPYRIGHT AID

Rev C - revised side and porch Rev D - materials, bins car charger added  
Rev G - revised with North sign, boundary in red, clarify parking

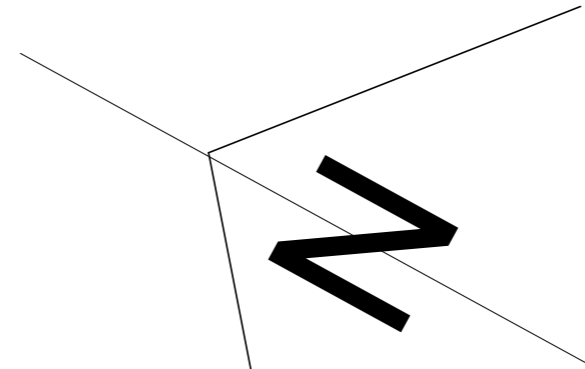

No 133

No. 135

4 bedroom  
GIA: 150m<sup>2</sup>  
2 car spaces  
at front

No. 135 a

3 bedroom  
GIA: 100m<sup>2</sup>  
1 carspace at  
front with  
electric charger

Waste bins 240 lts  
Plastic glass recycle 180 lts  
paper 47lt  
card 55lt  
food 23 lt

Living

EXISTING DRAINAGE

BOUNDARY FENCE

GARDEN AREA 70 M2

GARDEN AREA 70 M2

Remove manhole over  
sewer and form new  
manhole to house at  
rear.

Gate close boarded  
1.8 m high to be  
removed if building  
not used in association  
with house

1.8 m high close  
boarded fence

New rainwater water  
butt with connection  
to irrigation to garden  
area

1800 mm high fences

Existing pavement

Existing grass verge

Existing  
crossover  
Viewing splay  
2m from 2 m  
back from edge  
of pavement

RIVERVIEW ROAD

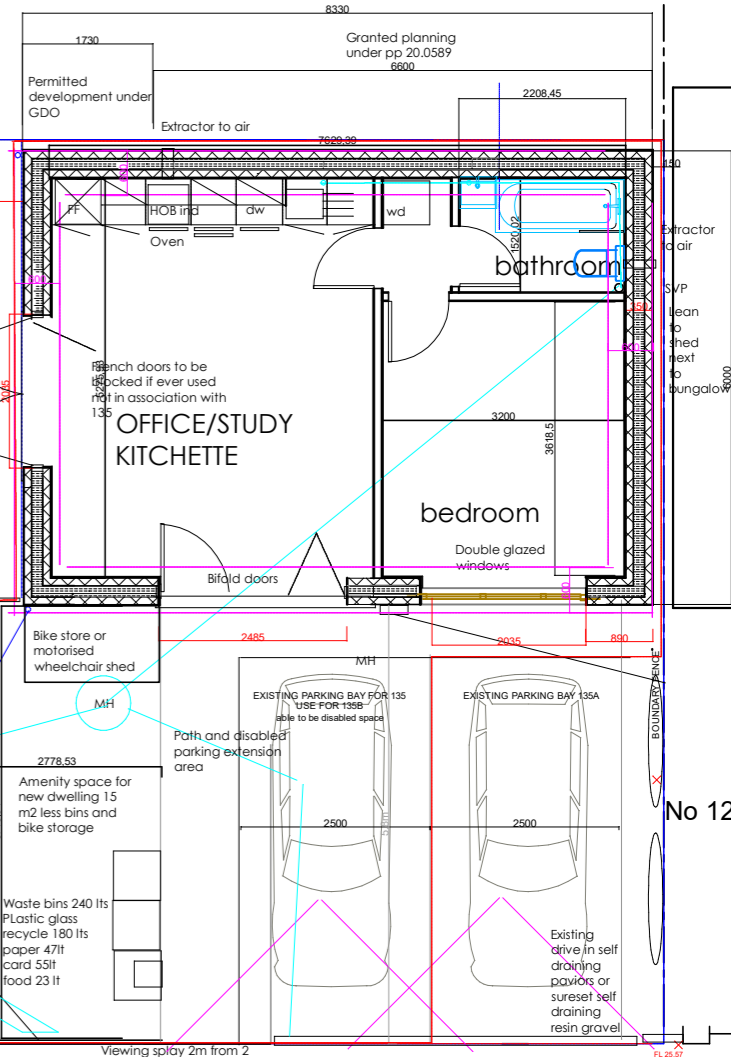

No 124