

Plan of North Coombe Farm Tiverton Fitzpaine.

Planning No 10/073/0025 (62)
10/073/0025 (62)

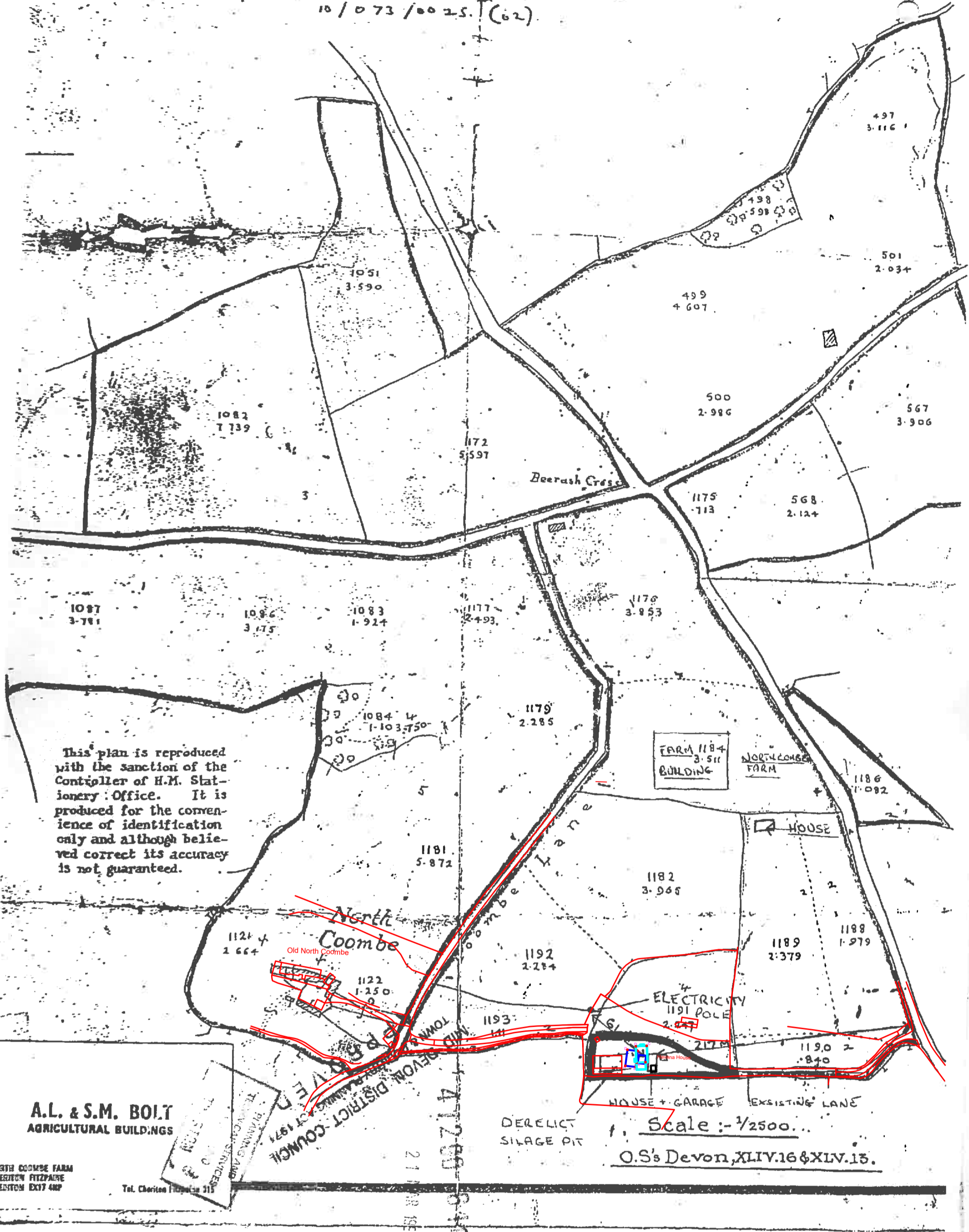

This plan is reproduced with the sanction of the Controller of H.M. Stationery Office. It is produced for the convenience of identification only and although believed correct its accuracy is not guaranteed.

A.L. & S.M. BOLT
AGRICULTURAL BUILDINGS

Scale :- 1/2500...
O.S's Devon XLIV.16 & XLV.15.

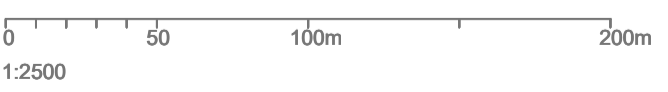

1:2500

Key

- Mastermap Ordnance Survey data.
- As approved location of dwelling and garage from planning permission reference 90/000610/FULL.
- Dwelling as built drawn using geotagged aerial photography and survey measurements.

Measurements

- A - A = 8.4 metres
- B - B = 7.5 metres
- C - C = 7.4 metres
- D - D = 6.7 metres

Issue	Date	Revision

Acorn

RURAL PROPERTY CONSULTANTS

1b Oaklands Court, Tiverton Business Park,
Tiverton, Devon, EX16 6TG
T: 01884 212380

Client
Mr & Mrs Bolt

Site
Havana House
Cadeleigh
Tiverton
EX16 8HT

Project
Certificate of lawfulness for dwelling (use class C3) with unrestricted occupancy - dwelling free from the encumbrance of the planning conditions attached to planning permission 4/12/90/610

Title
Mastermap OS data and position of built dwelling overlaid on extract from location plan stamped approved and 21 March 1990

Drawing No. ARPC4 Issue:
Scale 1:2500 (A2)
04 August 2023

Copyright Acorn Rural Property Consultants 2023
Ordnance Survey Crown Copyright 2023. All rights reserved. Licence No. 100022432
E&O.E
For submission with planning application.