

1. All boundaries, dimensions and levels are to be checked on site before construction and any discrepancies are to be reported to Orchil. 2. This drawing is copyright and may not be reproduced or used for any purpose other than that intended without the prior written agreement from Orchil Architectural Consultants.

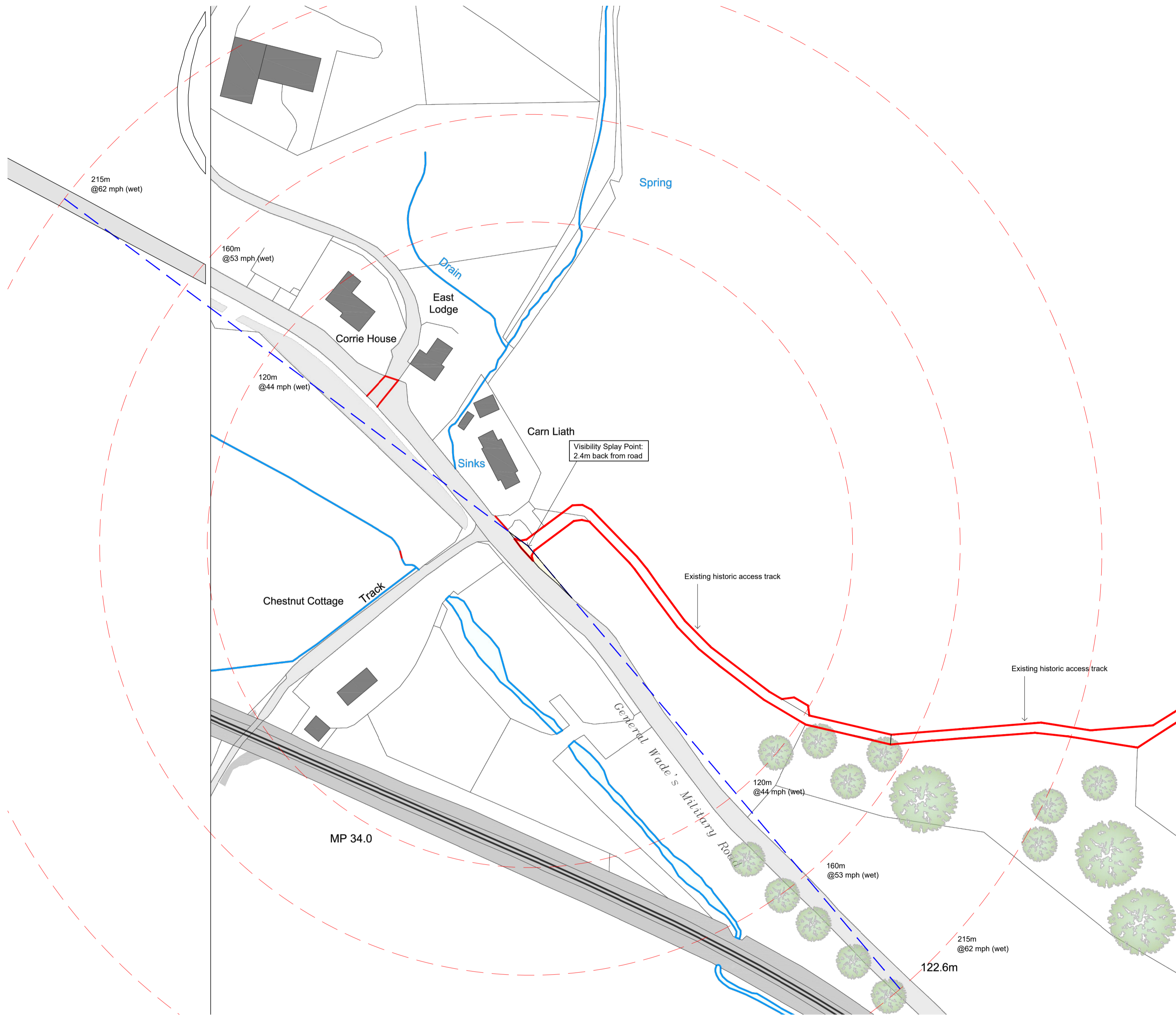
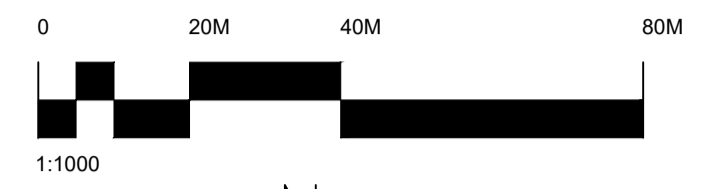

**215m Visibility Splay Plan - (set at 2.4m from road edge)**

**Scots Road Development Guide: (extract notes)**

**Visibility Splay**  
 Visibility splays are calculated in the same manner to the method used in the Urban area for the X distance, but the speed which the Y distance is based on will be higher.  
 In certain circumstances, the design speed for the road will not be known and it may be necessary to measure the actual speed at which the traffic is travelling in order to calculate the Y distance.

**Speed Visibility Relationship**  
 Where the traffic speed can be measured, the 85% i.e. speed should be measured in wet weather and then this measured speed can be compared against the speed, or the next highest speed in Table 8, which then gives the Y distance. If there is not an opportunity to measure the speed then Table 8 should be used and the Y distance obtained from the appropriate speed limit.

Table 8 - Wet Weather - 8.5 Percentile Speed

Major Road Speed (mph)	75	62	53	44	37.5	30
Y Distance (m)	295	215	160	120	59	43

Table 8 - Speed Limit

Major Road Speed (mph)	70	60	50	37	30
Y Distance (m)	295	215	160	59	43

Rev	Date	Description	By	CHK
A	16.10.23	Amended for planning	JH	BH

**Orchil**  
 Architectural Consultants  
 The Barn, Mains of Orchil  
 Killiecrankie  
 Pitlochry  
 Perthshire  
 PH16 5LR  
 t: 01796 470082  
 e: mail@orchilarch.co.uk  
 w: www.orchilarch.co.uk

Client:  
 Paul Fleming

Project:  
 Strathgroy Farmhouse  
 Killiecrankie

Drawing title:  
 Vehicular Access Visibility Splay Plan

Scale(s)	Size	First issue:	Drawn:	Checked:	
1:1000	A1	03.08.23	JH	BH	
Job no:	299	Drawing no:	07	Rev:	A