

Arboricultural impact assessment/tree survey

The attached drawing indicates location of existing trees and vegetation. The proposal is to retain all trees, subject to the requirement of the foundations scheme.

The foundation scheme at this stage has not been designed.

- Options
- Trench fill foundations
- Ground beam and piling
- Combination of the above.

The foundation scheme will be designed so as to have as little an impact as possible for the proposal.

Additional information and arboricultural impact will be clarified following planning decision being given (possibly with conditions) or if requested for further information for a formal report.

- Tree Reference
- T0 - Cedrus
 - T1 - Pinus
 - T3 - Chamaecyparis
 - T4 - Willows
 - T5 - Ornamental Prunus
 - T6 - Copper Beech
 - T7 - Chamaecyparis
 - T8 - Laburnum
 - T9 - Scotts Pine
 - T10 - Chamaecyparis
 - T11 - Cherry

Foundations for proposed houses are to be designed and detailed to allow for retention of adjacent trees within tree root influence zone.

Further investigation required and developed by structural engineer.

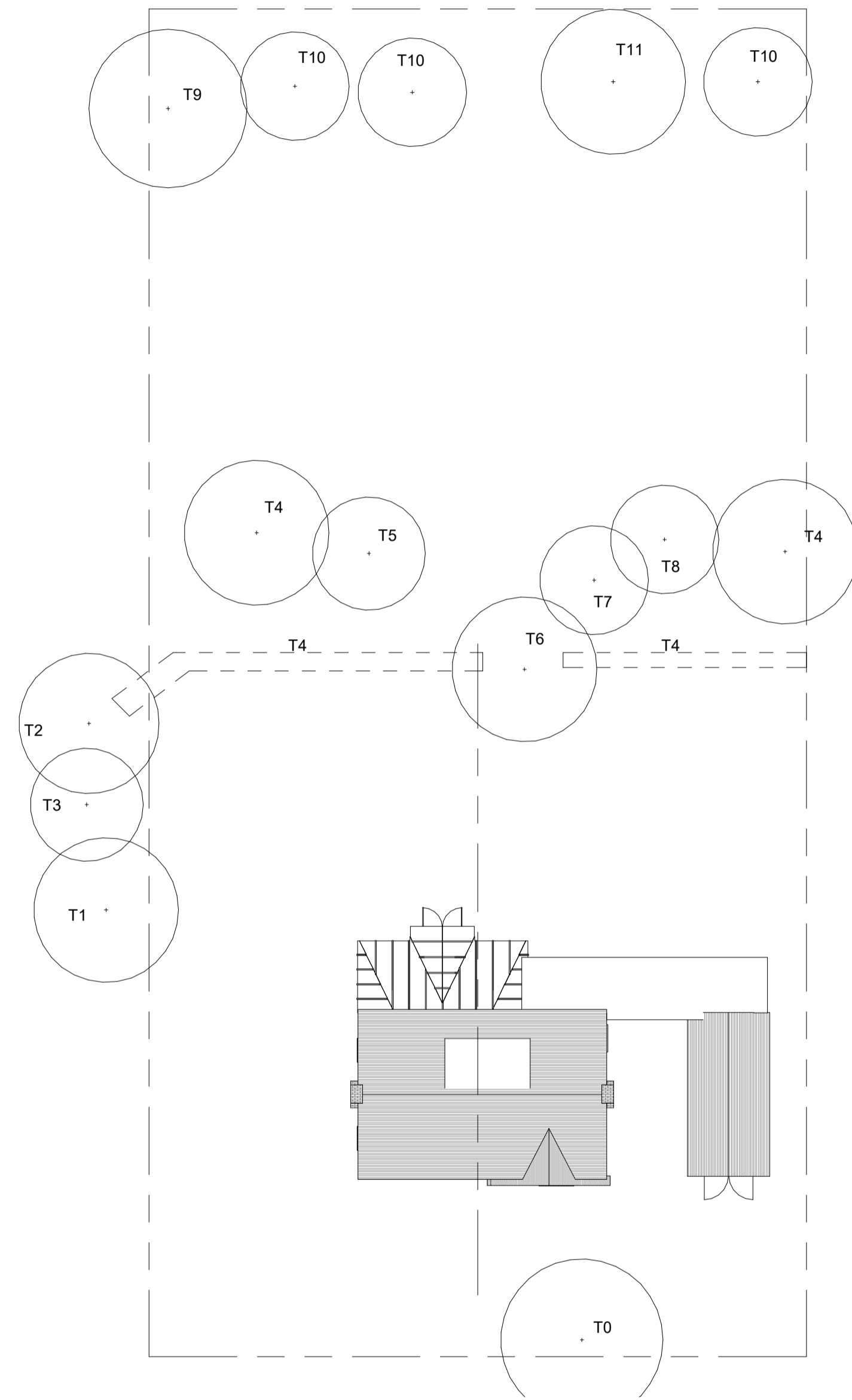

E Existing Site - Trees
1: 200

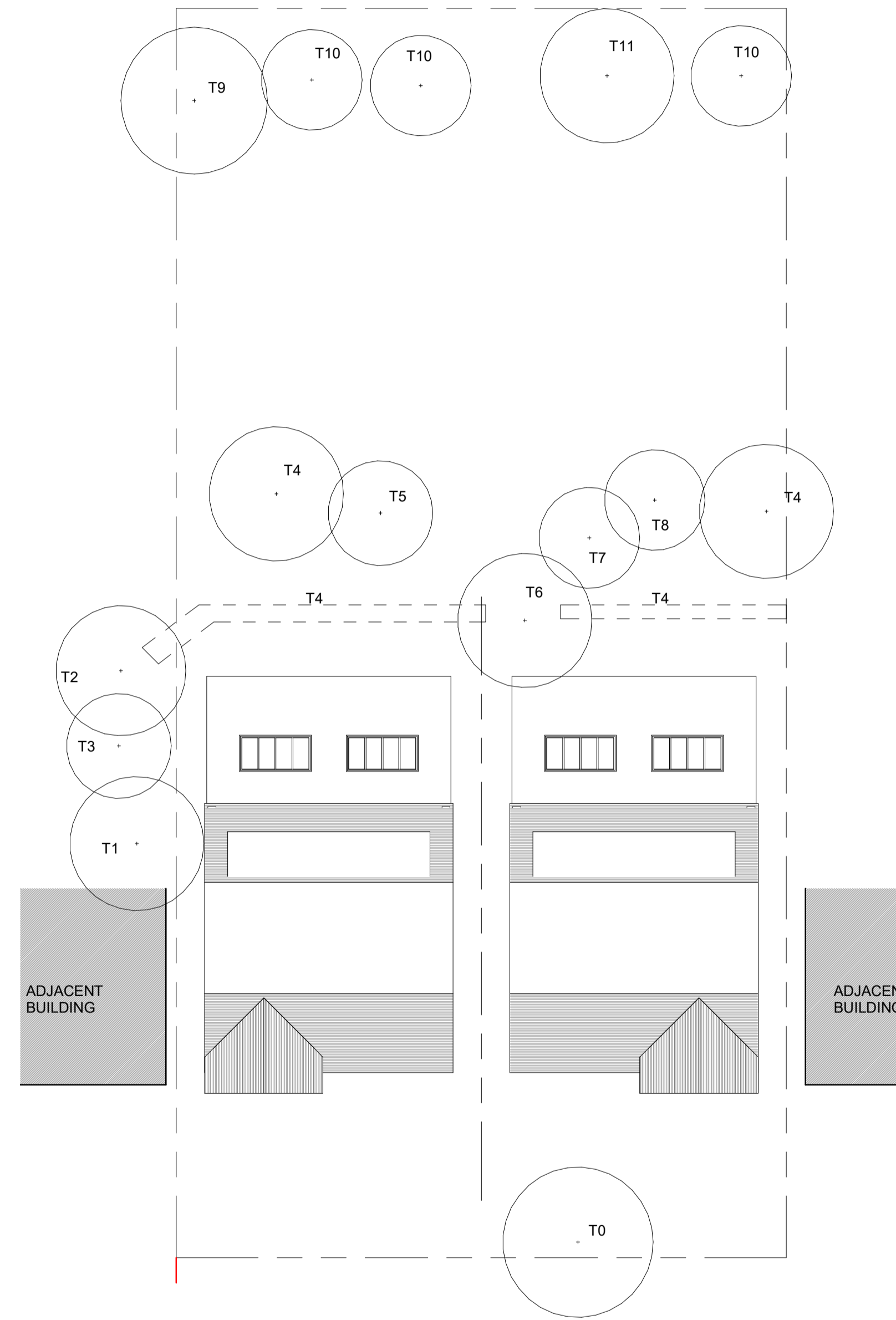

P Proposed Site - Trees
1: 200

TREE LAYOUT ADJACENT TO EXISTING AND PROPOSED HOUSES.

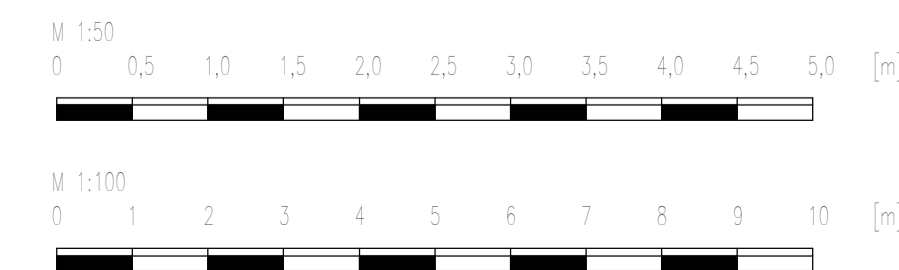

Rev	Date	Tree survey information	Description
	23.10.2023		
Client Peter Scott			
Project Title 22 The Close Dartford DA2 7ES			
Drawing Title EXISTING AND PROPOSED HOUSE PLANS SHOWING TREE LOCATIONS			
ETC DESIGN <small>92 MERLIN ROAD, WELLING, KENT DA16 2JR Mob: 07951 768098</small>			
Scale 1: 200@A1			
Date	Oct 23	Drawn by	ETC
Status	PLANNING SUBMISSION	CHK'd	ETC
		App'd	COU
Dwg No.	22THCL/005	Rev.	-