

**Dontaking / Demolition Notes**

1. All partitions, ceilings, floor coverings, fixtures and fittings associated with the WC and tea prep area to be removed. Floors to be taken back to screed.
2. Existing doors and roller shutters to be removed, including housing box.

Note: staging of the above works to be confirmed with contractor.

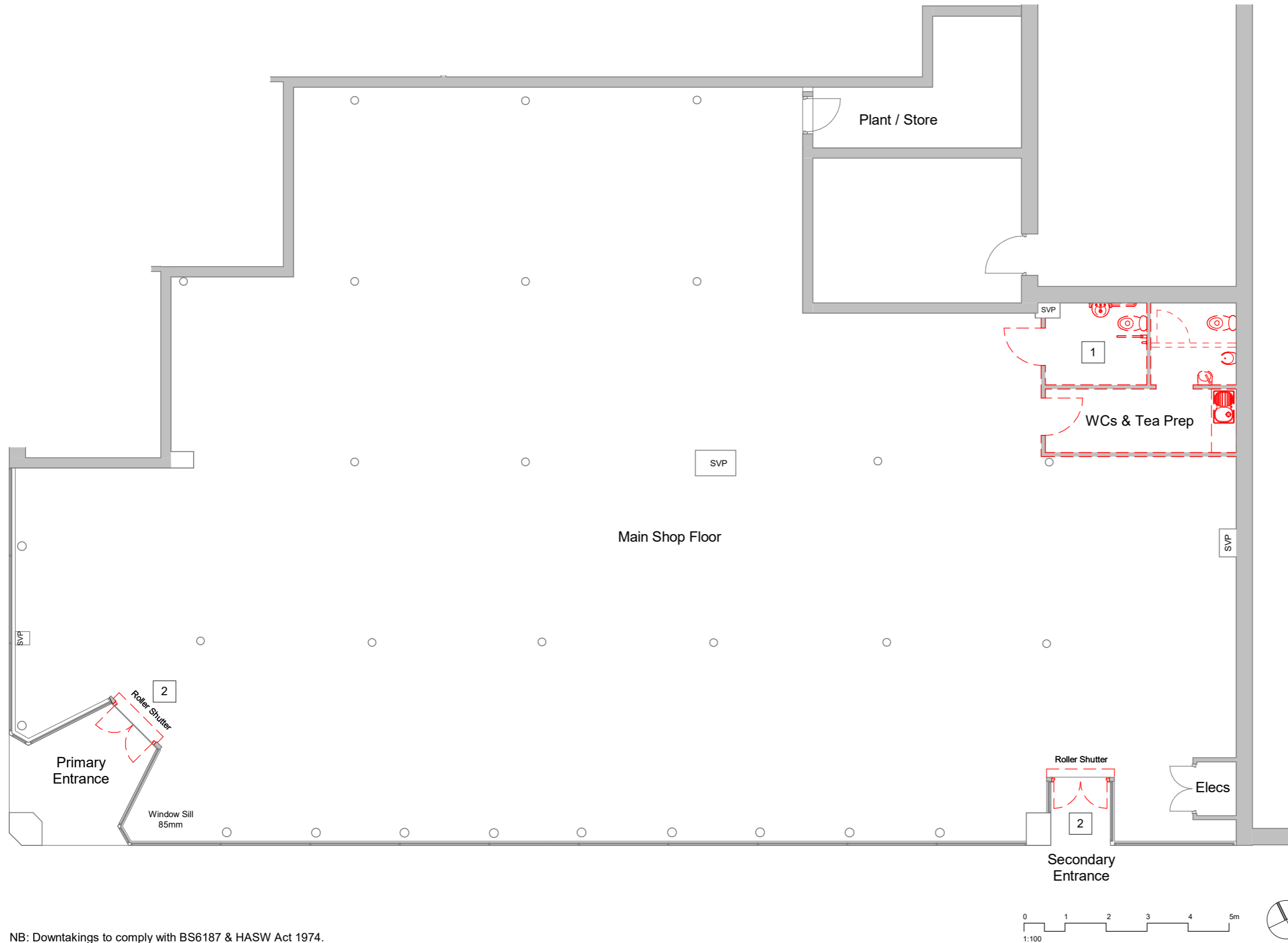

**Key:**

- - Elements to be removed - refer to notes on dwg

**Notes:**

All dimensions to be checked on site prior to the start of any work and discrepancies notified in writing.

Contractor to comply with current CDM regulations, health & safety plan, BS8000 & relevant codes of practice.

All works to be carried out in compliance with the Building (Scotland) Regulations 2004 (Non-Domestic).

Refer to engineers drawings for all structural, heating, lighting, drainage and ventilation information.

Rev	Description	Date

**DRAWING STATUS**

**PLANNING**

**Glasgow City Health & Social Care Partnership**

Glasgow City HSCP  
Health and Social Care Partnership

Commonwealth House, 32 Albion Street, Glasgow, G1 1LH  
www.glasgowcity.hscp.scot

**PROJECT**

Complex Needs Service  
59-61 Bell Street,  
Glasgow

**TITLE**

Dontakings Plan - Stage 2

<b>DRAWN BY</b> CO	<b>CHECKED BY</b> MD	<b>DATE</b> 18/10/23
<b>SCALE (@ A3)</b> 1 : 100		<b>PROJECT NUMBER</b> 2-002
<b>DRAWING NUMBER</b> AL(09)02		<b>REV</b>

DO NOT SCALE: WORK TO FIGURED DIMENSIONS ONLY

NB: Dontakings to comply with BS6187 & HASW Act 1974.

