

NOTE
 This drawing is the copyright of G1 Architects and the contents shall not be reproduced or used for any other purpose without their written permission. Do not use scaled dimensions from this drawing. All dimensions are to be verified and checked on site by the main contractor before the commencement of any work whatsoever, either on his behalf or for subcontractors or suppliers. Shop drawings to be presented to the architect for approval prior to fabrication. All discrepancies are to be reported to the architect immediately. Drawing to be read in conjunction with all other architects, engineers and specialists drawings & specifications.
 If in doubt ASK

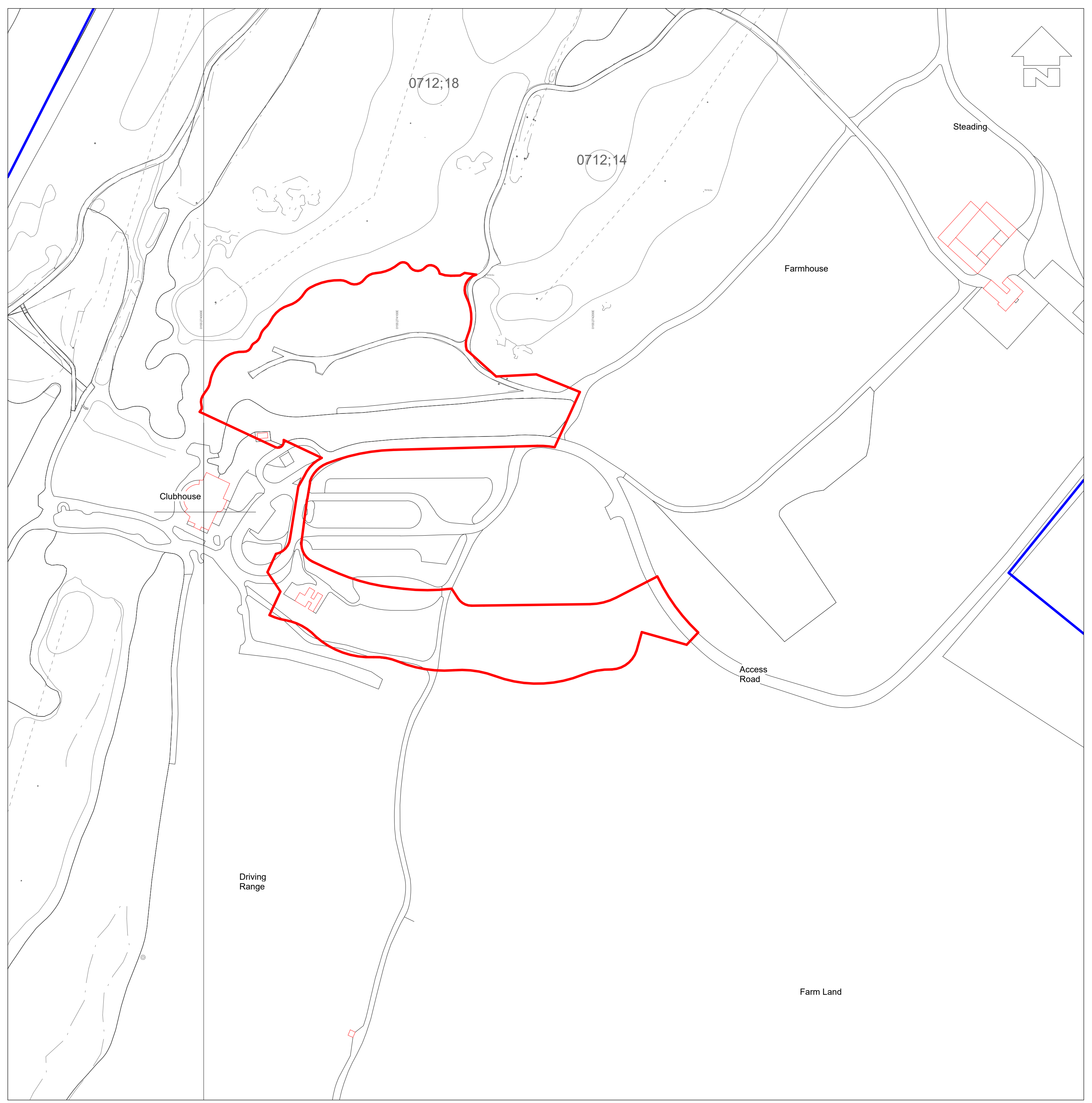

Location Plan
 1:1250
 0 50 100 m

Location Plan Legend
 1:500
 Planning - Site Boundary
 Planning - Ownership Boundary

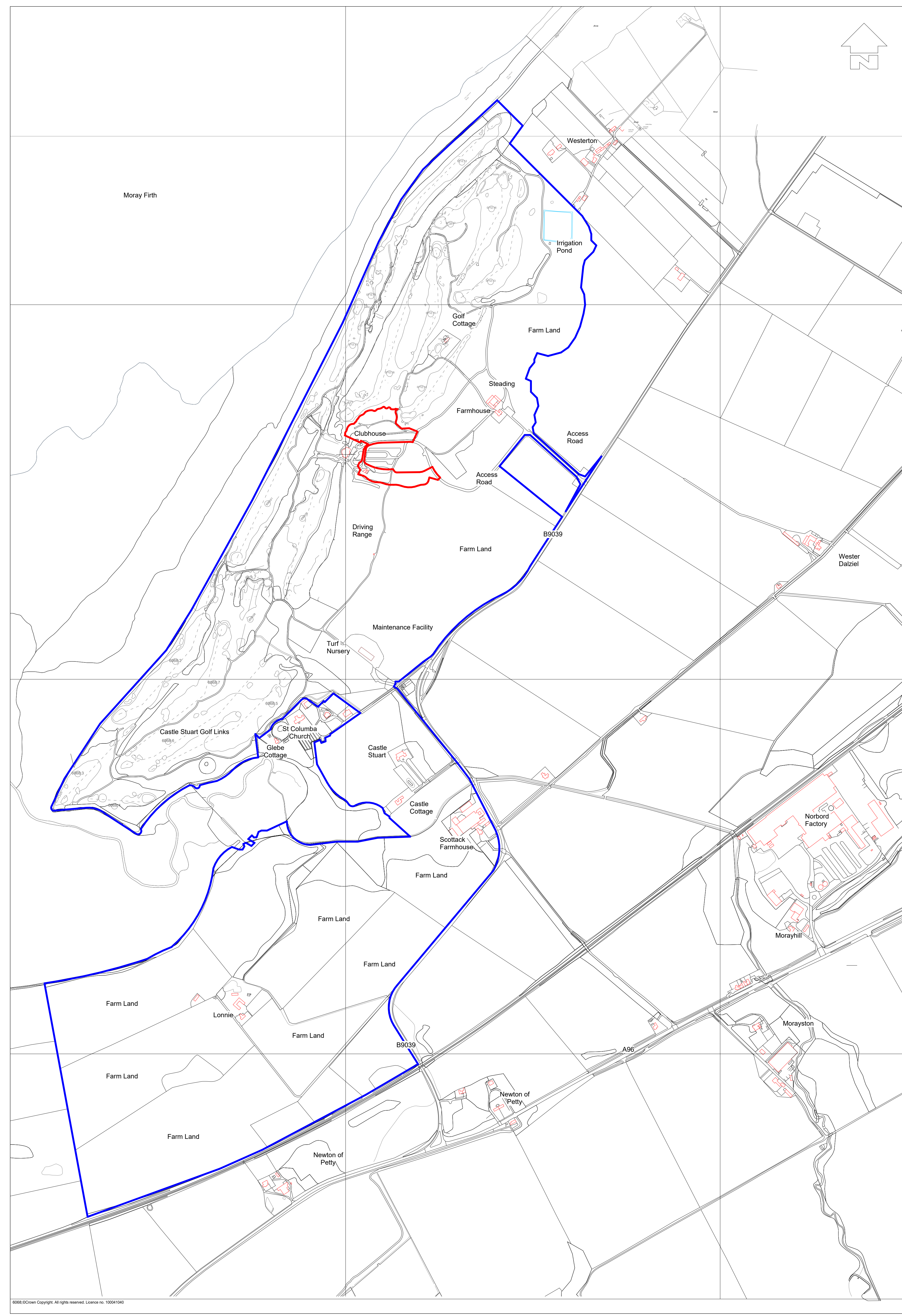

Supplementary Location Plan
 1:5000
 0 250 500 m

CONCEPT DESIGN:
HART HOWERTON
 NEW YORK - SAN FRANCISCO
CLIENT:
CABOT

G1 Architects
 G1 Architects
 3rd Floor West
 211 Dumbarton Road
 Glasgow G11 6AA
 T 0141 334 4881
 info@g1architects.com
 www.g1architects.com

No.	Description	Date
Revision Notes		

Drawing Status	Suitability
Planning	

Project	Drawing Title
Lodges	Location Plans
Cabot Highlands, Dalcross, Inverness, Scotland, IV2 7JL	

Scale	Size	Drawn	Checked	Date
As indicated	PD	DB		08/29/23

Drawing No.	Revision
815_04-G1-S1-XX-DR-A-LP01	