

Do not scale from this drawing.

SAFETY HEALTH AND ENVIRONMENTAL INFORMATION

IN ADDITION TO THE HAZARD/RISKS NORMALLY ASSOCIATED WITH THE TYPES OF WORK DETAILED ON THIS DRAWING, NOTE THE FOLLOWING RISKS AND INFORMATION.

RISKS LISTED HERE ARE NOT EXHAUSTIVE. REFER TO DESIGN ASSESSMENT FORM NO.

CONSTRUCTION:
LIVE PRIMARY ROUTE TRAFFIC (B9039). UTILITIES TO BE DIVERTED/PROTECTED

DEMOLITION:
NONE THAT WOULD NOT BE APPARENT TO A COMPETENT CONTRACTOR

FOR INFORMATION RELATING TO USE, CLEANING AND MAINTENANCE SEE THE HEALTH AND SAFETY FILE.

IT IS ASSUMED THAT ALL WORKS WILL BE CARRIED OUT BY A COMPETENT CONTRACTOR WORKING, WHERE APPROPRIATE, TO AN APPROVED METHOD STATEMENT.

- Notes:**
- All dimensions on this drawing are in metres unless noted otherwise. Do not scale from this drawing, only written dimensions are to be used.
 - This drawing is to be read in conjunction with all architectural and engineering drawings, details and specifications.
 - All work to comply with Highland Council's Roads and Transport Guidelines for New Developments.
 - Prior to roads construction works, the appointed Contractor is to submit laboratory CBR & PSD test results and details of any capping requirements to the engineer or roads officer at Highland Council who is processing the Roads Construction Consent application.
 - Road signs and markings to be in accordance with the Traffic Signs Regulations And General Directions 2016.
 - The contractor is responsible for checking the line and level of existing services prior to the commencement of works. Any discrepancies from design information must be reported to the Site Manager and Site Engineer in writing.
 - Any discrepancies should be reported to the engineer immediately so clarification can be sought.
 - All existing services to be located prior to any construction work being carried out. The locating of any mains and services must be undertaken by hand dug trial holes. The approval of the appropriate utility must be sought before any mechanical plant is used.
 - Underground services must be located in accordance with Health and Safety Executive Guidance note HSG 47.
 - Overhead services stand off and safe working areas must be implemented per the guidance in Health and Safety Executive Guidance Note GS6.
 - For clarity this drawing should only be printed and read in colour.

XX.XX - Denotes external level
XX.XX - Denotes door level

B	05.10.23	Step information to north plots updated.	AH	AH	AKF
A	03.10.23	Architect's Layout Updated	LB	AH	AKF
Rev.	Date	Description	Drawn	Chkd.	Appd.

Client: **FAIRHURST** Castle Stuart Golf LLP

Elvie House
Beechwood Business Park
WICKNESS
IV2 3BW

Tel: 01463 724 544
Fax: 0844 381 4412

Project Title: **Cabot Highlands Proposed Golf Lodge Facilities**

Drawing Title: **Roads Layout Sheet 2 of 5 North West**

Scale at A1:	Status:	Approved:
As Shown	Planning	LB
Drawn:	Checked:	Date:
LB	AH	28/09/2023
Date:	Date:	Date:
28/09/2023	28/09/2023	28/09/2023
Drawing No.:	Revision:	
154163-PC-8002	B	

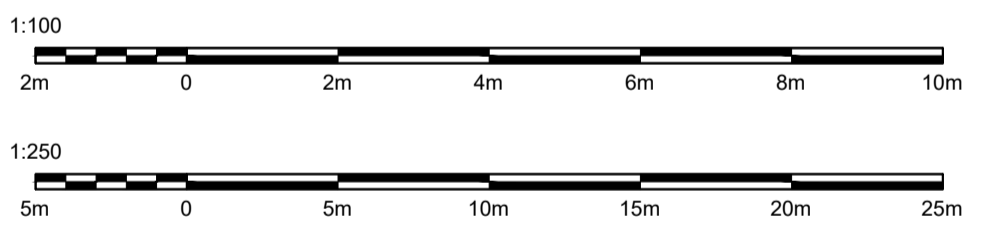
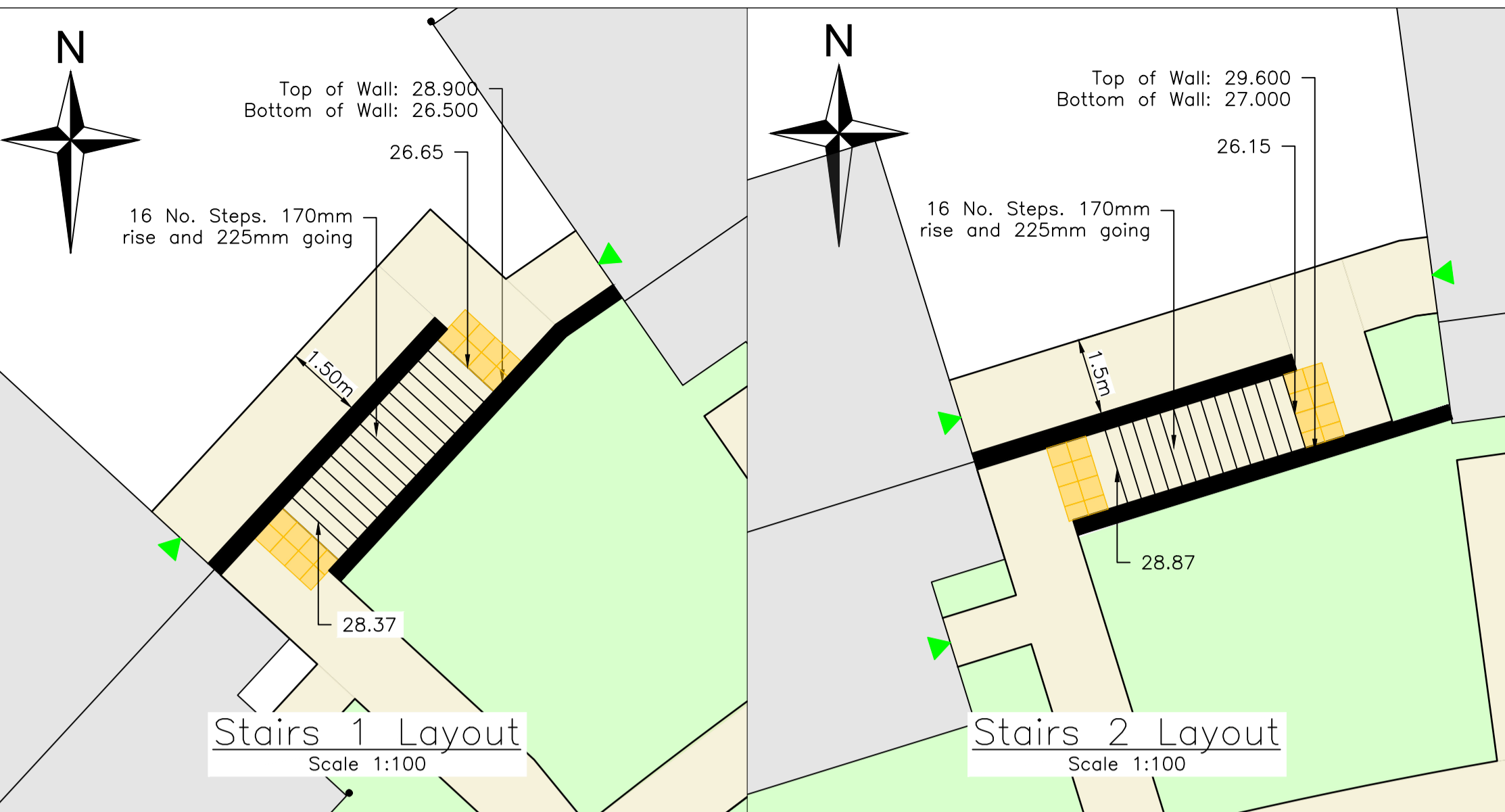

Legend:

- Proposed Road Surfacing
- Hardcore Surfacing
- Proposed Footpath Surfacing
- Proposed Block Paving Surfacing
- Proposed Landscaped Area/Grassed Verge
- Proposed Retaining Wall
- Proposed Landscaping Wall
- Proposed Gravel Board
- Site Boundary
- Proposed Corduroy Tactile Slabs
- Proposed Blister Tactile Slabs
- Proposed 1m Bio-Retention

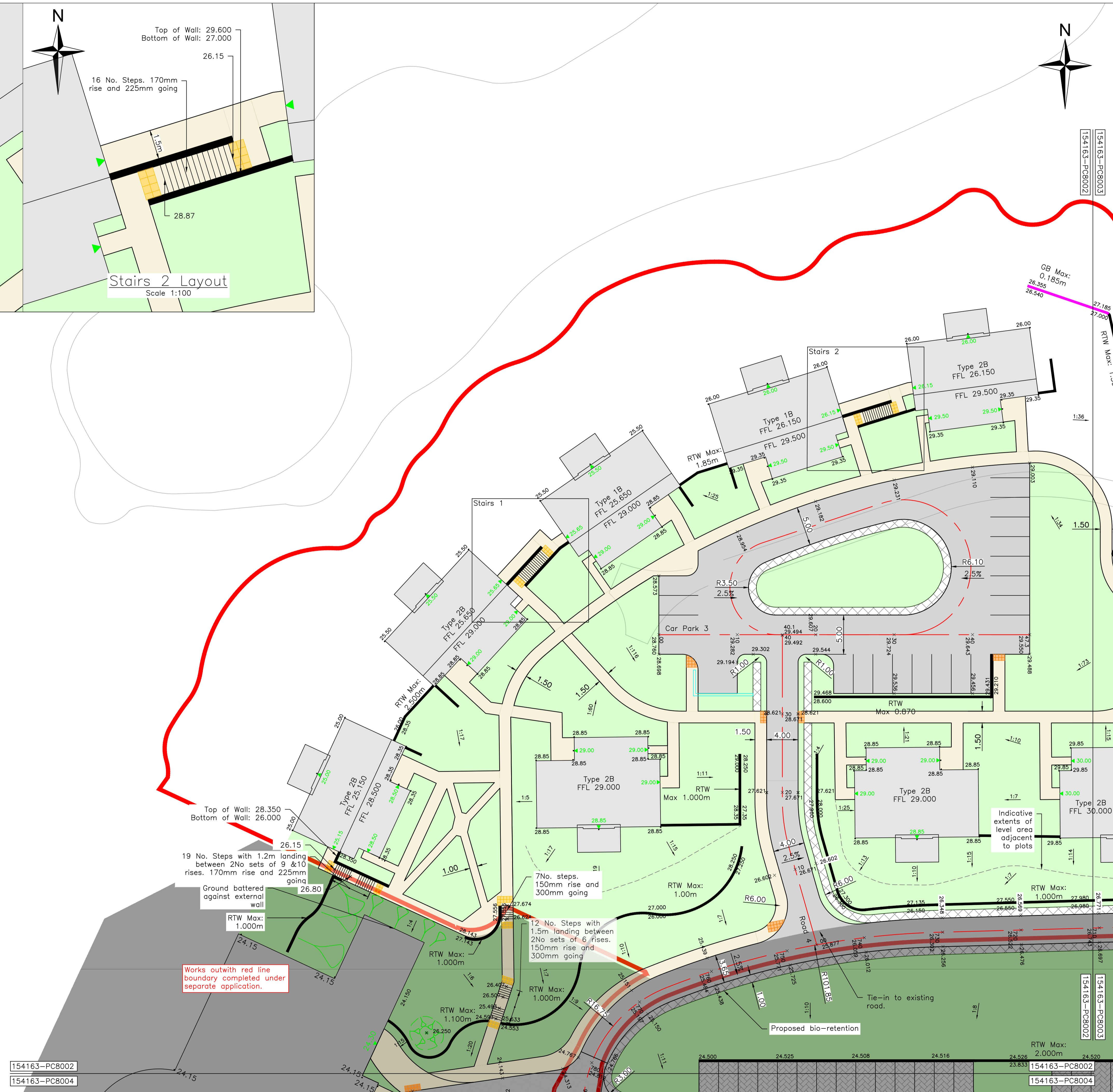

154163-PC8002
154163-PC8004
154163-PC8003
154163-PC8002
154163-PC8004