

125 x 255 Half Battered (HB) Road Kerb
Scale 1:10

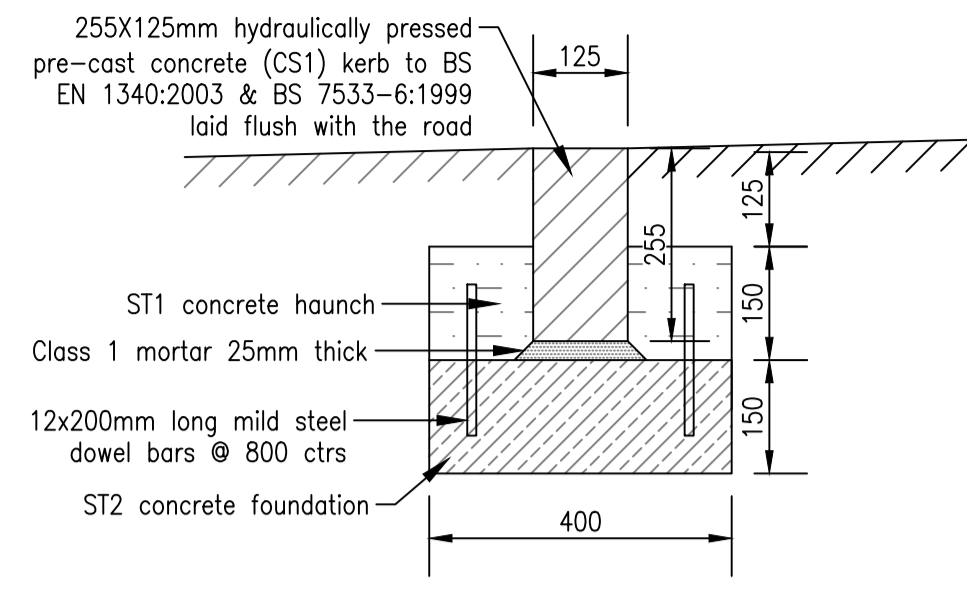

255x125 Channel (CS1) Kerb
Scale 1:10

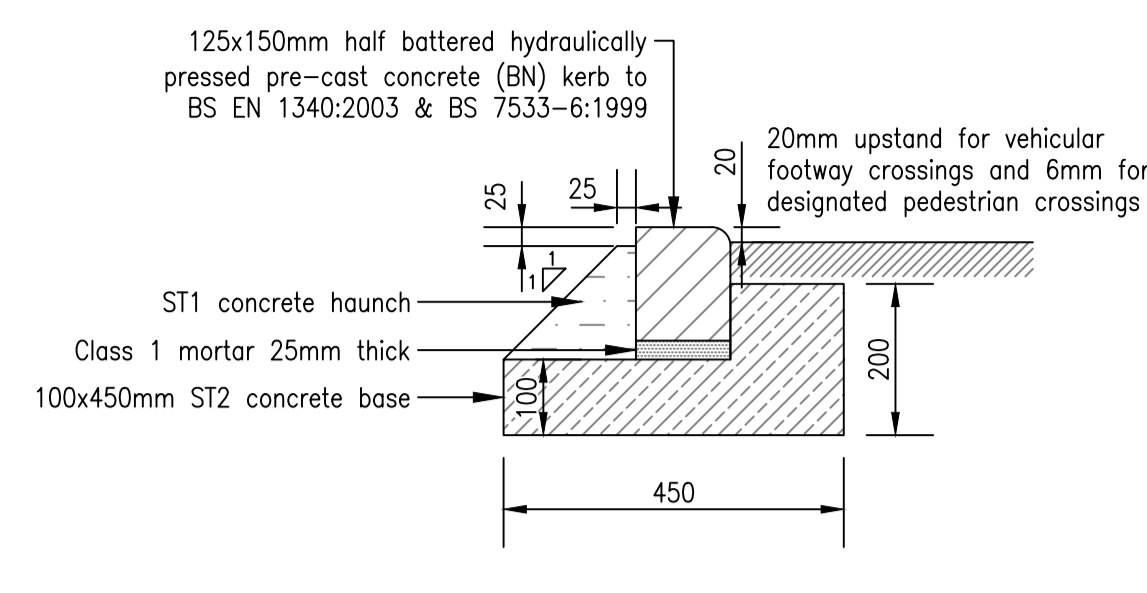

125 x 150 Bullnose (BN) Kerb
Scale 1:10

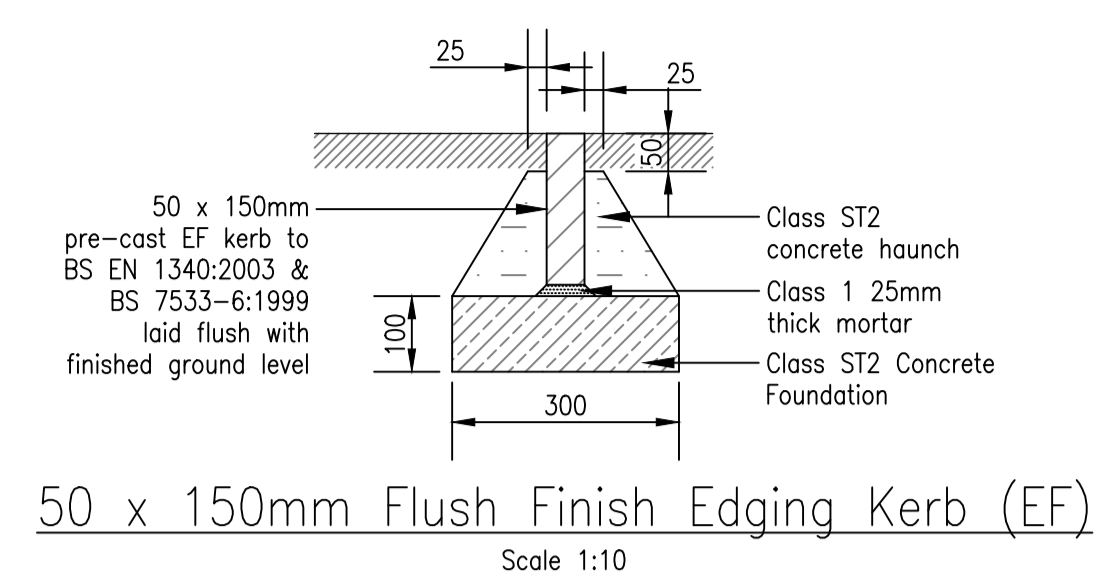

50 x 150mm Flush Finish Edging Kerb (EF)
Scale 1:10

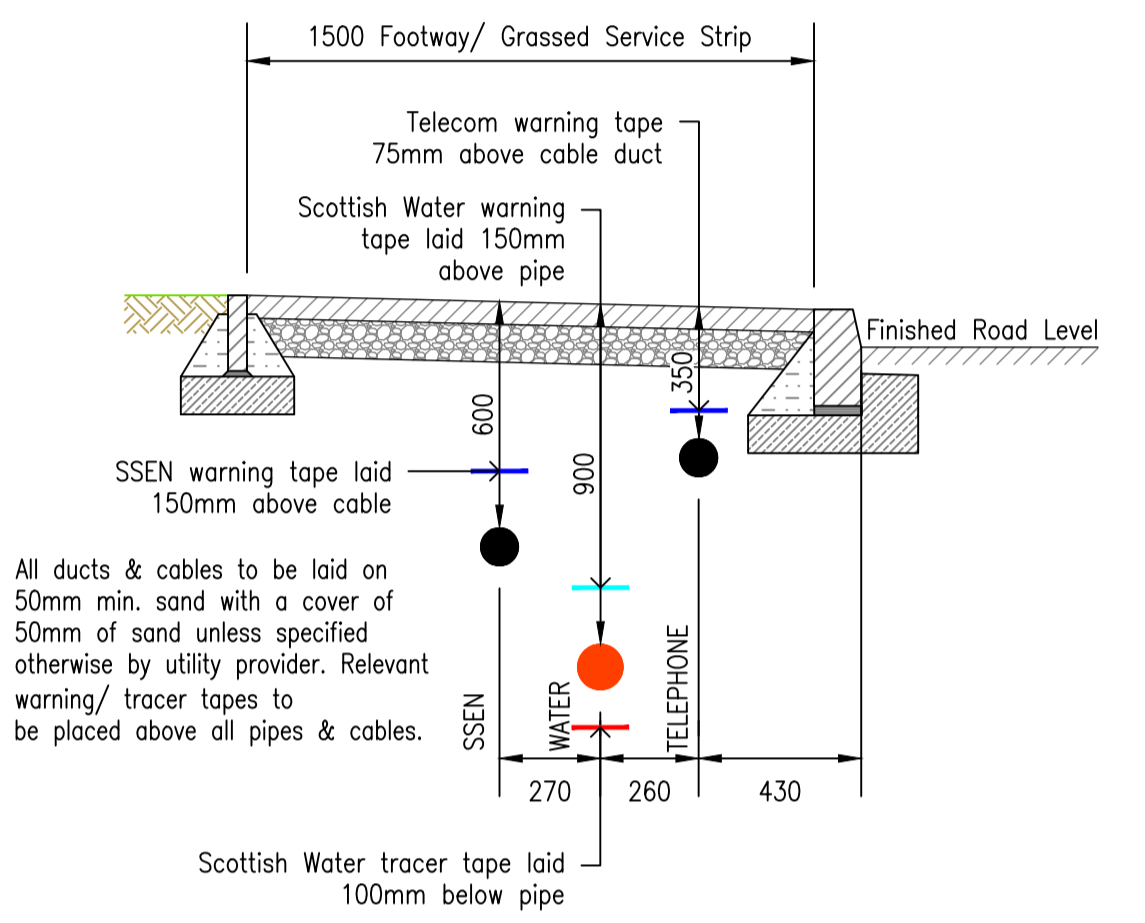

Typical Service Positions Within Footway/ Service Strip
Scale 1:20

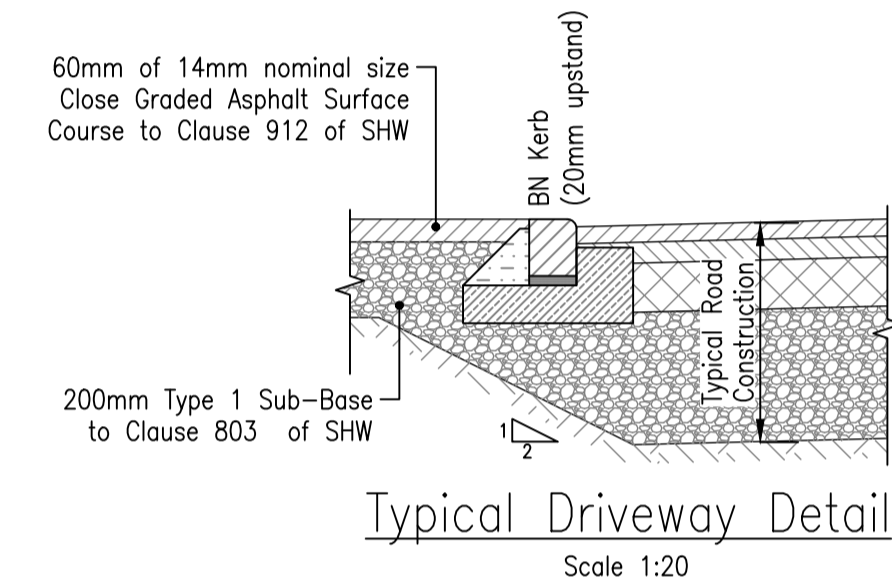

Typical Driveway Detail
Scale 1:20

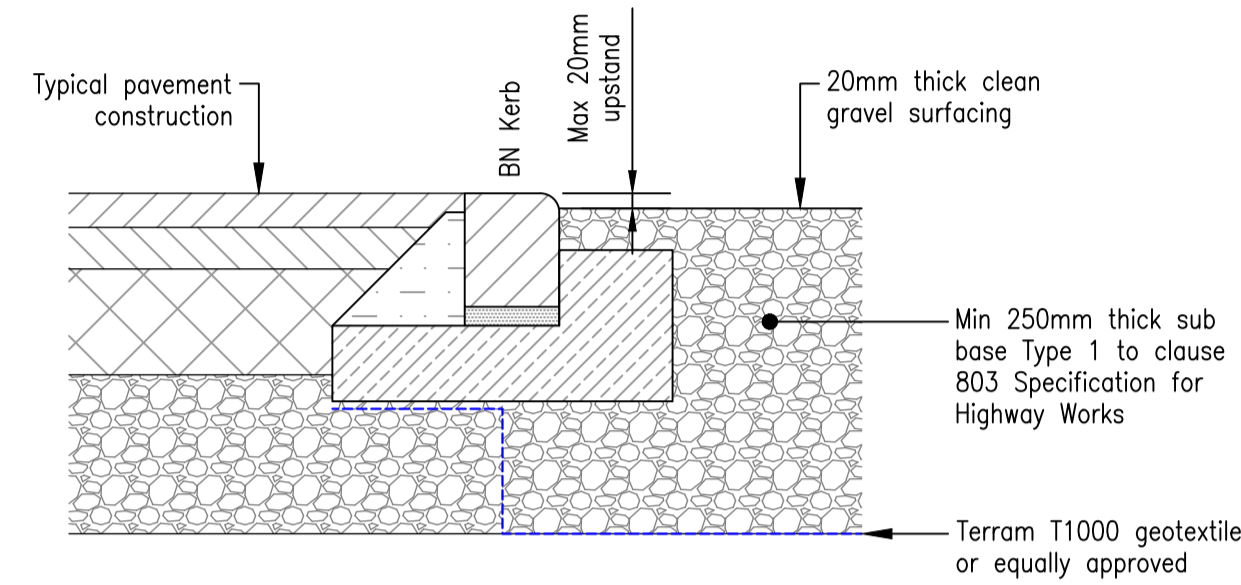

Typical Transition from Asphalt to Unbound Road
Scale 1:10

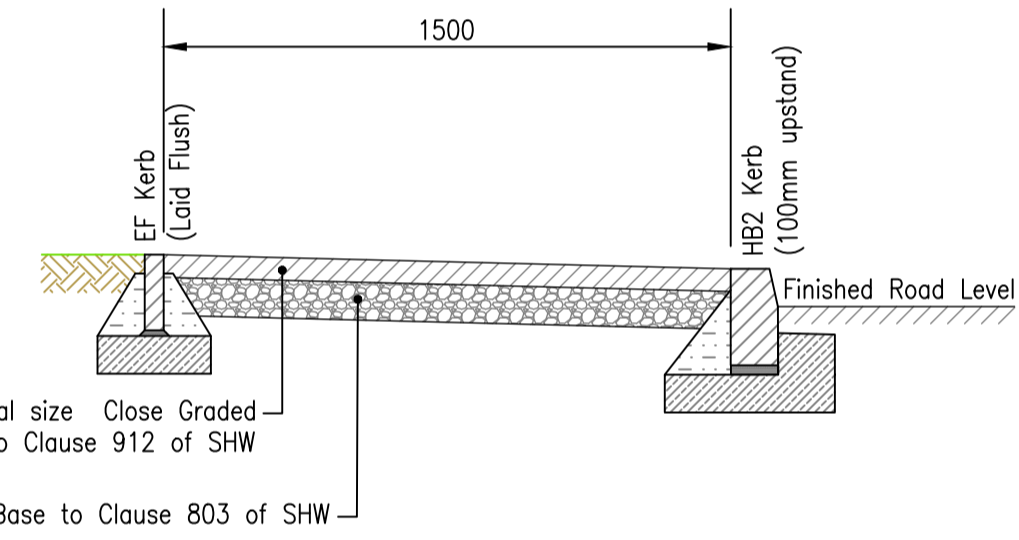

Typical Footway Construction
Scale 1:20

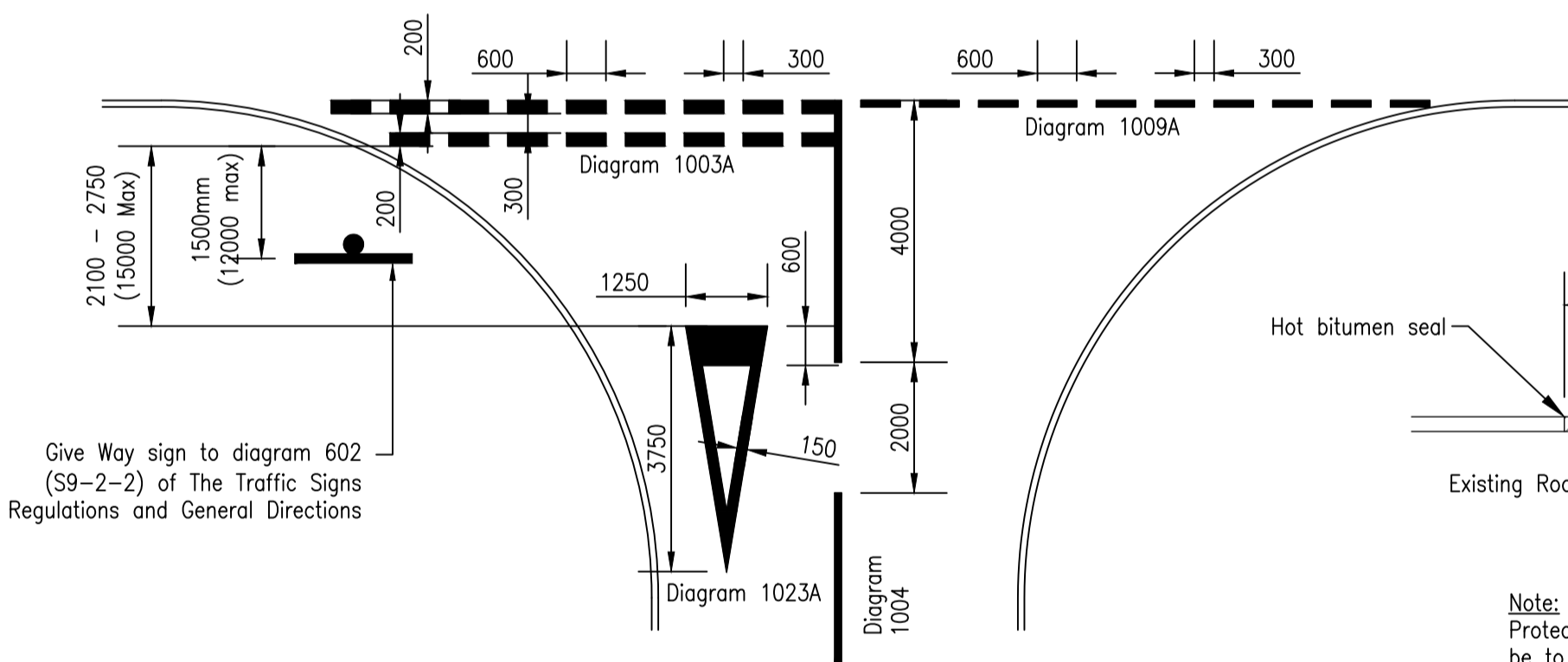

Typical Give Way Junction Detail
Scale 1:100

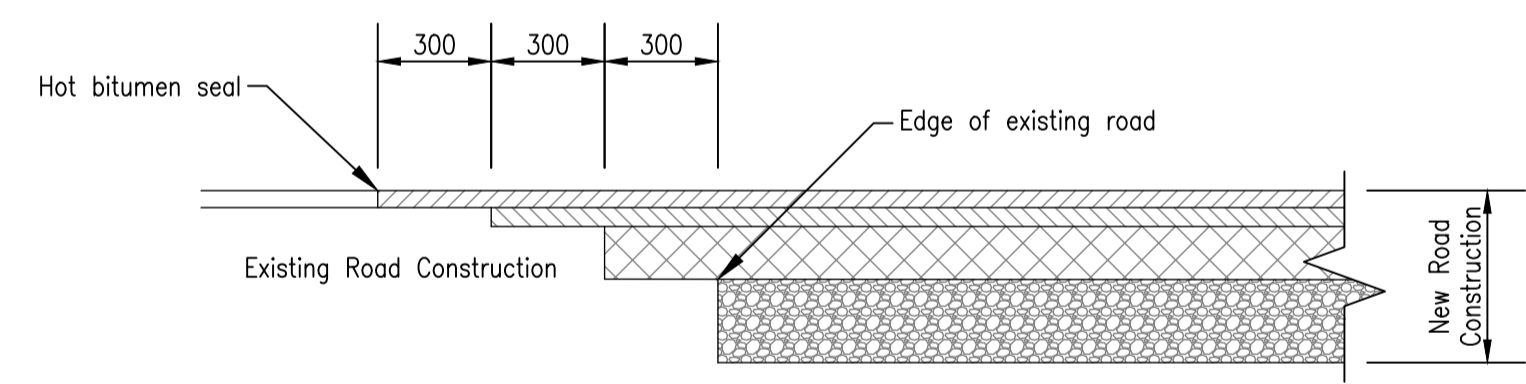

Typical New Road to Existing Road Tie-in Detail
Scale 1:20

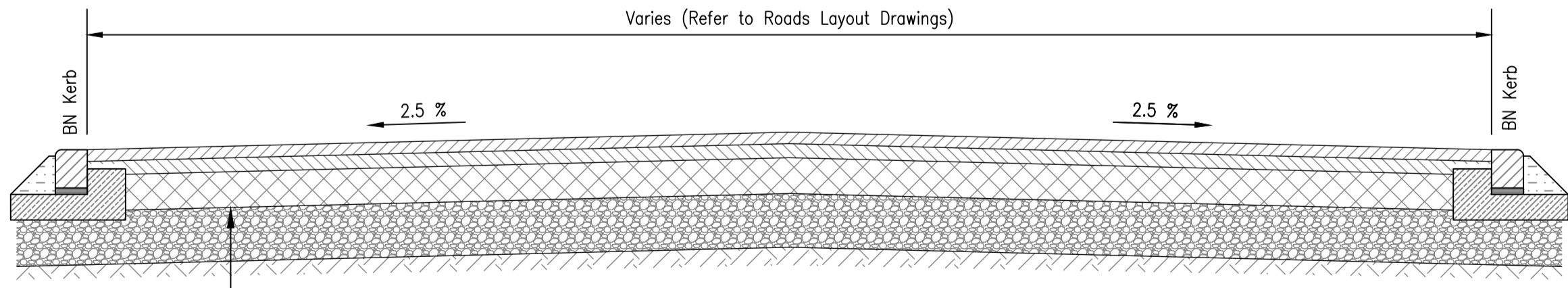

Typical Pavement Construction Detail (3% CBR)
Scale 1:20

Capping and Sub-Base thickness Based on Highland Council Guidance

CBR	Capping Thickness	Sub-Base Thickness
2.5%	250mm	350mm
5%	210mm	240mm
10%	180mm	180mm
15%	-	200mm

- Notes:**
- 450mm min cover of approved material required on frost susceptible road formation.
 - The contractor shall be responsible for identifying any soft spots within the final excavated areas. Proof rolling shall be undertaken as defined in SHW Clause 616. Where soft spots are encountered, the contractor shall inform the Engineer. The contractor shall remove all soft spots to below formation level and replace them with well compacted imported granular fill to the satisfaction of the engineer.

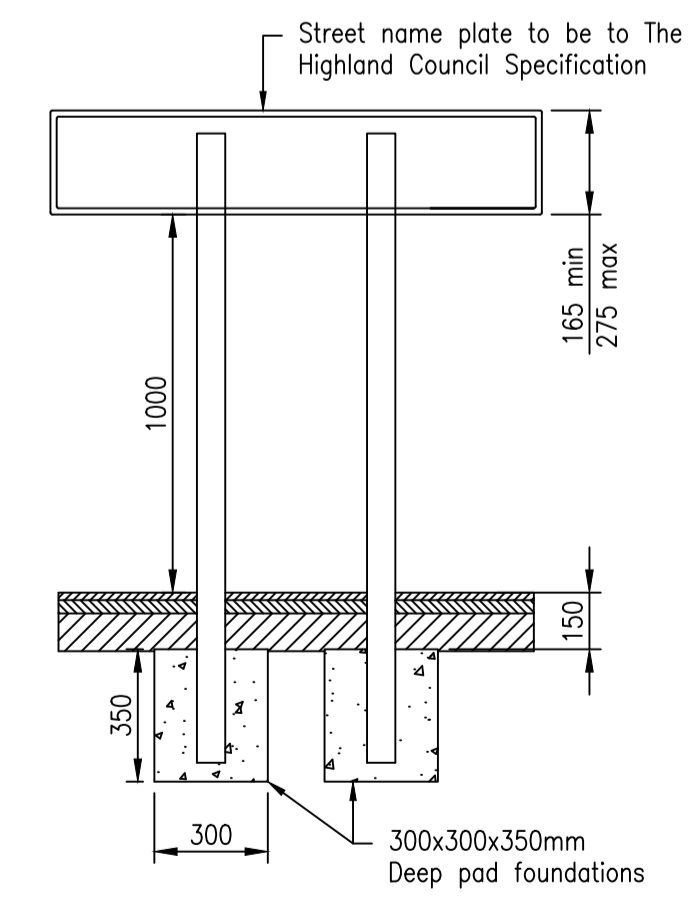

Typical Street Name Plate Detail
Scale 1:20

Do not scale from this drawing.

SAFETY HEALTH AND ENVIRONMENTAL INFORMATION

IN ADDITION TO THE HAZARD/RISKS NORMALLY ASSOCIATED WITH THE TYPES OF WORK DETAILED ON THIS DRAWING, NOTE THE FOLLOWING RISKS AND INFORMATION.

RISKS LISTED HERE ARE NOT EXHAUSTIVE. REFER TO DESIGN ASSESSMENT FORM NO. DAF01

CONSTRUCTION:
LIVE PRIMARY ROUTE TRAFFIC (B9039). UTILITIES TO BE DIVERTED/PROTECTED

DEMOLITION:
NONE THAT WOULD NOT BE APPARENT TO A COMPETENT CONTRACTOR

FOR INFORMATION RELATING TO USE, CLEANING AND MAINTENANCE SEE THE HEALTH AND SAFETY FILE.

IT IS ASSUMED THAT ALL WORKS WILL BE CARRIED OUT BY A COMPETENT CONTRACTOR WORKING, WHERE APPROPRIATE, TO AN APPROVED METHOD STATEMENT.

Notes:

- Do not scale from this drawing, only written dimensions are to be used.
- This drawing is to be read in conjunction with all architectural and engineering drawings, details and specifications.
- All work to comply with Highland Council's Roads and Transport Guidelines for New Developments.
- Road signs and markings to be in accordance with the Traffic Signs Regulations And General Directions 2016.
- Any discrepancies should be reported to the engineer immediately so clarification can be sought.
- For clarity this drawing should only be printed and read in colour.

Rev.	Date	Description	Drawn	Chkd.	Appd.
		FAIRHURST	Client: Castle Stuart Golf LLP		
		Elvie House Beechwood Business Park WICKNESS IV2 3BW	CABOT		
		Tel: 01463 724 544 Fax: 0844 381 4412			

Project Title:
Cabot Highlands Proposed Golf Lodge Facilities

Drawing Title:
Roads Typical Construction Detail Sheet 1 of 2

Scale at A1: As Shown	Status: Planning	Approved: AKF
Drawn: EM	Checked: AH	Date: 28/09/2023
Date: 28/09/2023	Date: 28/09/2023	Date: 28/09/2023
Drawing No.: 154163-PC-8050	Revision: -	