

Legend:

Proposed Road Surfacing	
Hardcore Surfacing	
Proposed Footpath Surfacing	
Proposed Landscaped Area/Grassed Verge	
Proposed Retaining Wall	
Proposed Landscaping Wall	
Proposed Gravel Board	
Site Boundary	
Proposed Corduroy Tactile Slabs	
Proposed Blister Tactile Slabs	
Proposed 1m Bio-Retention	

Do not scale from this drawing.

SAFETY HEALTH AND ENVIRONMENTAL INFORMATION

IN ADDITION TO THE HAZARD/RISKS NORMALLY ASSOCIATED WITH THE TYPES OF WORK DETAILED ON THIS DRAWING, NOTE THE FOLLOWING RISKS AND INFORMATION.

RISKS LISTED HERE ARE NOT EXHAUSTIVE. REFER TO DESIGN ASSESSMENT FORM NO.

CONSTRUCTION:
LIVE PRIMARY ROUTE TRAFFIC (B9039). UTILITIES TO BE DIVERTED/PROTECTED

DEMOLITION:
NONE THAT WOULD NOT BE APPARENT TO A COMPETENT CONTRACTOR

FOR INFORMATION RELATING TO USE, CLEANING AND MAINTENANCE SEE THE HEALTH AND SAFETY FILE.

IT IS ASSUMED THAT ALL WORKS WILL BE CARRIED OUT BY A COMPETENT CONTRACTOR WORKING, WHERE APPROPRIATE, TO AN APPROVED METHOD STATEMENT.

Notes:

- All dimensions on this drawing are in metres unless noted otherwise. Do not scale from this drawing, only written dimensions are to be used.
- This drawing is to be read in conjunction with all architectural and engineering drawings, details and specifications.
- All work to comply with Highland Council's Roads and Transport Guidelines for New Developments.
- Prior to roads construction works, the appointed Contractor is to submit laboratory CBR & PSD test results and details of any capping requirements to the engineer or roads officer at Highland Council who is processing the Road Construction Consent application.
- Road signs and markings to be in accordance with the Traffic Signs Regulations And General Directions 2016.
- The contractor is responsible for checking the line and level of existing services prior to the commencement of works. Any discrepancies from design information must be reported to the Site Manager and Site Engineer in writing.
- Any discrepancies should be reported to the engineer immediately so clarification can be sought.
- All existing services to be located prior to any construction work being carried out. The locating of any mains and services must be undertaken by hand dug trial holes. The approval of the appropriate utility must be sought before any mechanical plant is used.
- Underground services must be located in accordance with Health and Safety Executive Guidance note HSG 47.
- Overhead services stand off and safe working areas must be implemented per the guidance in Health and Safety Executive Guidance Note GS6.
- For clarity this drawing should only be printed and read in colour.

XX.XX – Denotes external level
 XX.XX – Denotes door level

A	03/10/23	Architect's Layout Updated	LB	AH	AKF
Rev.	Date	Description	Drawn	Chkd.	Appd.
		Client:			
		FAIRHURST	Castle Stuart Golf LLP		
		Elvie House Beechwood Business Park WINDRESS IV2 3BW			
		Tel: 01463 724 544 Fax: 0844 381 4412			

Project Title:
Cabot Highlands Golf Lodge Facilities

Drawing Title:
Roads Layout Sheet 3 Of 5 North East

Scale at A1: 1:250	Status: Planning	Approved:
Drawn: LB	Checked: AH	Approved: AKF
Date: 28/09/2023	Date: 28/09/2023	Date: 28/09/2023

Drawing No.: **154163-PC-8003** Revision: **A**

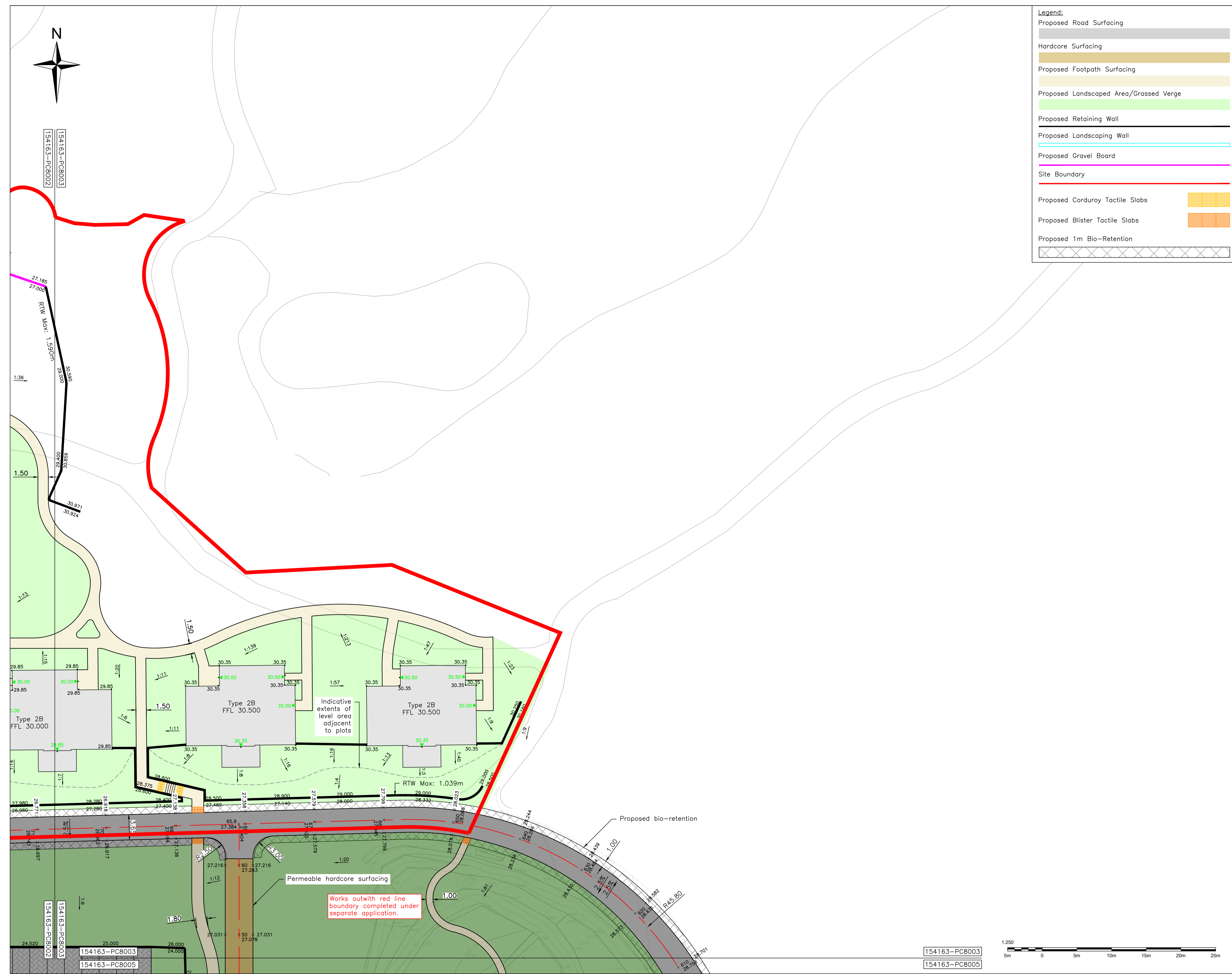

154163-PC8003
 154163-PC8005

154163-PC8003
 154163-PC8002

154163-PC8003
 154163-PC8005