

AL  
12

# 2307 COLLEGE BARN

SITE AND LOCATION PLAN  
1:500 AND 1:1250 @ A3

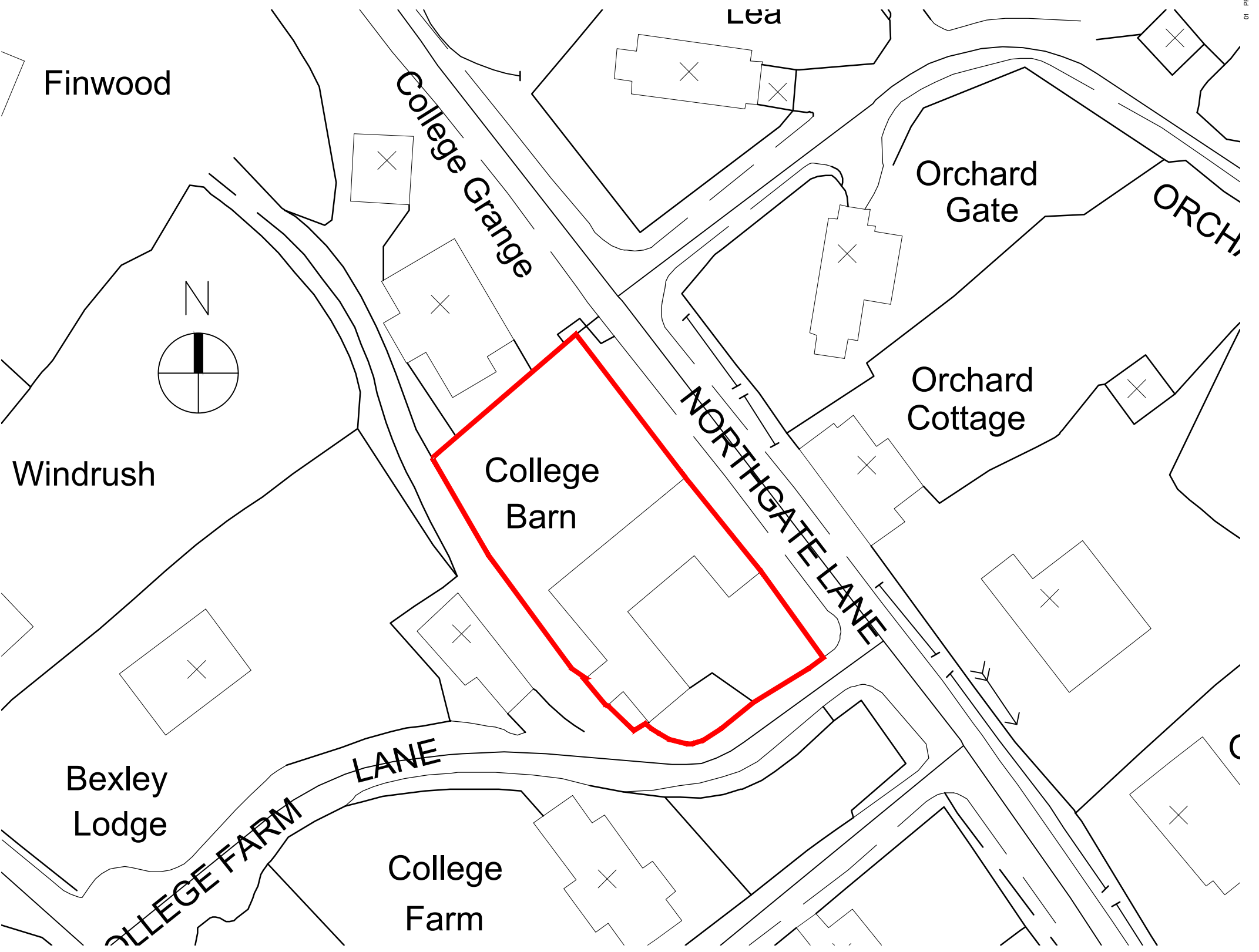
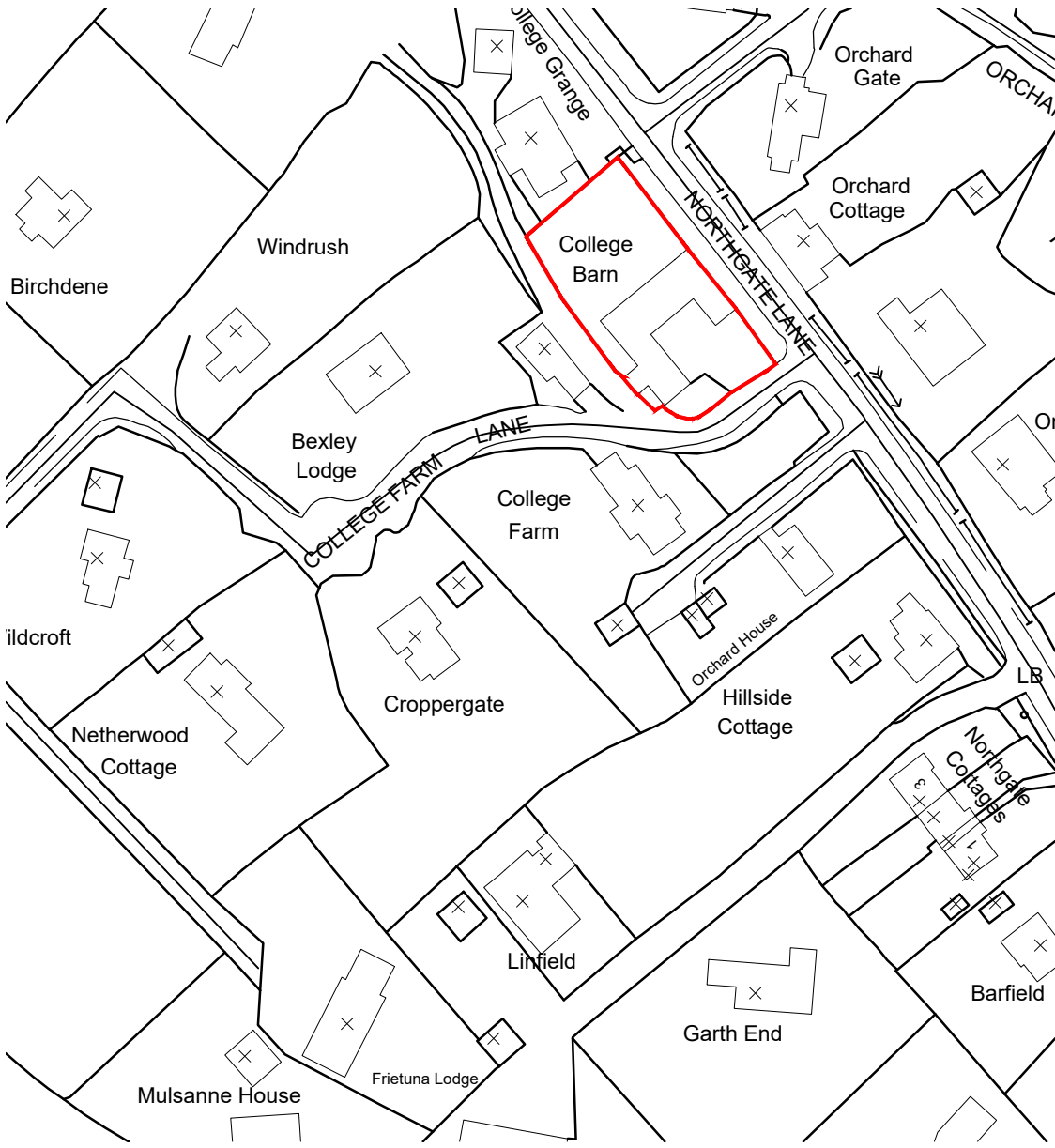

**horsley townsend consulting architects**  
horsleytownsend.com

client	MR AND MRS G BROWNE
project	COLLEGE BARN, NORTHGATE LN, LINTON LS22 4HR
drawing	SITE LOCATION PLANS
date	SEPT 2023
scale	1:100 @ A3
checked	checked
job no	2307
drawing no.	12
rev.	AS INDICATED

01 PRELIMINARY PLANS  
21/06/23  
Wetherby Office, Morcar Hill, Barrowby Lane, Kearsby Nr Wetherby, Harrogate, HG3 1HX, Tel: 019 37 567420  
COPYRIGHT RESERVED  
DO NOT SCALE