

NOTES:  
 (C) Any unauthorised use, reproduction or distribution of the document or it's contents will constitute an infringement of copyright.  
 This document is to be read in conjunction with all other relevant information.  
 Any discrepancies noted are to be raised as soon as possible. Do not scale from this drawing for construction purposes.  
 0m 1.0 2.0 3.0 4.0 5.0 6.0  
 Scale Bar 1:50  
 0m 1.0 2.0 3.0 4.0 5.0 6.0  
 Scale Bar 1:100



**East Elevation**  
 1 : 100



**North Elevation**  
 1 : 100



**West Elevation**  
 1 : 100



**South Elevation**  
 1 : 100

**Proposed Materials:**  
 Walls - smooth render painted white with granite quoins & lintels  
 Windows - white tbc  
 Roof Lights - Conservation style  
 Roof - Natural slate

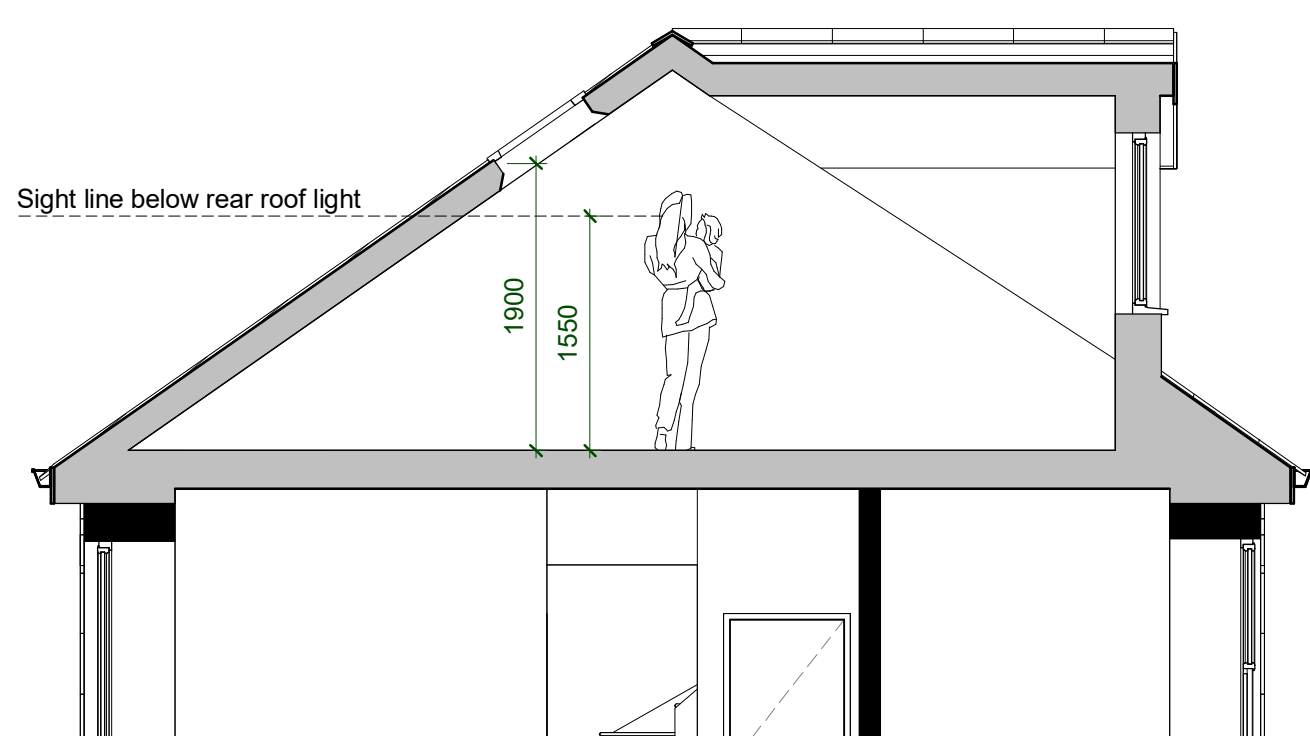

**Attic Section**  
 1 : 50



**Typical Section**  
 1 : 50

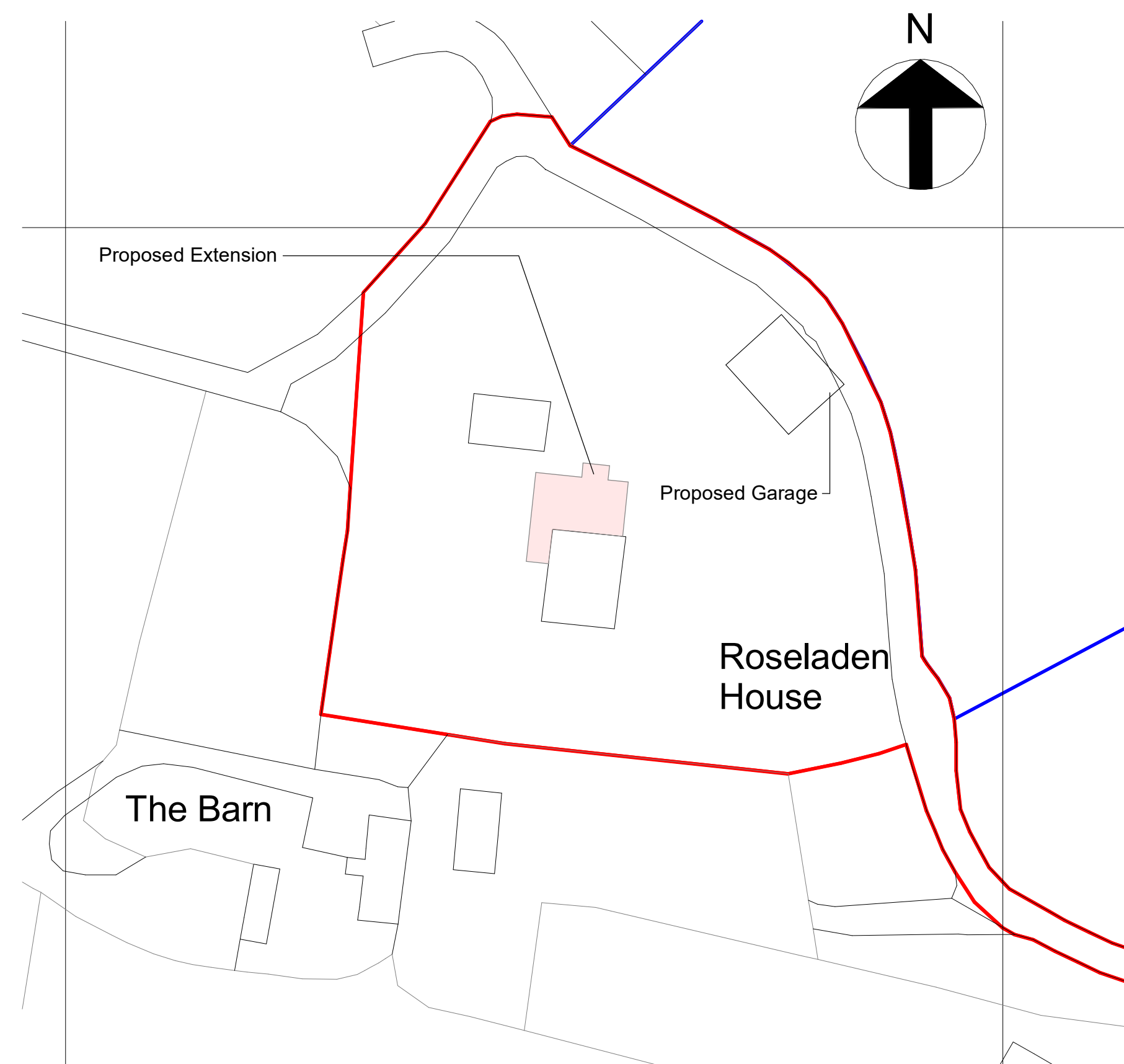

**Proposed Site Plan**  
 1 : 500

Total GIA: 309.0m<sup>2</sup>  
 Total Site Area: 3600m<sup>2</sup>

Revisions

No.	Date	Description

REV: \_\_\_\_\_ DATE: \_\_\_\_\_

CLIENT: **Mr & Mrs G. Parker**  
 PROJECT: **Two Storey Extension & Associated Works**  
 ADDRESS: **Roseladen House, Roscarra Road, Mearn Valley, Goldenbank, Falmouth, TR11 5BL**  
 DRAWING NAME: **Proposed Elevations**  
 REF: 22-0020 As Indicated SCALE: A1 PAPER SIZE: A1 DRAWN: CHKD: - -  
 DATE: 05/02/2023 STATUS: **PLANNING**  
 PROJECT: 22-0020 - - - - - 0 102A