

— NO VENTS NO BREATHER MEMBRANE
— NONE VENT WEATHERBOARD DETAIL WITH BREATHER MEMBRANE

NOTE: STUDS UNDER REAR EAVES BEAM ARE REQUIRED TO SUPPORT THE EAVES BEAM SO SHOULD BE INSTALLED PRIOR TO ANY ROOF COVERING

REFERENCE:
STUDWORK AND HORIZONTAL WEATHERBOARDING DETAIL SHOWING SPECIAL WIND BRACE

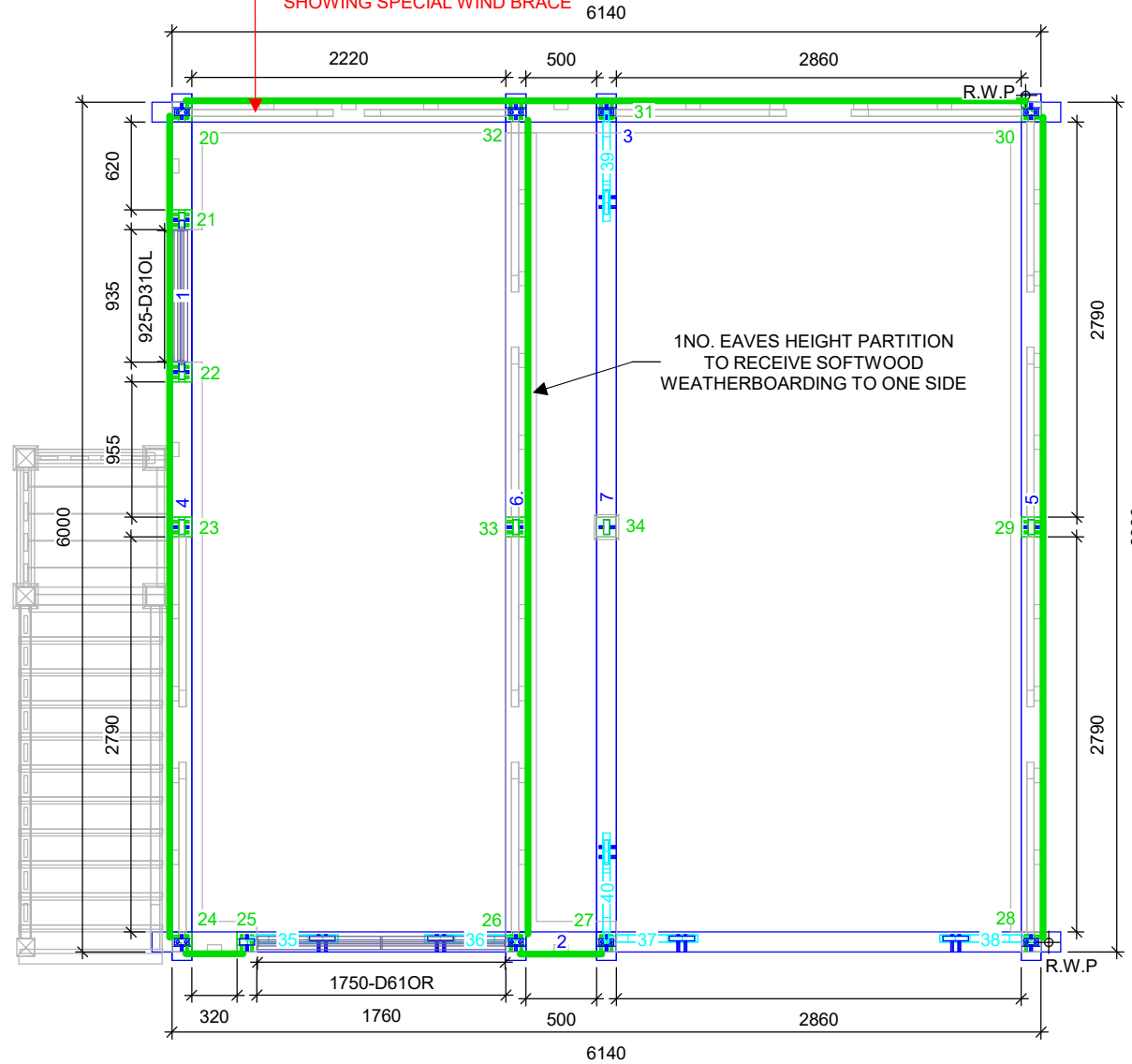

NOTE: CLIENT'S BUILDER TO SUPPLY & INSTALL 2NO. LAYERS OF PLASTERBOARDING WITH STAGGERED JOINTS TO THE RIGHT ELEVATION AT FIRST FLOOR AND APPLY INTUMESCENT PAINT TO THE EXTERNAL FACE OF WEATHERBOARDING POST PRIME OAK COMPLETION TO SATISFY PART B4 REQUIREMENTS (PROJECT LOCATED 3.0m FROM RIGHT BOUNDARY)

CLIENT'S BUILDER TO SUPPLY AND INSTALL VENTILATION TO WEATHERBOARDING TO PROVIDE MINIMUM 12000mm² OF BACKGROUND VENTILATION POST PRIME OAK COMPLETION

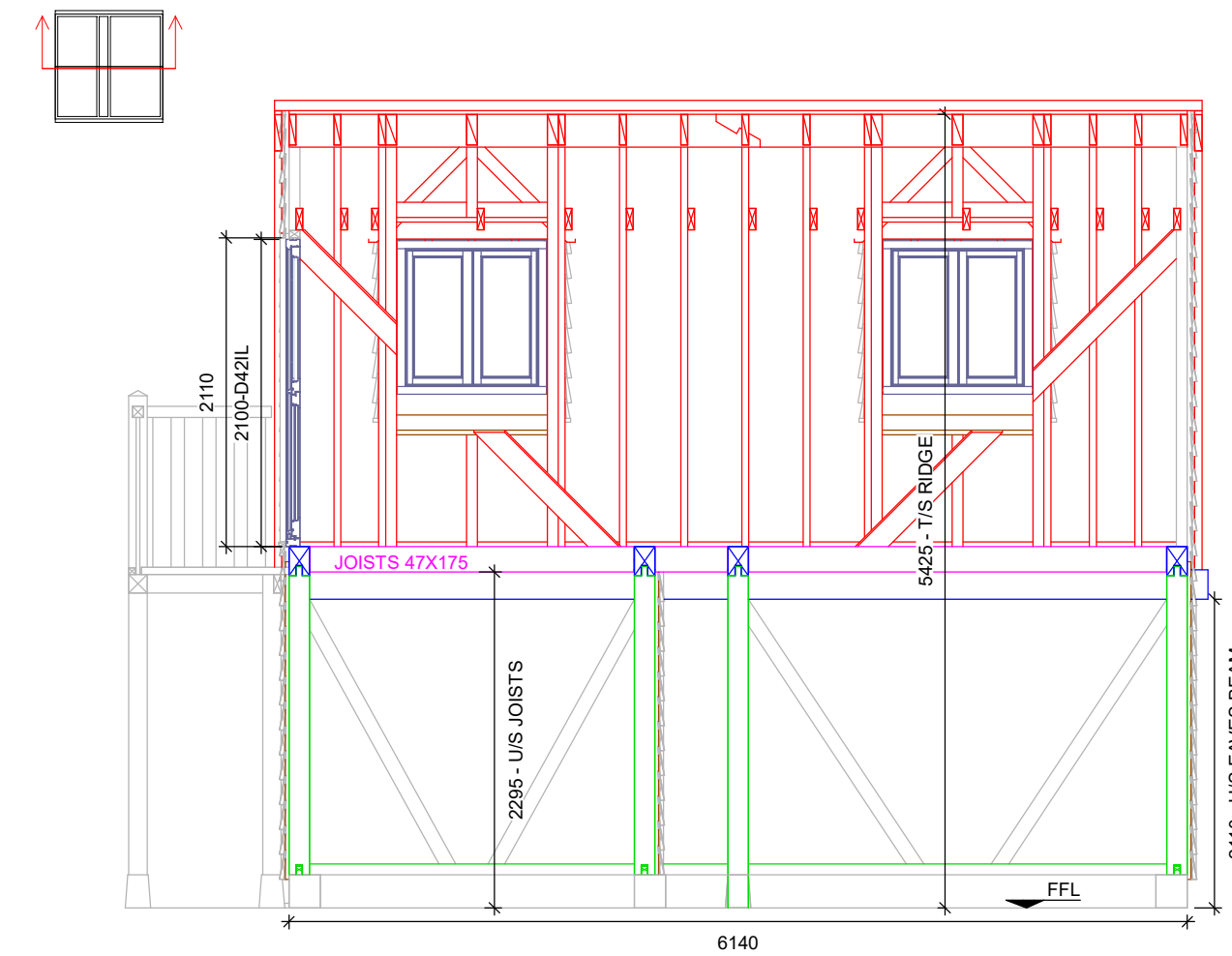
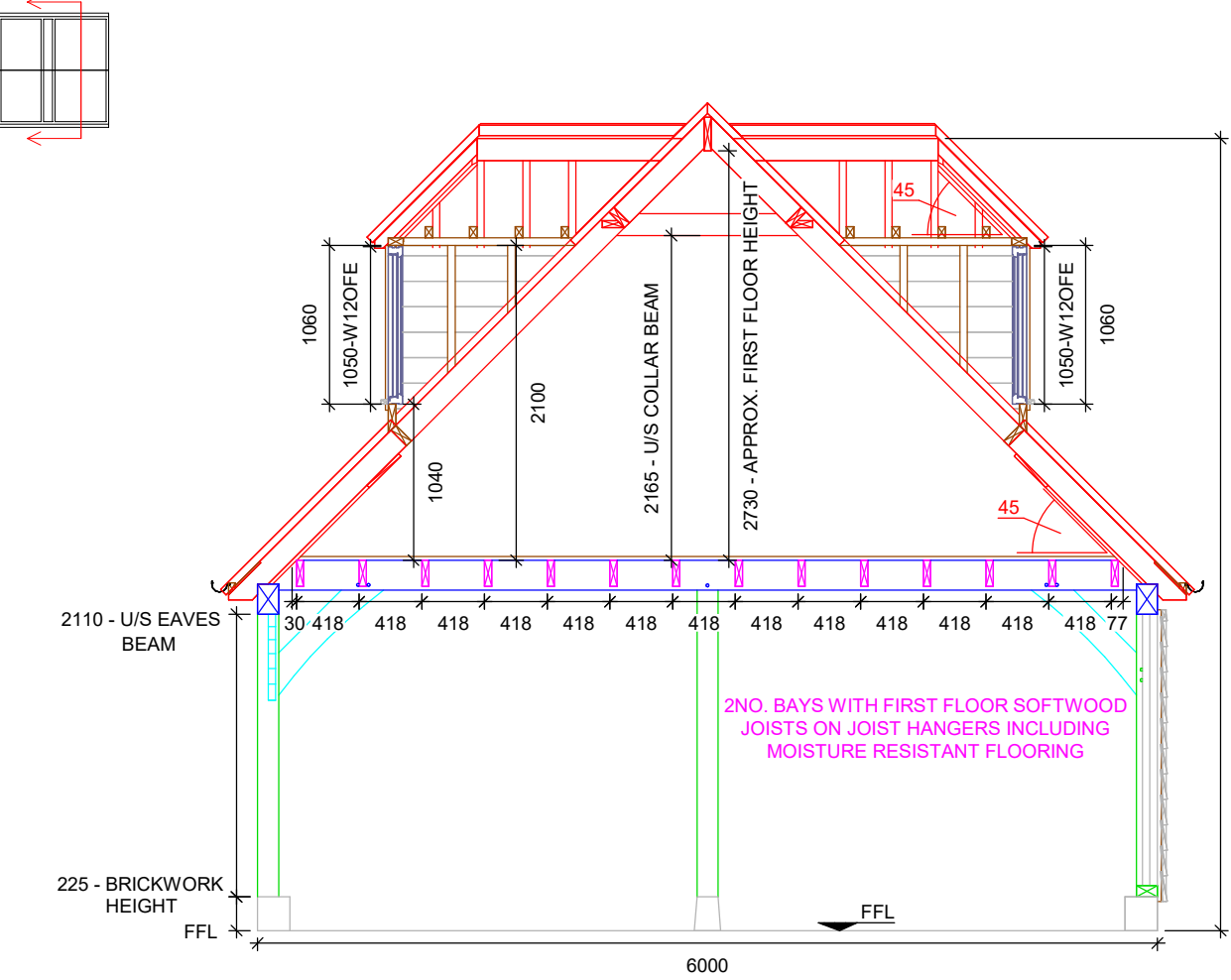
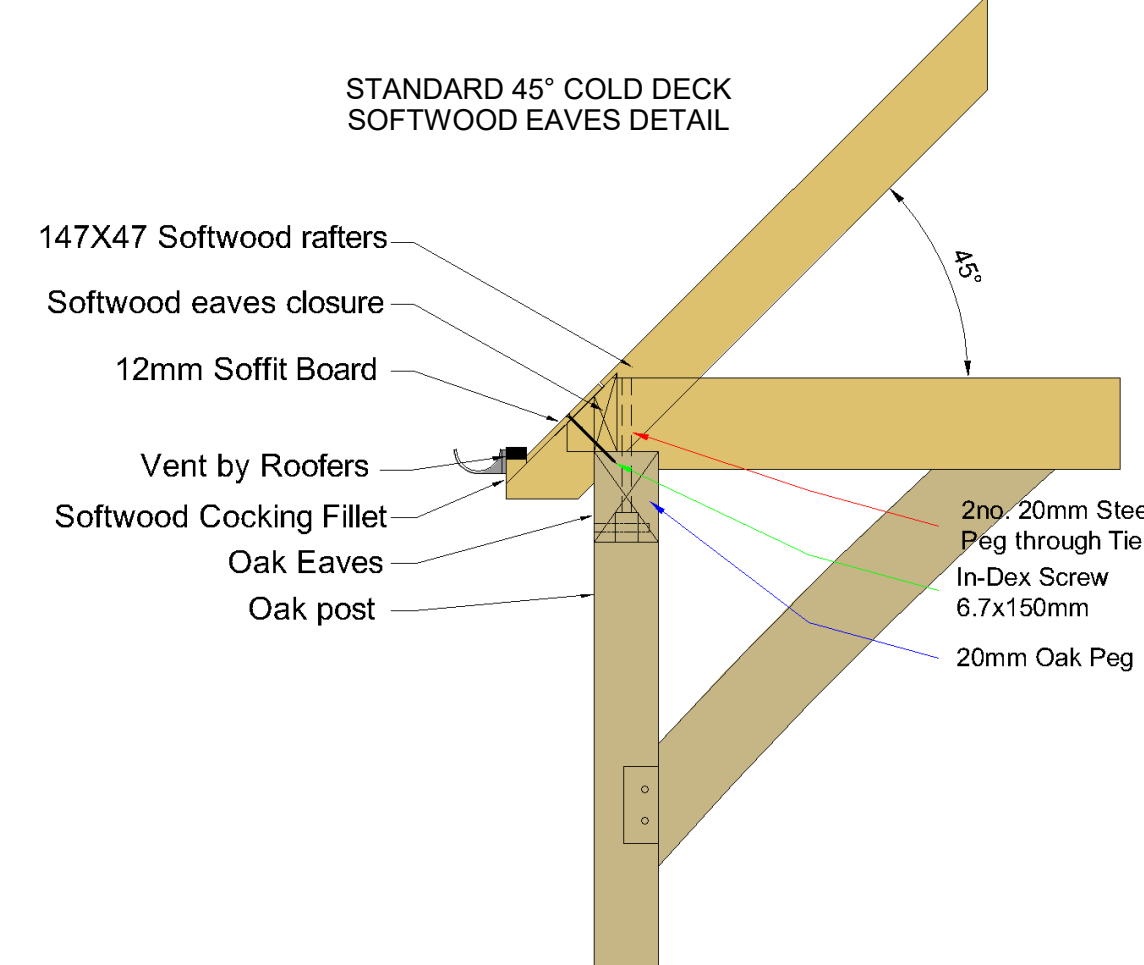
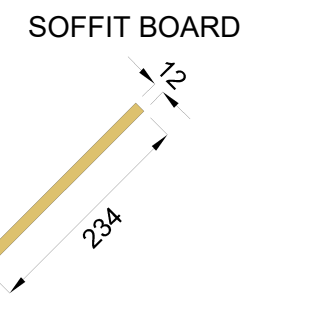
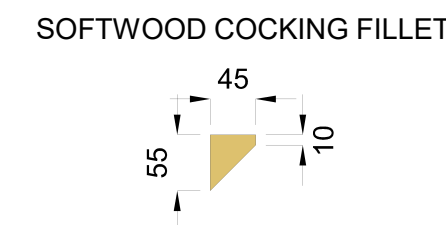
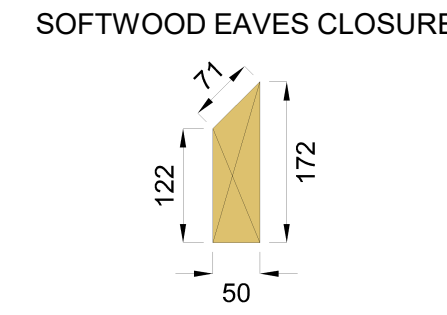
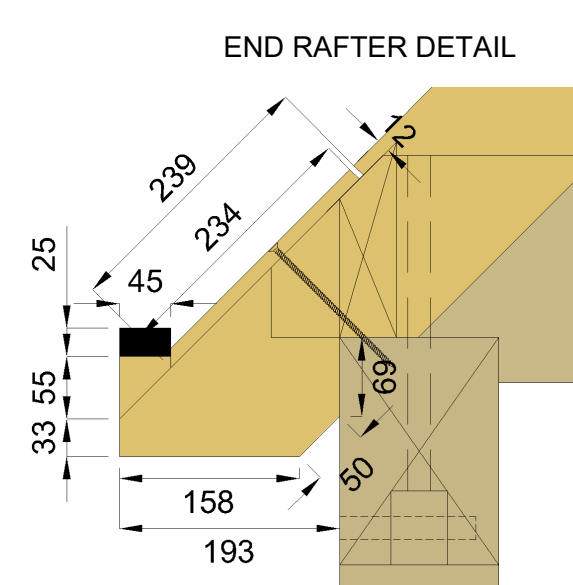
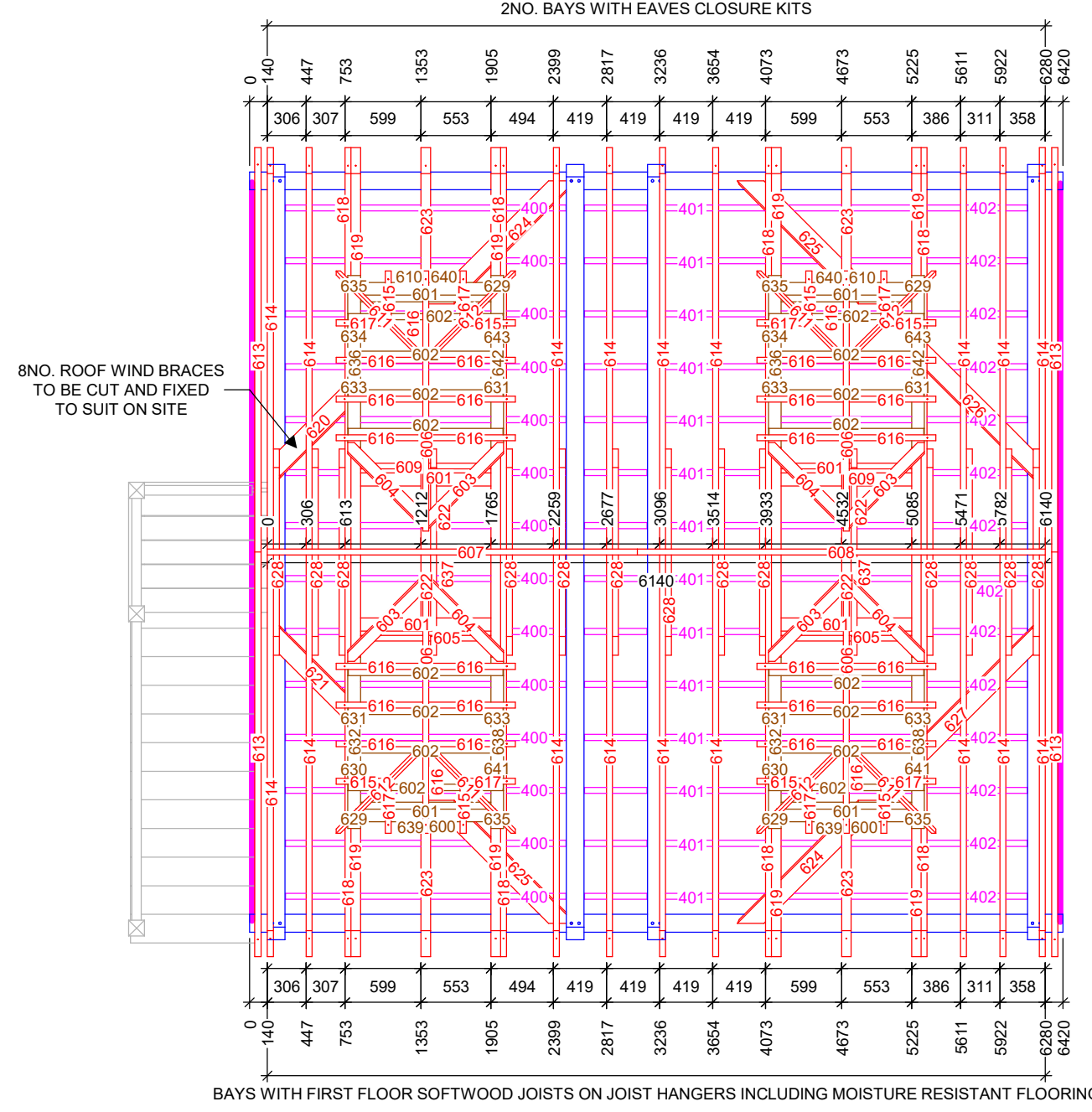

STUDWORK AND HORIZONTAL WEATHERBOARDING DETAIL SHOWING SPECIAL WIND BRACE

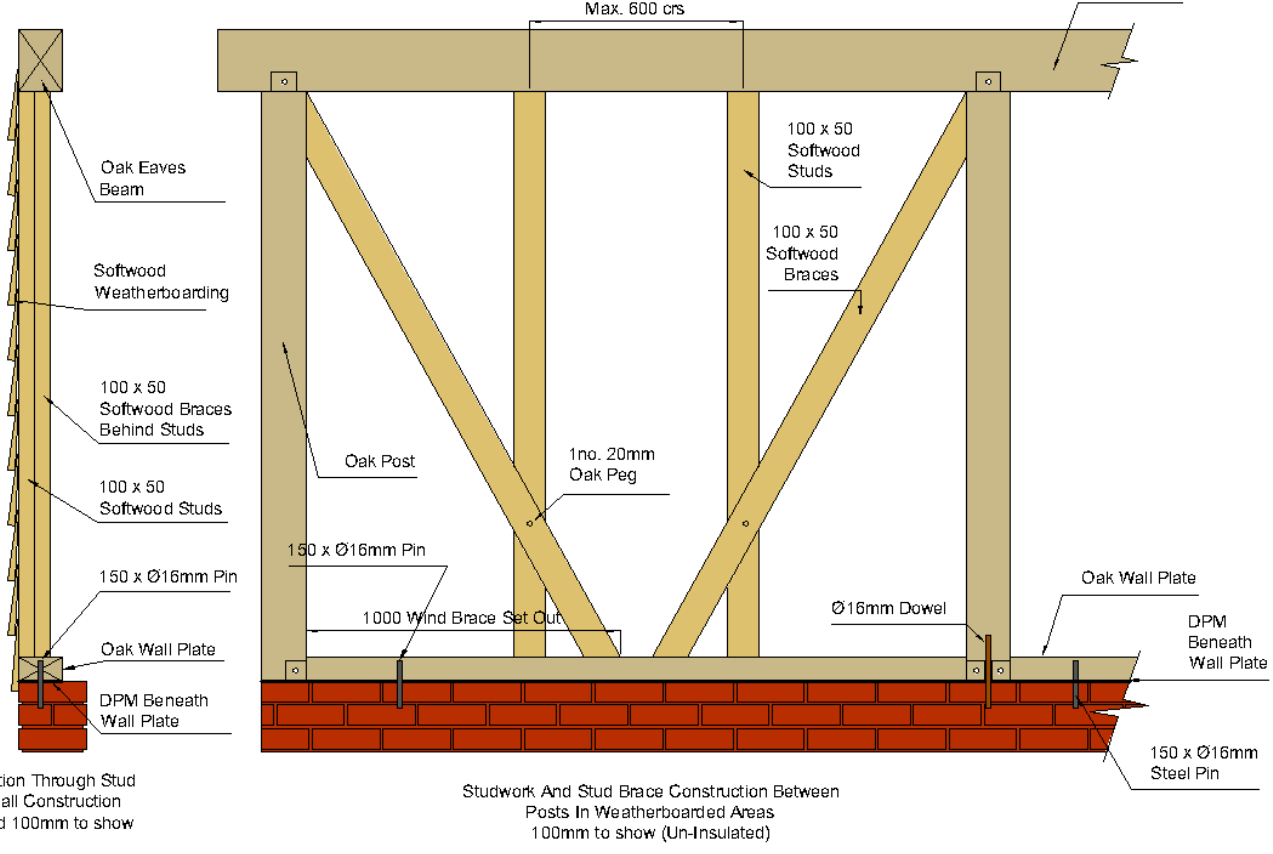

STUDWORK AND HORIZONTAL UN-INSULATED WEATHERBOARDING DETAIL

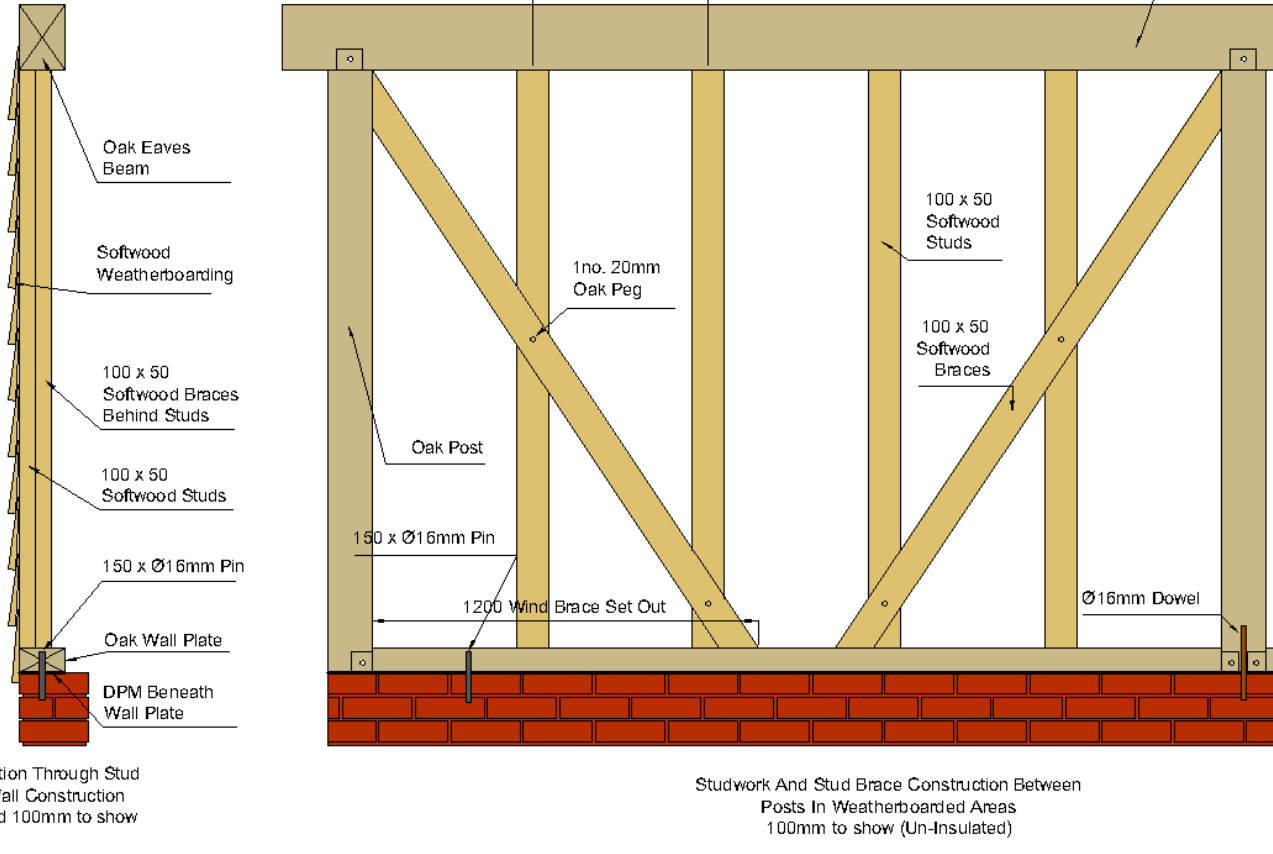

ID	QTY	DESCRIPTION
D610R	1	OAK, BOARDED DOUBLE DOOR, 1750X2100, O/O, RH MASTER
D42L	1	OAK, HALF GLAZED STABLE DOOR, 925X2100, O/O, LH
D310L	1	OAK, FULLY BOARDED DOOR, 925X2100, O/O, LH
W120FE	4	OAK, TRADITIONAL 2 PANE WINDOW, 1020X1050, L&RH, FIRE ESCAPE
	1	OAK EXTERNAL STAIRCASE WITH HANDRAIL & BALUSTRADE

FRAME:	ROUGH SAWN FINISH
STUDWORK:	SOFTWOOD
WEATHERBOARD:	ALL HORIZONTAL FEATHEREDGE WEATHERBOARDING ROUGH SAWN IN SOFTWOOD
RAFTERS:	SOFTWOOD
INSULATION:	ALL PLASTERBOARDING AND INSULATION BY CLIENT'S BUILDER
TILING:	NEW SPANISH SLATES
GLAZING:	28mm TOUGHENED ARGON FILLED CAVITY GLAZING U-VALUE 1.2 W/m ² K (9 NO. UNITS)
JOINERY FURNITURE:	SATIN NICKEL FINISH
RAINFALL GOODS:	1/2 ROUND BLACK UPVC RAINWATER GUTTERING & DOWNPIPES

SITE ADDRESS:
Grayshot Court,
Headley Road,
Grayshot,
Hindhead,
Hampshire,
GU26 6DS

IF IN DOUBT ASK

NOTES:
DO NOT SCALE

DUE TO OAK'S NATURAL IRON CONTENT, AN INITIAL STAINING WILL OCCUR TO STABLESTONES, BRICKWORK AND OVERSITE. THIS WILL DISAPPEAR NATURALLY IN TIME.

© THIS DRAWING IS THE COPYRIGHT OF PRIME OAK & MUST NOT BE REPRODUCED IN PART OR WHOLE WITHOUT CONSENT.

ANY DISCREPANCIES IN THIS DRAWING TO BE REPORTED TO PRIME OAK IMMEDIATELY.

WIDTH: 6140mm
DEPTH: 6000mm
EAVES HEIGHT: 2100mm
ROOF PITCH: 45°
CATSLIDE: N/A
OUTSHOT: N/A

CLIENT: MRS FIONA JACKSON
JOB NO.: 87731
SCALE: 1:50 @ A1
DATE: 28/06/2023
DRAWN: RW
DESIGNER: Damien O'Dowda
DRAWING NO.: 87731.002
REVISION: V1



Prime Oak
The Millworks Heath Mill Road,
Wombourne,
Wolverhampton,
England,
WV5 5AP

Tel: 01384 296677
Fax: 01384 273118
www.primeoak.co.uk