

All dimensions to be checked on site prior to commencement of building work.

Electrical Key:

- ⊗ W recessed downlight IP65 rated
- SS shaver socket

General Key:

- RWP rain water pipe
- SVP soil vent pipe
- RAD radiator
- c/h 0000 ceiling height

Notes:

RWP = Rainwater downpipe

Roof structure to Structural Engineer design details and specification

Surface water drainage:

Additional roof surface area = 13.00 sqm

Soakaway size required = 0.25m cubic  
Soakaway specification 1 x Rainsmart Ellipse double soakaway crates (or similar) with capacity of 0.25m cubic

Position and suitability of existing soakaway to be determined on site and agreed with Building Control Officer.

If required new soakaway to be positioned a minimum 5m from any wall of the house.

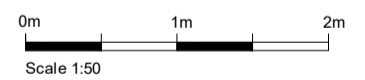
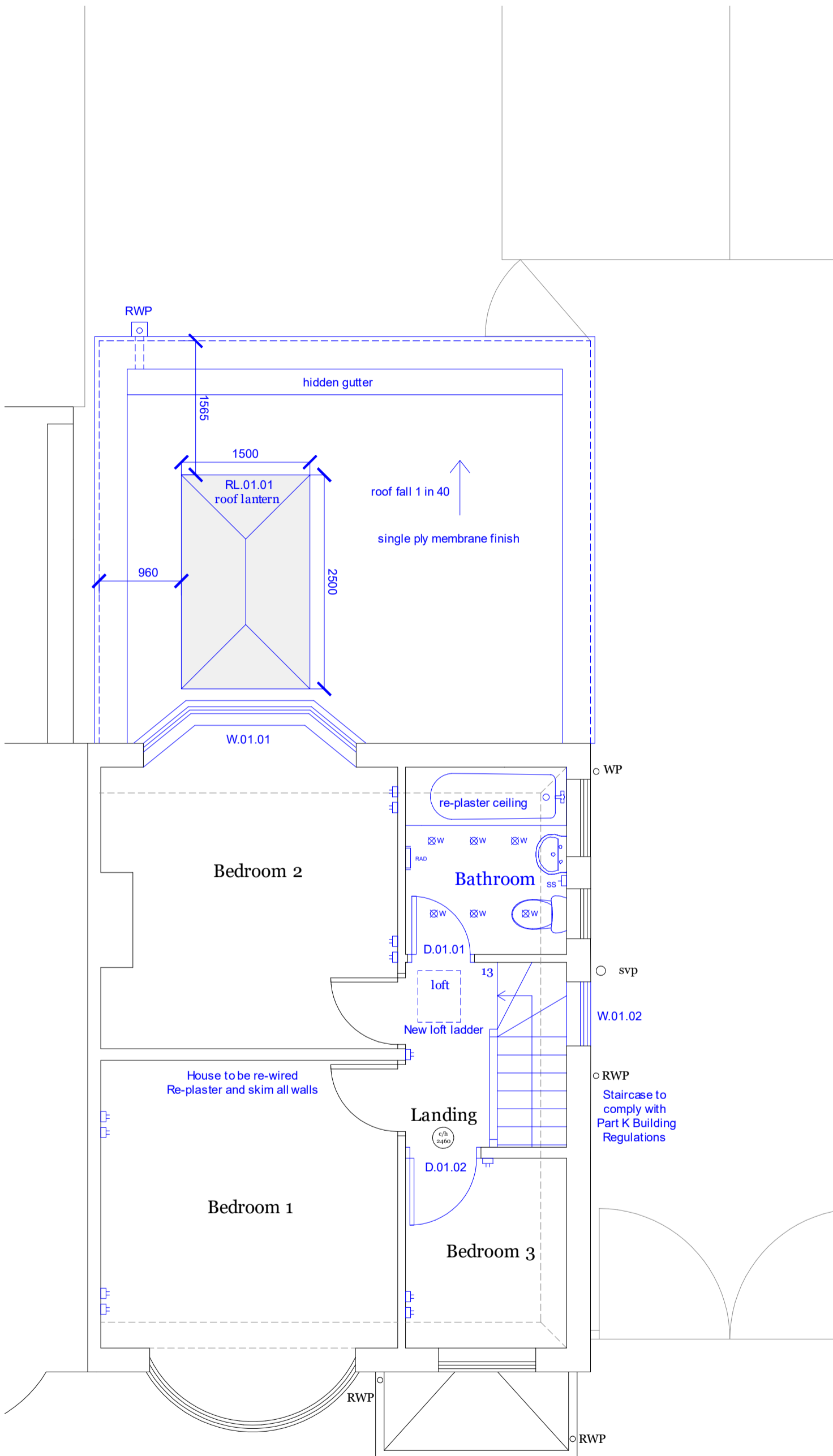

Rev	description	date	by

Project  
**74 Grand Avenue**  
Surbiton, KT5 9HX

Scale 1:50@A3 Date 28/04/23 Drawn MH

Drawing Title  
**Proposed First Floor Plan**

Status  
Building Regulations

Drawing No. 23020 - 10.09 Rev -



MJH Architects, 4 Rockswood, Alton, Hants, GU342LD  
T 01420 544501 www.mjharchitects.co.uk

Notes:  
This drawing is © copyright of MJH Architects.  
This drawing is to be read in conjunction with all consultant's drawings, details and specification.  
All dimensions to be checked on site prior to commencement of building work.  
Scale for planning purposes only.  
Any discrepancies to be reported to the architect prior to implementation.