

CL Voelcker trust that this report meets your requirements, but please contact us should you require clarification on any of the matters raised. Thank you for your custom and we hope that we can be of further assistance to you in the future.

Yours faithfully,

For **CL Voelcker** part of  
Environmental Scientifics Group



**SIMON MASON**  
Soil and Environmental Scientist  
simon.mason@esg.co.uk

### References

BSI 3882 : 2007 : Specification for Topsoil and Requirements for Use. British Standards Institution, London.

Hodgson, M. : 1976, Soil Survey Field Handbook. Soil Survey of England and Wales. Technical Monograph No. 5, Harpenden.

MAFF : 1998, The Soil Code Revised 1998, Code of Good Practice for the Protection of Soil, Ministry of Agriculture Fisheries and Food, Welsh Office Agriculture Department, October 1998

Munsell Color Company Inc. : 1973, Baltimore, Maryland 21218, USA.

# Mechanical Analysis Soil Textural Classes

## UK CLASSIFICATION

Clay *Less than 0.002mm*  
 Silt *0.002 - 0.06mm*  
 Sand *0.06 - 2.00mm*

Client: **Charles Morris  
 Fertilisers**  
 Site: **GP**  
 Date: **27 June 2011**

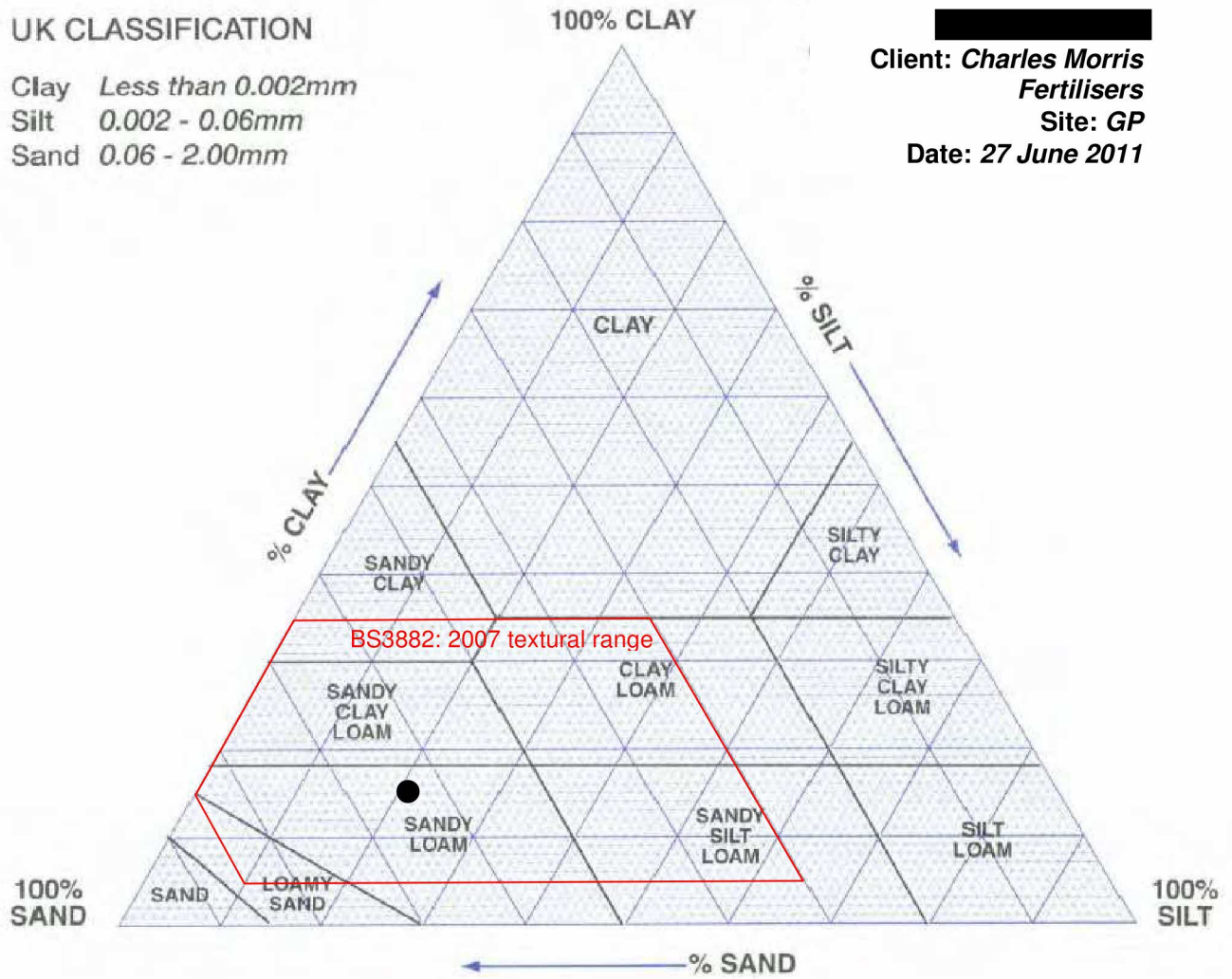

Sample Reference	GP						
Textural Class (UK)	SL	●					

## Certificate of Analysis

Client	Charles Morris Fertilisers	
Date Received	15/06/2011	Date : 27/06/2011
Suite ID	BS3882 : 2007 - Multipurpose Grade	Sampled by : Client
Site Details	Hythe End Farm	

**Soil Sample Reference :** GP

**Particle Size Distribution\* (UK Classification)**

Clay (<0.002mm)	%	16	✓
Silt (0.002-0.06mm)	%	20	✓
Sand (0.06-2.0mm)	%	64	✓
Textural Class		SL	✓

**Stone Content (Dry Weight Basis)**

Stones 2-20mm	%w/w	9.3	✓
Stones 20-50mm	%w/w	14.2	*
Stones >50mm	%w/w	0	✓

**Soil Reaction & Soluble Salts**

pH Value ‡	units	7.6	✓
Electrical Conductivity (CaSO <sub>4</sub> )†	µS/cm	2198	✓
≠ ESP±	%	0.8	✓

**Organic Matter & Nutrient Status**

Organic Matter (WB <sup>^</sup> )	%	3.6	✓
Total Nitrogen	%	0.11	*
Carbon : Nitrogen Ratio		19:1	✓
Extractable Phosphorous	mg/l	33	✓
Extractable Potassium	mg/l	140	✓
Extractable Magnesium	mg/l	96	✓

**Phytotoxic Metals<sup>1</sup>**

Zinc (Zn)	mg/kg	135.1	✓
Copper (Cu)	mg/kg	34.9	✓
Nickel (Ni)	mg/kg	26.1	✓

**Visible Contaminants (Dry Weight Basis)**

Total foreign matter > 2 mm	%w/w	<0.5	✓
... of which plastics	%w/w	<0.25	✓
... of which sharps	%w/w	0	✓

**Notes:**

- Conforms to BS3882:2007 Multipurpose Grade  
 Fails to conform to BS3882:2007 Multipurpose Grade

**UK Soil Texture Classification**

C	Clay	ZC	Silty Clay
SC	Sandy Clay	ZCL	Silty Clay Loam
CL	Clay Loam	SZL	Sandy Silt Loam
SL	Sandy Loam	ZL	Silt Loam
SCL	Sandy Clay Loam	S	Sand
LS	Loamy Sand		

- \* ADAS pipette  
‡ 1:2.5 water extract  
† CaSO<sub>4</sub> extract  
≠ dependent option  
± Exchangeable Sodium Percentage  
<sup>1</sup> Total metals  
<sup>^</sup> Walkley Black method  
ne not evaluated

Sample(s) were analysed by the UKAS accredited laboratory of NRM

# J & G FENCING LTD

---

WWW.JGFENCING.COM - [REDACTED]

**To: WHOM IT MAY CONCERN**

**From: Tony Price**

**Date: 24/07/11**

**Re: MAINTENANCE / REPAIR FENCING BURY GREEN SITE**

**PLEASE FIND INSTALLATION DETAILS SUPPLIER INFO FOR FENCING BEING INSTALLED AT ABOVE PROJECT**

**MANUFACTURED AND INSTALLED TO BS 1722 PART 14 CAT 3 358 ANTI CLIMB MESH**

**YOUR ORDER REF CONTRACT NO PROJECT 27366**

**SHOULD TOUCH UP PAINT BE NEEDED IF FENCE IS SCRATCHED COLOUR IS RAL 8025**

**SHOULD FENCE BE DAMAGED PANELS CAN BE REPAIRED / REPLACED CONTACT THE INSTALLER J & G FENCING LTD**

**NO OTHER MAINTENANCE REQUIRED**

**MAINTENANCE FOR EXISTING GATES THE HINGES NEED TO BE GREASED PERIODICALLY OR AS REQUIRED MIN EVERY 6 MONTHS**

**SUPPLIER TOP SECURITY FENCING 01746 763299  
CONTACT BOB WHITBY**

**INSTALLER J& G FENCING LTD  
CONTACT TONY PRICE 07912 270629**

**SOUTHWEST DIVISION UNIT 25 BROOKGATE SOUTH LIBERTY LANE BEDMINSTER BRISTOL BS3  
2UQ TELEPHONE 01179 231001 FAX 01179 532400**

**JON GWYTHYR 07812 170684 JAMES LANGRIDGE 07786 1120755**

**SOUTHWALES DIVISION  
20a CROSS HANDS RD GORSLAS LLANELLI SA14 6RP TONY PRICE 07912270629**

**COMPANY NO 04502579 VAT REG 794 2455 00**

SECTION 5  
CERTIFICATION OF REINFORCEMENT

See attached

# UK Certification Authority for Reinforcing Steels

## *Certificate of Approval*

### Product Conformity Certification

This is to certify that

**Thames Reinforcements Ltd.**

at its establishment at

**Sheerness**

has satisfied the Authority that it operates a Quality System that complies with the requirements of BS EN ISO 9001 2008 and the relevant CARES Quality and Operations Assessment Schedules. Where appropriate, and as listed below, it has further satisfied the Authority that it manufactures and/or supplies products that conform with the stated product standards and is entitled to use the CARES marks on its products.

**Processing of steel reinforcement to BS 8666 and BS 4466**

**Stocking and distribution of BS 4449, BS 4482 and BS 4483**

**Application of Erico Lenton Taper Thread standard (A12) and positional (P13 and 14) mechanical couplers for use in accordance with CARES Appendix TA1-B as follows:**

**BS 4449 460B and B500B and B500C reinforcing steel in the size range 12 to 40mm.**

**Manufacture of pre-assembled MIG welded fabrications, using reinforcing bar in the size range 12 to 50mm, to the relevant requirements of BS 7123 and CARES Quality and Operations Assessment Schedules 6 and 10 using tack welds and semi-structural joints produced under factory conditions**

using the processes and procedures registered with the Authority.

This Certificate is the property of the Authority and is issued subject to the Regulations of the Authority.

The Certificate Number is: **070703**

Issue Date: **01-January-2011**

Expiry Date: **31-December-2011**

Signed on behalf of the Board of Management

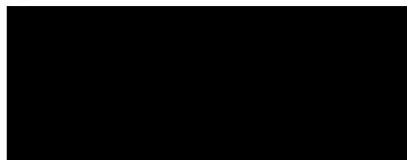

Executive Director

The use of the Accreditation Mark indicates accreditation in respect of those activities covered by the accreditation certificate number 002.

UK Certification Authority for Reinforcing Steels  
Pembroke House, 21 Pembroke Road, Sevenoaks, Kent, TN13 1XR, UK. [www.ukcares.com](http://www.ukcares.com)



# UK Certification Authority for Reinforcing Steels

## *Certificate of Approval*

### Environmental Management System Certification

**This is to certify that**

**Thames Reinforcements Ltd.**

at its establishment at

**Sheerness**

has satisfied the Authority that it operates an Environmental Management System  
that complies with the requirements of

**BS EN ISO 14001 2004**

**Processing of steel reinforcement products**

using the processes and procedures registered with the Authority.

This Certificate is the property of the Authority and is issued subject to the Regulations of the Authority.

The Certificate Number is: **1199**

Issue Date: **01-January-2011**

Expiry Date: **31-December-2011**

Signed on behalf of the Board of Management

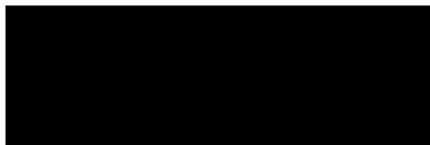

Executive Director

The use of the Accreditation Mark indicates accreditation in respect  
of those activities covered by the accreditation certificate number 002.

UK Certification Authority for Reinforcing Steels  
Pembroke House, 21 Pembroke Road, Sevenoaks, Kent, TN13 1XR, UK. [www.ukcares.com](http://www.ukcares.com)



# UK Certification Authority for Reinforcing Steels

## *Certificate of Approval*

### Occupational Health and Safety Management System Certification

**This is to certify that  
Thames Reinforcements Ltd.**

at its establishment at

**Sheerness**

has satisfied the Authority that it operates an Occupational Health and Safety Management System that complies with the requirements of

**OHSAS 18001 2007**

**Processing of steel reinforcement products**

using the processes and procedures registered with the Authority.

This Certificate is the property of the Authority and is issued subject to the Regulations of the Authority.

The Certificate Number is: **1241**

Issue Date: **01-January-2011**

Expiry Date: **31-December-2011**

Signed on behalf of the Board of Management

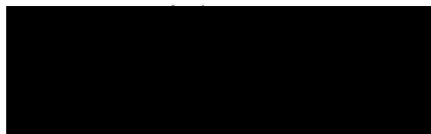

Executive Director

The use of the Accreditation Mark indicates accreditation in respect of those activities covered by the accreditation certificate number 002.

UK Certification Authority for Reinforcing Steels  
Pembroke House, 21 Pembroke Road, Sevenoaks, Kent, TN13 1XR, UK. [www.ukcares.com](http://www.ukcares.com)





SECTION 6  
CONCRETE MIX DESIGNS

See attached



J Coffey Construction Ltd  
 93/95 Greenford Road  
 Harrow  
 HA1 3QF

Date: 04-Jul-11

## Certificate of Mix Design

Site / Project: Bury Green Lane, Millfield Lane, Little Hadham

Plant : Hertford

### Mix Specifications

Mix	Description	Agg Size	Cement Type	Target Slump
1	C16/20 + WRA (N)	20	CEM II/B-V+SR	S1
2	GEN 3 + WRA (N)	20	CEM II/B-V+SR	S2
3	RC32/40	20	CEM II/B-V+SR	S2
4	C32/40 PUMP + WRA (N)	20	CEM II/B-V+SR	S2
5	READYMIX VOIDFILL	20	CEM I	550MM

### Mix Design

Materials		Dry Batch Weights Kg/m <sup>3</sup>				
Type	Source	1	2	3	4	5
CEM I	Cemex - Tilbury	~	~	~	~	220
CEM II/B-V+SR	Cemex - Tilbury	156	220	321	296	~
0/4	Cemex - West Mill	896	814	712	851	1500
4/20	Cemex - West Mill	1103	1090	1107	995	~
Admix 1 (ml)	Cemex WRA - CP105	936	1320	~	1779	~
Admix 2 (ml)	Cemex AEA - CA201	~	~	~	~	3000
WATER	Free Water/Cement Ratio	0.88	0.68	0.51	0.49	N/A

Mix design details given are subject to variation as material properties vary.

### Additional Information

Signed:

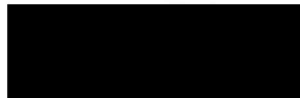

Steve Amos  
 Readymix Technical Manager

#### CEMEX UK Materials Limited

CEMEX House, Evreux Way, Rugby, Warwickshire, CV21 2DT, United Kingdom.

Phone: +44 (0) 1788 517000 Fax: +44 (0) 1788 517009

www.cemex.co.uk

Registered in England and Wales: Company Number 4895833 Registered Office: CEMEX House, Coldharbour Lane, Thorpe, Egham, Surrey TW20 8TD, United Kingdom.

## SECTION 7

### TEST CERTIFICATES / CERTIFICATES COMPLIANCE

See attached

- Concrete Test Cube Results
- Pre-Pour Certificates

# CONCRETE TEST CUBE REPORT

**BS 1881-116:1983** (withdrawn)

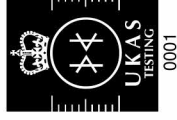

Unit 11  
Cowley Mill Trading Estate  
Longbridge Way  
Uxbridge  
Middlesex  
UB8 2YG  
United Kingdom  
Tel: +44(0) 1895 235235

Report no: UXB22018892\_01

Date: 26/08/2011

Client: J COFFEY CONSTRUCTION LTD

Scheme: Bury Green Farm, Little Hadham, Ware SG11 2ED

Contract no: 50157754

Request Sheet No.	Lab Ref.	Client Ref.	Date Made	Time Made	Date Received in Laboratory	Date Tested	Age days	Weight kg	Dimensions mm	Density kg/m <sup>3</sup>	Failure Load kN	Compressive Strength N/mm <sup>2</sup>	Specified Strength at 28 days N/mm <sup>2</sup>
S004627	22018892	JC002D	28/06/2011	0900	30/06/2011	23/08/2011	56	7.905	150x150x150	2340	1044.0	46.5	40.0

Location: SWITCH ROOM BASE SLAB  
 Mix details: RC32/40 150mm Slump  
 Remarks: Lab. Tank Temps reached 24.2degC during 5-8th August.

The following apply unless otherwise stated under Remarks.

- 1) Laboratory curing range 18°-22°C.
- 2) Cube appearance as received satisfactory.
- 3) Test moisture condition and density saturated.
- 4) Cube failure normal. Concrete appearance normal.
- 5) Volume determined by measurement or designated size. Any fins removed by abrasive stone.
- 6) Laboratory curing conditions cannot be assured during tank cleaning.
- 7) Certificate of sampling not received. Certificate of making and curing not received.

Certified that curing in the laboratory and testing carried out in accordance with BS 1881-111, 114, 116, 116 : 1983.



Signed

Ben Thomas - Concrete Laboratory Manager

Issued to: Head Office

for and on behalf of Environmental Scientifics Group Limited

## CUBE RESULTS SUMMARY

Unit 11  
Cowley Mill Trading Estate  
Longbridge Way  
Uxbridge  
Middlesex  
UB8 2YG  
United Kingdom  
[REDACTED]

Client: J COFFEY CONSTRUCTION LTD

Scheme: Bury Green Farm, Little Hadham, Ware SG11 2ED

Contract no:

50157754

Request Sheet No.	Lab Ref.	Client Ref.	Date Made	Time Made	Date Received	Date Tested	Age days	Weight kg	Sample Location	Density kg/m <sup>3</sup>	Load kN	Cube Strength N/mm <sup>2</sup>	Spec Strgth at 28 days N/mm <sup>2</sup>
S004626	21994982	JC001A	04/06/2011	0930	06/06/2011	11/06/2011	7	7.921	TRANSFER BASE SLABS	2350	568	25.0	40.0
S004626	21994983	JC001B	04/06/2011	0930	06/06/2011	02/07/2011	28	7.896	TRANSFER BASE SLABS	2340	801	35.5	40.0
S004626	21994984	JC001C	04/06/2011	0930	06/06/2011	02/07/2011	28	7.821	TRANSFER BASE SLABS	2320	810	36.0	40.0
S004627	22018889	JC002A	28/06/2011	0900	30/06/2011	05/07/2011	7	7.904	SWITCH ROOM BASE SLAB	2340	541	24.0	40.0



## CUBE RESULTS SUMMARY

Unit 11  
 Cowley Mill Trading Estate  
 Longbridge Way  
 Uxbridge  
 Middlesex  
 UB8 2YG  
 United Kingdom

Client: J COFFEY CONSTRUCTION LTD

Scheme: Bury Green Farm, Little Hadham, Ware SG11 2ED

Contract no: 50157754

Request Sheet No.	Lab Ref.	Client Ref.	Date Made	Time Made	Date Received	Date Tested	Age days	Weight kg	Sample Location	Density kg/m <sup>3</sup>	Load kN	Cube Strength N/mm <sup>2</sup>	Spec Strgth at 28 days N/mm <sup>2</sup>
S004626	21994982	JC001A	04/06/2011	0930	06/06/2011	11/06/2011	7	7.921	TRANSFER BASE SLABS	2350	568	25.0	40.0

NB: Results remain unchecked until the final report is completed.

## SECTION 8

### AS BUILT DRAWINGS & SCHEDULES

Drawings worked to: -

**ARC: MC**

Drawing Nr: A1.000 Rev #  
Drawing Nr: A1.001 Rev #  
Drawing Nr: A7.000 Rev #  
Drawing Nr: A7.001 Rev #  
Drawing Nr: A7.002 Rev #  
Drawing Nr: A7.003 Rev #  
Drawing Nr: A7.004 Rev #  
Drawing Nr: A7.005 Rev #  
Drawing Nr: A7.006 Rev #  
Drawing Nr: A7.007 Rev A  
Drawing Nr: A7.008 Rev #  
Drawing Nr: A7.010 Rev #  
Drawing Nr: A7.011 Rev #  
Drawing Nr: A7.012 Rev A  
Drawing Nr: A7.013 Rev A  
Drawing Nr: A7.014 Rev A  
Drawing Nr: SK. 011 Rev #  
Drawing Nr: SK. 012 Rev #

### **BENDING SCHEDULES**

Drawing Nr: BS – X – 010-011  
Drawing Nr: 12-01 A7. 012-014 (a)  
Drawing Nr: 12-01 A7. 012-014 (b)

### **AS BUILT**

Drawing Nr: JCSK1 20-06-2011  
Drawing Nr: JCSK2 20-06-2011







ARC:MC

# A7.000 #

ALL RIGHTS RESERVED. ALL DRAWINGS AND OTHER MATERIALS ARE THE PROPERTY OF ARC:MC. NO PART OF THIS DRAWING OR OTHER MATERIALS MAY BE REPRODUCED OR TRANSMITTED IN ANY FORM OR BY ANY MEANS, ELECTRONIC OR MECHANICAL, WITHOUT THE WRITTEN PERMISSION OF ARC:MC. THIS DRAWING IS THE PROPERTY OF ARC:MC AND IS TO BE USED ONLY FOR THE PROJECT AND SITE SPECIFICALLY IDENTIFIED HEREIN. IT IS NOT TO BE USED FOR ANY OTHER PROJECT OR SITE WITHOUT THE WRITTEN PERMISSION OF ARC:MC.

NO.	REV.	DATE	DESCRIPTION
1	01	15/03/2024	ISSUED FOR TENDER
2	02	15/03/2024	ISSUED FOR TENDER
3	03	15/03/2024	ISSUED FOR TENDER
4	04	15/03/2024	ISSUED FOR TENDER
5	05	15/03/2024	ISSUED FOR TENDER
6	06	15/03/2024	ISSUED FOR TENDER
7	07	15/03/2024	ISSUED FOR TENDER
8	08	15/03/2024	ISSUED FOR TENDER
9	09	15/03/2024	ISSUED FOR TENDER
10	10	15/03/2024	ISSUED FOR TENDER
11	11	15/03/2024	ISSUED FOR TENDER
12	12	15/03/2024	ISSUED FOR TENDER
13	13	15/03/2024	ISSUED FOR TENDER
14	14	15/03/2024	ISSUED FOR TENDER
15	15	15/03/2024	ISSUED FOR TENDER
16	16	15/03/2024	ISSUED FOR TENDER
17	17	15/03/2024	ISSUED FOR TENDER
18	18	15/03/2024	ISSUED FOR TENDER
19	19	15/03/2024	ISSUED FOR TENDER
20	20	15/03/2024	ISSUED FOR TENDER

- NOTES:
1. THESE DRAWINGS TO BE READ IN CONJUNCTION WITH ALL ARCHITECTURAL & ELECTRICAL SPECIFICATIONS AND ALL OTHER SPECIFICATIONS AND SUCH TO THEIR RESPECTIVE CONTRACTS. ANY DISCREPANCIES SHALL BE REPORTED BACK TO SOURCE.
  2. ALL LEVELS ARE IN METERS ABOVE ORDNANCE DATUM. ALL DIMENSIONS ARE IN MM UNLESS OTHERWISE NOTED. DO NOT SCALE DRAWINGS. ALL DIMENSIONS TO FACE UNLESS OTHERWISE SPECIFIED.
  3. ALL SETTING OUT DIMENSIONS TO BE CONFIRMED BY ON-SITE CONTRACTOR PRIOR TO COMMENCEMENT OF WORK.
  4. FOR ELECTRICAL DETAILS OF SUBSTATION REFER TO HPF/SERIES DRAWING 5.
  5. FOR UNDERGROUND SERVICES REFER TO HPF/SERIES DRAWINGS.
  6. FOR ARCHITECTURAL DETAILS REFER TO ARC/MC/SERIES DRAWINGS.

FOR TENDER



MISSION CRITICAL

140-142 St John Street  
 Dublin 1, Ireland  
 T: +353 1 454 1234  
 E: info@arc-mc.com

REGISTERED IN IRELAND - COMPANY NO. 12345678  
 V.A.T. NO. 123456789  
 PROJECT: SUBSTATION ELECTRIFICATION  
 DRAWING NO: A7.000  
 DATE: 15/03/2024  
 DRAWN BY: J. SMITH  
 CHECKED BY: M. JONES  
 APPROVED BY: K. BROWN

# A7.000 #

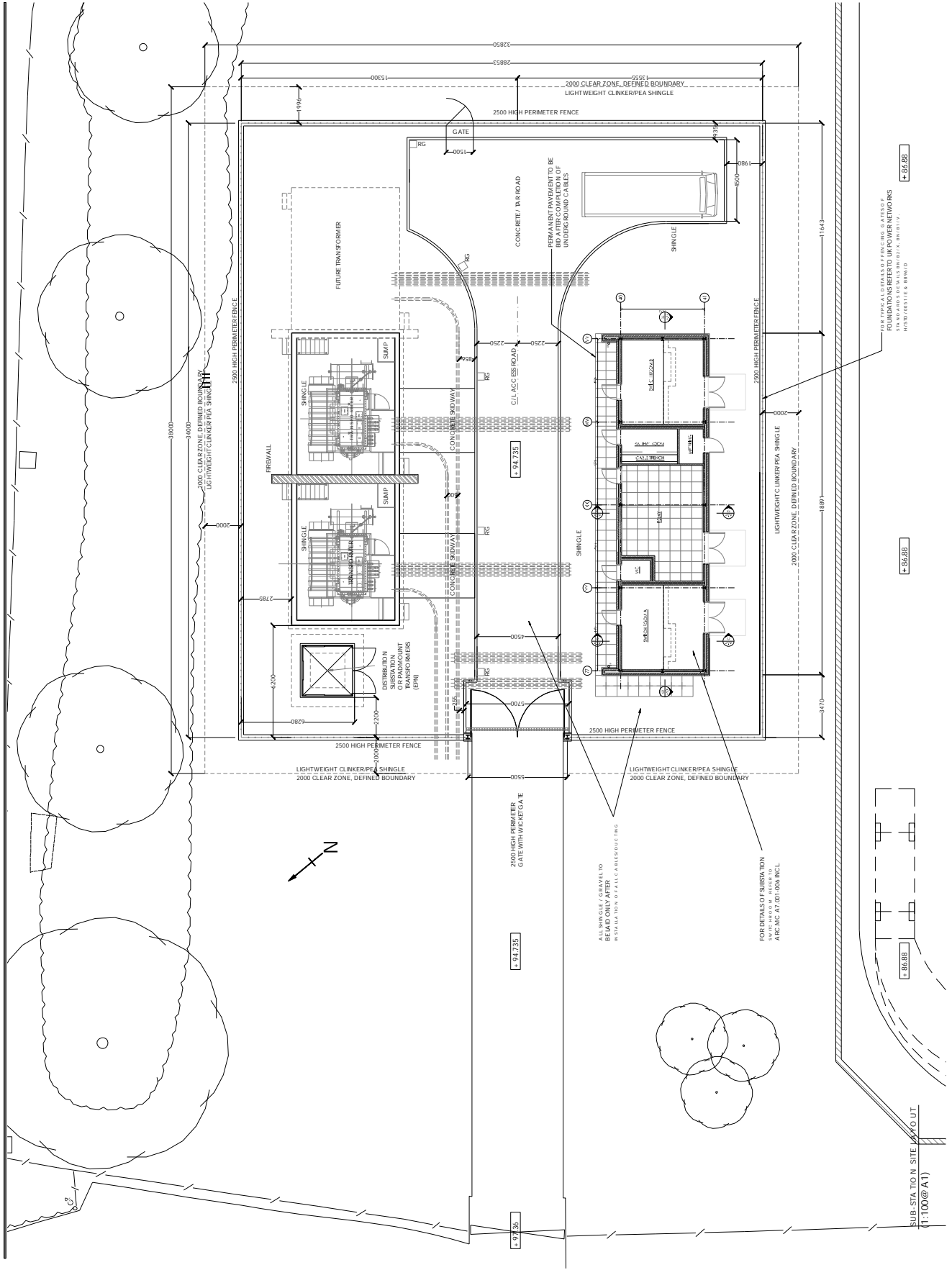

FOR TYPICAL DETAILS OF FENCING GATES & FOUNDATIONS REFER TO UK POWER NETWORKS STANDARDS AND SPECIFICATIONS.

+86.88

+84.88

+86.88

FOR DETAILS OF SUBSTATION REFER TO HPF/SERIES DRAWING 5

1:100@A1





# A7.003 #

ALL RIGHTS RESERVED. ALL DRAWINGS AND OTHER MATERIALS ARE THE PROPERTY OF ARC:MC. NO PART OF THIS DRAWING OR ANY OTHER MATERIALS MAY BE REPRODUCED OR TRANSMITTED IN ANY FORM OR BY ANY MEANS, ELECTRONIC OR MECHANICAL, INCLUDING PHOTOCOPYING, RECORDING, OR BY ANY INFORMATION STORAGE AND RETRIEVAL SYSTEM.

NO.	REVISION	DATE	BY	CHK
1	ISSUED FOR PERMIT	18/01/2023	ARC:MC	ARC:MC
2	ISSUED FOR PERMIT	18/01/2023	ARC:MC	ARC:MC
3	ISSUED FOR PERMIT	18/01/2023	ARC:MC	ARC:MC
4	ISSUED FOR PERMIT	18/01/2023	ARC:MC	ARC:MC
5	ISSUED FOR PERMIT	18/01/2023	ARC:MC	ARC:MC
6	ISSUED FOR PERMIT	18/01/2023	ARC:MC	ARC:MC
7	ISSUED FOR PERMIT	18/01/2023	ARC:MC	ARC:MC
8	ISSUED FOR PERMIT	18/01/2023	ARC:MC	ARC:MC
9	ISSUED FOR PERMIT	18/01/2023	ARC:MC	ARC:MC
10	ISSUED FOR PERMIT	18/01/2023	ARC:MC	ARC:MC

- GENERAL NOTES**
- CONCRETE SHALL BE CAST AND CURED IN ACCORDANCE WITH THE REQUIREMENTS OF THE SPECIFICATION AND THE RELEVANT STANDARDS.
  - ALL CONCRETE SHALL BE CAST AND CURED IN ACCORDANCE WITH THE REQUIREMENTS OF THE SPECIFICATION AND THE RELEVANT STANDARDS.
  - ALL CONCRETE SHALL BE CAST AND CURED IN ACCORDANCE WITH THE REQUIREMENTS OF THE SPECIFICATION AND THE RELEVANT STANDARDS.
  - ALL CONCRETE SHALL BE CAST AND CURED IN ACCORDANCE WITH THE REQUIREMENTS OF THE SPECIFICATION AND THE RELEVANT STANDARDS.
  - ALL CONCRETE SHALL BE CAST AND CURED IN ACCORDANCE WITH THE REQUIREMENTS OF THE SPECIFICATION AND THE RELEVANT STANDARDS.
  - ALL CONCRETE SHALL BE CAST AND CURED IN ACCORDANCE WITH THE REQUIREMENTS OF THE SPECIFICATION AND THE RELEVANT STANDARDS.
  - ALL CONCRETE SHALL BE CAST AND CURED IN ACCORDANCE WITH THE REQUIREMENTS OF THE SPECIFICATION AND THE RELEVANT STANDARDS.
  - ALL CONCRETE SHALL BE CAST AND CURED IN ACCORDANCE WITH THE REQUIREMENTS OF THE SPECIFICATION AND THE RELEVANT STANDARDS.
  - ALL CONCRETE SHALL BE CAST AND CURED IN ACCORDANCE WITH THE REQUIREMENTS OF THE SPECIFICATION AND THE RELEVANT STANDARDS.
  - ALL CONCRETE SHALL BE CAST AND CURED IN ACCORDANCE WITH THE REQUIREMENTS OF THE SPECIFICATION AND THE RELEVANT STANDARDS.

FOR TENDER

# ARC:MC

MISSION CRITICAL

116142 St Johns Street  
 Level 10  
 Sydney NSW 1585  
 Australia  
 Tel: +61 2 9550 1111  
 Fax: +61 2 9550 1112  
 Email: info@arc-mc.com.au  
 Website: www.arc-mc.com.au

# A7.003 #

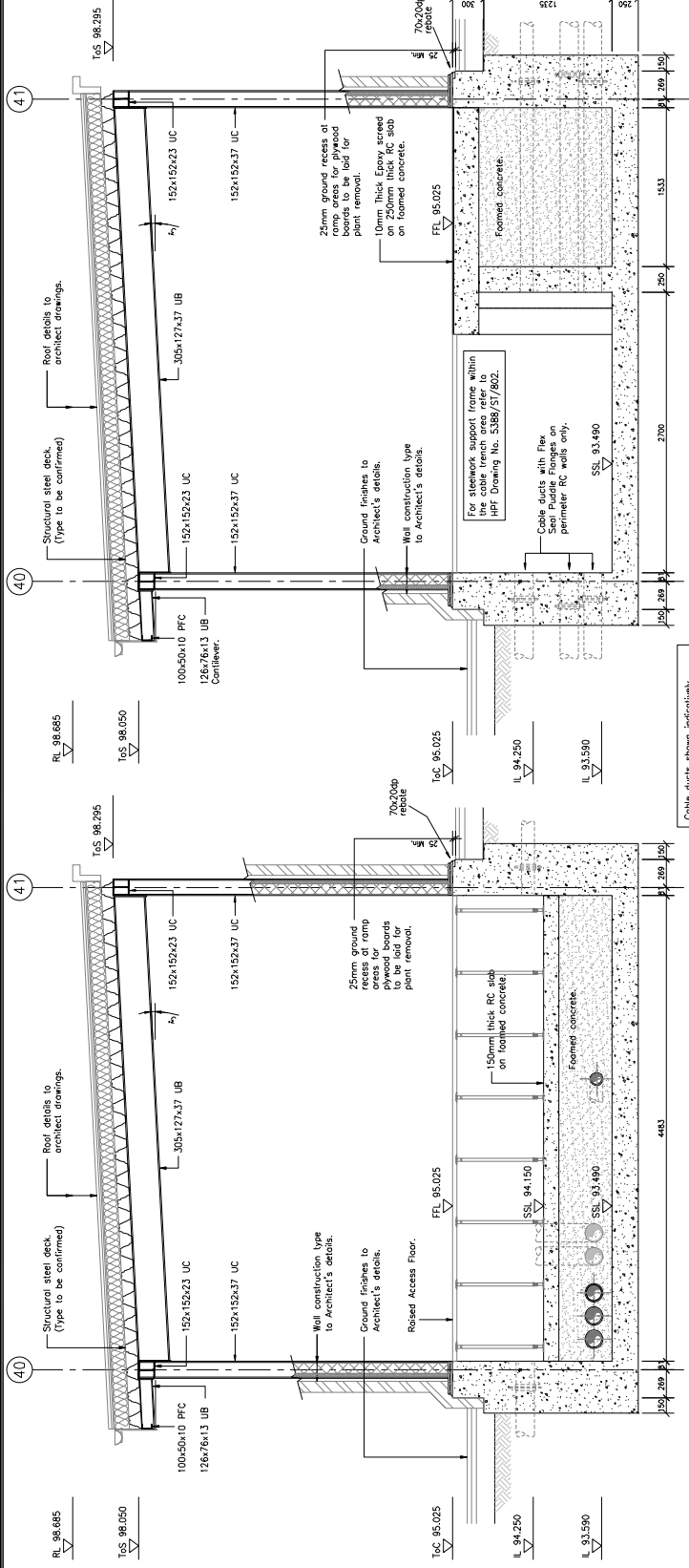

Cable ducts shown indicatively. Refer to M&E service drawings for cable locations layout & setting out.

NB: ALL CABLE LAYOUTS ARE INDICATIVE & MUST BE CONFIRMED, WITH HPF/SERVICE LAYOUTS

